

(SUBMIT IN TRIPLICATE)

Indian Agency Navajo

UNITED STATES
DEPARTMENT OF THE INTERIOR
GEOLOGICAL SURVEY

Alottee _____

Lease No. 1-67-120-57

Section 3

SUNDRY NOTICES AND REPORTS ON WELLS

NOTICE OF INTENTION TO DRILL	<input checked="" type="checkbox"/>	SUBSEQUENT REPORT OF WATER SHUT-OFF	
NOTICE OF INTENTION TO CHANGE PLANS		SUBSEQUENT REPORT OF SHOOTING OR ACIDIZING	
NOTICE OF INTENTION TO TEST WATER SHUT-OFF		SUBSEQUENT REPORT OF ALTERING CASING	
NOTICE OF INTENTION TO REDRILL OR REPAIR WELL		SUBSEQUENT REPORT OF REDRILLING OR REPAIR	
NOTICE OF INTENTION TO SHOOT OR ACIDIZE		SUBSEQUENT REPORT OF ABANDONMENT	
NOTICE OF INTENTION TO PULL OR ALTER CASING		SUPPLEMENTARY WELL HISTORY	
NOTICE OF INTENTION TO ABANDON WELL			

(INDICATE ABOVE BY CHECK MARK NATURE OF REPORT, NOTICE, OR OTHER DATA)

April 24, 1961

Well No. 20 is located 999 ft. from N line and 5310 ft. from E line of sec. 3

12 1/4 Sec. 3 (1/4 Sec. and Sec. No.) 12N - 12W (Twp.) 12N (Range) 12N (Meridian)
Table Mesa (Field) San Juan County (County or Subdivision) New Mexico (State or Territory)

The elevation of the derrick floor above sea level is 5135 ft.

DETAILS OF WORK

(State names of and expected depths to objective sands; show sizes, weights, and lengths of proposed casings; indicate mudding jobs, cementing points, and all other important proposed work)

We propose to drill this well with rotary tools to an estimated depth of 1355' to the top of the Dakota formation. A 5 1/2" casing will be run and cemented to surface. We will then drill out from under the 5 1/2" casing with cable tools and complete the well open hole.

I understand that this plan of work must receive approval in writing by the Geological Survey before operations may be commenced.

Company Continental Oil Company

Address P. O. Box 3112

Deming, Colorado

Original Signed By:
By H. D. HALEY

Title District Superintendent



NUMBER OF COPIES RECEIVED	
DISTRIBUTION	
SANTA FE	
FILE	
U.S.G.S.	
LAND OFFICE	
TRANSPORTER	OIL GAS
PRODUCTION OFFICE	
OPERATOR	

NEW MEXICO OIL CONSERVATION COMMISSION
WELL LOCATION AND ACREAGE DEDICATION PLAT
 SEE INSTRUCTIONS FOR COMPLETING THIS FORM ON THE REVERSE SIDE

FORM C-128
 Revised 5/1/57

SECTION A

Operator Continental Oil Company		Lease Table Mesa		Well No. 20
Unit Letter B	Section 3	Township 27N	Range 17W	County San Juan
Actual Footage Location of Well: 990 feet from the North line and 2310 feet from the East line				
Ground Level Elev. 5325	Producing Formation Dakota	Pool Table Mesa	Dedicated Acreage: 40 Acres	

1. Is the Operator the only owner in the dedicated acreage outlined on the plat below? YES ☒ NO ____ . ("Owner" means the person who has the right to drill into and to produce from any pool and to appropriate the production either for himself or for himself and another. (65-3-29 (e) NMSA 1935 Comp.)
2. If the answer to question one is "no," have the interests of all the owners been consolidated by communitization agreement or otherwise? YES ____ NO ____ . If answer is "yes," Type of Consolidation ____
3. If the answer to question two is "no," list all the owners and their respective interests below:

Owner	Land Description

RECEIVED
APR 25 1961

SECTION B

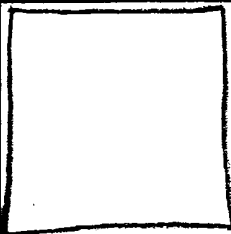
<div align="center">  </div>			
PLEASE SEE ATTACHED PLAT.			

N. M. CON. COM. DIST. 3 I hereby certify that the information in SECTION A above is true and complete to the best of my knowledge and belief. Original Signed By: H. D. HALEY
Name District Superintendent
Position Continental Oil Company
Company April 24, 1961
Date

I hereby certify that the well location shown on the plat in SECTION B was plotted from field notes of actual surveys made by me or under my supervision, and that the same is true and correct to the best of my knowledge and belief.

Date Surveyed 4-13-61
Registered Professional Engineer and/or Land Surveyor <i>Edmund M. Clark</i>
Certificate No. 3109

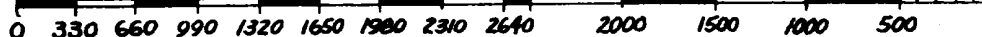

INSTRUCTIONS FOR COMPLETION OF FORM C-128

1. Operator shall furnish and certify to the information called for in Section A.
2. Operator shall outline the dedicated acreage for *both* oil and gas wells on the plat in Section B.
3. A registered professional engineer or land surveyor registered in the State of New Mexico or approved by the Commission shall show on the plat the location of the well and certify this information in the space provided.
4. All distances shown on the plat must be from the outer boundaries of the Section.
5. If additional space is needed for listing owners and their respective interests as required in question 3 of Section A, please use space below.

RECEIVED

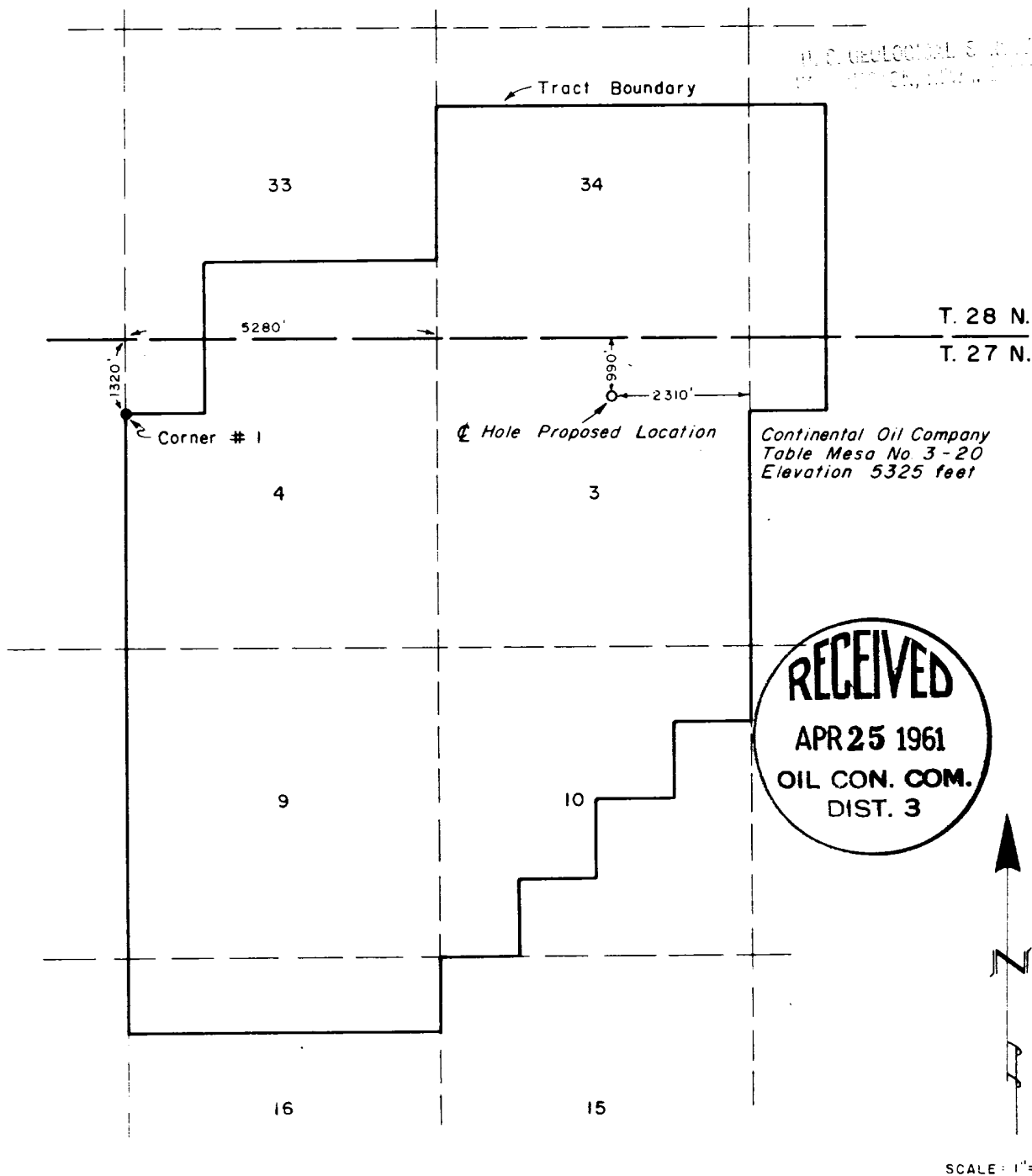

NOTE:

Section line projection based upon lease description
and tract survey of November, 1950.

I hereby certify the above plat represents a survey
made under my supervision and that it is accurate
to the best of my knowledge and belief.

Elmer M. Clark

ELMER M. CLARK
Registered Land Surveyor
State of New Mexico (No 3189)

CONTINENTAL OIL CO.

WELL LOCATION PLAT
Sec. 3, T27N, R17W
San Juan Co., New Mexico

E.M. CLARK & ASSOC.
Durango, Colorado

DATE: April 21, 1961
FILE NO: 61031