

(SUBMIT IN TRIPLICATE)

UNITED STATES
DEPARTMENT OF THE INTERIOR
GEOLOGICAL SURVEY

Land Office Santa Fe
Lease No. 078895
Unit 140

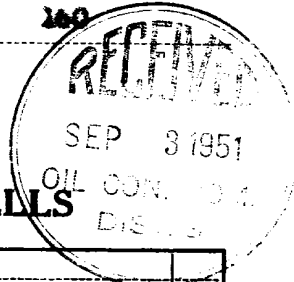

SUNDRY NOTICES AND REPORTS ON WELLS

NOTICE OF INTENTION TO DRILL.....	<input checked="" type="checkbox"/>	SUBSEQUENT REPORT OF WATER SHUT-OFF.....	
NOTICE OF INTENTION TO CHANGE PLANS.....		SUBSEQUENT REPORT OF SHOOTING OR ACIDIZING.....	
NOTICE OF INTENTION TO TEST WATER SHUT-OFF.....		SUBSEQUENT REPORT OF ALTERING CASING.....	
NOTICE OF INTENTION TO RE-DRILL OR REPAIR WELL.....		SUBSEQUENT REPORT OF REDRILLING OR REPAIR.....	
NOTICE OF INTENTION TO SHOOT OR ACIDIZE.....		SUBSEQUENT REPORT OF ABANDONMENT.....	
NOTICE OF INTENTION TO PULL OR ALTER CASING.....		SUPPLEMENTARY WELL HISTORY.....	
NOTICE OF INTENTION TO ABANDON WELL.....			

(INDICATE ABOVE BY CHECK MARK NATURE OF REPORT, NOTICE, OR OTHER DATA)

August 30, 1951, 19

Well No. 7 is located 990 ft. from N line and 990 ft. from E line of sec. 6
NE 1/4 of Sec. 6 27N 11W N.M.P.M.
 (1/4 Sec. and Sec. No.) (Twp.) (Range) (Meridian)
West Gate Canyon San Juan New Mexico
 (Field) (County or Subdivision) (State or Territory)

The elevation of the derrick floor above sea level is 6021.1 ft.

DETAILS OF WORK

(State names of and expected depths to objective sands; show sizes, weights, and lengths of proposed casings; indicate mudding jobs, cementing points, and all other important proposed work)

Propose to drill with rotary tools well of sufficient depth to test Pictured Cliffs formation at approximately 1800 feet. Expect to set approximately 160 feet of 8-5/8", 9-5/8", 10-1/4" or 11" surface casing and approximately 1800 feet of 5 1/2" or 7" production casing. Surface casing will be cemented to surface and production casing will be cemented with not less than 50 sacks. If considered desirable to increase production potential, will plan to shoot well with nitro-glycerine. Propose to drill in and complete the well with cable tools. Copies of any logs obtained will be furnished to USGS.

NE 1/4 of Section 6 is Designated Drilling Unit.

I understand that this plan of work must receive approval in writing by the Geological Survey before operations may be commenced.

Company JAMES D. HANCOCK & COMPANY, LTD.

Address 916 Kirby Building

Dallas, Texas

By O. F. STEVENS

cc: EN OIL CONSERVATION COMMISSION
P. G. LARK, INC.

Title Superintendent

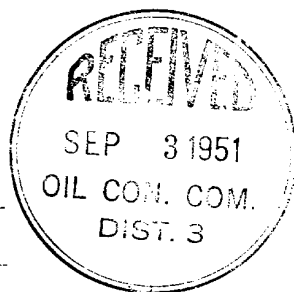

Company James D. Hancock & Co. Ltd.

Lease E.W. Mudge A-Federal Well No. 7

Sec. 6 T. 27 N., R. 11 W., N.M.P.M.

Location 990' from the North line and 990'
from the East line.

San Juan County

New Mexico

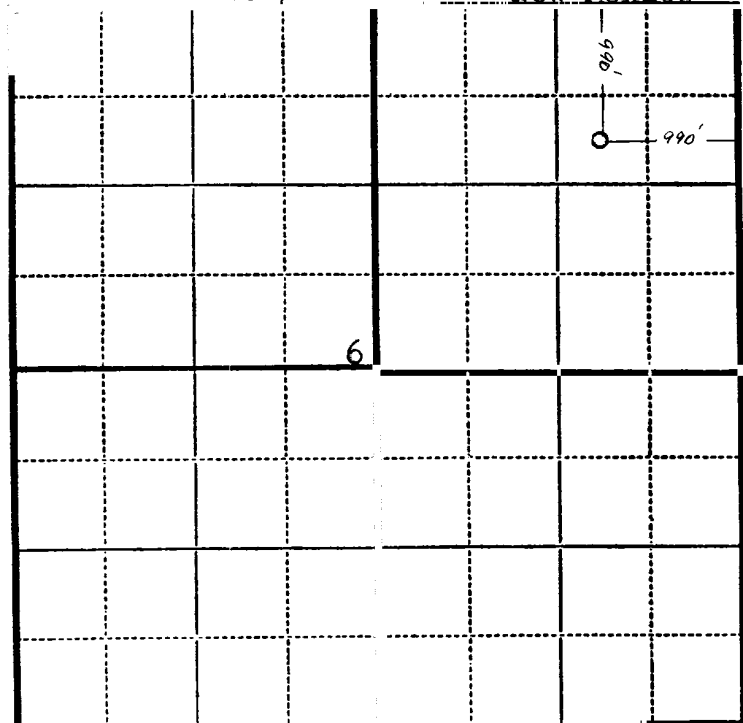

Scale—4 inches equals 1 mile.

This is to certify that the above plat was prepared from field notes of actual surveys made by me or under my supervision and that the same are true and correct to the best of my knowledge and belief.

Charles J. Finklea

Seal:

Registered Professional Charles J. Finklea
Engineer and Land Surveyor. N. Mex. Reg. No. 1302

Surveyed August 23, 1951