

(SUBMIT IN TRIPPLICATE)

UNITED STATES  
DEPARTMENT OF THE INTERIOR  
GEOLOGICAL SURVEY

Land Office Santa Fe  
Lease No. 080112  
Unit Riddle

30-045-0 1186  
Budget Bureau No. 42-R358.4.  
Approval expires 12-31-60.

## SUNDRY NOTICES AND REPORTS ON WELLS

NOTICE OF INTENTION TO DRILL.....	<input checked="" type="checkbox"/>	SUBSEQUENT REPORT OF WATER SHUT-OFF.....	
NOTICE OF INTENTION TO CHANGE PLANS.....		SUBSEQUENT REPORT OF SHOOTING OR ACIDIZING.....	
NOTICE OF INTENTION TO TEST WATER SHUT-OFF.....		SUBSEQUENT REPORT OF ALTERING CASING.....	
NOTICE OF INTENTION TO RE-DRILL OR REPAIR WELL.....		SUBSEQUENT REPORT OF RE-DRILLING OR REPAIR.....	
NOTICE OF INTENTION TO SHOOT OR ACIDIZE.....		SUBSEQUENT REPORT OF ABANDONMENT.....	
NOTICE OF INTENTION TO PULL OR ALTER CASING.....		SUPPLEMENTARY WELL HISTORY.....	
NOTICE OF INTENTION TO ABANDON WELL.....			

(INDICATE ABOVE BY CHECK MARK NATURE OF REPORT, NOTICE, OR OTHER DATA)

April 15, 19 57

Well No. 4-F(FM) is located 1000 ft. from N line and 1550 ft. from E line of sec. 29

NE Section 29 20N W N.M.P.M.  
(1/4 Sec. and Sec. No.) (Twp.) (Range) (Meridian)

Artes P.C. Ext. & Blanco San Juan New Mexico  
(Field) (County or Subdivision) (State or Territory)

The elevation of the derrick floor above sea level is 5831 ft.

### DETAILS OF WORK

(State names of and expected depths to objective sands; show sizes, weights, and lengths of proposed casings; indicate mudding jobs, cementing points, and all other important proposed work)

It is intended to drill & dual complete a well in the Pictured Cliffs formation & Mesa Verde formation. Mud circulation will be used thru the Pictured Cliffs formation & set intermediate casing. Gas circulation will be used thru the Mesa Verde & a production liner will be set. Possible productive intervals will be perforated & fractured. Estimated Total Depth 4580'.

#### Casing Program:

10-3/4" at 170' with 125 sacks cement circulated to the surface.  
7-5/8" at 2360' with 250 sacks cement.  
5-1/2" liner at 4580' with 300 sacks cement.

The E/2 of Section 29 is dedicated to the Mesa Verde.

The NE/4 of Section 29 is dedicated to the Pictured Cliffs  
E/2 & NE/4 SP 080112.

I understand that this plan of work must receive approval in writing by the Geological Survey before operations may be commenced.

Company S. Paso Natural Gas Company

Address Box 991

Farmington, New Mexico

By ORIGINAL SIGNED F.W. BOYD

Title Petroleum Engineer

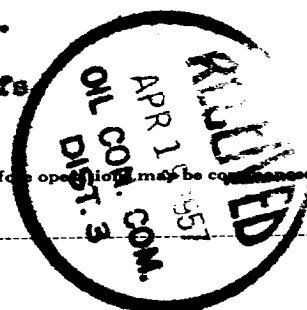



NEW MEXICO  
OIL CONSERVATION COMMISSION

WELL LOCATION AND/OR GAS PRORATION PLAT

APRIL 8, 1957

EL PASO NATURAL GAS COMPANY

RIDDLE "F"

SF 080112

4 (PM)

29

28 N

8 W

1000

NORTH

1550

EAST

SAN JUAN

S. 30

5821

P.C. & M.V.

BLANCO NY

160 AC PC  
320 AC NY  
(1919 PLAT)

Note: All distances in feet unless otherwise indicated.

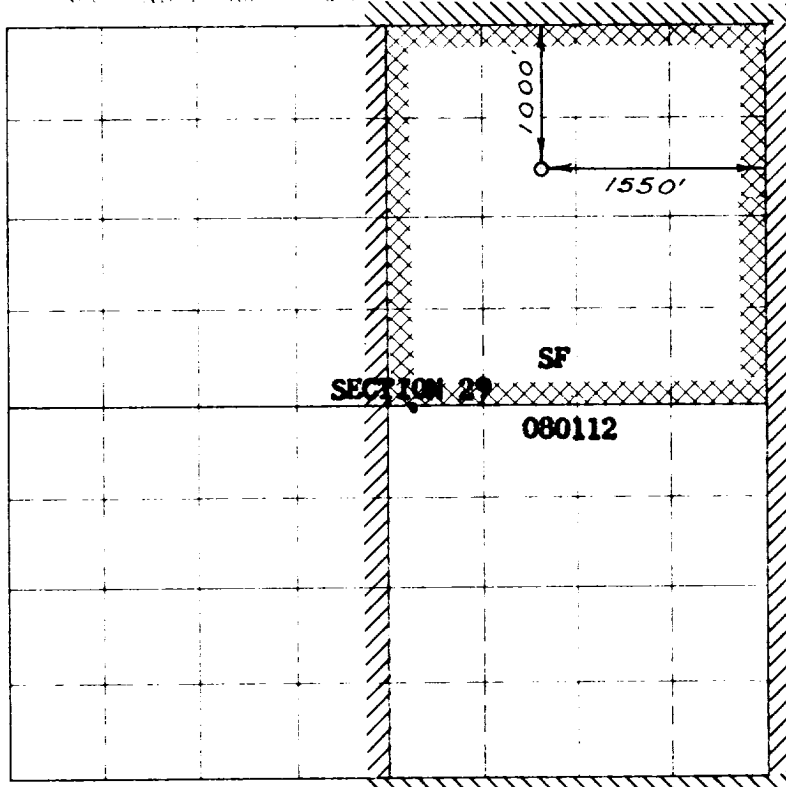

Scale: 4 inches equal 1 mile

NOTE

This section of  
form is to be used  
for gas wells only

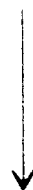

I hereby certify that the above plat was prepared from  
field notes of actual surveys made by me or under my  
supervision and that the same are true and correct to the  
best of my knowledge and belief.

Date Surveyed **MARCH 7, 1957**

*E. O. Walker*

Registered Professional Engineer and/or Land Surveyor

1. Is this well a Dual Comp.

Yes ☒ No ☐

2. If the answer to Question 1

is yes, are there any other dualy  
completed wells within the  
dedicated acreage.

Yes ☐ No ☒

Name **ORIGINAL SIGNED F.W. BOYD**

Position **Petroleum Engineer**

Representing **El Paso Natural Gas**

Address **Box 997, Farmington, N.M.**

Send