

(SUBMIT IN TRIPLICATE)
UNITED STATES
DEPARTMENT OF THE INTERIOR
GEOLOGICAL SURVEY

Land Office Santa Fe
Lease No. 080112
Unit Geoch

SUNDRY NOTICES AND REPORTS ON WELLS

NOTICE OF INTENTION TO DRILL	<input checked="" type="checkbox"/>	SUBSEQUENT REPORT OF WATER SHUT-OFF	<u>DIST. 3</u>
NOTICE OF INTENTION TO CHANGE PLANS		SUBSEQUENT REPORT OF SHOOTING OR ACIDIZING	
NOTICE OF INTENTION TO TEST WATER SHUT-OFF		SUBSEQUENT REPORT OF ALTERING CASING	
NOTICE OF INTENTION TO RE-DRILL OR REPAIR WELL		SUBSEQUENT REPORT OF REDRILLING OR REPAIR	
NOTICE OF INTENTION TO SHOOT OR ACIDIZE		SUBSEQUENT REPORT OF ABANDONMENT	
NOTICE OF INTENTION TO PULL OR ALTER CASING		SUPPLEMENTARY WELL HISTORY	
NOTICE OF INTENTION TO ABANDON WELL			

(INDICATE ABOVE BY CHECK MARK NATURE OF REPORT, NOTICE, OR OTHER DATA)

June 16, 1952

Well No. 1 is located 1450 ft. from XX S line and 990 ft. from XX W line of sec. 17

NW SW Section 17
(¼ Sec. and Sec. No.)

28N
(Twp.)

3W
(Range)

N. M. P. M.
(Meridian)

Blanco - La Plata
(Field)

San Juan
(County or Subdivision)

New Mexico
(State or Territory)

The elevation of the derrick floor above sea level is 5722 ft.

DETAILS OF WORK

(State names of and expected depths to objective sands; show sizes, weights, and lengths of proposed casings; indicate mudding jobs, cementing points, and all other important proposed work)

It is intended to:

1. Drill a well with rotary tools through the Mesaverde.
2. Drill the pay section with gas circulation.
3. Shoot the entire Mesaverde with two quarts per foot of S.N.G. Total depth 4550'.

Casing program:

9-5/8" at 150' with cement to surface.
7 " at 3780' with 300 sacks regular cement.

½ of Section 17 is dedicated to this well.

I understand that this plan of work must receive approval in writing by the Geological Survey before operations may be commenced.

Company EL PASO NATURAL GAS COMPANY

Address P. O. Box 997

Farmington, New Mexico

By

Title Petroleum Engineer

COMPANY El Paso Natural Gas Company

Well Name & No. Gooch No. 1 Lease No. SFO 0112

Location 990 Feet From The West Line, 1450 Feet From The South Line

Being in the N.E. of the S.W.

Sec. 17, T 25 N., R 8 W., N.M.P.M., San Juan County, New Mexico

Ground Elevation 5719.32

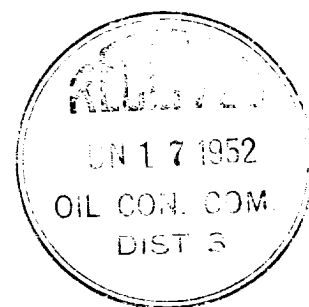
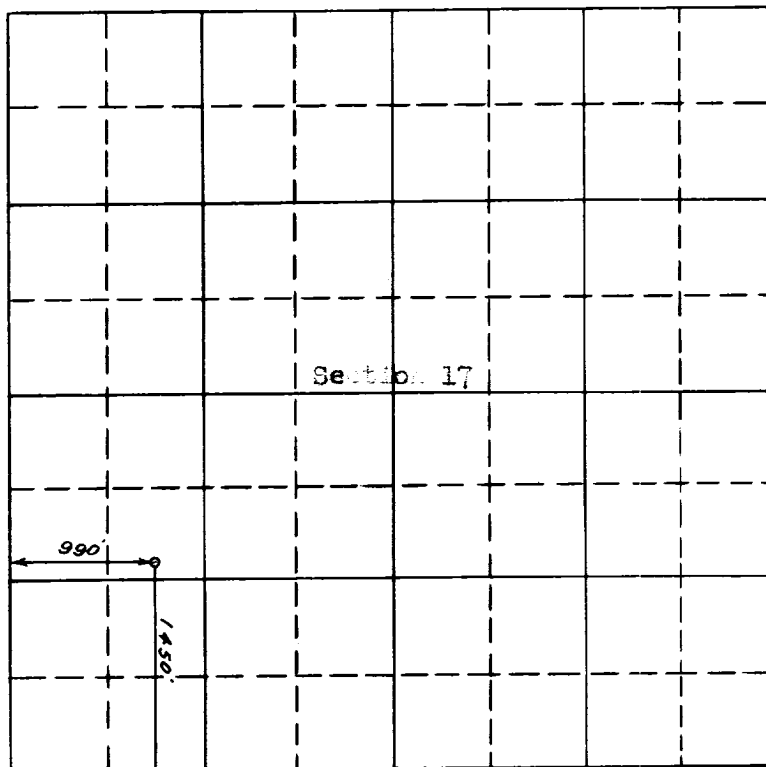

Scale -- 4 inches equals 1 mile

Surveyed June 3, 19 52

This is to certify that the above plat was prepared from field notes of actual surveys made by me or under my supervision and that the same are true and correct to the best of my knowledge and belief.

B. O. Walker

Registered Professional
Engineer and Land Surveyor.

Seal:

Farmington, New Mexico

Washington, New Mexico

Seal:

Engineer and Land Surveyor.
Registered Professional

This is to certify that the above plat was prepared from field notes of actual surveys made by me or under my supervision and that the same are true and correct to the best of my knowledge and belief.

Surveyed _____, 19__

Scale -- 4 inches equals 1 mile

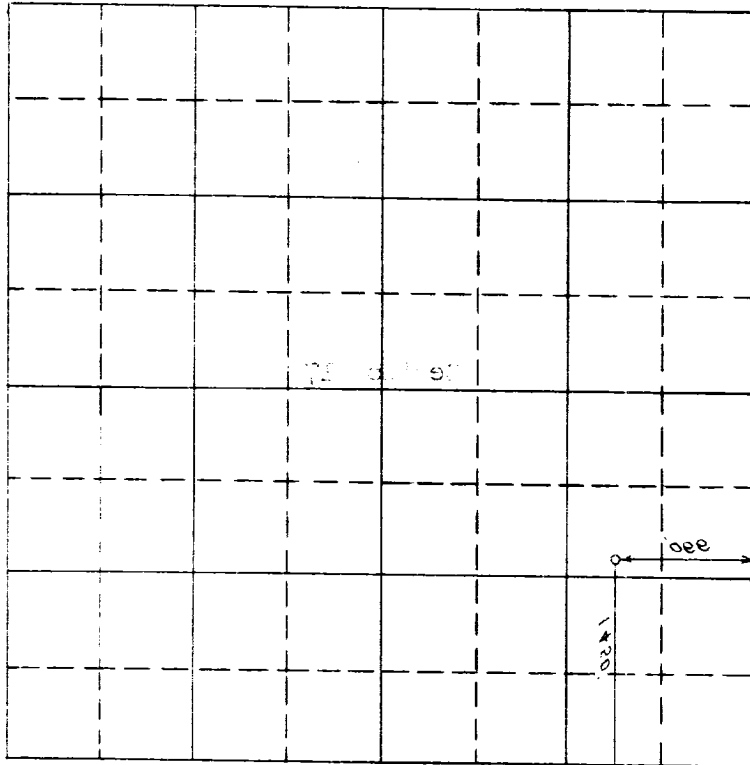

Ground Elevation _____
Sec. 14, T. 24N., R. 10W., N.M.P.M., San Juan County, New Mexico
Being in _____
Location _____
Well Name & No. _____
Lease No. _____
COMPANY _____