

(SUBMIT IN TRIPLICATE)

UNITED STATES
DEPARTMENT OF THE INTERIOR
GEOLOGICAL SURVEY

Land Office New Mexico
Lease No. 013860-A
Unit Russell

RECORDED

SUNDRY NOTICES AND REPORTS ON WELLS

NOTICE OF INTENTION TO DRILL	<input checked="" type="checkbox"/>	SUBSEQUENT REPORT OF WATER SHUT-OFF	
NOTICE OF INTENTION TO CHANGE PLANS		SUBSEQUENT REPORT OF SHOOTING OR ACIDIZING	
NOTICE OF INTENTION TO TEST WATER SHUT-OFF		SUBSEQUENT REPORT OF ALTERING CASING	
NOTICE OF INTENTION TO RE-DRILL OR REPAIR WELL		SUBSEQUENT REPORT OF RE-DRILLING OR REPAIR	
NOTICE OF INTENTION TO SHOOT OR ACIDIZE		SUBSEQUENT REPORT OF ABANDONMENT	
NOTICE OF INTENTION TO PULL OR ALTER CASING		SUPPLEMENTARY WELL HISTORY	
NOTICE OF INTENTION TO ABANDON WELL			

(INDICATE ABOVE BY CHECK MARK NATURE OF REPORT, NOTICE, OR OTHER DATA)

March 3, 1958

Well No. 3(PM) is located 690 ft. from Box line and 1140 ft. from W line of sec. 23

SW Sec. 23 26N 3W N.M.P.M.
(1/4 Sec. and Sec. No.) (Twp.) (Range) (Meridian)
Blanco M. V. San Juan New Mexico
(Field) (County or Subdivision) (State or Territory)
Undesignated P. C.

The elevation of the derrick floor above sea level is 5875 ft.

DETAILS OF WORK

(State names of and expected depths to objective sands; show sizes, weights, and lengths of proposed casings; indicate mudding jobs, cementing points, and all other important proposed work)

It is intended to drill & dual complete a well in the Pictured Cliffs formation & Mesa Verde formation. Mud circulation will be used thru the Pictured Cliffs formation & set intermediate casing. Gas circulation will be used thru the Mesa Verde & a production liner will be set. Possible productive intervals will be perforated & fractured. Estimated Total Depth 4732'.

Casing Program:

10 3/4" at 170' with 125 sacks cement circulated to the surface.

7 5/8" at 2562' with 250 sacks cement.

5 1/2" liner at 4732' with 300 sacks cement.

the W/2 of Section 23 is dedicated to the Mesa Verde.

The NW/4 of Section 23 is dedicated to the Pictured Cliffs

W/2: NW 013860-A (SW/4); SP 078499 (NW/4)

I understand that this plan of work must receive approval in writing by the Geological Survey before operations may be commenced.

Company El Paso Natural Gas Company

Address Box 997

Farmington, New Mexico

Original Signed D. C. Johnston

By _____

Title Petroleum Engineer

NEW MEXICO OIL CONSERVATION COMMISSION

Well Location and Acreage Dedication Plat

Section A.

Date **FEBRUARY 24, 1958**

Operator **EL PASO NATURAL GAS COMPANY** Lease **RUSSELL** NM **013860-A**
 Well No. **3(PM)** Unit Letter **M** Section **23** Township **28-N** Range **8-W** NMPM
 Located **890** Feet From **SOUTH** Line, **1140** Feet From **WEST** Line
 County **SAN JUAN** G. L. Elevation **5865** Dedicated Acreage **320 & 160** Acres
 Name of Producing Formation **MESA VERDE & PICTURED CLIFF** Pool **MV - BLANCO, PC - WILDCAT**

1. Is the Operator the only owner in the dedicated acreage outlined on the plat below?
 Yes ☒ No ☐
2. If the answer to question one is "no", have the interests of all the owners been consolidated by communization agreement or otherwise? Yes ☐ No ☐ If answer is "yes", Type of Consolidation.

3. If the answer to question two is "no", list all the owners and their respective interests below:

Owner

Land Description

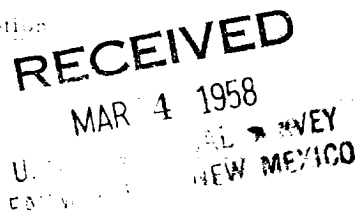

Section B.

This is to certify that the information in Section A above is true and complete to the best of my knowledge and belief.

El Paso Natural Gas Company

(Operator)

Original Signed D. C. Johnston

(Representative)

Box 997

(Address)

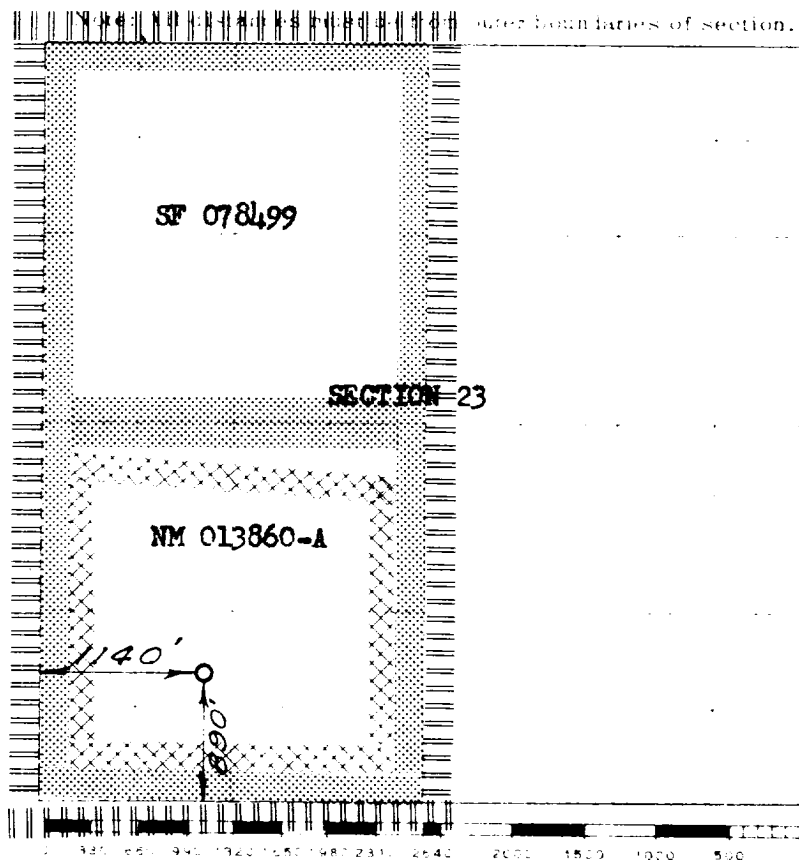
Farmington, New Mexico

Scale 1 inch = 1 mile

This is to certify that the above plat was prepared from field notes of actual surveys made by me or under my supervision and that the same are true and correct to the best of my knowledge and belief.

(Seal)

Date surveyed **OCTOBER 23, 1957**

David O. Johnson
 Registered Professional Engineer and/or Land Surveyor

Farmington, New Mexico