

(SUBMIT IN TRIPLICATE)

UNITED STATES
DEPARTMENT OF THE INTERIOR
GEOLOGICAL SURVEY

Land Office Santa Fe
Lease No. MT-97-B
Unit Michigan

SUNDRY NOTICES AND REPORTS ON WELLS

NOTICE OF INTENTION TO DRILL	<input checked="" type="checkbox"/>	SUBSEQUENT REPORT OF WATER SHUT-OFF	
NOTICE OF INTENTION TO CHANGE PLANS		SUBSEQUENT REPORT OF SHOOTING OR ACIDIZING	
NOTICE OF INTENTION TO TEST WATER SHUT-OFF		SUBSEQUENT REPORT OF ALTERING CASING	
NOTICE OF INTENTION TO RE-DRILL OR REPAIR WELL		SUBSEQUENT REPORT OF RE-DRILLING OR REPAIR	
NOTICE OF INTENTION TO SHOOT OR ACIDIZE		SUBSEQUENT REPORT OF ABANDONMENT	
NOTICE OF INTENTION TO PULL OR ALTER CASING		SUPPLEMENTARY WELL HISTORY	
NOTICE OF INTENTION TO ABANDON WELL			

(INDICATE ABOVE BY CHECK MARK NATURE OF REPORT, NOT CE, OR OTHER DATA)

February 25, 1952

Well No. 2 is located 1453 ft. from N line and 195 ft. from W line of sec. 15
N. Section 15 20N 9W 11MPN
(1/4 Sec. and Sec. No.) (Twp.) (Range) (Meridian)
Calcut San Juan New Mexico
(Field) (County or Subdivision) (State or Territory)

The elevation of the derrick floor above sea level is 627 ft.

DETAILS OF WORK

(State names of and expected depths to objective sands; show sizes, weights, and lengths of proposed casings; indicate mudlogging jobs, cementing points, and all other important proposed work)

It is intended to drill a well thru the Pictured Cliff formation using rotary tools to the casing point and to drill the pay section with cable tools and to water fracture the entire pay section. T.D. 2300'

Casing Program:

5 5/8" at 120' with 125 sacks regular cement circulated to surface.
5 1/2" at 2320' with 75 sacks cement, 75 sacks grout.

The N-1/4 of Section 15 is dedicated to this well.

I understand that this plan of work must receive approval in writing by the Geological Survey before operations may be commenced.

Company El Paso Natural Gas Company
Address Box 977
Frederington, New Mexico
By Carl W. Walsh
Title Petroleum Engineer

OIL CONSERVATION COMMISSION

WELL LOCATION AND/OR GAS PROPRATION PLAT

DATE MARCH 2, 1956OPERATOR EL PASO NATURAL GAS COMPANY LEASE MITCHENER SF 077107 BWELL NO. 2 SECTION 15 TOWNSHIP 28N RANGE 9W NNPMLOCATED 1453 FEET FROM NORTH LINE 1850 FEET FROM WEST LINESAN JUAN COUNTY, NEW MEXICO G. L. ELEVATION 6017NAME OF PRODUCING FORMATION PICTURED CLIFF POOL AZTEC DEDICATED ACREAGE 160 ACRES

Note: All distances must be from outer boundaries of section.

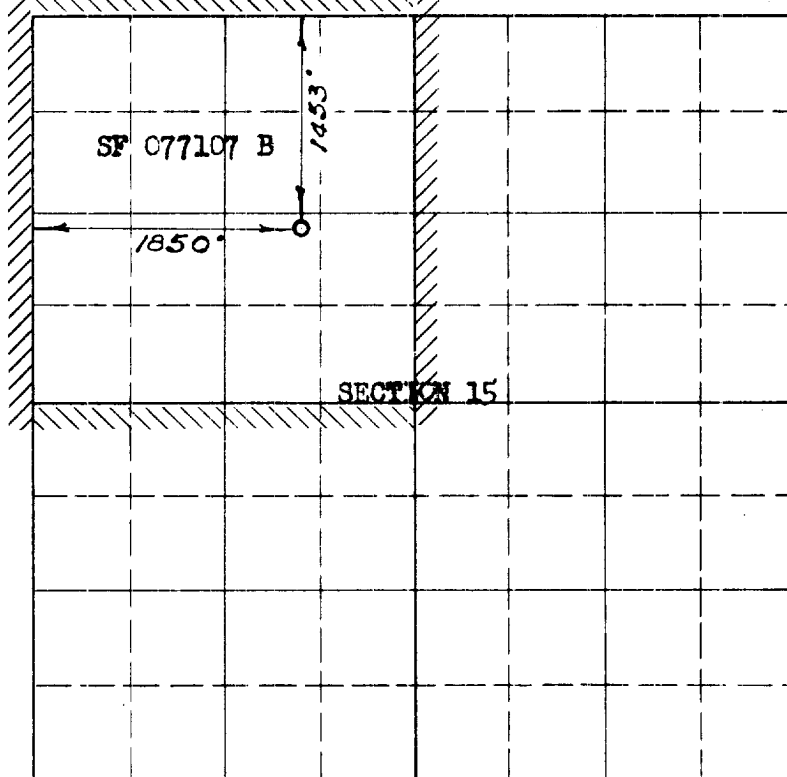

Scale 4 inches equal 1 mile

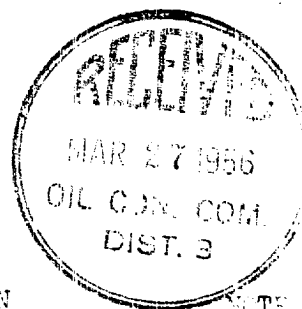

This section of
form is to be used
for gas wells only

This is to certify that the above plat was prepared from field notes of actual surveys made by me or under my supervision and that the same are true and correct to the best of my knowledge and belief.

Date Surveyed FEBRUARY 10, 1956

E. O. Walker
Registered Professional Engineer and/or
Land Surveyor

(Seal)

1. Is this well a Dual Comp.
Yes No ✓

2. If the answer to question 1
is yes, are there any other
fully completed wells within
the dedicated acreage.
Yes No

Name Wm. M. MohrPosition Petroleum EngineerRepresenting El Paso Nat. Gas Co.Address Box 997, Farmington, N.M.

Farmington, New Mexico

NOTE: PLAT RE-ISSUED ON CORRECTED FORM