

(SUBMIT IN TRIPLICATE)

UNITED STATES
DEPARTMENT OF THE INTERIOR
GEOLOGICAL SURVEYLand Office Santa Fe
Lease No. NS-01772-A
Unit _____

SUNDRY NOTICES AND REPORTS ON WELLS

NOTICE OF INTENTION TO DRILL.....	<input checked="" type="checkbox"/>	SUBSEQUENT REPORT OF WATER SHUT-OFF.....
NOTICE OF INTENTION TO CHANGE PLANS.....		SUBSEQUENT REPORT OF SHOOTING OR ACIDIZING.....
NOTICE OF INTENTION TO TEST WATER SHUT-OFF.....		SUBSEQUENT REPORT OF ALTERING CASING.....
NOTICE OF INTENTION TO RE-DRILL OR REPAIR WELL.....		SUBSEQUENT REPORT OF RE-DRILLING OR REPAIR.....
NOTICE OF INTENTION TO SHOOT OR ACIDIZE.....		SUBSEQUENT REPORT OF ABANDONMENT.....
NOTICE OF INTENTION TO PULL OR ALTER CASING.....		SUPPLEMENTARY WELL HISTORY.....
NOTICE OF INTENTION TO ABANDON WELL.....		

(INDICATE ABOVE BY CHECK MARK NATURE OF REPORT, NOTICE, OR OTHER DATA)

October 19, 1956

Well No. 11 Reid is located 105 ft. from ~~North~~ line and 1990 ft. from ~~West~~ line of sec. 6SE/4, Section 8 T-28-N, R-9-W N.M.P.M.
(1/4 Sec. and Sec. No.) (Twp.) (Range) (Meridian)Astec San Juan New Mexico
(Field) (County or Subdivision) (State or Territory)The elevation of the derrick floor above sea level is _____ ft. to be furnished -

DETAILS OF WORK

(State names of and expected depths to objective sands; show sizes, weights, and lengths of proposed casings; indicate mudding jobs, cementing points, and all other important proposed work)

Propose to: Set 8 5/8" casing at 160' with 125 sacks cement. Drill through Pictured Cliffs formation to an approximate total depth of 2300'. Set 5 1/2" casing to 2300' with 100 sacks cement. Perforate Pictured Cliffs formation. Sand-water free with 20,000 gallons water and 20,000 lbs. sand. Install 1" tubing.

The proration unit assigned in Section 8 are lots 1, 2, and 3 and S/2 SE/4 and SE/SW consisting of 25.08 acres. R-658

Note: Verbal approval has been obtained from N.M.P.C.C. in regard to this non-standard location. See Order No. NSL-67.

I understand that this plan of work must receive approval in writing by the Geological Survey before operations may be commenced.

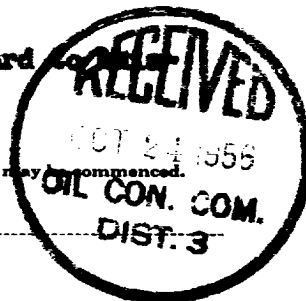
Company AZTEC OIL & GAS COMPANYAddress P O Box 786Farmington, New MexicoBy Joe C. Salmon
Joe C. Salmon
Title Drilling Superintendent

NEW MEXICO
OIL CONSERVATION COMMISSION

Form C-128

Well Location and/or Gas Proration Plat

Date October 16, 1956

Operator Aztec Oil and Gas Company Lease 2224

Well No. 22 Section 8 Township 28 North Range 9 West NMPM

Located 105 Feet From South Line, 1900 Feet From East Line,

San Juan County, New Mexico. G. L. Elevation 5952

Name of Producing Formation Pictured Cliffs Pool Aztec Dedicated Acreage 273.92

(Note: All distances must be from outer boundaries of Section)

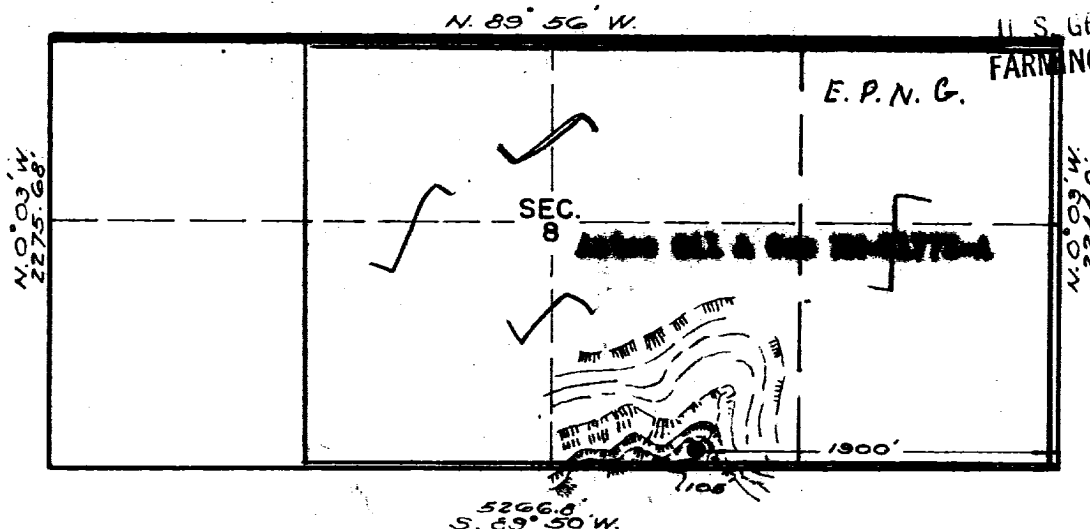

TOTAL AREA OF SECTION
(273.92 ACRES)

NOTE

This section of
form is to be
used for gas
wells only.

SCALE: 1"=1000'

1. Is this Well a Dual Comp. ? Yes No
2. If the answer to Question 1 is yes, are there any other
dually completed wells within the dedicated acreage?
Yes No

Name Joe C. Salmon
Position Field Supervisor
Representing Aztec Oil & Gas Company
Address Box 106, Farmington, New Mexico



This is to certify that the plat was prepared
from field notes of actual survey made by me or
under my supervision and that the same is true and
correct to the best of my knowledge.

Date Surveyed October 16, 1956

Ernest V. Echohawk
Reg. Land Surveyor, N. Mex., Reg. No. 1545