

OIL CONSERVATION COMMISSION  
3 DISTRICT

OIL CONSERVATION COMMISSION  
BOX 871  
SANTA FE, NEW MEXICO

DATE 1-25-66  
Re: Proposed NSP \_\_\_\_\_  
Proposed NWU \_\_\_\_\_  
Proposed NSL \_\_\_\_\_  
Proposed NFO \_\_\_\_\_  
Proposed DC ✓

Gentlemen:

I have examined the application dated 1-21-66  
for the Shackleton Oil & Gas Co. Operator Lease and Well No. Fedon # S-T-R 24-27-8  
and my recommendations are as follows:

Approved  
\_\_\_\_\_  
\_\_\_\_\_  
\_\_\_\_\_  
\_\_\_\_\_  
\_\_\_\_\_

Yours very truly,

Ernest E. Anderson

**PROPOSED DUAL COMPLETION**

Marron WN Federal, Well #6  
 1500' f/North and 1500' f/East lines  
 Section 24-27N-8W, San Juan County

**Drilling Units:**

- Pictured Cliffs - NE/4 Sec. 24
- Mesaverde - E/2 Sec. 24

SINCLAIR OIL & GAS COMPANY - OPR.

**OFFSET OPERATORS**

- North - Northwest Production Corporation,  
P. O. Box 1796, El Paso, Texas
- East - El Paso Natural Gas Company  
P. O. Box 990, Farmington, New Mexico
- South - Skelly Oil Company  
Box 4115, Station A, Albuquerque, New Mexico
- South - John A. Egan, Box 208, Farmington, New Mex.
- South - R & G Drilling Co., Inc.  
Box 327, Farmington, New Mexico
- West - John A. Egan, Box 208, Farmington, New Mex.

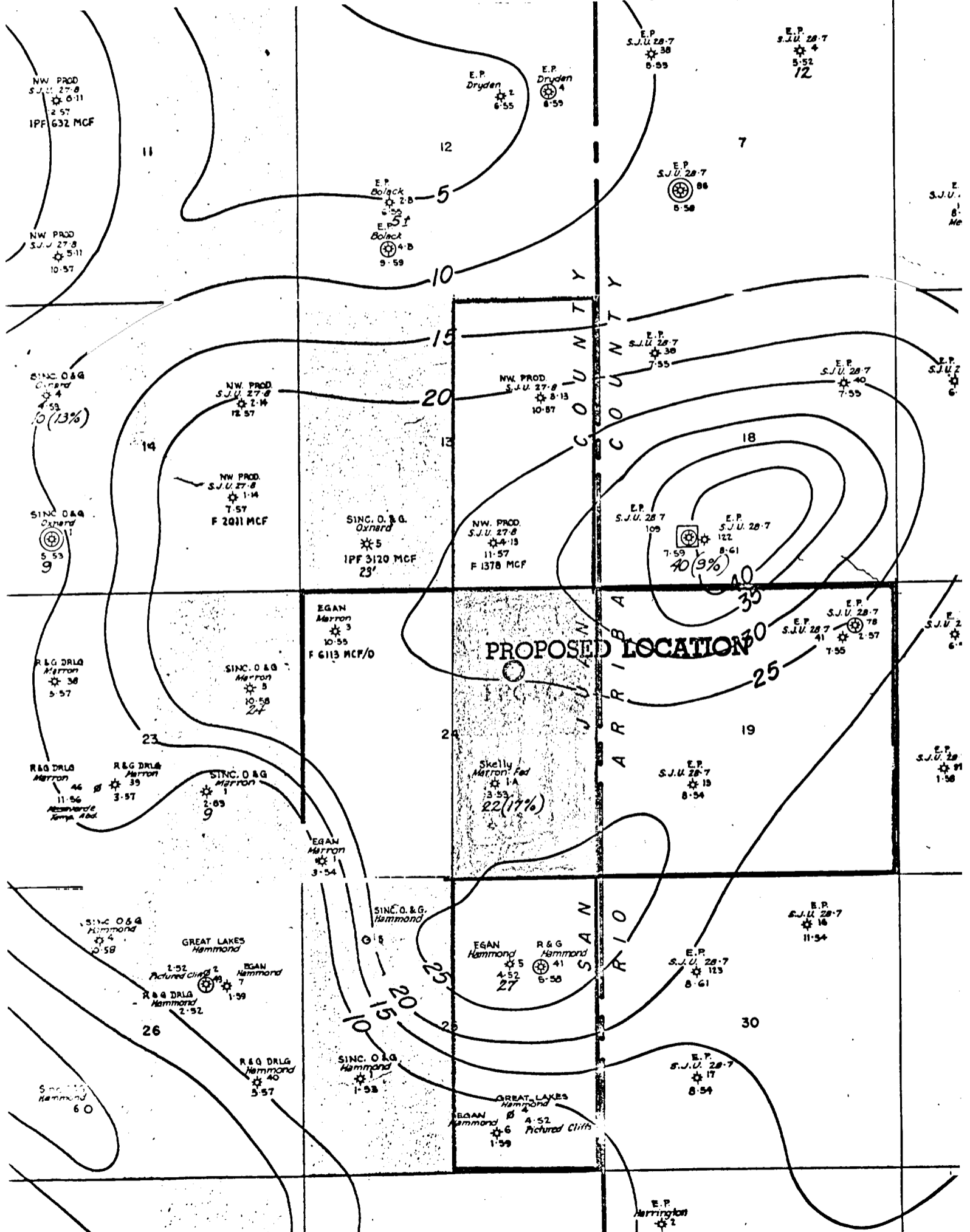

**PROPOSED DUAL COMPLETION**

Marron WN Federal, Well #6  
 1500' f/North and 1500' f/East lines  
 Section 24-27N-8W, San Juan County

**Drilling Units:**

Pictured Cliffs - NE/4 Sec. 24  
 Mesaverde - E/2 Sec. 24

SINCLAIR OIL & GAS COMPANY - OPR.

**OFFSET OPERATORS**

- North - Northwest Production Corporation,  
P. O. Box 1796, El Paso, Texas
- East - El Paso Natural Gas Company  
P. O. Box 990, Farmington, New Mexico
- South - Skelly Oil Company  
Box 4115, Station A, Albuquerque, New Mexico
- South - John A. Egan, Box 208, Farmington, New Mex.
- South - R & G Drilling Co., Inc.  
Box 327, Farmington, New Mexico
- West - John A. Egan, Box 208, Farmington, New Mex.

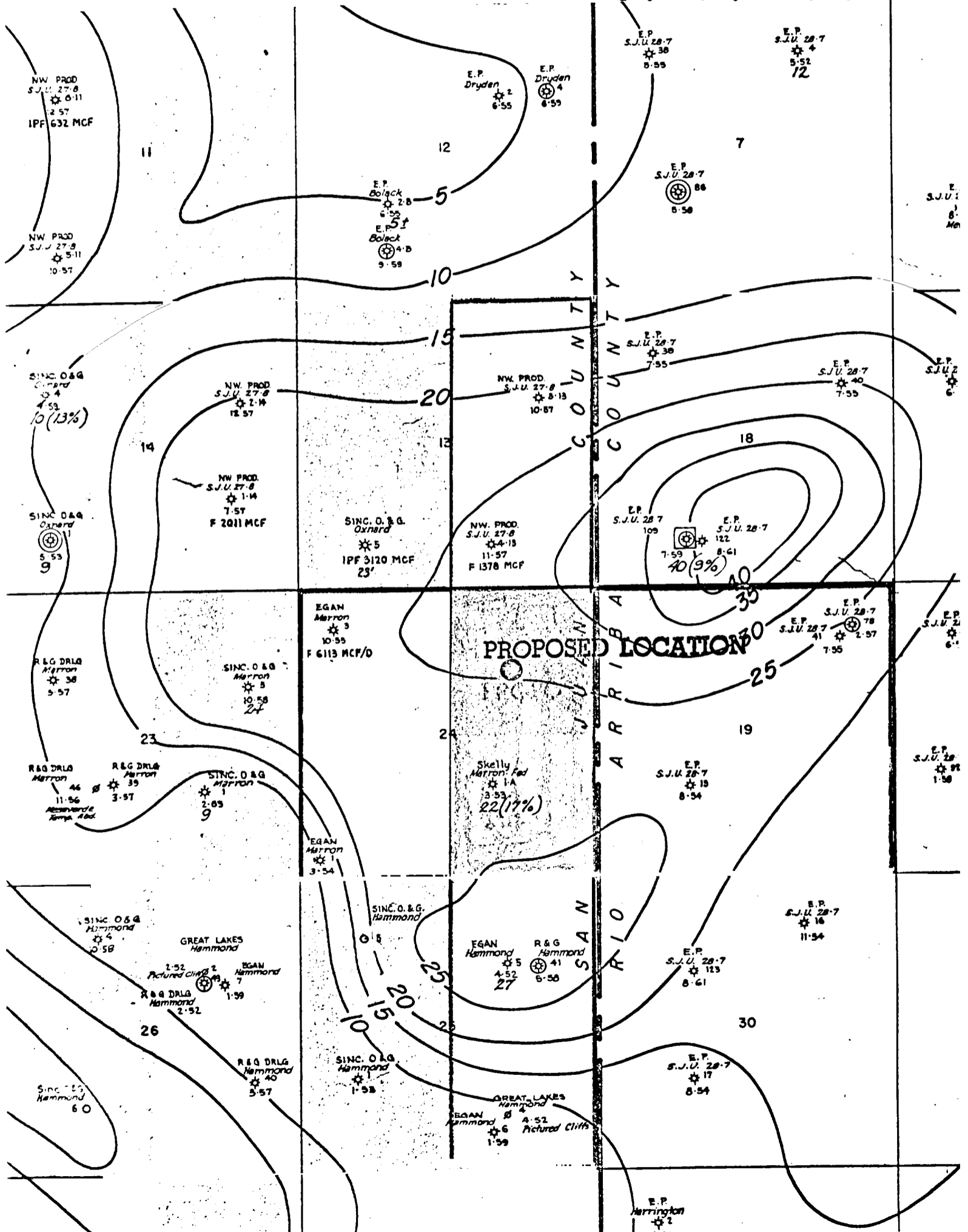



**SINCLAIR OIL & GAS COMPANY**  
501 LINCOLN TOWER BUILDING  
DENVER, COLORADO 80203

January 21, 1966

WESTERN REGION

**To: Northwest Production Corp.  
El Paso Natural Gas Co.  
Shelby Oil Co.  
John A. Egan  
R & G Drilling Co.**

**RE: Sinclair Oil & Gas Company  
Marron WN Federal, Well #6  
NE/4 Section 24-27N-8W  
San Juan County, New Mexico**

Gentlemen:

Pursuant the provisions of Rule 112-A, New Mexico Rules and Regulations, you are hereby notified of the proposed dual completion of the captioned well in the Mesaverde and Pictured Cliffs formations. For your information, the following are enclosed:

1. Copy of Form C-107, Application for Multiple Completion.
2. Plat showing the captioned location and your offset lease.
3. Sketch of proposed completion.

Very truly yours,

SINCLAIR OIL & GAS COMPANY

By F. P. Haskin  
F. P. Haskin  
Area Supervisor

Encls.

NEW MEXICO OIL CONSERVATION COMMISSION  
 SANTA FE, NEW MEXICO  
 APPLICATION FOR MULTIPLE COMPLETION

Form C-107  
 5-1-61

Operator <b>Stclair Oil &amp; Gas Company</b>		County <b>San Juan</b>		Date <b>January 21, 1946</b>
Address <b>501 Lincoln Tower Bldg., Denver, Colorado</b>		Lease <b>Western Nat'l Federal</b>	Well No. <b>6</b>	
Location of Well	Unit <b>6</b>	Section <b>24</b>	Township <b>27 North</b>	Range <b>8 West</b>

1. Has the New Mexico Oil Conservation Commission heretofore authorized the multiple completion of a well in these same pools or in the same zones within one mile of the subject well? YES **X** NO \_\_\_\_\_
2. If answer is yes, identify one such instance: Order No. **NS-2072**; Operator Lease, and Well No.: **General Well (2)**  
**June 15, 1943** **Western National Gas Co. - San Juan**

	Upper Zone	Intermediate Zone	Lower Zone
a. Name of Pool and Formation	<b>So. Blaine, Natural</b>		<b>Blaine, Natural</b>
b. Top and Bottom of Pay Section (Perforations)	<b>Top - 2975'</b> <b>Bottom - 2900'</b>		<b>Top 2800'</b> <b>Bottom 2807'</b>
c. Type of production (Oil or Gas)	<b>Gas</b>		<b>Gas</b>
d. Method of Production (Flowing or Artificial Lift)	<b>Flow through tubing</b>		<b>Flow through tubing</b>

4. The following are attached. (Please check YES or NO)

- | Yes                                 | No                       |                                                                                                                                                                                                                                                                                                                                                                                                 |
|-------------------------------------|--------------------------|-------------------------------------------------------------------------------------------------------------------------------------------------------------------------------------------------------------------------------------------------------------------------------------------------------------------------------------------------------------------------------------------------|
| <input checked="" type="checkbox"/> | <input type="checkbox"/> | a. Diagrammatic Sketch of the Multiple Completion, showing all casing strings, including diameters and setting depths, centralizers and/or turbolizers and location thereof, quantities used and top of cement, perforated intervals, tubing strings, including diameters and setting depth, location and type of packers and side door chokes, and such other information as may be pertinent. |
| <input checked="" type="checkbox"/> | <input type="checkbox"/> | b. Plat showing the location of all wells on applicant's lease, all offset wells on offset leases, and the names and addresses of operators of all leases offsetting applicant's lease.                                                                                                                                                                                                         |
| <input checked="" type="checkbox"/> | <input type="checkbox"/> | c. Waivers consenting to such multiple completion from each offset operator, or in lieu thereof, evidence that said offset operators have been furnished copies of the application.*                                                                                                                                                                                                            |
| <input checked="" type="checkbox"/> | <input type="checkbox"/> | d. Electrical log of the well or other acceptable log with tops and bottoms of producing zones and intervals of perforation indicated thereon. (If such log is not available at the time application is filed it shall be submitted as provided by Rule 112-A.)                                                                                                                                 |

5. List all offset operators to the lease on which this well is located together with their correct mailing address. **(Added to below)**  
**(Listed Quarterly)**  
**(January 21, 1946)**
- North - Northwest Production Corporation, Box 1736, El Paso, Texas**
- East - El Paso Natural Gas Company, Box 996, Farmington, New Mexico**
- South - Shelly Oil Company, Box 4115, Station A, Albuquerque, New Mexico**
- South - John A. Ryan, Box 236, Farmington, New Mexico**
- South - B & G Drilling Co., Inc., Box 327, Farmington, New Mexico**
- West - John A. Ryan, Box 236, Farmington, New Mexico**

6. Were all operators listed in Item 5 above notified and furnished a copy of this application? YES **X** NO \_\_\_\_\_. If answer is yes, give date of such notification **January 21, 1946**.

CERTIFICATE: I, the undersigned, state that I am the **Area Supervisor** of the **Stclair Oil & Gas Company** (company), and that I am authorized by said company to make this report; and that this report was prepared under my supervision and direction and that the facts stated therein are true, correct and complete to the best of my knowledge.

**F. F. English**  
 Signature

\*Should waivers from all offset operators not accompany an application for administrative approval, the New Mexico Oil Conservation Commission will hold the application for a period of twenty (20) days from date of receipt by the Commission's Santa Fe office. If, after said twenty-day period, no protest nor request for hearing is received by the Santa Fe office, the application will then be processed.

NOTE: If the proposed multiple completion will result in an unorthodox well location and/or a non-standard proration unit in one or more of the producing zones, then separate application for approval of the same should be filed simultaneously with this application.

SINCLAIR OIL & GAS COMPANY

MARRON WN FEDERAL  
Well No. 6  
NE/4 Section 24-27N-8W  
San Juan County

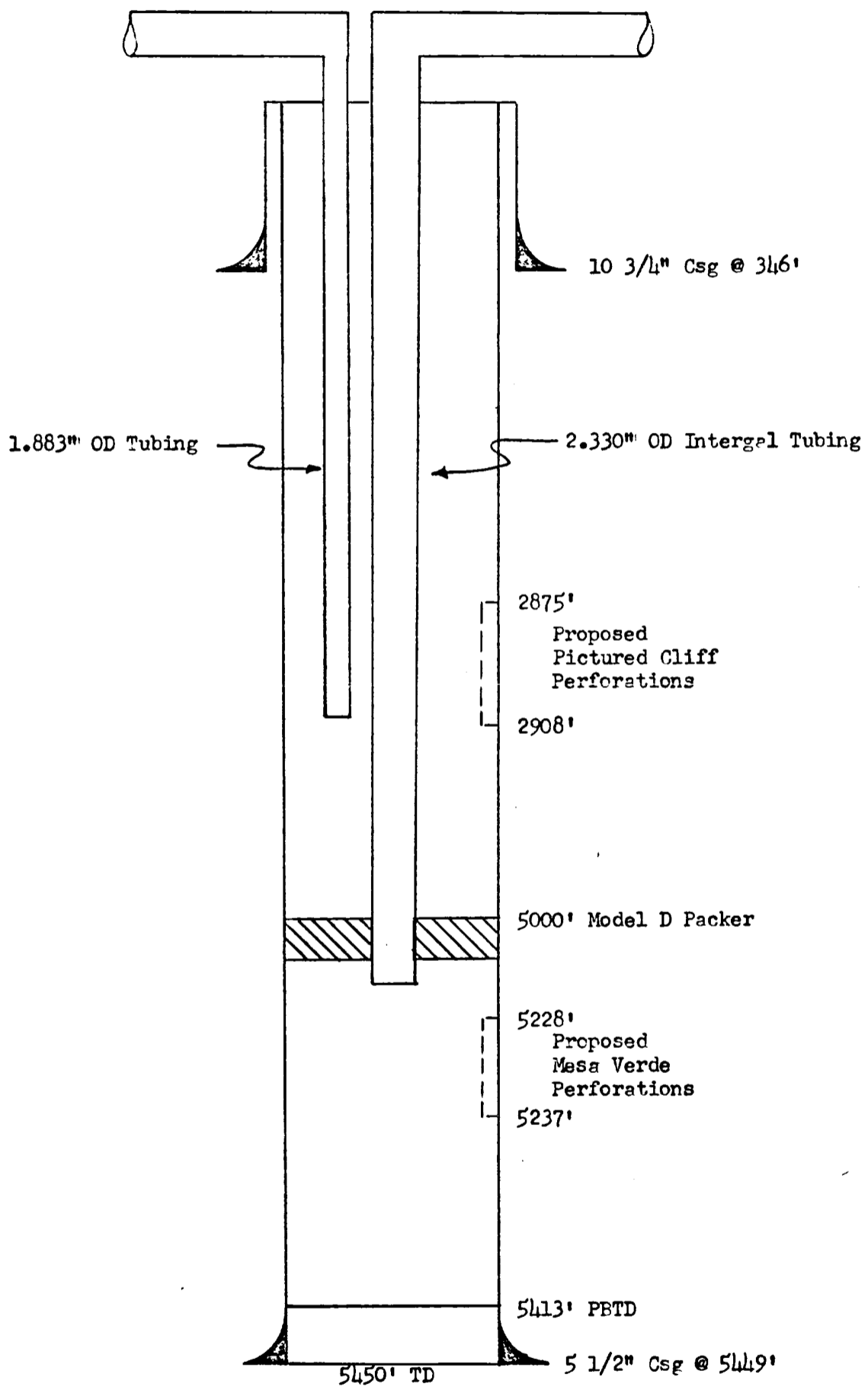

SINCLAIR OIL & GAS COMPANY

MARRON WN FEDERAL  
Well No. 6  
NE/4 Section 24-27N-8W  
San Juan County

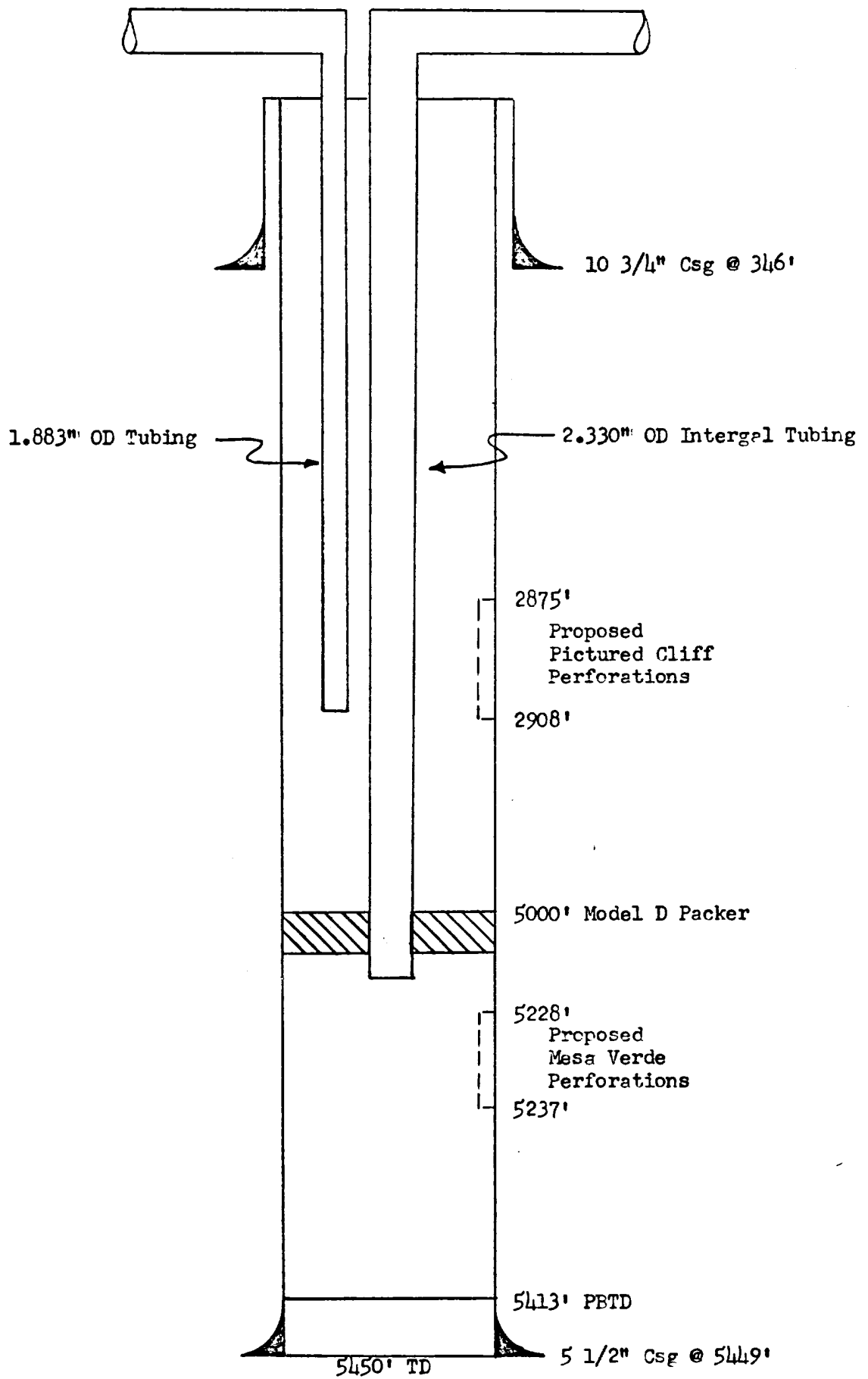

SINCLAIR OIL & GAS COMPANY

MARRON WN FEDERAL  
 Well No. 6  
 NE/4 Section 24-27N-8W  
 San Juan County

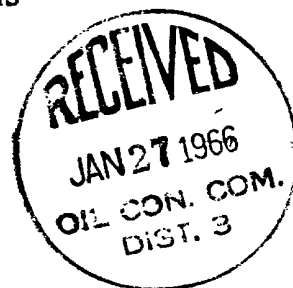
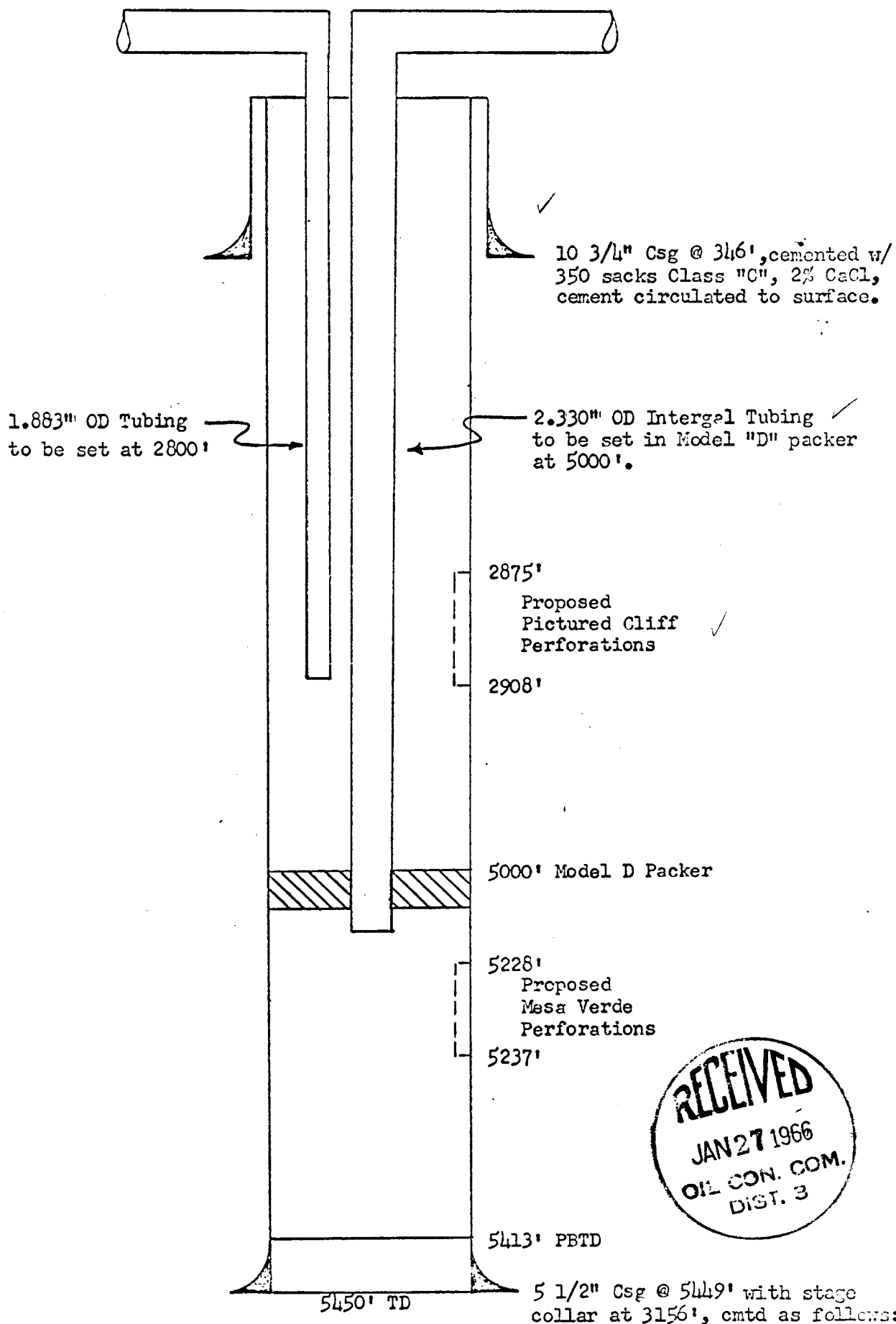

Completed 1st stage with 300 sx Class "C", 4% gel, 1/8# Celoflake/sack, Pumped plug to 5413'.  
 Completed 2nd stage with 200 sx Class "C", 4% gel, 1/8# Celoflake/sack. Cement top log has  
 not been run, but will be run when completion operations are started. All zones not properly  
 perforated will be perforated and recemented. Theoretical fill-up 5-1/2" OD 15.5# casing in  
 5-7/8" hole: 1st stage: 2001' f/ 5450' to 3449'  
 2nd stage: 1274' f/ 3156' to 1882'.