

OIL CONSERVATION COMMISSION  
3 DISTRICT

OIL CONSERVATION COMMISSION  
BOX 871  
SANTA FE, NEW MEXICO

DATE 1-7-68

Re: Proposed NSP \_\_\_\_\_

Proposed NWU \_\_\_\_\_

Proposed NSL ✓ \_\_\_\_\_

Proposed NFO \_\_\_\_\_

Proposed DC \_\_\_\_\_

Gentlemen:

I have examined the application dated \_\_\_\_\_  
for the Truneco Co. Schweitzer A #4 SE 31-28N-8W  
Operator Lease and Well No. S-T-R

and my recommendations are as follows:

to pay as per contract and approve  
\_\_\_\_\_  
\_\_\_\_\_  
\_\_\_\_\_  
\_\_\_\_\_

Yours very truly,

Ernest C. Jones



TENNECO OIL COMPANY • P. O. BOX 1714 • 835 SECOND AVENUE • DURANGO, COLORADO 81302

January 3, 1966

C  
Secretary Director  
New Mexico Oil Conservation Comm.  
P. O. Box 2088  
Santa Fe, New Mexico

Dear Sir:

O  
Re: Unorthodox Location  
Schwerdtfeger "A" #4  
1190' FSL, 660' FEL  
Section 31, T-28-N, R-8-W  
San Juan County, New Mexico

P  
Application is hereby made under NMOCC Rule 3A, Well Location,  
for unorthodox location in the Dakota formation on the above well  
because of topography. (See attached plat.)

Y  
A copy of this letter will be forwarded to the offset operators:  
El Paso Natural Gas Company, P. O. Box 990, Farmington, New Mexico;  
Pan American Petroleum Corporation, P. O. Box 480, Farmington; and  
Skelly Oil Company, P. O. Box 38, Hobbs, New Mexico.

Very truly yours,

TENNECO OIL COMPANY

*R. E. Siverson*  
R. E. Siverson  
District Production Superintendent

HCN:nw

Attach.

CC: New Mexico Oil Conservation Comm. - Aztec ✓  
J. D. Moon - Tenneco - Midland  
El Paso Natural Gas Company - Farmington  
Pan American Petroleum Corp. - Farmington  
Skelly Oil Company - Hobbs

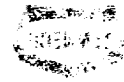

THE UNIVERSITY OF CHICAGO LIBRARY

CHICAGO, ILL.

THE UNIVERSITY OF CHICAGO LIBRARY  
540 EAST 57TH STREET  
CHICAGO, ILL. 60637

1978

THE UNIVERSITY OF CHICAGO LIBRARY  
540 EAST 57TH STREET  
CHICAGO, ILL. 60637  
1978

THE UNIVERSITY OF CHICAGO LIBRARY  
540 EAST 57TH STREET  
CHICAGO, ILL. 60637

THE UNIVERSITY OF CHICAGO LIBRARY  
540 EAST 57TH STREET  
CHICAGO, ILL. 60637

CHICAGO, ILL.

CHICAGO, ILL.

CHICAGO, ILL.

CHICAGO, ILL.

1978

1978

THE UNIVERSITY OF CHICAGO LIBRARY  
540 EAST 57TH STREET  
CHICAGO, ILL. 60637  
1978

NEW MEXICO OIL CONSERVATION COMMISSION  
WELL LOCATION AND ACREAGE DEDICATION PLAT

Form O-112  
Supersedes O-128  
Effective 1-1-65

All distances must be from the outer boundaries of the Section

TENNECO OIL COMPANY			Lease <b>SCHWERTFEOER "A"</b>		Well No. <b>4</b>
Tract Letter <b>P</b>	Section <b>31</b>	Range <b>28 North</b>	Range <b>8 West</b>	County <b>San Juan</b>	
Actual Location of Well:					
<b>1190</b>	feet from the	<b>South</b>	line and	<b>660</b>	feet from the <b>East</b>
Ground Level Elev. <b>6703' ungraded</b>	Producing Formation <b>Basin Dakota</b>		Pool <b>Basin Dakota</b>		Dedicated Acreage: <b>E/2</b> <b>320</b> Acres

1. Outline the acreage dedicated to the subject well by colored pencil or hachure marks on the plat below.
2. If more than one lease is dedicated to the well, outline each and identify the ownership thereof (both as to working interest and royalty).
3. If more than one lease of different ownership is dedicated to the well, have the interests of all owners been consolidated by communization, unitization, force-pooling, etc?

☐ Yes ☐ No If answer is "yes," type of consolidation \_\_\_\_\_

If answer is "no," list the owners and tract descriptions which have actually been consolidated (Use reverse side of this form if necessary.) \_\_\_\_\_

No allowable will be assigned to the well until all interests have been consolidated (by communization, unitization, forced-pooling, or otherwise) or until a non-standard unit, eliminating such interests, has been approved by the Commission.

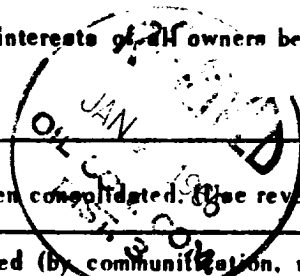

**CERTIFICATION**

I hereby certify that the information contained herein is true and complete to the best of my knowledge and belief.

*Harold C. Nichols*  
Name **Harold C. Nichols**  
Position **Sr. Production Clerk**  
Company **Tenneco Oil Company**  
Date **December 7, 1965**

I hereby certify that the well location shown on this plat was plotted from field notes of actual surveys made by me or under my supervision, and that the same is true and correct to the best of my knowledge and belief.

Date Surveyed  
**3 December 1965**  
Registered Professional Engineer and/or Land Surveyor  
*Robert H. Ernst*  
**ROBERT H. ERNST**  
Certificate No.  
**N. Mex. PE & LS 2463**

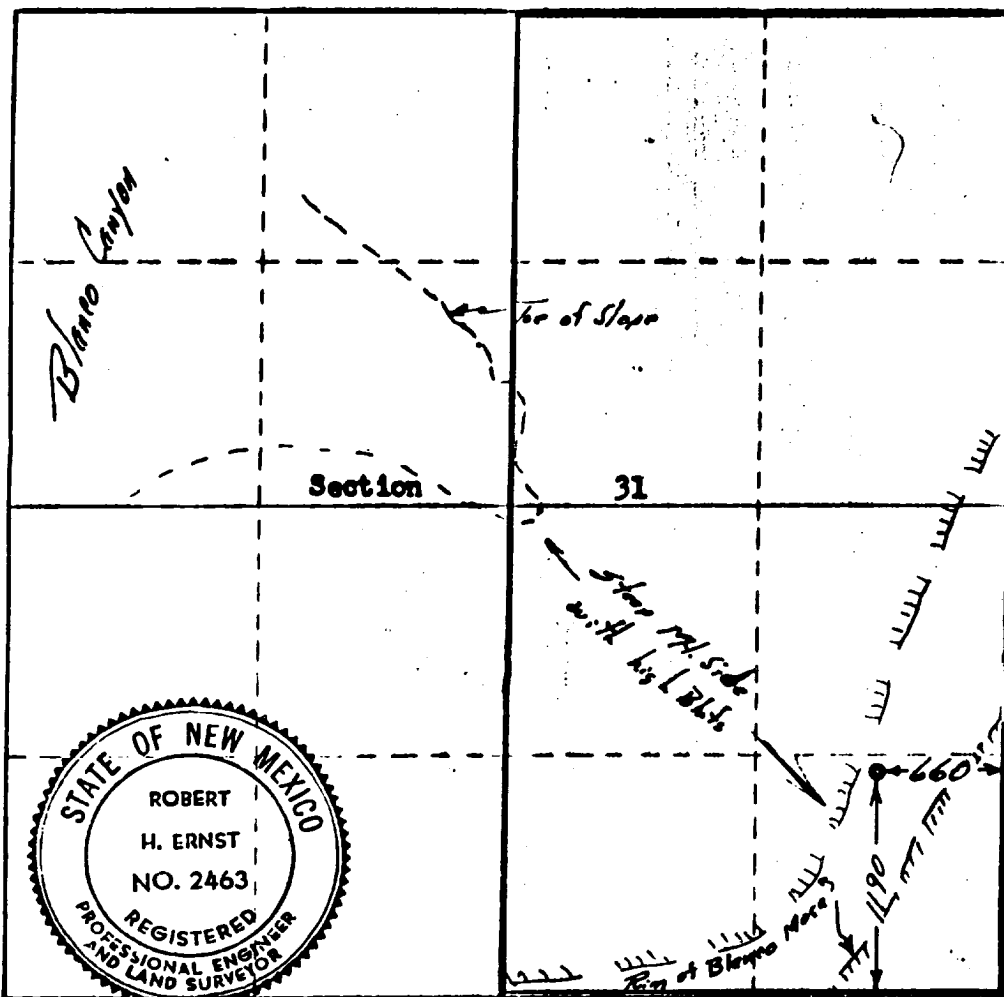

0 320 640 960 1280 1600 1920 2240 2560 2880 3200 3520 3840 4160 4480 4800 5120 5440 5760 6080 6400 6720 7040 7360 7680 8000 8320 8640 8960 9280 9600 9920 10240 10560 10880 11200 11520 11840 12160 12480 12800 13120 13440 13760 14080 14400 14720 15040 15360 15680 16000 16320 16640 16960 17280 17600 17920 18240 18560 18880 19200 19520 19840 20160 20480 20800 21120 21440 21760 22080 22400 22720 23040 23360 23680 24000 24320 24640 24960 25280 25600 25920 26240 26560 26880 27200 27520 27840 28160 28480 28800 29120 29440 29760 30080 30400 30720 31040 31360 31680 32000 32320 32640 32960 33280 33600 33920 34240 34560 34880 35200 35520 35840 36160 36480 36800 37120 37440 37760 38080 38400 38720 39040 39360 39680 40000 40320 40640 40960 41280 41600 41920 42240 42560 42880 43200 43520 43840 44160 44480 44800 45120 45440 45760 46080 46400 46720 47040 47360 47680 48000 48320 48640 48960 49280 49600 49920 50240 50560 50880 51200 51520 51840 52160 52480 52800 53120 53440 53760 54080 54400 54720 55040 55360 55680 56000 56320 56640 56960 57280 57600 57920 58240 58560 58880 59200 59520 59840 60160 60480 60800 61120 61440 61760 62080 62400 62720 63040 63360 63680 64000 64320 64640 64960 65280 65600 65920 66240 66560 66880 67200 67520 67840 68160 68480 68800 69120 69440 69760 70080 70400 70720 71040 71360 71680 72000 72320 72640 72960 73280 73600 73920 74240 74560 74880 75200 75520 75840 76160 76480 76800 77120 77440 77760 78080 78400 78720 79040 79360 79680 80000 80320 80640 80960 81280 81600 81920 82240 82560 82880 83200 83520 83840 84160 84480 84800 85120 85440 85760 86080 86400 86720 87040 87360 87680 88000 88320 88640 88960 89280 89600 89920 90240 90560 90880 91200 91520 91840 92160 92480 92800 93120 93440 93760 94080 94400 94720 95040 95360 95680 96000 96320 96640 96960 97280 97600 97920 98240 98560 98880 99200 99520 99840 100000

UNITED STATES  
DEPARTMENT OF THE INTERIOR  
GEOLOGICAL SURVEYSUBMIT IN TRIPPLICATE\*  
(Other instructions on re-  
verse side)Form approved.  
Budget Bureau No. 42-1-24.  
5. LEASE DESIGNATION AND SERIAL NO.

SF 079319

6. IF INDIAN, ALLOTTEE OR TRIBE NAME

7. UNIT AGREEMENT NAME

8. FARM OR LEASE NAME

Schwerdtfeger "A"

9. WELL NO.

4

10. FIELD AND POOL, OR WILDCAT

Basin Dakota

11. SEC., T., R., M., OR BLK. AND  
SURVEY OR AREA

Sec. 31, T-28-N, R-8-W

12. COUNTY OR PARISH

San Juan

13. STATE  
New MexicoSUNDRY NOTICES AND REPORTS ON WELLS  
(Do not use this form for proposals to drill or to deepen or plug back to a different reservoir.  
Use "APPLICATION FOR PERMIT—" for such proposals.)1. OIL WELL ☐ GAS WELL ☒ OTHER

2. NAME OF OPERATOR

Tenneco Oil Company

3. ADDRESS OF OPERATOR

P.O. Box 1714 - Durango, Colorado

4. LOCATION OF WELL (Report location clearly and in accordance with any State requirements.\*  
See also space 17 below.)  
At surface

1190' FSL, 660' FEL

14. PERMIT NO.

15. ELEVATIONS (Show whether DF, RT, GR, etc.)

6703' GR

## 16. Check Appropriate Box To Indicate Nature of Notice, Report, or Other Data

## NOTICE OF INTENTION TO:

TEST WATER SHUT-OFF ☐FRACTURE TREAT ☐SHOOT OR ACIDIZE ☐REPAIR WELL ☐(Other) ☐PULL OR ALTER CASING ☐MULTIPLE COMPLETE ☐ABANDON\* ☐CHANGE PLANS ☐

## SUBSEQUENT REPORT OF

WATER SHUT-OFF ☐FRACTURE TREATMENT ☒SHOOTING OR ACIDIZING ☒(Other) ☐REPAIRING WELL ☐ALTERING CASING ☐ABANDONMENT\* ☐(NOTE: Report results of multiple completion on Well  
Completion or Recompletion Report and Log.)

17. DESCRIBE PROPOSED OR COMPLETED OPERATIONS (Clearly state all pertinent details, and give pertinent dates, including estimated date of starting and proposed work. If well is directionally drilled, give subsurface locations and measured and true vertical depths for all marks and zones pertinent to this work.)\*

Moved in completion rig 2-16-66. Drilled stage collar at 5350'. Cleaned out to 7568'. Ran IES log to 7540', ran Caliper log to 7537'. Ran 2 1/2" joints 2-7/8" 6.4 J-55 seal lock tubing and cemented with 150 sacks cement set at 7585'. WOC. Temperature Survey shows cement top at 6640'. Tested casing to 14,000#. Backed off safety joint at 6632'. Pulled 2-7/8" tubing. Pulled 211 joints tubing. Left 953' of 2-7/8" tubing in hole (liner). Cemented leak in liner at 6632' with 100 sacks cement. Re-cemented liner with 50 sacks. Reversed out 5 sacks cement.

Tested casing and liner to 4,000# OK. Cleaned out to 7553' PBTD. Perf 4 holes per foot 7310 - 7337. Frac perfs with 50,000 gallons water and 35,000 lbs. sand. Perf 4 holes per foot 7334 - 7344'. Re-perf 4 holes per foot 7334-7344, 40 holes. Acidized perfs with 500 gallons acid. Frac perfs with 50,000 gallons water and 40,000 lbs. sand. Cleaned out to 7553'. Ran 209 joints 2-3/8" EUE tubing set at 6615'. Set tree. Job complete 3-5-66. Well flowed 4533 MCFD.

RECEIVED  
MAR 11 1966  
OIL CON. COM.  
DIST. 3

RECEIVED

MAR 10 1966

18. I hereby certify that the foregoing is true and correct.

SIGNED

Harold C. Nichols

TITLE

Senior Production Engineer, DATE March 8, 1966

(This space for Federal or State office use)

APPROVED BY  
CONDITIONS OF APPROVAL, IF ANY:

TITLE

DATE

## Distribution:

5 - USGS  
1 - Continental  
1 - File

\*See Instructions on Reverse Side