

04

District I	State Of New Mexico	SUBMIT 1 COPY TO
P.O. Box 1980, Hobbs, NM	Energy, Minerals and Natural Resources Department	APPROPRIATE
District II		DISTRICT OFFICE
P.O. Drawer, Artesia, NM 88211	OIL CONSERVATION DIVISION	AND 1 COPY TO
District III	P.O. Box 2088	SANTA FE OFFICE
1000 Rio Brazos Rd. Aztec, NM 87410	Santa Fe, New Mexico 87504-2088	(Revised 3/9/94)
OIL CON. DIV. DIST. 3		
PIT REMEDIATION AND CLOSURE REPORT		

Operator:	Conoco Inc.		Telephone:	505-324-5813				
Address:	3315 Bloomfield Hwy - Farmington, NM 87401							
Facility Or:	Johnston A #1							
Well Name								
Location:	Unit or Qtr/Qtr Sec	P	Sec	17 T	28N R	9W	County	San Juan
Pit Type:	Separator	Dehydrator		Other		BDP		
Land Type:	BLM	State	X	Fee	Other			
Pit Location: (Attach diagram)	Pit dimension:		length	10'	width	10'	depth	2'
	Reference:		wellhead	X	other			
	Footage from reference:		108'					
	Direction from reference:			Degrees		East	X	Northwest
						West		South

Depth To Ground Water:	Less than 50 feet	(20 points)	
(Vertical distance from	50 feet to 9 feet	(10 points)	
contaminants to seasonal	Greater than 100 feet	(0 points)	
high water elevation of			
ground water)	Total		0
Wellhead Protection Area:	Yes (20 points)		
(Less than 200 feet from a private	No (0 points)		
domestic water source, or; less than			
1000 feet from all other water sources)	Total		0
Distance To Surface Water:	Less than 200 feet	(20 points)	(20 points)
(Horizontal distance to perennial	200 feet to 1000 feet	(10 points)	(10 points)
lakes, ponds, rivers, streams, creeks,	Greater than 1000 feet	(0 points)	(0 points)
irrigation canals and ditches)			
	Total		0
	RANKING SCORE (TOTAL POINTS):		0

Date Remediation Started: _____		Date Completed: _____	
Remediation Method: (Check all appropriate sections)	Excavation: _____	Approx. cubic yards _____	
	Landfarm _____	Insitu Bioremediation _____	
	Other _____		
Remediation Location:	Onsite _____	Offsite _____	
(ie. landfarmed onsite, name and location of offsite facility)			
General Description Of Remedial Action: _____			
One sample was taken at 3' below bottom of pit center. No PID reading was conducted on location. Sample was transported to laboratory for TPH analysis per EPA Method 8015 and for BTEX analysis per EPA Method 8020A			
Ground Water Encountered:	No <input checked="" type="checkbox"/> Yes <input type="checkbox"/>	Depth _____	
Final Pit:	Sample location	Bottom of pit - center	
Closure Sampling:			
(if multiple samples attach sample results and diagram of sample locations and depths)	Sample depth	3'	
	Sample date	3/31/99	Sample time 12:00 p.
	Sample Results		
	Benzene (ppm)	0.238	
	Total BTEX (ppm)	2.49	
	Field headspace (ppm)	None	
	TPH	3.2	
Ground Water Sample:	Yes <input type="checkbox"/> No <input checked="" type="checkbox"/>	(If yes, attach sample results)	
I HEREBY CERTIFY THAT THE INFORMATION ABOVE IS TRUE AND COMPLETE TO THE BEST OF MY KNOWLEDGE AND BELIEF			
DATE	6/28/99	PRINTED NAME	Shirley EBent
SIGNATURE	Shirley EBent	AND TITLE	Steam Spec.

Lease Name: JOHNSTON A #1 Operator: LC Robinson Date: 3/93

Site Security
(Indicate North)

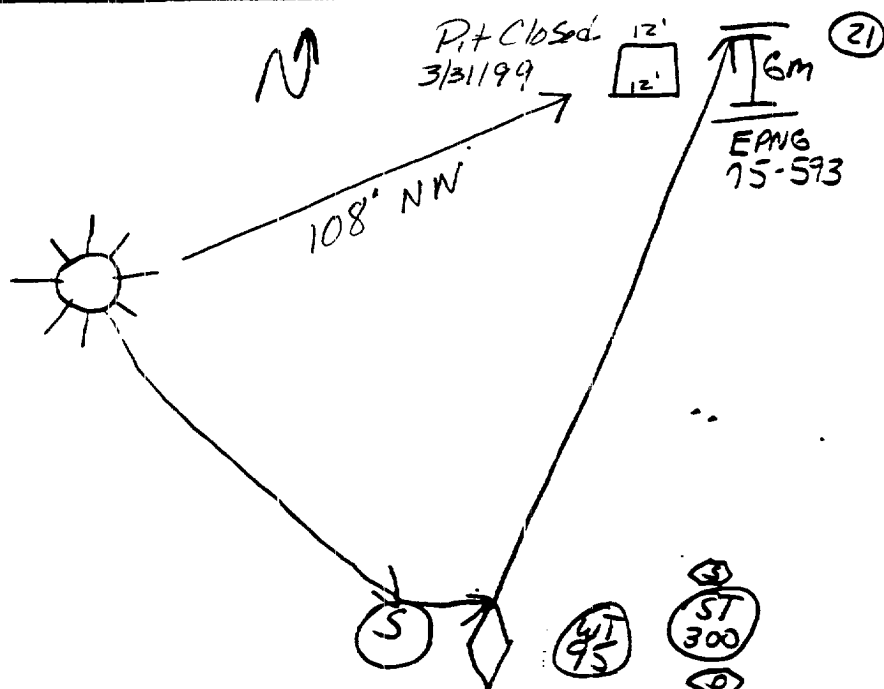

28N-9W-17

Lease Name: Johnston A 1

Federal/ Indian Lease No: NM 04202

CA No.: NA

Unit: P

Legal Description: Sect: 17 TP: 28N R: 9W

County: San Juan, NM

Load line valves :
Sealed during Production

Drain line valves :
Sealed during Production

Production Line valve:
Sealed during sales

This lease is subject to the site security plan for
San Juan Basin Operations. The plan is located at:
Conoco Inc.
3315 Bloomfield Hwy
Farmington, NM

6770

[illegible]

1. The first part of the document is a list of the names of the persons who have been appointed to the various positions of the Board of Directors of the Corporation.

2. The second part of the document is a list of the names of the persons who have been appointed to the various positions of the Board of Directors of the Corporation.

3. The third part of the document is a list of the names of the persons who have been appointed to the various positions of the Board of Directors of the Corporation.

4. The fourth part of the document is a list of the names of the persons who have been appointed to the various positions of the Board of Directors of the Corporation.

Client:Conoco, Inc.

Sample ID:BDP

Laboratory Number:E933

Chain of Custody No:6770

Sample Matrix:Soil

Preservative:Cool

Condition:Cool and Intact

Project #:707003

Date Reported:04-02-99

Date Sampled:03-31-99

Date Received:04-01-99

Date Extracted:04-02-99

Date Analyzed:04-02-99

Analysis Requested:8015 TPH

Parameter	Concentration (mg/Kg)	Det. Limit (mg/Kg)
Gasoline Range (C5 - C10)	3.2	0.2
Diesel Range (C10 - C28)	ND	0.1
Total Petroleum Hydrocarbons	3.2	0.2

ND - Parameter not detected at the stated detection limit.

References:

Method 8015B, Nonhalogenated Volatile Organics, Test Methods for Evaluating Solid Waste, SW-846, USEPA, December 1996.

Comments:

Johnston A #1.

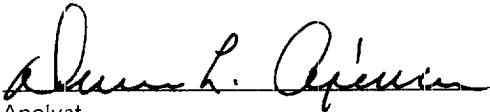

Analyst

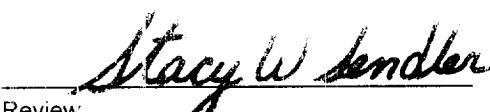

Review

Client:	Conoco, Inc.	Project #:	707003
Sample ID:	BDP	Date Reported:	04-02-99
Laboratory Number:	E933	Date Sampled	03-31-99
Chain of Custody:	6770	Date Received:	04-01-99
Sample Matrix:	Soil	Date Analyzed:	04-02-99
Preservative:	Cool	Date Extracted:	04-02-99
Condition:	Cool & Intact	Analysis Requested:	BTEX

Parameter	Concentration (ug/Kg)	Det. Limit (ug/Kg)
Benzene	238	8.8
Toluene	523	8.4
Ethylbenzene	797	7.6
p,m-Xylene	729	10.8
o-Xylene	199	5.2
Total BTEX	2,490	

ND - Parameter not detected at the stated detection limit.

Surrogate Recoveries:	Parameter	Percent Recovery
	Trifluorotoluene	98 %
	Bromofluorobenzene	98 %

References: Method 5030B, Purge-and-Trap, Test Methods for Evaluating Solid Waste, SW-846, USEPA, December 1996.

 Method 8021B, Aromatic Volatile Organics, Test Methods for Evaluating Solid Waste, SW-846, USEPA, December 1996.

Comments: Johnston A #1.

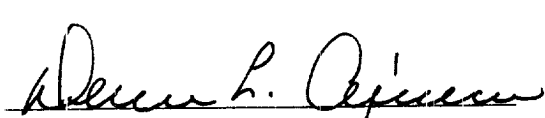
Analyst

Review

CHAIN OF CUSTODY RECORD

6770

Client / Project Name <i>Conoco Inc</i>			Project Location <i>Johnston A#1</i>		ANALYSIS / PARAMETERS							
Sampler: <i>Danny Roberts</i>			Client No: <i>97070-03</i> <i>Non Vulnerable Area</i>			No. of Containers				Remarks		
Sample No/ Identification	Sample Date	Sample Time	Lab Number	Sample Matrix	<input checked="" type="checkbox"/>	<i>BTEX</i>	<input checked="" type="checkbox"/>	<i>TPH</i>				
<i>BBP</i>	<i>3/31/99</i>	<i>12:00pm</i>	<i>E933</i>	<i>Soil</i>	<input checked="" type="checkbox"/>	<input checked="" type="checkbox"/>	<input checked="" type="checkbox"/>					
Relinquished by: (Signature) <i>[Signature]</i>			Date <i>3/31/99</i>	Time <i>2:30pm</i>	Received by: (Signature) <i>Shirley Hunt</i>			Date <i>3/31/99</i>	Time <i>2:30pm</i>			
Relinquished by: (Signature) <i>Shirley Hunt</i>			Date <i>4/1/99</i>	Time <i>12:25pm</i>	Received by: (Signature) <i>Shirley D. McNally</i>			Date <i>4/1/99</i>	Time <i>12:20pm</i>			
Relinquished by: (Signature)					Received by: (Signature)							
<div>ENVIROTECH INC.</div> <div>5796 U.S. Highway 64 Farmington, New Mexico 87401 (505) 632-0615</div>												
Sample Receipt												
										Y	N	N/A
Received Intact										<input checked="" type="checkbox"/>		
Cool - Ice/Blue Ice										<input checked="" type="checkbox"/>		