

(SUBMIT IN TRIPLICATE)

UNITED STATES
DEPARTMENT OF THE INTERIOR
GEOLOGICAL SURVEY

Land Office Santa Fe
Lease No. SP-077306
Unit USA E. J. Johnson
Gas Unit

SUNDRY NOTICES AND REPORTS ON WELLS

NOTICE OF INTENTION TO DRILL	<input checked="" type="checkbox"/>	SUBSEQUENT REPORT OF WATER SHUT-OFF	<div style="text-align: center;"> RECEIVED NOV 13 1959 U. S. GEOLOGICAL SURVEY FARMINGTON, NEW MEXICO </div>
NOTICE OF INTENTION TO CHANGE PLANS	<input type="checkbox"/>	SUBSEQUENT REPORT OF SHOOTING OR ACIDIZING	
NOTICE OF INTENTION TO TEST WATER SHUT-OFF	<input type="checkbox"/>	SUBSEQUENT REPORT OF ALTERING CASING	
NOTICE OF INTENTION TO RE-DRILL OR REPAIR WELL	<input type="checkbox"/>	SUBSEQUENT REPORT OF RE-DRILLING OR REPAIR	
NOTICE OF INTENTION TO SHOOT OR ACIDIZE	<input type="checkbox"/>	SUBSEQUENT REPORT OF ABANDONMENT	
NOTICE OF INTENTION TO PULL OR ALTER CASING	<input type="checkbox"/>	SUPPLEMENTARY WELL HISTORY	
NOTICE OF INTENTION TO ABANDON WELL	<input type="checkbox"/>		

(INDICATE ABOVE BY CHECK MARK NATURE OF REPORT, NOTICE, OR OTHER DATA)

USA E. J. Johnson Gas Unit

Farmington, New Mexico November 17 19 59

Well No. 1 is located 1650 ft. from N line and 670 ft. from E line of sec. 21

NE 1/4 of Section 21
(1/4 Sec. and Sec. No.)

T-27-N
(Twp.)

R-10-W
(Range)

T.14.P.M.
(Meridian)

Angelo Peak Dakota
(Field)

San Juan
(County or Subdivision)

New Mexico
(State or Territory)

The elevation of the derrick floor above sea level is _____ ft. (To be reported later.)

DETAILS OF WORK

(State names of and expected depths to objective sands; show sizes, weights, and lengths of proposed casings; indicate mudding jobs, cementing points, and all other important proposed work)

We propose to drill the above well to an approximate depth of 6500' with rotary tools to evaluate Dakota prospects. Stimulation and completion will be as indicated upon reaching total depth. The following casing program is proposed:

SIZE	DEPTH	CEMENT	REMARKS
9-5/8"	350'	—	Neat - circulate.
4-1/2"	6500'	—	Casing will be cemented in 2 stages. First stage 6% gel followed by 100 sacks neat or sufficient to fill 500' above top of Gallup. Second stage 4% gel with DV tool set approximately 100' below Pictured Cliffs and sufficient cement to fill 200 to 300' above Pictured Cliffs.

A copy of any survey taken will be submitted upon completion of well. Copies of location plate attached.

I understand that this plan of work must receive approval in writing by the Geological Survey before operations may be commenced.

Company Pan American Petroleum Corporation

Address Box 487

Farmington, New Mexico

Attn: L. O. Speer, Jr.

ORIGINAL SIGNED BY
R. M. Bauer, Jr.

By

Area Engineer

Title

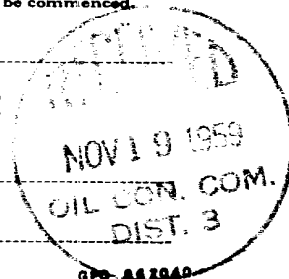

NEW MEXICO OIL CONSERVATION COMMISSION

Well Location and Acreage Dedication Plat

Section A.

Date November 16, 1959

Operator PAN AMERICAN PETROLEUM CORPORATION Lease USA E. J. JOHNSON GAS UNIT
 Well No. 1 Unit Letter H Section 21 Township 27 NORTH Range 10 WEST NMPM
 Located 1650 Feet From the NORTH Line 870 Feet From the EAST Line
 County SAN JUAN G. L. Elevation * Dedicated Acreage 320 Acres
 Name of Producing Formation Dakota Pool Angels Peak Dakota

1. Is the Operator the only owner in the dedicated acreage outlined on the plat below?
 Yes No X *To be reported later
2. If the answer to question one is "no", have the interests of all the owners been consolidated by communitization agreement or otherwise? Yes X No If answer is "yes", Type of Consolidation.

Jointly owned acreage

3. If the answer to question two is "no", list all the owners and their respective interests below:

Owner

Land Description



Section B.

Note: All distances must be from outer boundaries of section.

This is to certify that the information in Section A above is true and complete to the best of my knowledge and belief.

Pan American Petroleum Corporation
 (Operator)

R. M. Bauer, Jr. R.M. Bauer, Jr.
 (Representative)

Box 487, Farmington, N. Mex.
 (Address)

Ref: GLO plat dated 19 July 1915

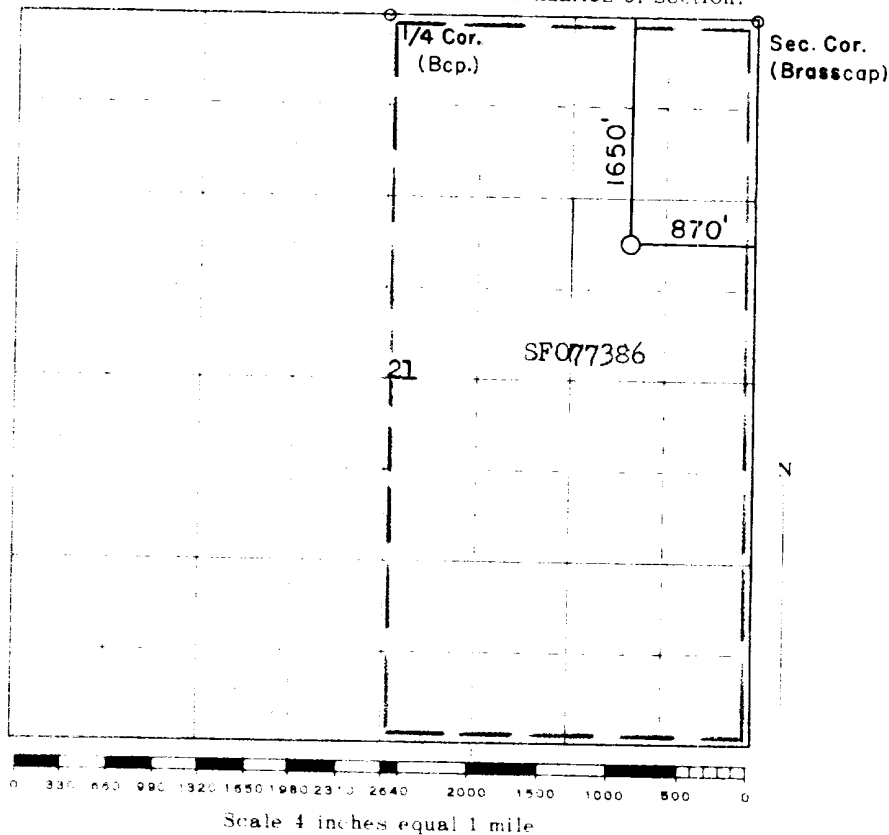

Scale 4 inches equal 1 mile



(Seal)

Farmington, New Mexico

This is to certify that the above plat was prepared from field notes of actual surveys made by me or under my supervision and that the same are true and correct to the best of my knowledge and belief.

Date Surveyed 9 November 1959

James P. Leese
 Registered Professional Engineer and/or Land Surveyor
 James P. Leese N. Mex. Reg. No. 1463