

UNITED STATES  
DEPARTMENT OF THE INTERIOR  
BUREAU OF LAND MANAGEMENT

FORM APPROVED  
Budget Bureau No. 1004-0135  
Expires: March 31, 1993

SUNDRY NOTICES AND REPORTS ON WELLS

Do not use this form for proposals to drill or to deepen or reentry to a different reservoir.  
Use "APPLICATION FOR PERMIT - " for such proposals

RECEIVED  
BLM

94 NOV 18 AM 11:52

070 FARMINGTON, NM

1. Type of Well

☐ Oil Well ☒ Gas Well ☐ Other

2. Name of Operator

AMOCO PRODUCTION COMPANY

Attention:

LOIS RAE BURN

3. Address and Telephone No.

P.O. Box 800, Denver, Colorado 80201

(303) 830-5294

4. Location of Well (Footage, Sec., T., R., M., or Survey Description)

1600FSL 940FWL

Sec. 21 T 27N R 10W L

5. Lease Designation and Serial No.

SF-077386 A

6. Indian, Allottee or Tribe Name

7. Unit or CA, Agreement Designation

8. Well Name and No.

E. J. Johnson "C" 1

9. API Well No.

3004506361

10. Field and Pool, or Exploratory Area

Dakota / Gallup

11. County or Parish, State

San Juan New Mexico

12. CHECK APPROPRIATE BOX(S) TO INDICATE NATURE OF NOTICE, REPORT, OR OTHER DATA

TYPE OF SUBMISSION	TYPE OF ACTION
<input checked="" type="checkbox"/> Notice of Intent	<input type="checkbox"/> Abandonment
<input type="checkbox"/> Subsequent Report	<input checked="" type="checkbox"/> Recompletion
<input type="checkbox"/> Final Abandonment Notice	<input type="checkbox"/> Plugging Back
	<input type="checkbox"/> Casing Repair
	<input type="checkbox"/> Altering Casing
	<input type="checkbox"/> Other Plug Back the Dakota
	<input type="checkbox"/> Change of Plans
	<input type="checkbox"/> New Construction
	<input type="checkbox"/> Non-Routine Fracturing
	<input type="checkbox"/> Water Shut-Off
	<input type="checkbox"/> Conversion to Injection
	<input type="checkbox"/> Dispose Water

(Note: Report results of multiple completion on Well Completion or Recompletion Report and Log form.)

13. Describe Proposed or Completed Operations (Clearly state all pertinent details, and give pertinent dates, including estimated date of starting any proposed work. If well is directionally drilled, give subsurface locations and measured and true vertical depths for all markers and zones pertinent to this work.)

Amoco Production Company request permission to plug back the Dakota formation and recomplete the Mesa Verde formation.

See Attached Procedures

If you should have any questions please contact Mike Kutas @ (303)830-5159

*submit a completed Well Location & Acreage Dedication Plat.*  
*1.) Signature*  
*2.) Number of acres & dedication*

SEE ATTACHED FOR  
CONDITIONS OF APPROVAL

14. I hereby certify that the foregoing is true and correct

Signed

*Lois Raeburn*

Title

Business Assistant

Date

11-14-1994

(This space for Federal or State office use)

Approved by

Conditions of approval, if any:

Title

APPROVED

DEC 07 1994

DISTRICT MANAGER

Title 18 U.S.C. Section 1001, makes it a crime for any person knowingly and willfully to make to any department or agency of the United States any false, fictitious, or fraudulent statements or representations as to any matter within its jurisdiction.

\* See Instructions on Reverse Side

OPERATOR

PO Box 1980, Hobbs, NM 88241-1980  
District II  
PO Drawer DD, Artesia, NM 88211-0712  
District III  
1000 Rio Brazos Rd., Aztec, NM 87410  
District IV  
PO Box 2088, Santa Fe, NM 87504-2088

State of New Mexico  
Energy, Minerals & Natural Resources Department

OIL CONSERVATION DIVISION  
PO Box 2088  
Santa Fe, NM 87504-2088

Hold C-104  
for NSL

Form C-102  
Revised February 21, 1994  
Instructions on back  
Submit to Appropriate District Office  
State Lease - 4 Copies  
Fee Lease - 3 Copies

JAN 13 1995 11:53

☒ AMENDED REPORT

WELL LOCATION AND ACREAGE DEDICATION PLAT

SF-077386A

API Number 3004506361		Pool Code 02170	Well Name ANGELS PEAK Gallup ASSOC - EXT
Property Code	Property Name E. J. Johnson "C"		Well Number 1
OGRID No. 000778	Operator Name Amoco Production Company		Elevation 6233' GL

10 Surface Location

UL or lot no.	Section	Township	Range	Lot Idn	Feet from the	North/South line	Feet from the	East/West line	County
L	21	27N	10W	L	1600	South	940	West	San Juan

11 Bottom Hole Location If Different From Surface

UL or lot no.	Section	Township	Range	Lot Idn	Feet from the	North/South line	Feet from the	East/West line	County

12 Dedicated Acres 160 320	13 Joint or Infill	14 Consolidation Code	15 Order No.
-------------------------------	--------------------	-----------------------	--------------

NO ALLOWABLE WILL BE ASSIGNED TO THIS COMPLETION UNTIL ALL INTERESTS HAVE BEEN CONSOLIDATED  
OR A NON-STANDARD UNIT HAS BEEN APPROVED BY THE DIVISION

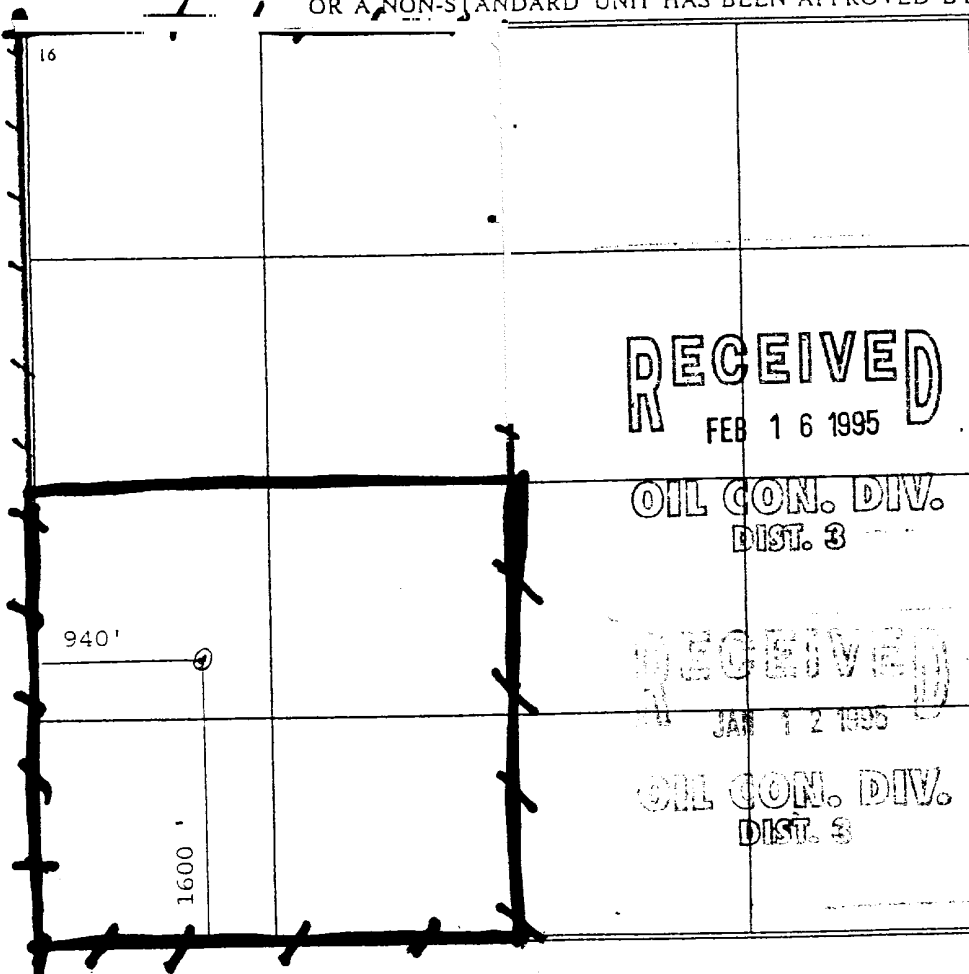

17 OPERATOR CERTIFICATION

I hereby certify that the information contained herein is true and complete to the best of my knowledge and belief

*Lois Raeburn*  
Signature

Lois Raeburn  
Printed Name

Business Assistant  
Title

11-14-94  
Date

18 SURVEYOR CERTIFICATION

I hereby certify that the well location shown on this plat was plotted from field notes of actual surveys made by me or under my supervision, and that the same is true and correct to the best of my belief.

Date of Survey 2-5-64

Signature and Seal of Professional Surveyor:

On File

**ACCEPTED FOR RECORD**  
3602

Certificate Number

JAN 09 1995

NMOCD

FARMINGTON DISTRICT OFFICE

11 2A

1944-1945

1946-1947

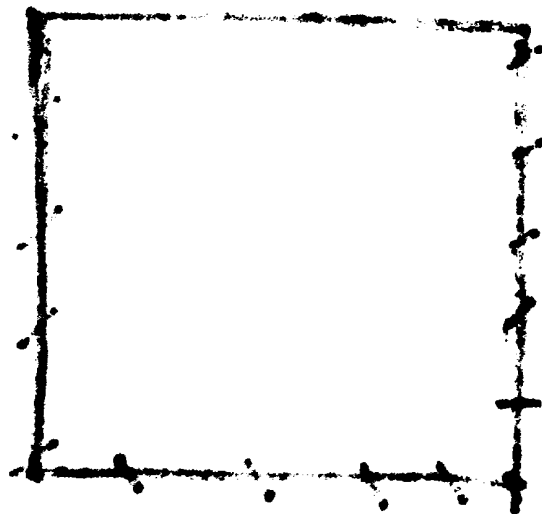

--	--	--