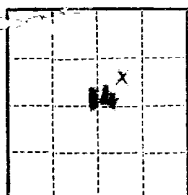

(SUBMIT IN TRIPLICATE)

UNITED STATES  
DEPARTMENT OF THE INTERIOR  
GEOLOGICAL SURVEYLand Office **Santa Fe**  
Lease No. **078094**  
Unit **Gov't. Fullerton**

## SUNDRY NOTICES AND REPORTS ON WELLS

NOTICE OF INTENTION TO DRILL.....	<b>XX</b>	SUBSEQUENT REPORT OF WATER SHUT-OFF.....
NOTICE OF INTENTION TO CHANGE PLANS.....		SUBSEQUENT REPORT OF SHOOTING OR ACIDIZING.....
NOTICE OF INTENTION TO TEST WATER SHUT-OFF.....		SUBSEQUENT REPORT OF ALTERING CASING.....
NOTICE OF INTENTION TO RE-DRILL OR REPAIR WELL.....		SUBSEQUENT REPORT OF RE-DRILLING OR REPAIR.....
NOTICE OF INTENTION TO SHOOT OR ACIDIZE.....		SUBSEQUENT REPORT OF ABANDONMENT.....
NOTICE OF INTENTION TO PULL OR ALTER CASING.....		SUPPLEMENTARY WELL HISTORY.....
NOTICE OF INTENTION TO ABANDON WELL.....		

(INDICATE ABOVE BY CHECK MARK NATURE OF REPORT, NOTICE, OR OTHER DATA)

February 8, 1961

Government Fullerton  
Well No. **8** is located **1900** ft. from **N** line and **2800** ft. from **E** line of sec. **14****SW NE Section 14**  
(1/4 Sec. and Sec. No.)**27N**  
(Twp.)**11W**  
(Range)**104PM**  
(Meridian)**West Kutz Canyon**  
(Field)**San Juan**  
(County or Subdivision)**New Mexico**  
(State or Territory)The elevation of the derrick floor above sea level is **6387** ft. Est.

## DETAILS OF WORK

(State names of and expected depths to objective sands; show sizes, weights, and lengths of proposed casings; indicate mudding jobs, cementing points, and all other important proposed work)

To drill and test subject well to the Dakota Formation. Estimated TD - **6550'**.  
Surface Casing: 8-5/8" 24# casing to be set at approx. 275' KB and cemented to surface.  
 VOC 24 hours. Production Casing: 4-1/2" 11.6# J-55 casing, with stage collar set approx. 50' below Picture Cliff. Use centralizers and scratchers thru the Dakota and Gallup Sands. Cement with 300 sack 1:1 Pozmix with 2% Gel on 1st stage and 150 sack Heat cement on 2nd stage. No coring and testing planned. Logging: Combination ES-Induction Log from TD to surface casing. Detail ES-Induction Log and Sonic or Microlog, 5200' to TD. Run Gamma Ray-Collar Log in conjunction with perforating. Drilling Time: Geolograph from 300' to TD. Drift Surveys: At 50' intervals to 300'; thereafter at 250' intervals. Standard Depth Measurements: SLM of drill pipe at approx. 300' above the Lower Gallup Zone, prior to coring, GST, and at TD. Samples: Collect 10' samples from surface to TD, or as directed by wellsite geologist.

I understand that this plan of work must receive approval in writing by the Geological Survey before operations may be commenced.

Company **The British-American Oil Producing Company**Address **P. O. Box 120****Denver, Colorado**By **Thomas M. Hogan**Title **District Superintendent**

NUMBER OF COPIES RECEIVED	
DISTRIBUTION	
SANTA FE	
FILE	
U.S.G.S.	
LAND OFFICE	
TRANSPORTER	OIL
	GAS
PRORATION OFFICE	
OPERATOR	

**NEW MEXICO OIL CONSERVATION COMMISSION**  
**WELL LOCATION AND ACREAGE DEDICATION PLAT**  
 SEE INSTRUCTIONS FOR COMPLETING THIS FORM ON THE REVERSE SIDE

FORM C-128  
 Revised 5/1/57

**SECTION A**

Operator <b>BRITISH AMERICAN OIL PRODUCING COMPANY</b>		Lease <b>FULLERTON</b>		Well No. <b>8</b>
Unit Letter <b>G</b>	Section <b>14</b>	Township <b>27 NORTH</b>	Range <b>11 WEST</b>	County <b>SAN JUAN</b>
Actual Footage Location of Well: <b>1500</b> feet from the <b>NORTH</b> line and <b>1800</b> feet from the <b>EAST</b> line				
Ground Level Elev. <b>6187.0</b>	Producing Formation <b>Dakota</b>	Pool <b>Dakota Dakota</b>	Dedicated Acreage: <b>320</b> Acres	

Ref: GLO plat dated 19 July 1915

1. Is the Operator the only owner in the dedicated acreage outlined on the plat below? YES ☒ NO ☐ ("Owner" means the person who has the right to drill into and to produce from any pool and to appropriate the production either for himself or for himself and another. (65-3-29 (e) NMSA 1935 Comp.)
2. If the answer to question one is "no," have the interests of all the owners been consolidated by communitization agreement or otherwise? YES ☐ NO ☐ . If answer is "yes," Type of Consolidation \_\_\_\_\_
3. If the answer to question two is "no," list all the owners and their respective interests below:

Owner <b>The British-American Oil Producing Company</b>	Land Description <b>N 1/2 Sec. 14-27N-11W</b> <b>San Juan County, New Mexico</b>
--	--

**CERTIFICATION**

I hereby certify that the information in SECTION A above is true and complete to the best of my knowledge and belief.

Name <b>Leo R. Stone</b>
Position <b>Field Superintendent</b>
Company <b>The British-American Oil Prod. Co.</b>
Date <b>2-9-61</b>

I hereby certify that the well location shown on the plat in SECTION B was plotted from field notes of actual surveys made by me or under my supervision, and that the same is true and correct to the best of my knowledge and belief.

Date Surveyed <b>7 February 1961</b>
Registered Professional Engineer and/or Land Surveyor <b>James P. Leese</b>
Certificate No. <b>1463</b>

**SECTION B**

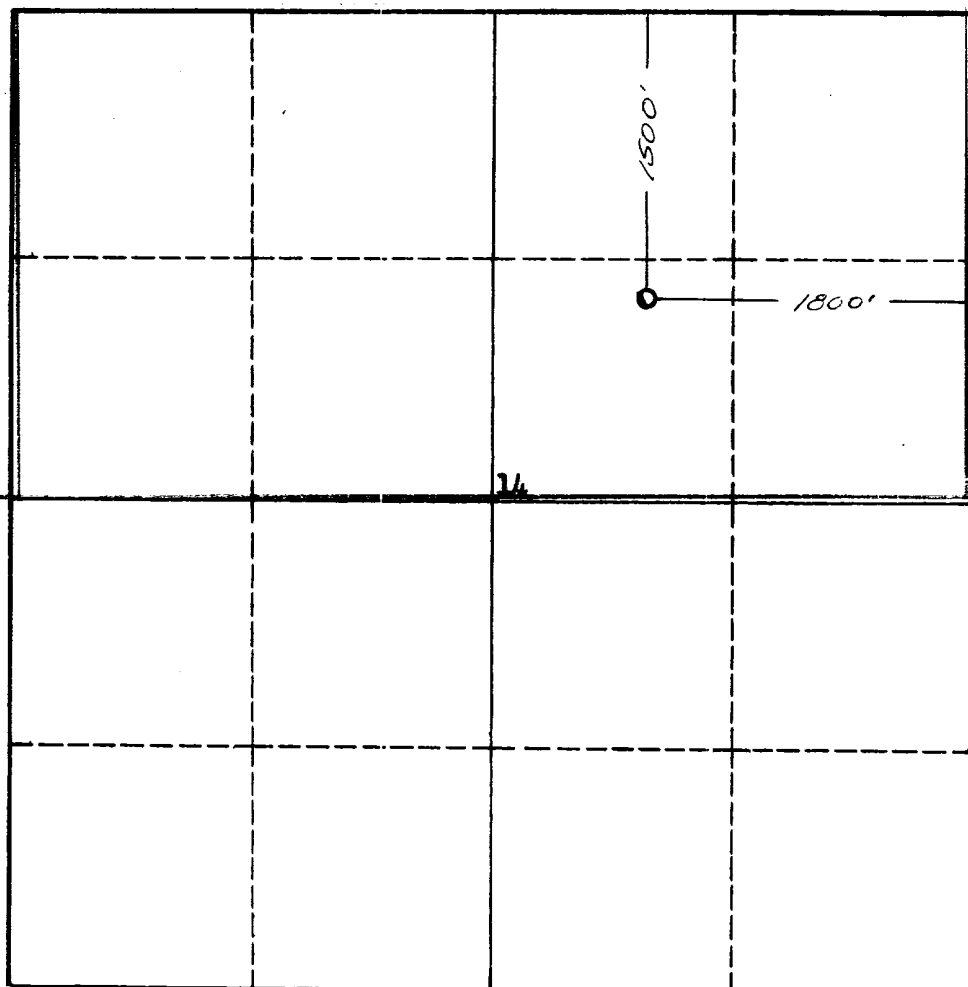

0 330 660 990 1320 1650 1980 2310 2640 2000 1500 1000 500 0

## INSTRUCTIONS FOR COMPLETION OF FORM C-128

1. Operator shall furnish and certify to the information called for in Section A.
2. Operator shall outline the dedicated acreage for *both* oil and gas wells on the plat in Section B.
3. A registered professional engineer or land surveyor registered in the State of New Mexico or approved by the Commission shall show on the plat the location of the well and certify this information in the space provided.
4. All distances shown on the plat must be from the outer boundaries of the Section.
5. If additional space is needed for listing owners and their respective interests as required in question 3 of Section A, please use space below.