

(SUBMIT IN TRIPLICATE)

UNITED STATES
DEPARTMENT OF THE INTERIOR
GEOLOGICAL SURVEY

Land Office **Santa Fe**
Lease No. **080168-A**
Unit _____

SUNDRY NOTICES AND REPORTS ON WELLS

NOTICE OF INTENTION TO DRILL	<input checked="" type="checkbox"/>	SUBSEQUENT REPORT OF WATER SHUT-OFF	
NOTICE OF INTENTION TO CHANGE PLANS		SUBSEQUENT REPORT OF SHOOTING OR ACIDIZING	
NOTICE OF INTENTION TO TEST WATER SHUT-OFF		SUBSEQUENT REPORT OF ALTERING CASING	
NOTICE OF INTENTION TO RE-DRILL OR REPAIR WELL		SUBSEQUENT REPORT OF RE-DRILLING OR REPAIR	
NOTICE OF INTENTION TO SHOOT OR ACIDIZE		SUBSEQUENT REPORT OF ABANDONMENT	
NOTICE OF INTENTION TO PULL OR ALTER CASING		SUPPLEMENTARY WELL HISTORY	
NOTICE OF INTENTION TO ABANDON WELL			

(INDICATE ABOVE BY CHECK MARK NATURE OF REPORT, NOTICE, OR OTHER DATA)

March 21, 19 61

H. O. Watson
Well No. **1** is located **1890** ft. from **[N]** line and **1890** ft. from **[E]** line of sec. **22**
SW/4 Sec. 22 **27 N** **12 W** **H.M.P.M.**
(1/4 Sec. and Sec. No.) (Twp.) (Range) (Meridian)
Basin District **San Juan** **New Mexico**
(Field) (County or Subdivision) (State or Territory)

The elevation of the ~~drainage~~ **ground level** above sea level is **9853** ft.

DETAILS OF WORK

(State names of and expected depths to objective sands; show sizes, weights, and lengths of proposed casings; indicate mudding jobs, cementing points, and all other important proposed work)

We propose to drill above well as follows:

1. Drill 12-1/4" hole to 200 feet.
2. Run and cement 8-5/8" OD, 54# casing at 200 feet. Circulate cement to surface.
3. Drill 7-7/8" hole to 25 (approximately 6175').
4. Run and cement 5-1/2" OD, 14# casing. Cement in two stages with stage collar 50 feet below base of Pictured Cliffs formation.
5. Fracture formation and test well.
6. Clean up location.

I understand that this plan of work must receive approval in writing by the Geological Survey before operations may be commenced.

Company **Tennessee Oil Company**

Address **P. O. Box 1714**

Durango, Colorado

By  **L. B. Plumb**

Title **District Production Superintendent**

NEW MEXICO OIL CONSERVATION COMMISSION
WELL LOCATION AND ACREAGE DEDICATION PLAT

FORM C-128
Revised 5/1/57

SEE INSTRUCTIONS FOR COMPLETING THIS FORM ON THE REVERSE SIDE

SECTION A

Operator TENNECO OIL COMPANY			Lease H2 O. Watson		Well No. 1
Unit Letter G	Section 22	Township 27 North	Range 12 West	County San Juan County	
Actual Footage Location of Well: 1850 feet from the North line and 1850 feet from the East line					
Ground Level Elev. 5853	Producing Formation Dakota		Pool Basin		Dedicated Acreage: 320 Acres

1. Is the Operator the only owner in the dedicated acreage outlined on the plat below? YES _____ NO _____. ("Owner" means the person who has the right to drill into and to produce from any pool and to appropriate the production either for himself or for himself and another. (65-3-29 (e) NMSA 1935 Comp.)
2. If the answer to question one is "no," have the interests of all the owners been consolidated by communitization agreement or otherwise? YES _____ NO _____. If answer is "yes," Type of Consolidation _____
3. If the answer to question two is "no," list all the owners and their respective interests below:

Owner	Land Description

MAR 23 1961

SECTION B

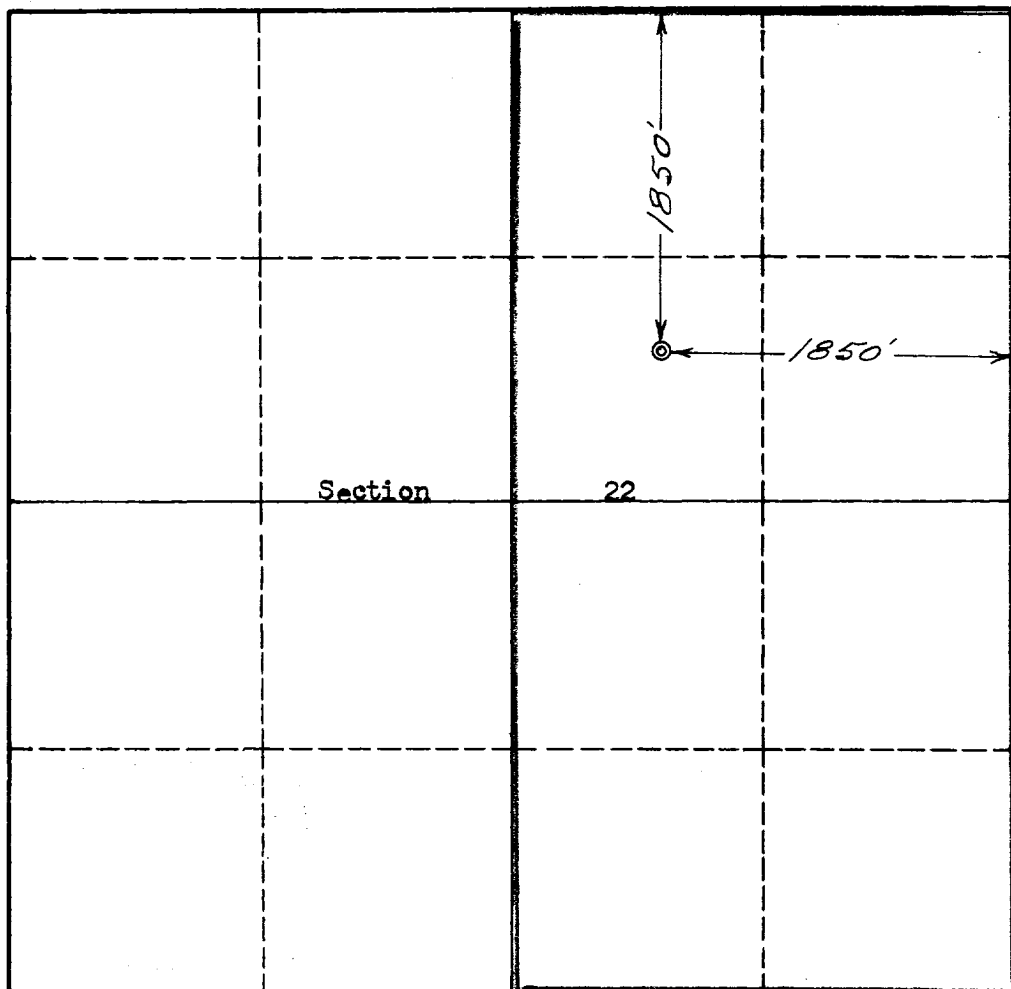

CERTIFICATION

I hereby certify that the information in SECTION A above is true and complete to the best of my knowledge and belief.

Name _____
 District Production Supt.
 Position _____
 Tenneco Corporation
 Company _____
 March 21, 1961
 Date _____

I hereby certify that the well location shown on the plat in SECTION B was plotted from field notes of actual surveys made by me or under my supervision, and that the same is true and correct to the best of my knowledge and belief.

Date Surveyed
17 March 1961
 Registered Professional Engineer
 and/or Land Surveyor
 Robert H. Ernst

Certificate No.
PE & IS 2463

San Juan Engineering Co.

0 330 660 990 1320 1650 1980 2310 2640 2000 1500 1000 500 0

INSTRUCTIONS FOR COMPLETION OF FORM C-128

1. Operator shall furnish and certify to the information called for in Section A.
2. Operator shall outline the dedicated acreage for *both* oil and gas wells on the plat in Section B.
3. A registered professional engineer or land surveyor registered in the State of New Mexico or approved by the Commission shall show on the plat the location of the well and certify this information in the space provided.
4. All distances shown on the plat must be from the outer boundaries of the Section.
5. If additional space is needed for listing owners and their respective interests as required in question 3 of Section A, please use space below.