

(SUBMIT IN TRIPLICATE)

UNITED STATES
DEPARTMENT OF THE INTERIOR
GEOLOGICAL SURVEY

Indian Agency _____

Navajo

Allottee _____

Lease No. **21-22-0423-4367**

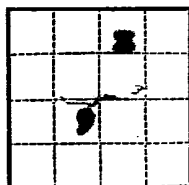

SUNDRY NOTICES AND REPORTS ON WELLS

NOTICE OF INTENTION TO DRILL	<input checked="" type="checkbox"/>	SUBSEQUENT REPORT OF WATER SHUT-OFF	
NOTICE OF INTENTION TO CHANGE PLANS		SUBSEQUENT REPORT OF SHOOTING OR ACIDIZING	
NOTICE OF INTENTION TO TEST WATER SHUT-OFF		SUBSEQUENT REPORT OF ALTERING CASING	
NOTICE OF INTENTION TO REDRILL OR REPAIR WELL		SUBSEQUENT REPORT OF REDRILLING OR REPAIR	
NOTICE OF INTENTION TO SHOOT OR ACIDIZE		SUBSEQUENT REPORT OF ABANDONMENT	
NOTICE OF INTENTION TO PULL OR ALTER CASING		SUPPLEMENTARY WELL HISTORY	
NOTICE OF INTENTION TO ABANDON WELL			

RECEIVED

NOV 6 1961

U. S. GEOLOGICAL SURVEY

(INDICATE ABOVE BY CHECK MARK NATURE OF REPORT, NOTICE, OR OTHER DATA)

November 2, 1961

Navajo Trust 26
Well No. **1** is located **460** ft. from **N** line and **1000** ft. from **E** line of sec. **9**
NW NE Section 9 (1/4 Sec. and Sec. No.) **77N** **10W** **60N**
(Twp.) (Range) (Meridian)
Wildcat **San Juan** **New Mexico**
(Field) (County or Subdivision) (State or Territory)

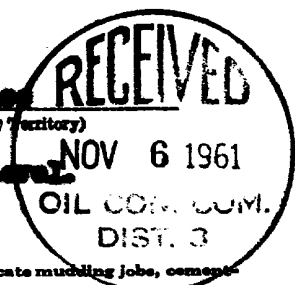

The elevation of the derrick floor above sea level is **5773** ft. **Ground Level**

DETAILS OF WORK

(State names of and expected depths to objective sands; show sizes, weights, and lengths of proposed casings; indicate mudlogging jobs, cementing points, and all other important proposed work)

Rotary drilling equipment will be used to drill to approximately 4,300' to the San Juan Formation. Casing Program: 300' of 8-5/8" Surface Casing will be run and cemented to surface. Required amount of 4-1/2" or 5-1/2" Production Casing will be run and cemented with sufficient cement to cover the highest potentially productive zone. Low solids Solignum will be used. All zones will be tested and Electric Logs will be run prior to setting casing or abandonment. Stimulation treatments may be employed in completion.

I understand that this plan of work must receive approval in writing by the Geological Survey before operations may be commenced.

Company **Humble Oil & Refining Company**
Address **P. O. Box 3082**
Durango, Colorado
COPY (ORIGINAL SIGNED) **B. M. BRADLEY**
By **By D. V. Emery**
B. M. Bradley
Title **Dist. Engr.**

NUMBER OF COPIES RECEIVED	
DISTRIBUTION	
SANTA FE	
FILE	
U.S.G.S.	
LAND OFFICE	
TRANSPORTER	OIL GAS
PRODUCTION OFFICE	
OPERATOR	

NEW MEXICO OIL CONSERVATION COMMISSION
WELL LOCATION AND ACREAGE DEDICATION PLAT
 SEE INSTRUCTIONS FOR COMPLETING THIS FORM ON THE REVERSE SIDE

FORM C-128
 Revised 5/1/57

SECTION A

Operator Humble Oil & Refining Company		Lease Huachuca Tract 16		Well No. 1
Unit Letter B	Section 9	Township 27N	Range 16W	County San Juan
Actual Footage Location of Well: 660 feet from the North line and 1880 feet from the East line				
Ground Level Elev. 5873	Producing Formation •	Pool Wildcat	Dedicated Acreage: • Acres	

1. Is the Operator the only owner in the dedicated acreage outlined on the plat below? YES **1** NO ____ . ("Owner" means the person who has the right to drill into and to produce from any pool and to appropriate the production either for himself or for himself and another. (65-3-29 (e) NMSA 1935 Comp.)
2. If the answer to question one is "no," have the interests of all the owners been consolidated by communication agreement or otherwise? YES ____ NO ____ . If answer is "yes," Type of Consolidation _____
3. If the answer to question two is "no," list all the owners and their respective interests below:

Owner	Land Description

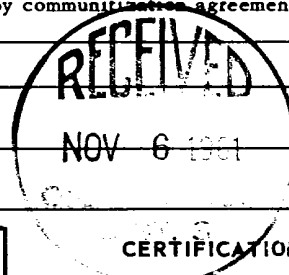

SECTION B

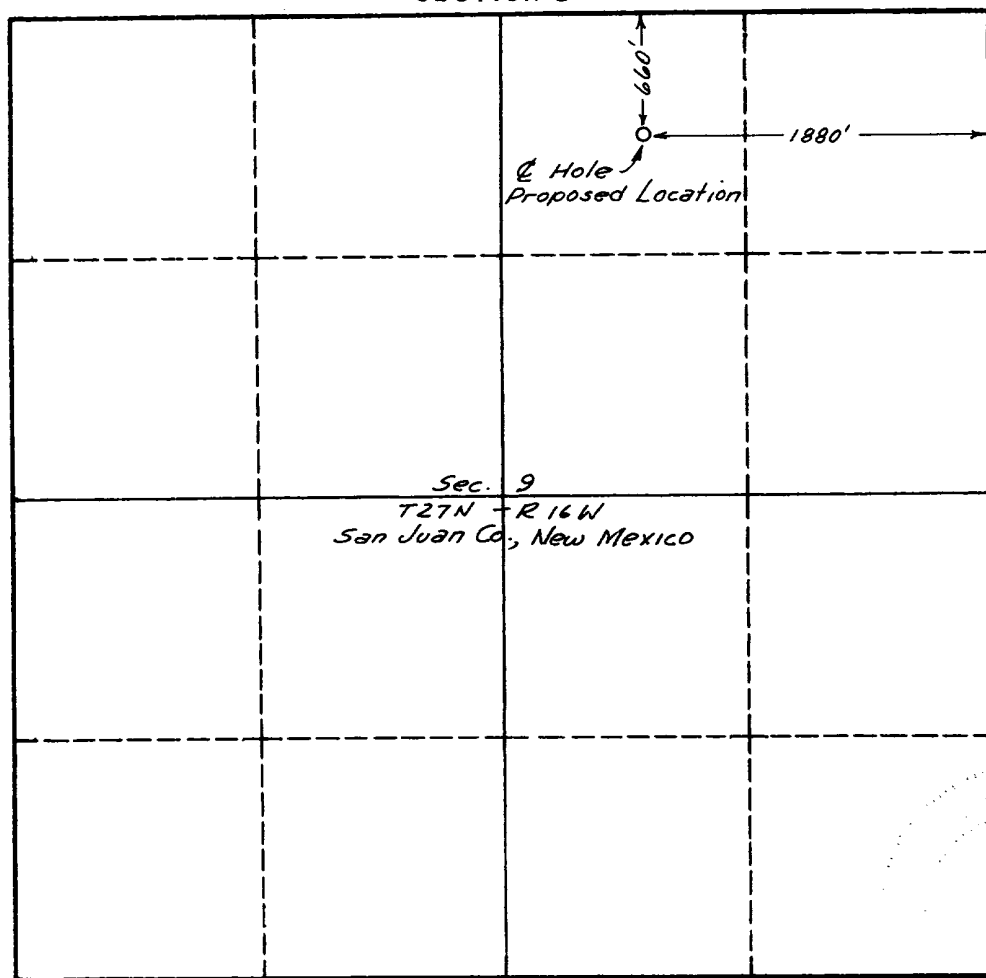

CERTIFICATION

I hereby certify that the information in SECTION A above is true and complete to the best of my knowledge and belief.

COPY (ORIGINAL SIGNED) B. M. BRADLEY

Name B. M. Bradley
Position Asst. Supt.
Company Humble Oil & Refining Co.
Date 11-7-61

I hereby certify that the well location shown on the plat in SECTION B was plotted from field notes of actual surveys made by me or under my supervision, and that the same is true and correct to the best of my knowledge and belief.

Date Surveyed October 27, 1961
Registered Professional Engineer and/or Land Surveyor [Signature]

Certificate No. New Mexico # 3189

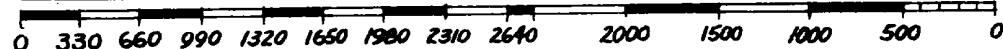

INSTRUCTIONS FOR COMPLETION OF FORM C-128

1. Operator shall furnish and certify to the information called for in Section A.
2. Operator shall outline the dedicated acreage for *both* oil and gas wells on the plat in Section B.
3. A registered professional engineer or land surveyor registered in the State of New Mexico or approved by the Commission shall show on the plat the location of the well and certify this information in the space provided.
4. All distances shown on the plat must be from the outer boundaries of the Section.
5. If additional space is needed for listing owners and their respective interests as required in question 3 of Section A, please use space below.