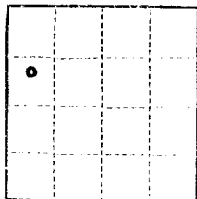

(SUBMIT IN TRIPLICATE)

UNITED STATES
DEPARTMENT OF THE INTERIOR
GEOLOGICAL SURVEYLand Office **New Mexico**
RM-01772-4
Lease No. **J. D. Reid**
Unit **11/4 Section 17**

SUNDRY NOTICES AND REPORTS ON WELLS

NOTICE OF INTENTION TO DRILL.....	<input checked="" type="checkbox"/>	SUBSEQUENT REPORT OF WATER SHUT-OFF.....	
NOTICE OF INTENTION TO CHANGE PLANS.....		SUBSEQUENT REPORT OF SHOOTING OR ACIDIZING.....	
NOTICE OF INTENTION TO TEST WATER SHUT-OFF.....		SUBSEQUENT REPORT OF ALTERING CASING.....	
NOTICE OF INTENTION TO RE-DRILL OR REPAIR WELL.....		SUBSEQUENT REPORT OF RE-DRILLING OR REPAIR.....	
NOTICE OF INTENTION TO SHOOT OR ACIDIZE.....		SUBSEQUENT REPORT OF ABANDONMENT.....	
NOTICE OF INTENTION TO PULL OR ALTER CASING.....		SUPPLEMENTARY WELL HISTORY.....	
NOTICE OF INTENTION TO ABANDON WELL.....			

(INDICATE ABOVE BY CHECK MARK NATURE OF REPORT, NOTICE, OR OTHER DATA)

March 22 35
19Well No. 6 is located 1790 ft. from ☒ N line and 590 ft. from ☒ E line of sec. 1711/4 Sec. 17 28 N 9 E 11/4
(1/4 Sec. and Sec. No.) (Twp.) (Range) (Meridian)Aztec Pictured Cliffs San Juan New Mexico
(Field) (County or Subdivision) (State or Territory)The elevation of ~~the derrick floor~~ ^{ground level} above sea level is 5841 ft.

DETAILS OF WORK

(State names of and expected depths to objective sands; show sizes, weights, and lengths of proposed casings; indicate mudding jobs, cementing points, and all other important proposed work)

Aztec proposes to set 150' of 8-5/8" OD surface casing and 5-1/2" OD casing at about 2050' with rotary tools. Well will be completed to about 2150' TD with cable tools and open hole will be treated w/5000 gals. oil and 5000# sand.

Proposed proration unit is 11/4 consisting of 160 acres.

RECEIVED
MAR 27 1955
U.S. GEOLOGICAL SURVEY
FEDERAL NEW MEXICO

I understand that this plan of work must receive approval in writing by the Geological Survey before operations may be commenced.

Company **AZTEC OIL & GAS COMPANY**Address **920 Mercantile Securities Bldg.****Dallas 1, Texas**By **G. B. Williams**Title **Petroleum Engineer**

COMPANY Aztec Oil and Gas Company

Well Name & No. Reid No. 6

Well No. NM-01772-A

Location 1750' from the North line and 990' from the West line.

Being in Section 17

S. 17, T. 28 N., R. 9 W., N.M.P.M.

San Juan County, New Mexico.

Ground Elevation 5841

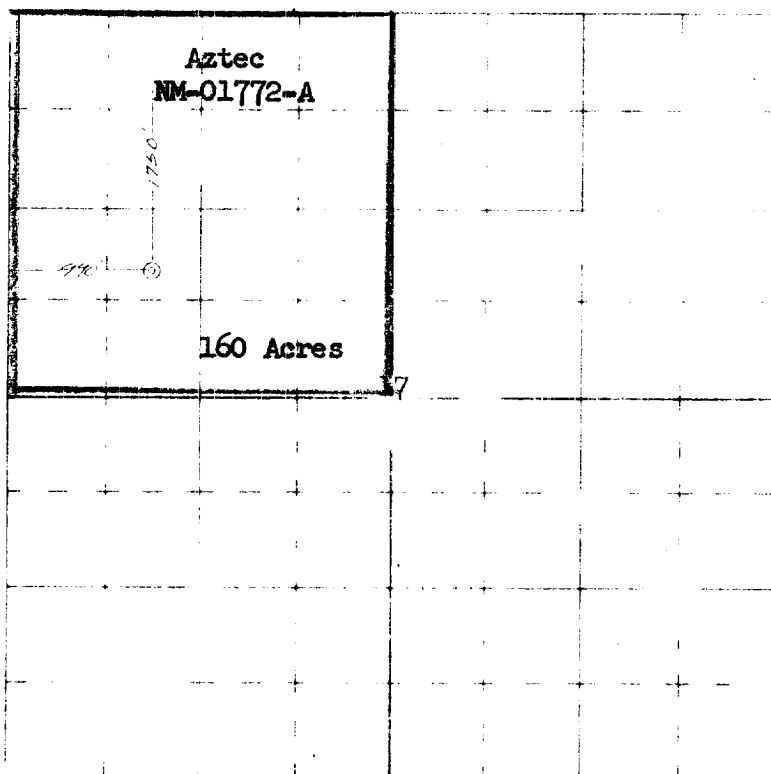

Scale -- 4 in. = 1 mile

Surveyed March 18

19 55

This is to certify that the above plat was prepared from field notes of actual surveys made by me or under my supervision and that the same are true and correct to the best of my knowledge and belief.



Ernest V. Echohawk
Registered Land Surveyor
S. M. Reg. #1545

RECEIVED
MAR 24 1955
U. S. GEOLOGICAL SURVEY
FARMINGTON, NEW MEXICO