



UNITED STATES
DEPARTMENT OF THE INTERIOR
GEOLOGICAL SURVEY
P. O. Box 965
Farmington, New Mexico

April 17, 1956

J. Glenn Turner
P. O. Box 728
Farmington, New Mexico

Re: Santa Fe 078356

Gentlemen:

Receipt is acknowledged of your "Notice of Intention to Drill" dated April 17, 1956 covering your well No. 57-23 Huerfanito Unit in SE¹ sec. 23, T. 27 N., R. 9 W., N. M. P. M., San Juan County, New Mexico, So. Blanco P.C.

Your proposed work is hereby approved subject to compliance with the provisions of the "Oil and Gas Operating Regulations" revised May 25, 1942, a copy of which will be sent to you on request, and subject to the following conditions:

1. Drilling operations so authorized are subject to the attached sheet for general conditions of approval.
2. Furnish copies of all logs.

Very truly yours,

(Long, signed)

Jerry W. Long
Acting District Engineer

JWLong:ac



UNITED STATES
DEPARTMENT OF THE INTERIOR
GEOLOGICAL SURVEY



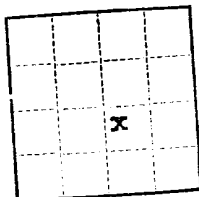

(SUBMIT IN TRIPLICATE)

UNITED STATES
DEPARTMENT OF THE INTERIOR
GEOLOGICAL SURVEY

Budget Bureau 42-R358.3.
Approval expires 12-31-55.
Land Office Santa Fe
Lease No. 078356
Unit SE/4

SUNDRY NOTICES AND REPORTS ON WELLS

NOTICE OF INTENTION TO DRILL	<input checked="" type="checkbox"/>	SUBSEQUENT REPORT OF WATER SHUT-OFF	
NOTICE OF INTENTION TO CHANGE PLANS		SUBSEQUENT REPORT OF SHOOTING OR ACIDIZING	
NOTICE OF INTENTION TO TEST WATER SHUT-OFF		SUBSEQUENT REPORT OF ALTERING CASING	
NOTICE OF INTENTION TO RE-DRILL OR REPAIR WELL		SUBSEQUENT REPORT OF RE-DRILLING OR REPAIR	
NOTICE OF INTENTION TO SHOOT OR ACIDIZE		SUBSEQUENT REPORT OF ABANDONMENT	
NOTICE OF INTENTION TO PULL OR ALTER CASING		SUPPLEMENTARY WELL HISTORY	
NOTICE OF INTENTION TO ABANDON WELL			

(INDICATE ABOVE BY CHECK MARK NATURE OF REPORT, NOTICE, OR OTHER DATA)

April 17, 1956, 19

Huerfanito Unit
Well No. 57-23 is located 1820 ft. from ~~100~~ [S] line and 1850 ft. from [E] line of sec. 23
SE/4 Sec. 23 (1/4 Sec. and Sec. No.) T. 27-N (Twp.) R. 9-W (Range) N.M.P.M. (Meridian)
So. Blanco P. C. (Field) San Juan County (County or Subdivision) New Mexico (State or Territory)

The elevation of the derrick floor above sea level is 6308 ft.

DETAILS OF WORK

(State names of and expected depths to objective sands; show sizes, weights, and lengths of proposed casings; indicate mudding jobs, cementing points, and all other important proposed work)

SE/4 of Section 23 dedicated to this well. Propose to spud with cable tools; then drill with rotary tools to the top of the Pictured Cliffs Formation - expected between 1,900 feet and 2,200 feet below the surface. Completion with cable tools - and sand oil fracturing or shooting with solidified nitro-glycerin as conditions warrant.

Casing program: 90 feet 8-5/8" O.D. new 8 rd. thd. 24# casing. Circulate cement to surface, using at least 70 sacks of cement.

5-1/2" O.D. 14# J-55 casing to be set on top of Pictured Cliffs Formation cemented with 100 sacks regular cement.

1" tubing to be set within 20 feet of ~~total~~ total depth for production.

I understand that this plan of work must receive approval in writing by the Geological Survey before operations may be commenced.

Company J. Glenn Turner - Unit Operator

Address P. O. Box 728

Farmington, New Mexico

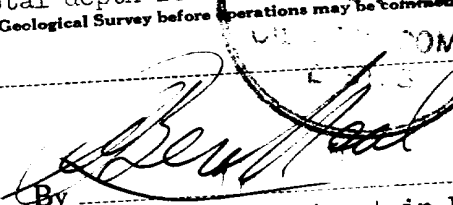
By 
C. Beeson Neal, Agent in Farmington
Title

NEW MEXICO
OIL CONSERVATION COMMISSION

Form C-128

Well Location and/or Gas Proration Plat

Date April 17, 1956

Operator J. GLENN TURNER Lease HUERFANITO UNIT

Well No. 57-23 Section 23 Township 27 NORTH Range 9 WEST NMPM

Located 1820 Feet From the SOUTH Line, 1850 Feet From the EAST Line,

SAN JUAN County, New Mexico. G. L. Elevation 6300.0

So. Blanco

Name of Producing Formation Pictured Cliffs Pool P. C. Dedicated Acreage 160

(Note: All distances must be from outer boundaries of Section)

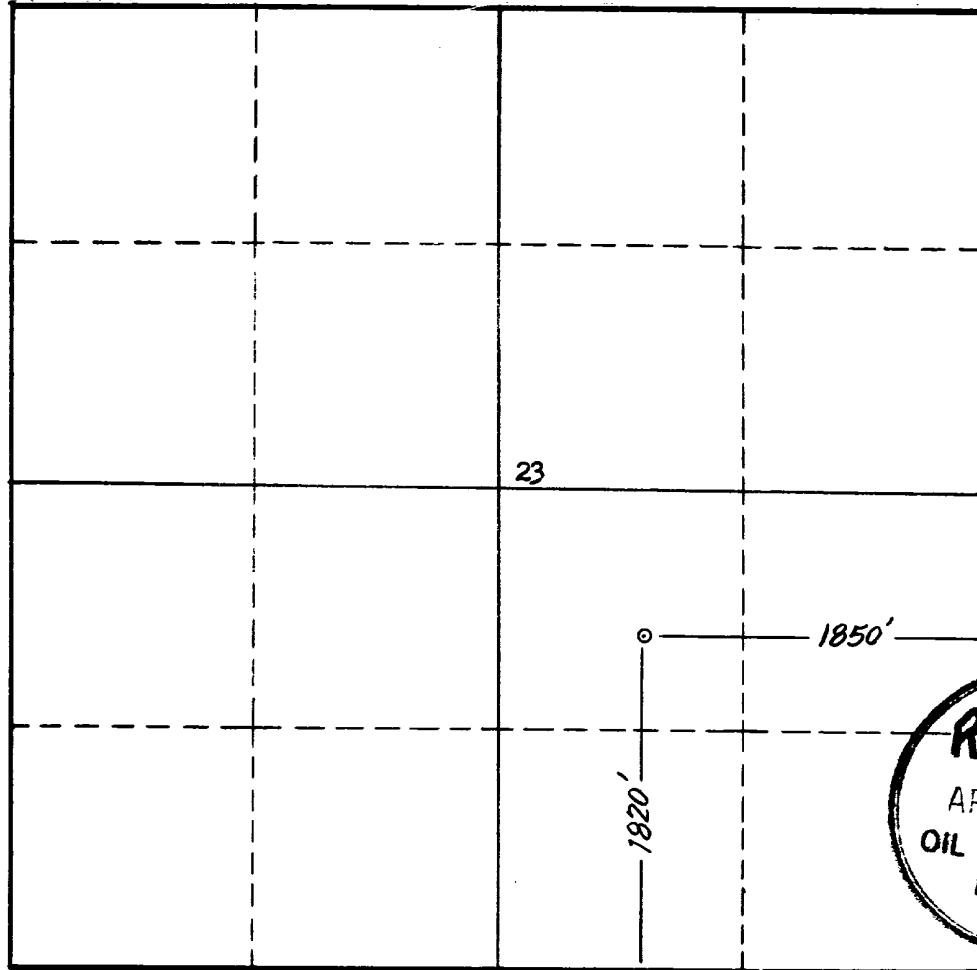

SCALE: 1"=1000'

1. Is this Well a Dual Comp. ? Yes ___ No X .
2. If the answer to Question 1 is yes, are there any other dually completed wells within the dedicated acreage? Yes ___ No X .

Name C. Beeson Neal
Position C. Beeson Neal, Agent in Farmington
Representing J. Glenn Turner
Address Box 728-Farmington, New Mexico

This is to certify that the above plat was prepared from field notes of actual surveys made by me or under my supervision and that the same are true and correct to the best of my knowledge and belief.

Date Surveyed February 24, 1956
James P. Leese
Registered Professional Engineer and/or
Land Surveyor JAMES P. LEESE
N. Mex. Reg. No. 1463

