

UNITED STATES  
DEPARTMENT OF THE INTERIOR  
GEOLOGICAL SURVEY30 - 257 - 20170  
5. LEASE DESIGNATION AND SERIAL NO.

SF 077329

6. IF INDIAN, ALLOTTEE OR TRIBE NAME

7. UNIT AGREEMENT NAME

8. FARM OR LEASE NAME

C. M. Morris Com. "A"

9. WELL NO.

1

10. FIELD AND POOL, OR WILDCAT

Basin Dakota

11. SEC., T., R., M., OR BLK.  
AND SURVEY OR AREA

Sec 13, T-27-N, R-10-W

12. COUNTY OR PARISH

San Juan

13. STATE  
New Mexico

1. TYPE OF WORK

DRILL ☒DEEPEN ☐PLUG BACK ☐

2. TYPE OF WELL

OIL ☐GAS ☒OTHER ☐SINGLE ☒MULTIPLE ☐

ZONE

ZONE

3. NAME OF OPERATOR

Tenneco Oil Company

4. ADDRESS OF OPERATOR

P. O. Box 1714, Durango, Colorado

5. LOCATION OF WELL (Report location clearly and in accordance with any State requirements.\*)

At surface

1450 FSL, 790 FWL

At proposed prod. zone

Unit L

14. DISTANCE IN MILES AND DIRECTION FROM NEAREST TOWN OR POST OFFICE\*

15. DISTANCE FROM PROPOSED\*

LOCATION TO NEAREST

PROPERTY OR LEASE LINE, FT.

(Also to nearest drlg. unit line, if any)

18. DISTANCE FROM PROPOSED LOCATION\*  
TO NEAREST WELL, DRILLING, COMPLETED,  
OR APPLIED FOR, ON THIS LEASE, FT.

16. NO. OF ACRES IN LEASE

320

19. PROPOSED DEPTH

6640

17. NO. OF ACRES ASSIGNED  
TO THIS WELL

320

20. ROTARY OR CABLE TOOLS

Rotary

21. ELEVATIONS (Show whether DF, RT, GR, etc.)

6121 Gr.

22. APPROX. DATE WORK WILL START\*

## PROPOSED CASING AND CEMENTING PROGRAM

SIZE OF HOLE	SIZE OF CASING	WEIGHT PER FOOT	SETTING DEPTH	QUANTITY OF CEMENT
12-1/4"	8-5/8"	20 & 24#	150	200 sx, cmt to surface
7-7/8"	5-1/2"	14 & 15.5#	6640	150 sx first stage
				100 sx second stage.

We will drill to 6640 T.D. Run casing as above, log, perf and frac. Run deliverability test.



IN ABOVE SPACE DESCRIBE PROPOSED PROGRAM: If proposal is to deepen or plug back, give data on present productive zone and proposed new productive zone. If proposal is to drill or deepen directionally, give pertinent data on subsurface locations and measured and true vertical depths. Give blowout preventer program, if any.

24.

SIGNED

*M. K. Wagner*  
M. K. Wagner

TITLE

DATE 10/6/67

(This space for Federal or State office use)

PERMIT NO.

APPROVAL DATE

APPROVED BY

*len*

TITLE

CONDITIONS OF APPROVAL, IF ANY:

RECEIVED

DATE

OCT 9 1967

USGS (5)

Pan Am (1)

Mobil (1)

\*See Instructions On Reverse Side

U. S. GEOLOGICAL SURVEY  
EARMING, N. N.

**NEW MEXICO OIL CONSERVATION COMMISSION  
WELL LOCATION AND ACERAGE DEDICATION PLAT**

All distances must be from the outer boundaries of the Section

Operator <b>TENNECO OIL COMPANY</b>			Lease <b>C. M. MORRIS COM. "A"</b>		Well No <b>1</b>
Unit Letter <b>L</b>	Section <b>13</b>	Township <b>27 North</b>	Range <b>10 West</b>	County <b>San Juan</b>	
Actual Well Location of Well: <b>1450</b> feet from the <b>South</b> line and <b>790</b> feet from the <b>West</b> line Producing Formation <b>Basin Dakota</b> Pool <b>Basin Dakota</b> Dedicated Acreage <b>W/2 320</b> Acres					

1. Outline the acreage dedicated to the subject well by colored pencil or hatchure marks on the plat below.
2. If more than one lease is dedicated to the well, outline each and identify the ownership thereof (both as to working interest and royalty).
3. If more than one lease of different ownership is dedicated to the well, have the interests of all owners been consolidated by communitization, unitization, force-pooling, etc?
- ☒ Yes ☐ No If answer is "yes," type of consolidation Presently being communitized

If answer is "no," list the owners and tract descriptions which have actually consolidated (Use reverse side of this form if necessary).

No allowable will be assigned to the well until all interests have been consolidated (by communitization, unitization, force-pooling, or otherwise) or until a non standard unit, eliminating such interests, has been approved by the Commission.

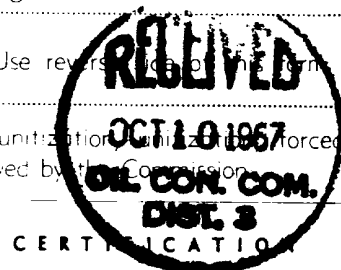

I hereby certify that the information contained herein is true and complete to the best of my knowledge and belief.

Name M. K. Wagner  
 Position Tenneco Oil Company  
 Company October 6, 1967  
 Date

I hereby certify that the well location shown on this plat was plotted from field notes of actual surveys made by me or under my supervision, and that the same is true and correct to the best of my knowledge and belief.

4 October 1967  
 Date Surveyed  
Robert H. Ernst  
 Registered Professional Engineer  
 and/or Land Surveyor  
 Robert H. Ernst  
 N. Mex. PE & LS 2463  
 Certificate No.

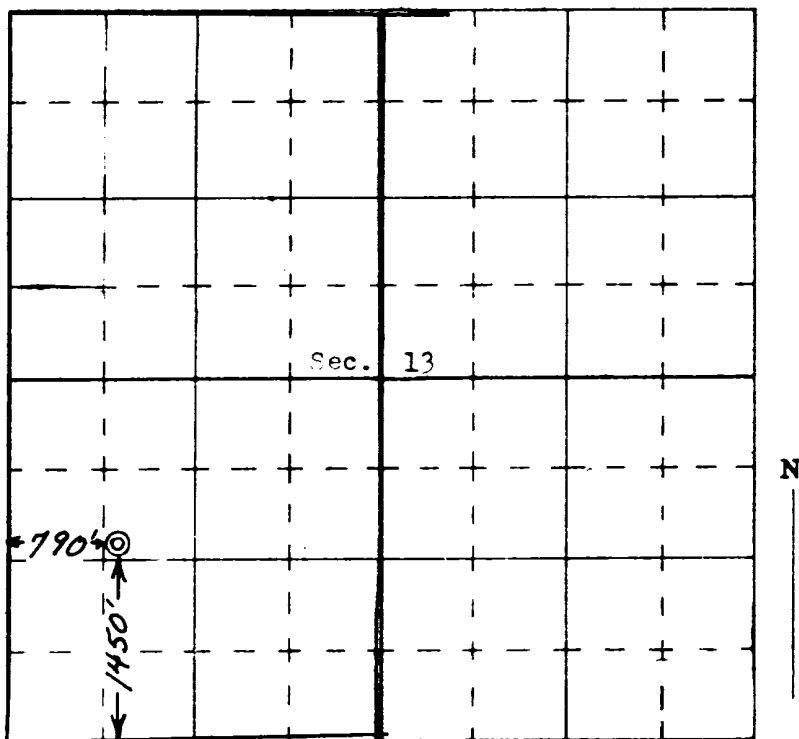

Ernst Engineering Co.  
Durango, Colorado



1