

**CONFIDENTIAL**  
UNITED STATES  
DEPARTMENT OF THE INTERIOR  
GEOLOGICAL SURVEYSUBMIT IN TRIPLICATE\*  
(Other instructions on  
reverse side)Form approved.  
Budget Bureau No. 42-R1425.645  
30-044-20302**APPLICATION FOR PERMIT TO DRILL, DEEPEN, OR PLUG BACK**

## 1a. TYPE OF WORK

DRILL ☒DEEPEN ☐PLUG BACK ☐

## b. TYPE OF WELL

OIL  
WELL ☒GAS  
WELL ☐

OTHER

SINGLE  
ZONE ☒MULTIPLE  
ZONE ☐

## 2. NAME OF OPERATOR

**TEXACO INC.**

## 3. ADDRESS OF OPERATOR

**Box 810, Farmington, New Mexico 87401**

## 4. LOCATION OF WELL (Report location clearly and in accordance with any State requirements.\*)

At surface

**1980' from south line and 660' from west line**

At proposed prod. zone

**same**

## 14. DISTANCE IN MILES AND DIRECTION FROM NEAREST TOWN OR POST OFFICE\*

**Approx. 13 miles south of Kirtland, N. M.**

## 10. DISTANCE FROM PROPOSED\*

LOCATION TO NEAREST  
PROPERTY OR LEASE LINE, FT.  
(Also to nearest drlg. unit line, if any)**660'**

## 16. NO. OF ACRES IN LEASE

**640'**17. NO. OF ACRES ASSIGNED  
TO THIS WELL**40**

## 18. DISTANCE FROM PROPOSED LOCATION\*

TO NEAREST WELL, DRILLING, COMPLETED,  
OR APPLIED FOR, ON THIS LEASE, FT.**first well  
on lease**

## 19. PROPOSED DEPTH

**5055**

## 20. ROTARY OR CABLE TOOLS

**rotary**

## 21. ELEVATIONS (Show whether DF, RT, GR, etc.)

**5923' GR**

## 22. APPROX. DATE WORK WILL START\*

**June 28, 1968**

## 23. PROPOSED CASING AND CEMENTING PROGRAM

SIZE OF HOLE	SIZE OF CASING	WEIGHT PER FOOT	SETTING DEPTH	QUANTITY OF CEMENT
<b>12 1/2"</b>	<b>8 5/8"</b>	<b>24#</b>	<b>300'</b>	<b>circulate</b>
<b>7 7/8"</b>	<b>"</b>	<b>"</b>	<b>"</b>	

**FORMATION TOPS AS EXPECTED**

Pictured Cliffs.....1150'  
Mesaverde.....1900'  
Point Lookout.....3630'  
Main Gallup.....4955'

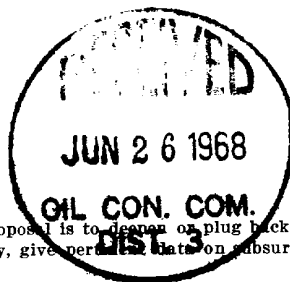
**RECEIVED****JUN 27 1968****U. S. GEOLOGICAL SURVEY  
FARMINGTON, N. M.**

IN ABOVE SPACE DESCRIBE PROPOSED PROGRAM: If proposal is to deepen or plug back, give data on present productive zone and proposed new productive zone. If proposal is to drill or deepen directionally, give pertinent data on subsurface locations and measured and true vertical depths. Give blowout preventer program, if any.

24.

SIGNED

TITLE

**District Superintendent**

DATE

**June 25, 1968**

(This space for Federal or State office use)

PERMIT NO.

APPROVAL DATE

APPROVED BY

TITLE

DATE

CONDITIONS OF APPROVAL, IF ANY:

\*See Instructions On Reverse Side

## Instructions

**General:** This form is designed for submitting proposals to perform certain well operations, as indicated, on all types of lands and leases for appropriate action by either a Federal or a State agency, or both, pursuant to applicable Federal and/or State laws and regulations. Any necessary special instructions concerning the use of this form and the number of copies to be submitted, particularly with regard to local, area, or regional procedures and practices, either are shown below or will be issued by, or may be obtained from, the local Federal and/or State office.

**Item 1:** If the proposal is to redrill to the same reservoir at a different subsurface location or to a new reservoir, use this form with appropriate notations. Consult applicable State or Federal regulations concerning subsequent work proposals or reports on the well.

**Item 4:** If there are no applicable State requirements, locations on Federal or Indian land should be described in accordance with Federal requirements. Consult local State or Federal office for specific instructions.

**Item 14:** Needed only when location of well cannot readily be found by road from the land or lease description. A plat, or plats, separate or on this reverse side, showing the roads to, and the surveyed location of, the well, and any other required information, should be furnished when required by Federal or State agency offices.

**Items 15 and 18:** If well is to be, or has been directionally drilled, give distances for subsurface location of hole in any present or objective production zone.

**Item 22:** Consult applicable Federal or State regulations, or appropriate officials, concerning approval of the proposal before operations are started.

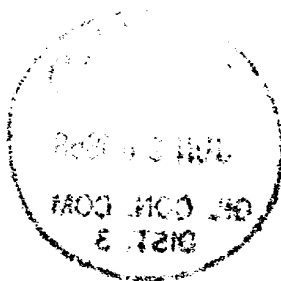

JATYECOWX00

# CONFIDENTIAL

## NEW MEXICO OIL CONSERVATION COMMISSION WELL LOCATION AND ACREAGE DEDICATION PLAT

Form C-102  
Supersedes C-128  
Effective 1-4-65

All distances must be from the outer boundaries of the Section.

Operator <b>TEXACO, INC.</b>		Lease <b>Navajo Tribe BK</b>		Well No. <b>1</b>
Unit Letter <b>L</b>	Section <b>29</b>	Township <b>27 North</b>	Range <b>14 West</b>	County <b>San Juan</b>
Actual Footage Location of Well: <b>1980</b> feet from the <b>South</b> line and <b>660</b> feet from the <b>West</b> line				
Ground Level Elev. <b>5923. ungr.</b>	Producing Formation <b>----</b>	Pool <b>Wildcat</b>	Dedicated Acreage: <b>40</b> Acres	

1. Outline the acreage dedicated to the subject well by colored pencil or hachure marks on the plat below.
2. If more than one lease is dedicated to the well, outline each and identify the ownership thereof (both as to working interest and royalty).
3. If more than one lease of different ownership is dedicated to the well, have the interests of all owners been consolidated by communitization, unitization, force-pooling, etc?

☐ Yes ☐ No If answer is "yes," type of consolidation \_\_\_\_\_

If answer is "no," list the owners and tract descriptions which have actually been consolidated. (Use reverse side of this form if necessary.) \_\_\_\_\_

No allowable will be assigned to the well until all interests have been consolidated (by communitization, unitization, forced-pooling, or otherwise) or until a non-standard unit, eliminating such interests, has been approved by the Commission.

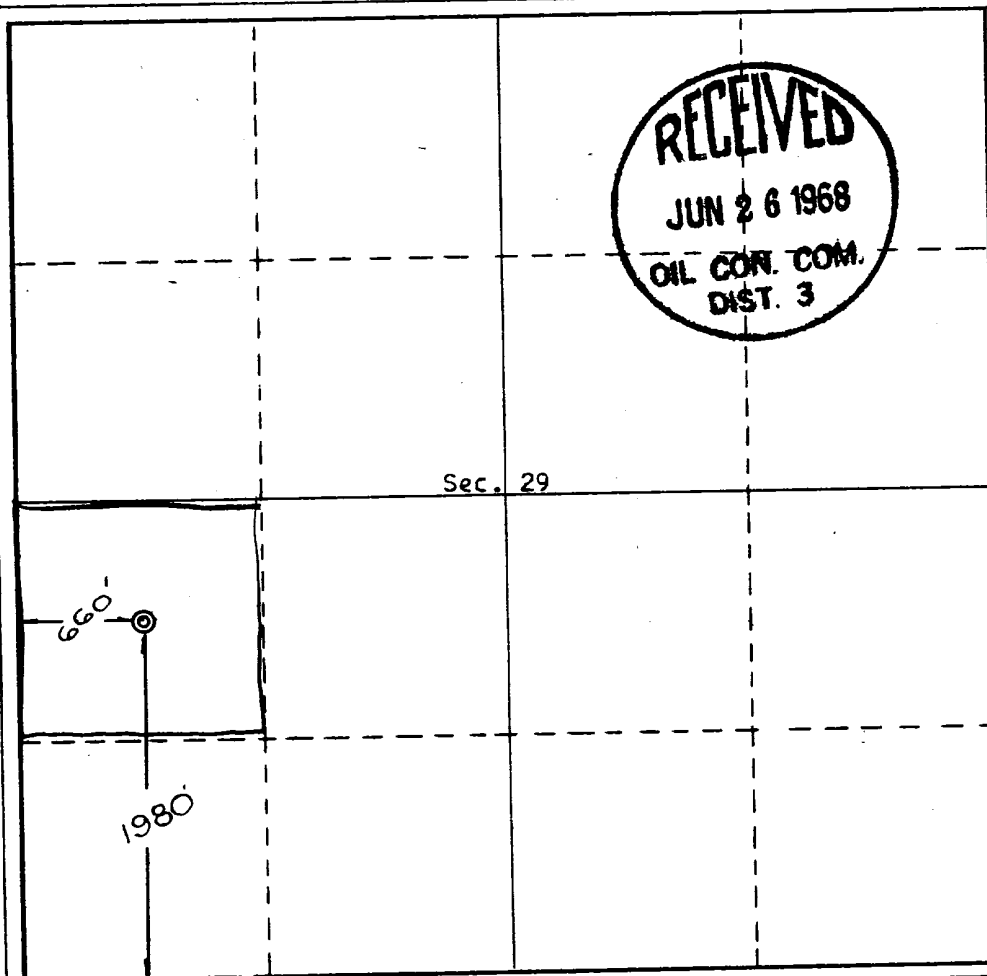

### CERTIFICATION

I hereby certify that the information contained herein is true and complete to the best of my knowledge and belief.

*C. F. Farmer*  
Name

**C. F. Farmer**

Position  
**Dist. Supt.**

Company  
**TEXACO INC.**

Date  
**June 25, 1968**

**STATE OF NEW MEXICO**  
I hereby certify that the well location shown on this plat was placed from field notes of actual surveys made by me or under my supervision, and that the same are true and correct to the best of my knowledge and belief.  
**REGISTERED LAND SURVEYOR**

Date Surveyed  
**June 24, 1968**

Registered Professional Engineer and/or Land Surveyor

*E. J. Edwards*  
Certificate No. **3602**

0 330 660 990 1320 1650 1980 2310 2640 2000 1500 1000 500 0