

UNITED STATES
DEPARTMENT OF THE INTERIOR
GEOLOGICAL SURVEY

APPLICATION FOR PERMIT TO DRILL, DEEPEN, OR PLUG BACK

1a. TYPE OF WORK
DRILL ☒ DEEPEN ☐ PLUG BACK ☐

b. TYPE OF WELL
OIL WELL ☐ GAS WELL ☒ OTHER ☐ SINGLE ZONE ☒ MULTIPLE ZONE ☐

2. NAME OF OPERATOR
El Paso Natural Gas Company

3. ADDRESS OF OPERATOR
Box 990, Farmington, New Mexico - 87401

4. LOCATION OF WELL* (Report location clearly and in accordance with any State requirements)
At surface 950'S, 820'E
At proposed prod. zone

14. DISTANCE IN MILES AND DIRECTION FROM NEAREST TOWN OR POST OFFICE*

15. DISTANCE FROM PROPOSED* LOCATION TO NEAREST PROPERTY OR LEASE LINE, FT. (Also to nearest drlg. unit line, if any)

16. NO. OF ACRES IN LEASE

17. NO. OF ACRES ASSIGNED TO THIS WELL

18. DISTANCE FROM PROPOSED LOCATION* TO NEAREST WELL, DRILLING, COMPLETED, OR APPLIED FOR, ON THIS LEASE, FT.

19. PROPOSED DEPTH
3365'

20. ROTARY OR CABLE TOOLS
Rotary

21. ELEVATIONS (Show whether DF, RT, GR, etc.)
6827' GL

22. APPROX. DATE WORK WILL START*

30-045-20502

5. LEASE DESIGNATION AND SERIAL NO.
ST 078566

6. IF INDIAN, ALLOTTEE OR TRIBE NAME

7. UNIT AGREEMENT NAME

8. FARM OR LEASE NAME
Storey

9. WELL NO.
7

10. FIELD AND POOL, OR WILDCAT
So. Blanco P. C.

11. SEC., T., R., M., OR BLK. AND SURVEY OR AREA
Sec. 35, T-28-N, R-6-W
N.M.P.M.

12. COUNTY OR PARISH
San Juan

13. STATE
New Mexico

154.15

PROPOSED CASING AND CEMENTING PROGRAM				
SIZE OF HOLE	SIZE OF CASING	WEIGHT PER FOOT	SETTING DEPTH	QUANTITY OF CEMENT
<u>12 1/4"</u>	<u>8 5/8"</u>	<u>24#</u>	<u>120'</u>	<u>5 Sks. to Circulate</u>
<u>6 3/4"</u>	<u>2 7/8"</u>	<u>6.4#</u>	<u>3365'</u>	<u>150 Sks. to fill from T. B. to top of the Kirtland formation.</u>

Selectively perforate and sand water fracture the Pictured Cliffs formation.

The SE/4 of Section 35 is dedicated to this well.

RECEIVED

MAY 23 1969

U. S. GEOLOGICAL SURVEY
FARMINGTON, N. M.

IN ABOVE SPACE DESCRIBE PROPOSED PROGRAM: If proposal is to deepen or plug back, give data on present productive zone and proposed new productive zone. If proposal is to drill or deepen directionally, give pertinent data on subsurface locations and measured and true vertical depths. Give blowout preventer program, if any.

24. Original Signed By: L. O. Van Ryan TITLE Petroleum Engineer DATE 5-23-69
(This space for Federal or State office use)

PERMIT NO. _____ APPROVAL DATE _____
APPROVED BY Gu TITLE _____ DATE _____
CONDITIONS OF APPROVAL, IF ANY:

*See Instructions On Reverse Side

NEW MEXICO OIL CONSERVATION COMMISSION
WELL LOCATION AND ACREAGE DEDICATION PLAT

Form 7-1-2
Supersedes C-128
Effective 1-1-69

All distances must be from the outer boundaries of the Section

EL PASO NATURAL GAS COMPANY		STOREY		(SF-078566)	7
P	35	28-N	8-W	SAN JUAN	
Actual Section Containing Well:					
950	SOUTH		820	EAST	
6827	PICTURED CLIFFS		SOUTH BLANCO PICTURED CLIFFS		154.15 Acres

- Outline the acreage dedicated to the subject well by colored pencil or hatchure marks on the plat below.
- If more than one lease is dedicated to the well, outline each and identify the ownership thereof (both as to working interest and royalty).
- If more than one lease of different ownership is dedicated to the well, have the interests actually been consolidated by communitization, unitization, force-pooling, etc?

☐ Yes ☐ No If answer is "yes," type of consolidation _____

If answer is "no," list the owners and tract descriptions which have actually been consolidated (to reverse side of this form if necessary.) _____

No allowable will be assigned to the well until all interests have been consolidated (by communitization, unitization, forced-pooling, or otherwise) or until a non-standard unit, eliminating such interests, has been approved by the Commission.

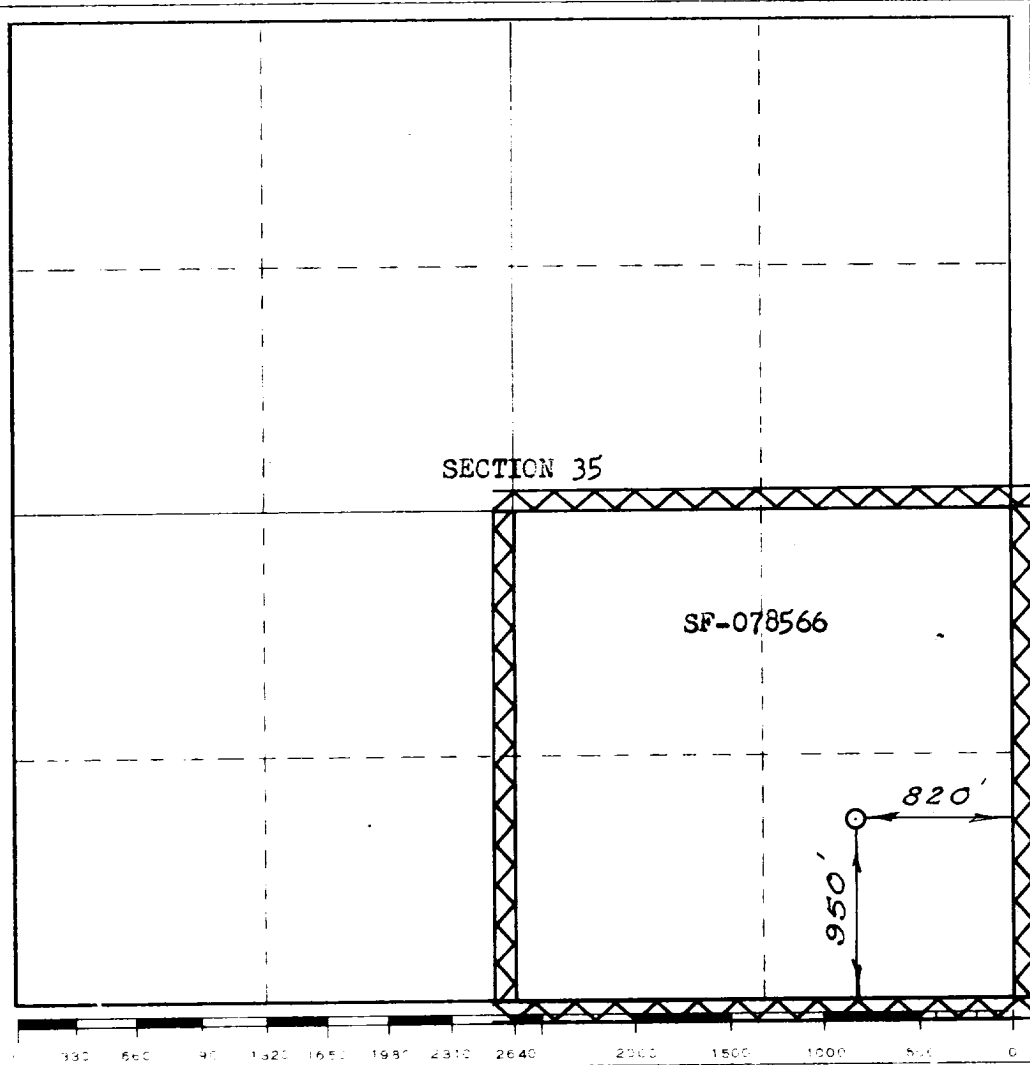
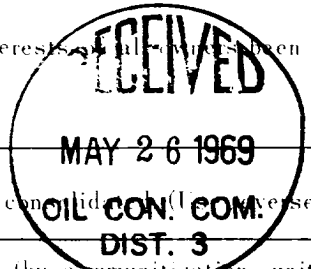

CERTIFICATION

I hereby certify that the information contained herein is true and complete to the best of my knowledge and belief.

Original Signed By:

Name **L. O. Van Ryan**
Petroleum Engineer
Company **El Paso Natural Gas Co.**
Date **May 21, 1969**

I hereby certify that the well location shown on this plat was plotted from field notes of actual surveys made by me or under my supervision, and that the same is true and correct to the best of my knowledge and belief.

Date **JANUARY 13, 1969**
Signature *David J. Wilson*
1760