

UNITED STATES  
DEPARTMENT OF THE INTERIOR  
GEOLOGICAL SURVEY30-045-20689  
5. LEASE DESIGNATION AND SERIAL NO.  
NM 12033  
6. IF INDIAN, ALLOTTEE OR TRIBE NAME

7. UNIT AGREEMENT NAME

8. FARM OR LEASE NAME

Nassau

9. WELL NO.

2

10. FIELD AND POOL, OR WILDCAT

Basin Dakota ✓

11. SEC., T., R., M., OR BLK.  
AND SURVEY OR AREA

Sec. 24, T27N, R13W

12. COUNTY OR PARISH 13. STATE

San Juan

N. M.

## APPLICATION FOR PERMIT TO DRILL, DEEPEN, OR PLUG BACK

1a. TYPE OF WORK

DRILL ☒DEEPEN ☐PLUG BACK ☐

b. TYPE OF WELL

OIL  
WELL ☐GAS  
WELL ☒

OTHER

SINGLE  
ZONE ☐MULTIPLE  
ZONE ☐

2. NAME OF OPERATOR

Jerome P. McHugh

3. ADDRESS OF OPERATOR

Box 234, Farmington, N. M. 87401

4. LOCATION OF WELL (Report location clearly and in accordance with any State requirements.)\*  
At surface

At proposed prod. zone 840' fnl 1850' fwl

14. DISTANCE IN MILES AND DIRECTION FROM NEAREST TOWN OR POST OFFICE\*

15 miles south of Farmington, N. M.

15. DISTANCE FROM PROPOSED\*

LOCATION TO NEAREST  
PROPERTY OR LEASE LINE, FT.  
(Also to nearest drig. unit line, if any)

840'

16. NO. OF ACRES IN LEASE

480

17. NO. OF ACRES ASSIGNED

TO THIS WELL

320

18. DISTANCE FROM PROPOSED LOCATION\*  
TO NEAREST WELL, DRILLING, COMPLETED,  
OR APPLIED FOR, ON THIS LEASE, FT.

---

19. PROPOSED DEPTH

6350'

20. ROTARY OR CABLE TOOLS

Rotary

21. ELEVATIONS (Show whether DF, RT, GR, etc.)

5901' Gr.

22. APPROX. DATE WORK WILL START\*

8/22/70

23.

## PROPOSED CASING AND CEMENTING PROGRAM

SIZE OF HOLE	SIZE OF CASING	WEIGHT PER FOOT	SETTING DEPTH	QUANTITY OF CEMENT
12 1/2"	8 5/8"	24#	200'	175 sx.
7 7/8"	4 1/2"	10.5#	6350'	500 - 2 stage

Drill well with mud to test Dakota formation. If productive set-4 1/2" casing, selectively perforate, fracture, clean out, run tubing and put well on production.

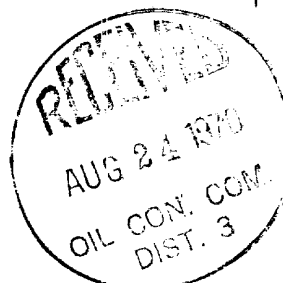

RECEIVED

AUG 20 1970

U. S. GEOLOGICAL SURVEY

IN ABOVE SPACE DESCRIBE PROPOSED PROGRAM: If proposal is to deepen or plug back, give data on present productive zone and proposed new productive zone. If proposal is to drill or deepen directionally, give pertinent data on subsurface locations and measured and true vertical depths. Give blowout preventer program, if any.

24.

Original signed by T. A. Dugan

TITLE Engineer

DATE 8/18/70

(This space for Federal or State office use)

PERMIT NO.

APPROVAL DATE

APPROVED BY

TITLE

DATE

CONDITIONS OF APPROVAL, IF ANY:

\*See Instructions On Reverse Side

**NEW MEXICO OIL CONSERVATION COMMISSION  
WELL LOCATION AND ACERAGE DEDICATION PLAT**

All distances must be from the outer boundaries of the Section

Operator <b>JEROME P. McHUGH</b>			Lease <b>Nassau</b>		Well No. <b>2</b>
Unit Letter <b>C</b>	Section <b>24</b>	Township <b>27 North</b>	Range <b>13 West</b>	County <b>San Juan</b>	

Actual Footage Location of Well:

<b>840</b>	feet from the <b>North</b>	line and	<b>1850</b>	feet from the <b>West</b>	line
Ground Level Elev <b>5901</b>	Producing Formation <b>Dakota</b>	Pool <b>Basin</b>	Dedicated Average <b>320</b>		Acres

1. Outline the acreage dedicated to the subject well by colored pencil or hatchure marks on the plat below.
2. If more than one lease is dedicated to the well, outline each and identify the ownership thereof (both as to working interest and royalty),
3. If more than one lease of different ownership is dedicated to the well, have the interests of all owners been consolidated by communization, unitization, force-pooling, etc?

( ) Yes ( ) No If answer is "yes," type of consolidation .....

If answer is "no," list the owners and tract descriptions which have actually consolidated. (Use reverse side of this form if necessary.) .....

No allowable will be assigned to the well until all interests have been consolidated (by communization, unitization, forced-pooling, or otherwise) or until a non standard unit, eliminating such interests, has been approved by the Commission.

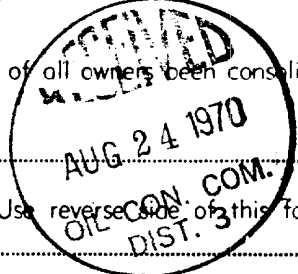

**CERTIFICATION**

I hereby certify that the information contained herein is true and complete to the best of my knowledge and belief.

Original signed by T. A. Dugan

Name

Thomas A. Dugan

Position

Engineer

Company

Jerome P. McHugh

Date

8/18/70

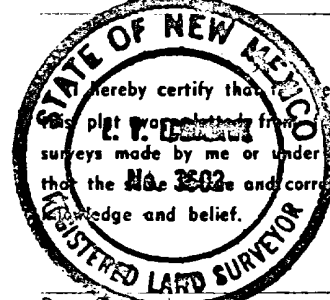

I hereby certify that the well location shown on this plat was determined from field notes of actual surveys made by me or under my supervision, and that the same are true and correct to the best of my knowledge and belief.

Date Surveyed

July 24, 1970

Registered Professional Engineer  
and/or Land Surveyor

*E. H. Echols*  
Certificate No. 3602

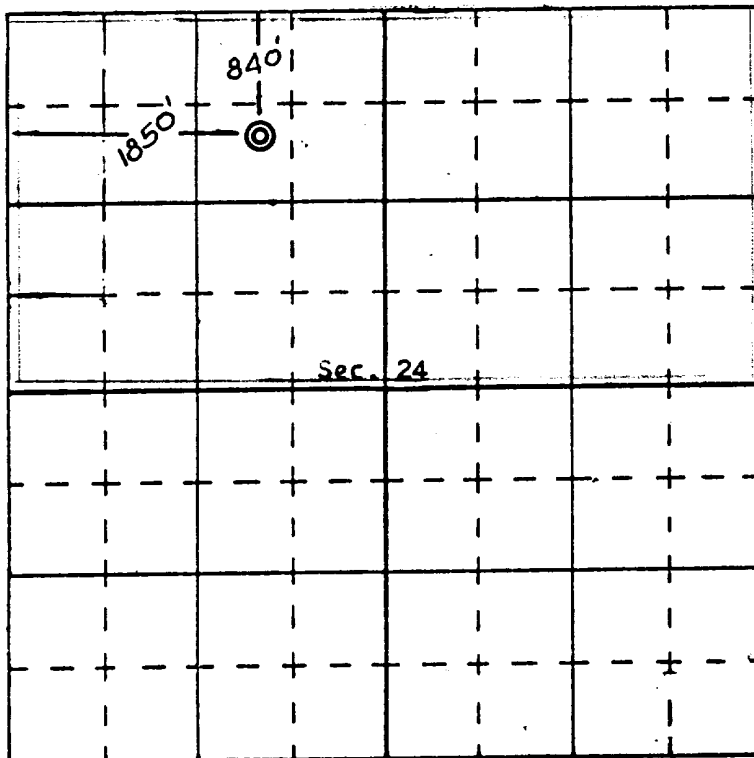

N