

NEW MEXICO OIL CONSERVATION COM.
WELL LOCATION AND ACREAGE DEDICATION PLAT

Supersedes O-128
Effective 1-1-75

All distances must be from the outer boundaries of the Section.

Lease		Well No.	
Amoco Production Company		2	
Section	Range	Township	County
16	10N	27N	San Juan
Section of Well			
1770	feet from the South line and	940	feet from the West line
Producing Formation		Pore	Dedicated Acreage
5927 ungr. Pictured Cliffs		Fulcher Kutz Pictured Cliffs	160

- Outline the acreage dedicated to the subject well by colored pencil or hachure marks on the plat below.
- If more than one lease is dedicated to the well, outline each and identify the ownership thereof (including interest and royalty).
- If more than one lease of different ownership is dedicated to the well, have the interests of all owners been consolidated by communitization, unitization, force-pooling, etc?

☐ Yes ☐ No If answer is "yes," type of consolidation _____

If answer is "no," list the owners and tract descriptions which have actually been consolidated. (Use reverse side of this form if necessary.) _____

No allowable will be assigned to the well until all interests have been consolidated (by communitization, unitization, forced-pooling, or otherwise) or until a non-standard unit, eliminating such interests, has been approved by the Commission.

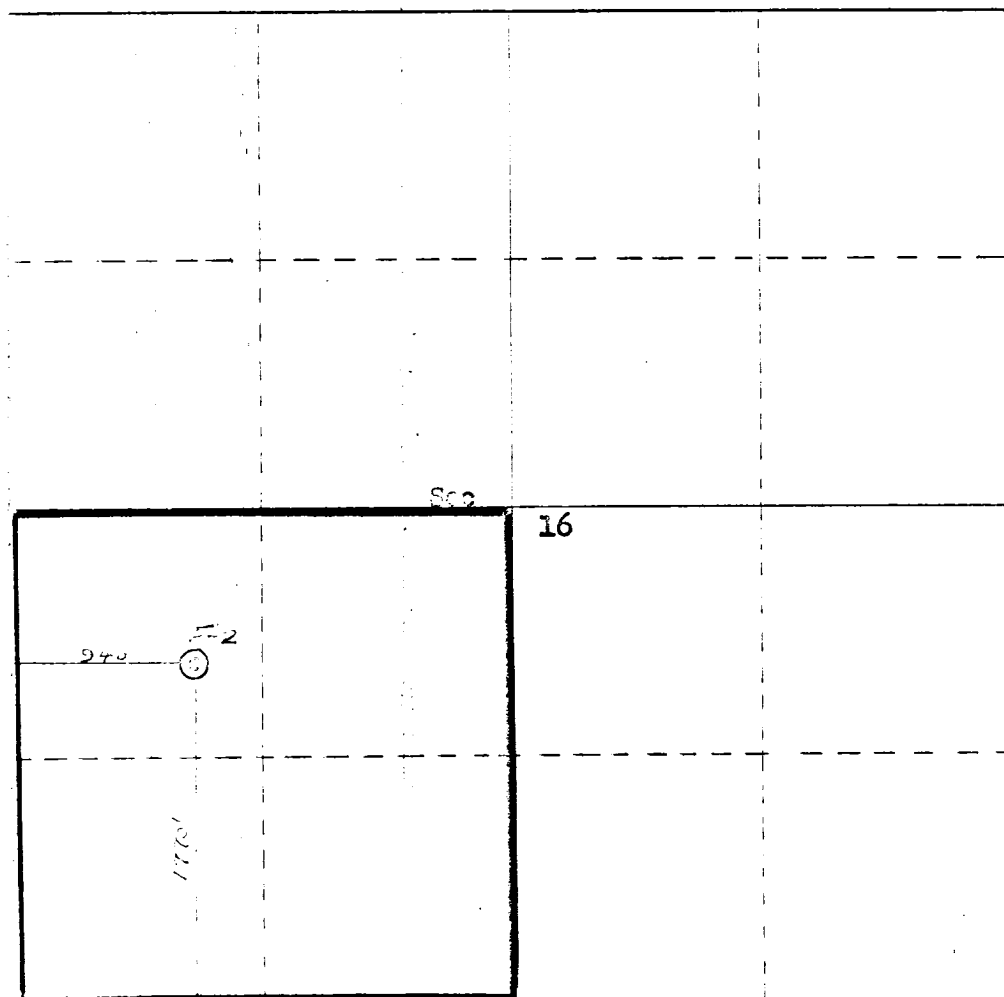

CERTIFICATION

I hereby certify that the information contained herein is true and complete to the best of my knowledge and belief.

Name

J. Arnold Snell

Position

Area Engineer

Company

AMOCO PRODUCTION COMPANY

Date

September 27, 1972

I hereby certify that the well location shown on this plat was plotted from field notes of actual surveys made by me or under my supervision, and that the same is true and correct to the best of my knowledge and belief.

Date Surveyed

September 25, 1972

Registered Professional Engineer and/or Land Surveyor

[Signature]
Fred J. Acree, Jr.

Certification No.

3950

1000 1650 2300 2640 3000 3650 4300 4950 5600