

UNITED STATES
DEPARTMENT OF THE INTERIOR
GEOLOGICAL SURVEY

APPLICATION FOR PERMIT TO DRILL, DEEPEN, OR PLUG BACK

1a. TYPE OF WORK DRILL <input checked="" type="checkbox"/> DEEPEN <input type="checkbox"/> PLUG BACK <input type="checkbox"/>		5. LEASE DESIGNATION AND SERIAL NO. Comm. #4703
b. TYPE OF WELL OIL WELL <input type="checkbox"/> GAS WELL <input checked="" type="checkbox"/> OTHER <input type="checkbox"/> SINGLE ZONE <input checked="" type="checkbox"/> MULTIPLE ZONE <input type="checkbox"/>		7. UNIT AGREEMENT NAME
2. NAME OF OPERATOR Petroleum Corporation of Texas		8. FARM OR LEASE NAME Kutz-Government
3. ADDRESS OF OPERATOR Box 911, Breckenridge, Texas 76024		9. WELL NO. 6-Y
4. LOCATION OF WELL (Report location clearly and in accordance with any State requirements.)* At surface 1640' FNL and 1190' FEL At proposed prod. zone Same as above		10. FIELD AND POOL, OR WILDCAT Fulcher Kutz (PC)
14. DISTANCE IN MILES AND DIRECTION FROM NEAREST TOWN OR POST OFFICE* Approx. 7½ miles SE Bloomfield, New Mexico		11. SEC., T., R., S., OR BLK. AND SURVEY OR AREA Unit H Sec. 3, T27N, R10W
15. DISTANCE FROM PROPOSED* LOCATION TO NEAREST PROPERTY OR LEASE LINE, FT. (Also to nearest drg. unit line, if any) 1190'	16. NO. OF ACRES IN LEASE 160	17. NO. OF ACRES ASSIGNED TO THIS WELL 160 16/28
18. DISTANCE FROM PROPOSED* LOCATION TO NEAREST WELL, DRILLING COMPLETED, OR APPLIED FOR, ON THIS LEASE, FT. 870'	19. PROPOSED DEPTH 2200'	20. ROTARY OR CABLE TOOLS Rotary
21. ELEVATIONS (Show whether DF, RT, GR, etc.) 5990' GR		22. APPROX. DATE WORK WILL START* 3-1-73

23. PROPOSED CASING AND CEMENTING PROGRAM

SIZE OF HOLE	SIZE OF CASING	WEIGHT PER FOOT	SETTING DEPTH	QUANTITY OF CEMENT
12"	8-5/8"	24#	110' [±]	75 sx.
7-7/8"	5-1/2"	15.5#	2200'	250 sx.

Propose to drill 12" hole to 110'[±], set 8-5/8" csg., cement w/75 sx.
Drill 7-7/8" hole to TD 2200', set 5½" casing, cement w/250 sx.
Perforate and frac Pictured Cliffs formation.
Run 1" tubing.



IN ABOVE SPACE DESCRIBE PROPOSED PROGRAM: If proposal is to deepen or plug back, give data on present productive zone and proposed new productive zone. If proposal is to drill or deepen directionally, give pertinent data on subsurface locations and measured and true vertical depths. Give blowout preventer program, if any.

24. SIGNED Mary B. Saylor TITLE Production Clerk DATE 1-23-73
(This space for Federal or State office use)

PERMIT NO. _____ APPROVAL DATE _____
APPROVED BY ra TITLE _____ DATE _____
CONDITIONS OF APPROVAL, IF ANY:

*See Instructions On Reverse Side

**NEW MEXICO OIL CONSERVATION COMMISSION
WELL LOCATION AND ACERAGE DEDICATION PLAT**

All distances must be from the outer boundaries of the Section

Operator Petroleum Corporation of Texas			Lease Kutz-Government		Well No. 6-Y
Unit Letter H	Section 3	Township 27 North	Range 10 West	County San Juan	
Actual Footage Location of Well:					
1640 feet from the North line and		1190 feet from the East line			
Ground Level Elev. 5990	Producing Formation Pictured Cliffs	Pool Fulcher Kutz	Dedicated Acreage: 161.28 160		Acres

1. Outline the acreage dedicated to the subject well by colored pencil or hachure marks on the plat below.
2. If more than one lease is dedicated to the well, outline each and identify the ownership thereof (both as to working interest and royalty).
3. If more than one lease of different ownership is dedicated to the well, have the interests of all owners been consolidated by communitization, unitization, force-pooling, etc?

() Yes () No If answer is "yes," type of consolidation

If answer is "no," list the owners and tract descriptions which have actually consolidated. (Use reverse side of this form if necessary.)

No allowable will be assigned to the well until all interests have been consolidated (by communitization, unitization, forced-pooling, or otherwise) or until a non standard unit, eliminating such interests, has been approved by the Commission.

CERTIFICATION

I hereby certify that the information contained herein is true and complete to the best of my knowledge and belief.

Mary B. Taylor
 Name Mary B. Taylor
 Position Production Clerk
Petroleum Corporation of Texas
 Company
January 25, 1973
 Date

I hereby certify that the well location shown on this plat was plotted from field notes of actual surveys made by me or under my supervision, and that the same is true and correct to the best of my knowledge and belief.

E. V. Echohawk
 Date Surveyed January 11, 1973
 Registered Professional Engineer
 and/or Land Surveyor

Certificate No. 3602
E. V. Echohawk LS

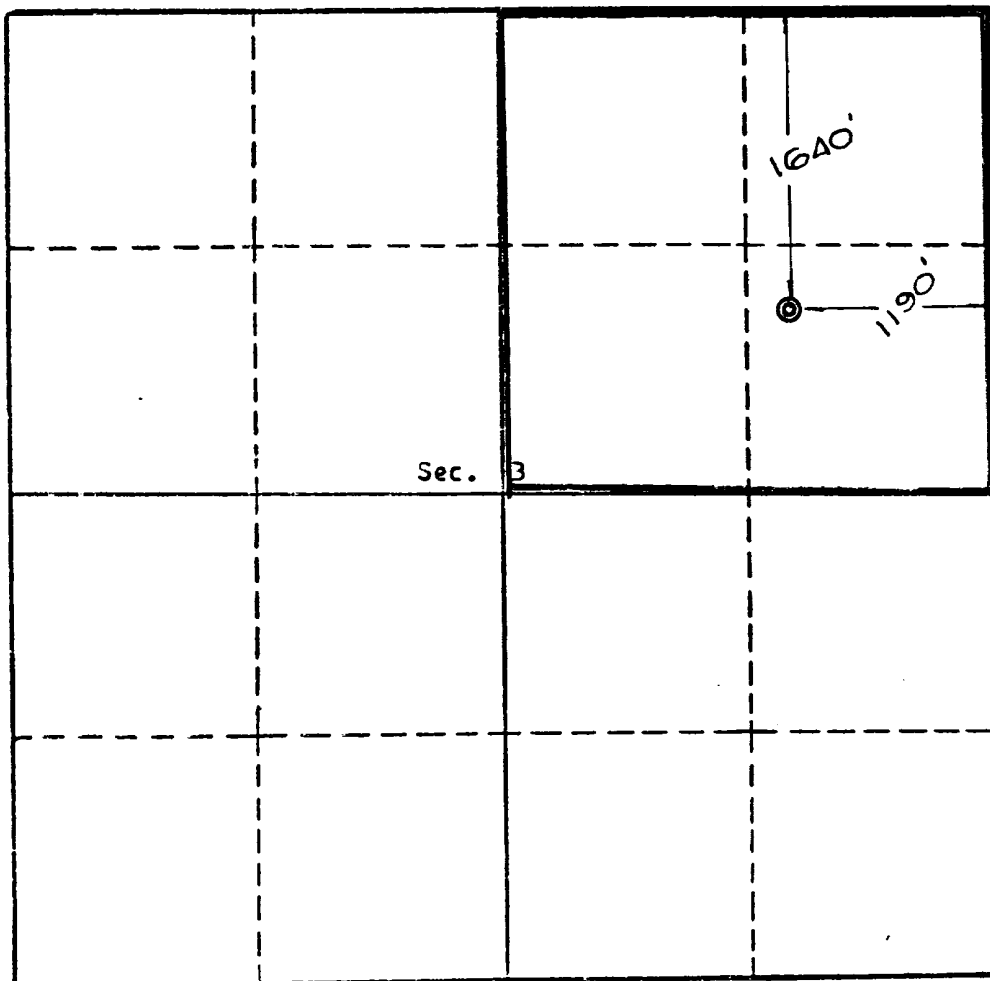

Scale, 1 inch = 1,000 feet