

UNITED STATES
DEPARTMENT OF THE INTERIOR
GEOLOGICAL SURVEY

30-045-212.57

APPLICATION FOR PERMIT TO DRILL, DEEPEN, OR PLUG BACK

1a. TYPE OF WORK

DRILL ☒DEEPEN ☐PLUG BACK ☐

b. TYPE OF WELL

OIL
WELL ☐GAS
WELL ☒OTHER ☐SINGLE
ZONE ☒MULTIPLE
ZONE ☐

2. NAME OF OPERATOR

Lively Exploration Company

3. ADDRESS OF OPERATOR

P. O. Box 234, Farmington, New Mexico 87401

4. LOCATION OF WELL (Report location clearly and in accordance with any State requirements.)*

At surface

480' FNL - 590' FEL

At proposed prod. zone

14. DISTANCE IN MILES AND DIRECTION FROM NEAREST TOWN OR POST OFFICE*

10 miles southeast Blanco, New Mexico

16. DISTANCE FROM PROPOSED*

LOCATION TO NEAREST

PROPERTY OR LEASE LINE, FT.

(Also to nearest drlg. unit line, if any)

480'

18. DISTANCE FROM PROPOSED LOCATION*

TO NEAREST WELL, DRILLING, COMPLETED,

OR APPLIED FOR, ON THIS LEASE, FT.

1500 approx.

16. NO. OF ACRES IN LEASE

19. PROPOSED DEPTH

6700'

17. NO. OF ACRES ASSIGNED

TO THIS WELL

312.11

20. ROTARY OR CABLE TOOLS

Rotary

21. ELEVATIONS (Show whether DF, RT, GR, etc.)

5755' GR

22. APPROX. DATE WORK WILL START*

3-20-73

23.

PROPOSED CASING AND CEMENTING PROGRAM

| SIZE OF HOLE | SIZE OF CASING | WEIGHT PER FOOT | SETTING DEPTH | QUANTITY OF CEMENT |
|--------------|----------------|-----------------|---------------|--------------------|
| 13-3/4" | 9-5/8" | 32.30# | 250' | 225 cu. ft. |
| 8-3/4" | 7" | 20# | 2525' | 600 cu. ft. |
| 6-1/4" | 4-1/2" | 10.5# | 6700' | 600 cu. ft. |

Plan to drill with water or minimum mud to 2525', set 7" intermediate casing, and cement with 600 cu. ft. cement. Drill 6-1/4" hole with gas to T.D. to test Dakota formation. Run 4-1/2" production casing through Dakota, selectively perforate and sand-water frac, clean out, run 1-1/4" tubing, and complete well.



IN ABOVE SPACE DESCRIBE PROPOSED PROGRAM: If proposal is to deepen or plug back, give data on present productive zone and proposed new productive zone. If proposal is to drill or deepen directionally, give pertinent data on subsurface locations and measured and true vertical depths. Give blowout preventer program, if any.

24.

Original signed by T. A. Dugan

SIGNED

Thomas A. Dugan

TITLE

Engineer

DATE

3-12-73

(This space for Federal or State office use)

PERMIT NO.

APPROVAL DATE

APPROVED BY

TITLE

DATE

CONDITIONS OF APPROVAL, IF ANY:

MAR 14 1973

*See Instructions On Reverse Side

U. S. GEOLOGICAL SURVEY

**NEW MEXICO OIL CONSERVATION COMMISSION
WELL LOCATION AND ACREAGE DEDICATION PLAT**

Form C-102
Supersedes C-128
Effective 1-1-65

All distances must be from the outer boundaries of the Section.

| | | | | | |
|--|--------------------------------------|-----------------------------|-----------------------------|---|-----------------------|
| Operator Lively Exploration Company | | | Lease Lively | | Well No. 13 |
| Unit Letter A | Section 18 | Township 28 North | Range 8 West | County San Juan | |
| Actual Footage Location of Well: 480 feet from the North line and 590 feet from the East line | | | | | |
| Ground Level Elev. 5755 | Producing Formation Dakota | | Pool Basin Dakota | Dedicated Acreage: 312.11 Acres | |

1. Outline the acreage dedicated to the subject well by colored pencil or hatchure marks on the plat below.
2. If more than one lease is dedicated to the well, outline each and identify the ownership thereof (both as to working interest and royalty).
3. If more than one lease of different ownership is dedicated to the well, have the interests of all interests been consolidated by communitization, unitization, force-pooling, etc?

☐ Yes ☐ No If answer is "yes," type of consolidation _____

If answer is "no," list the owners and tract descriptions which have actually been consolidated. (Use reverse side of this form if necessary.) _____

No allowable will be assigned to the well until all interests have been consolidated (by communitization, unitization, forced-pooling, or otherwise) or until a non-standard unit, eliminating such interests, has been approved by the Commission.

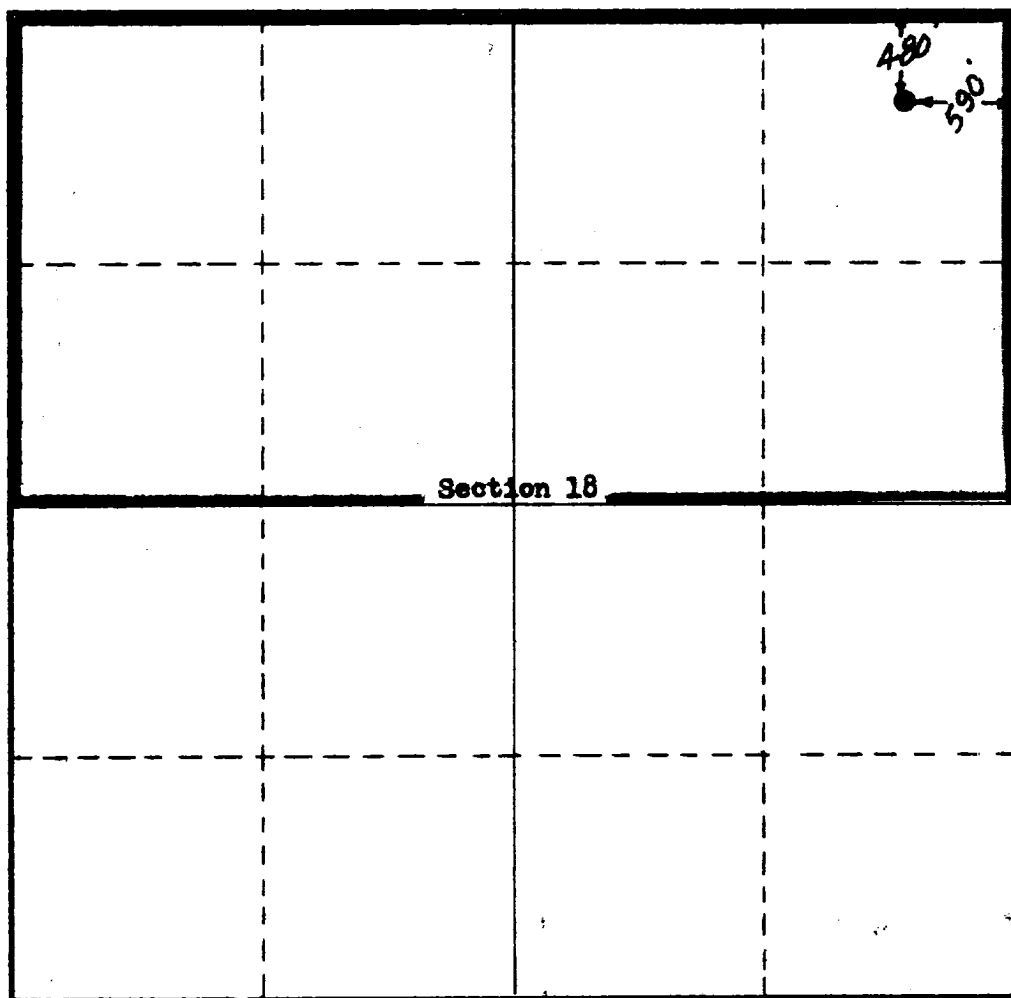
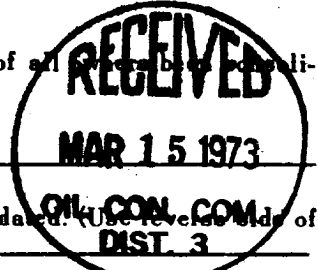

CERTIFICATION

I hereby certify that the information contained herein is true and complete to the best of my knowledge and belief.

Original signed by T. A. Dugan

Name
Thomas A. Dugan

Position
Engineer

Company
Lively Exploration Co.

Date
3-12-73

I hereby certify that the well location shown on this plat was plotted from field notes of actual surveys made by me or under my supervision, and that the same is true and correct to the best of my knowledge and belief.

Date Surveyed
January 12, 1973

Registered Professional Engineer and
3084

Certified
STATE OF NEW MEXICO

