

UNITED STATES  
DEPARTMENT OF THE INTERIOR  
BUREAU OF LAND MANAGEMENT

APPLICATION FOR PERMIT TO DRILL, DEEPEN, OR PLUG BACK

1a. TYPE OF WORK PLUG BACK	5. LEASE NUMBER USA-NM-03017
1b. TYPE OF WELL GAS	6. IF INDIAN, ALL. OR TRIBE NAME
2. OPERATOR <del>MERIDIAN OIL, INC.</del> <i>Meridian Oil Inc.</i>	7. UNIT AGREEMENT NAME HUERFANO UNIT
3. ADDRESS & PHONE NO. OF OPERATOR P.O. BOX 4289 FARMINGTON, NM 87499 (505) 326-9700	8. FARM OR LEASE NAME
4. LOCATION OF WELL  1840' FNL; 1840' FWL	9. WELL NO. NP #257
14. DISTANCE IN MILES FROM NEAREST TOWN	10. FIELD, POOL, OR WILDCAT BASIN FRUITLAND COAL
	11. SEC. T. R. M OR BLK. <i>F</i> SEC. 36, T27N, R10W
	12. COUNTY SAN JUAN
	13. STATE NM
15. DISTANCE FROM PROPOSED LOCATION TO NEAREST PROPERTY OR LEASE LINE.	16. ACRES IN LEASE
	17. ACRES ASSIGNED TO WELL 320.00
18. DISTANCE FROM PROPOSED LOCATION TO NEAREST WELL DR. COMPL., OR APPLIED FOR ON THIS LEASE.	19. PROPOSED DEPTH
	20. ROTARY OR CABLE TOOLS
21. ELEVATIONS (DF, FT, GR, ETC.) 6492' GL	22. APPROX. DATE WORK WILL START
23. PROPOSED CASING AND CEMENTING PROGRAM	
*SEE OPERATIONS PLAN	
24. AUTHORIZED BY: <i>[Signature]</i> (SHL) REGULATORY AFFAIRS	<i>7-26-90</i> DATE

PERMIT NO. \_\_\_\_\_ APPROVAL DATE \_\_\_\_\_

APPROVED BY \_\_\_\_\_ TITLE \_\_\_\_\_ DATE \_\_\_\_\_

NOTE: THIS FORMAT IS ISSUED IN LIEU OF US BLM FORM 3160-3.  
(NO ADDITIONAL DIRT WORK WILL BE REQUIRED)

APPROVED

AUG 13 1990

AREA MANAGER

*Hold C-104 FOR NSL*

NEW MEXICO OIL CONSERVATION COMMISSION  
WELL LOCATION AND ACREAGE DEDICATION PLAT

Form C-102  
Supersedes C-128  
Effective 1-1-65

All distances must be from the outer boundaries of the Section.

Operator <b>EL PASO NATURAL GAS COMPANY</b>		Lease <b>HUERFANO UNIT (NM-03017)</b>		Well No. <b>257</b>
Unit Letter <b>F</b>	Section <b>36</b>	Township <b>27-N</b>	Range <b>10-W</b>	County <b>SAN JUAN</b>
Actual Footage Location of Well: <b>1840</b> feet from the <b>NORTH</b> line and <b>1840</b> feet from the <b>WEST</b> line				
Ground Level Elev. <b>6492</b>	Producing Formation <b>Fruitland Coal</b>	Pool <b>Basin</b>	Dedicated Acreage: <b>320.00</b> Acres	

1. Outline the acreage dedicated to the subject well by colored pencil or hachure marks on the plat below.
2. If more than one lease is dedicated to the well, outline each and identify the ownership thereof (both as to working interest and royalty).
3. If more than one lease of different ownership is dedicated to the well, have the interests of all owners been consolidated by communitization, unitization, force-pooling, etc?

☒ Yes ☐ No If answer is "yes," type of consolidation Unitization

If answer is "no," list the owners and tract descriptions which have actually been consolidated. (Use reverse side of this form if necessary.)

No allowable will be assigned to the well until all interests have been consolidated (by communitization, unitization, forced-pooling, or otherwise) or until a non-standard unit, eliminating such interests, has been approved by the Commission.

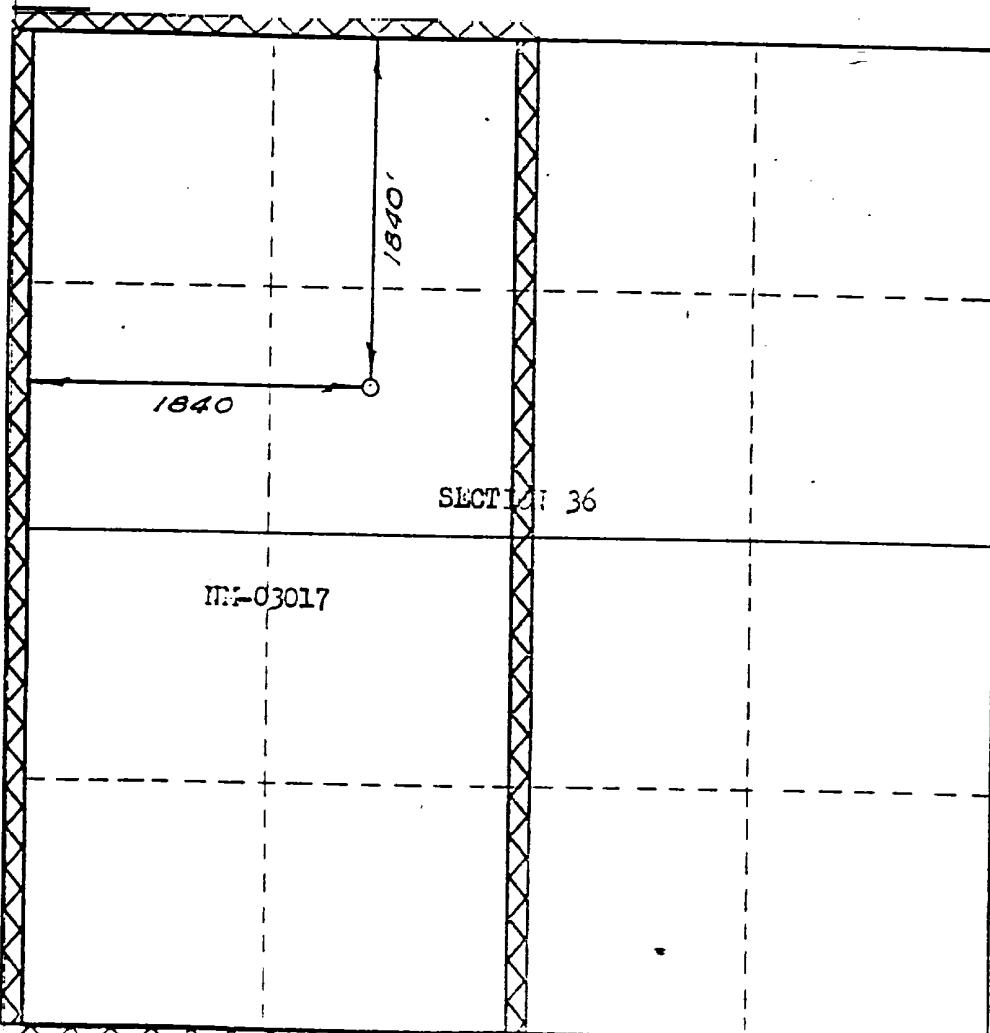

CERTIFICATION

I hereby certify that the information contained herein is true and complete to the best of my knowledge and belief.

Name  
Regulatory Affairs  
Position  
El Paso Natural Gas Company  
Company  
Date  
July 26, 1990

I hereby certify that the well location shown on this plat was plotted from field notes of actual surveys made by me or under my supervision, and that the same is true and correct to the best of my knowledge and belief.

Date Surveyed  
DECEMBER 11, 1973

Registered Professional Engineer and/or Land Surveyor

Paul Wilbur  
Certificate No. 1760

0 330 660 990 1320 1650 1980 2310 2640 2000 1500 1000 500 0

RECOMPLETION PROCEDURE  
HUERFANO UNIT NP #257

1. Load hole with water.
2. TOOH with tubing.
3. Run GR-CCL-CNL. Pick perforations from log.
5. Set a <sup>1</sup>/<sub>2</sub>" CIBP as close to the bottom Fruitland coal perforation as possible. Pressure test casing to 1000 psi for 15 minutes.
6. Perforate across the coal. Projected zones to be selected from CNL log run.
7. TIH with tubing and swab wellbore dry.
8. Clean out to CIBP.
9. Land tubing near bottom perforation. Swab well in. Record final 30, 45, and 60 minute gauges on morning report. ND BOP. NU tree. RD and release rig.
10. Evaluate well's performance for possible fracture stimulation. A fracture stimulation procedure will be provided if necessary.

NO WORK WILL BE PERFORMED OFF APPROVED WELL PAD

HUERFANO UNIT NP #257

RECOMPLETION PROCEDURE  
GALLUP PLUG AND ABANDONMENT

**\*\*NO WORK IS TO BE PERFORMED OR EQUIPMENT TO BE LOCATED OFF APPROVED WELL PAD\*\***

1. MOL and RU. ND wellhead. NU BOP. Load hole with water.
2. TOOH with tubing.
3. PU 4 1/2" casing scraper on 2 3/8" 4.7# J-55 EUE tubing and TIH to 6164'.  
TOOH.
4. TIH. Establish a rate into the Gallup perforations. Spot a cement plug from 6164'-5782' with 43 sx of Class B neat cement (51 cf, 50% excess to cover 50' above the top of the Gallup). Pull up to 5782' and circulate the casing with 92 bbls of 9.0 PPG mud with a minimum viscosity of 50 sec/qt. TOOH. Tag cement top with wireline after 4 hours.
5. Perforate 4 squeeze holes at 3865'. Establish a rate into the perforations with water. Set a 4 1/2" cement retainer at 3765'. TIH with 2 3/8" tubing and sting into test position in cement retainer. Pressure test tubing to 1000 psi. Establish rate into perforations with water. Squeeze cement with 50 sx of Class B neat cement (59 cf, 100% excess to cover 50' above the top of the Cliff House). Sting out of cement retainer and spot 6 sx Class B neat cement on top of cement retainer (7cf, 81' in 4 1/2" casing). TOOH.
6. Proceed with Fruitland recompletion.

# HUERFANO UNIT NP #257

## WELLBORE DIAGRAMS

BEFORE R/C

AFTER R/C

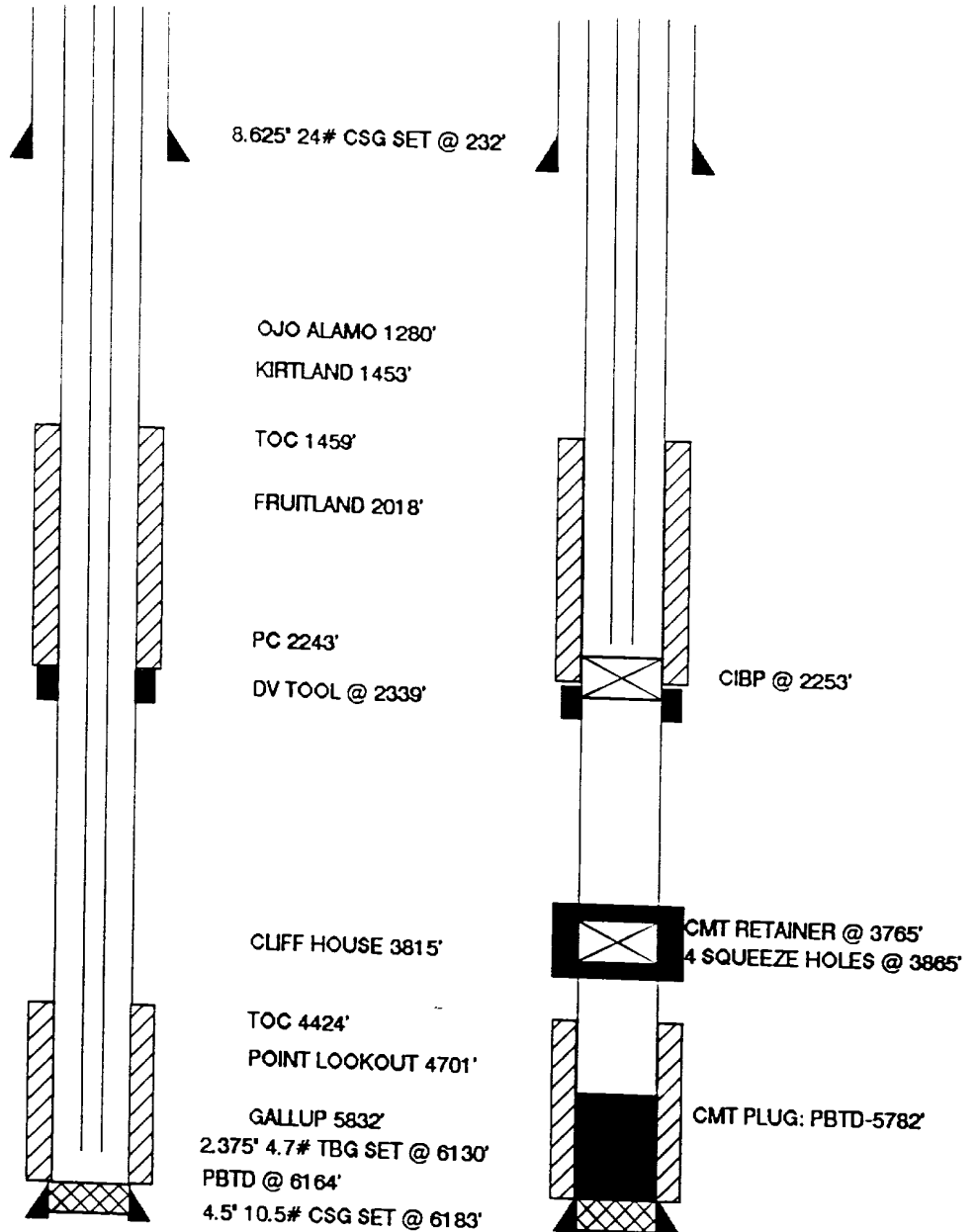

# WORKOVER / RECOMPLETION B. O. P. SCHEMATIC

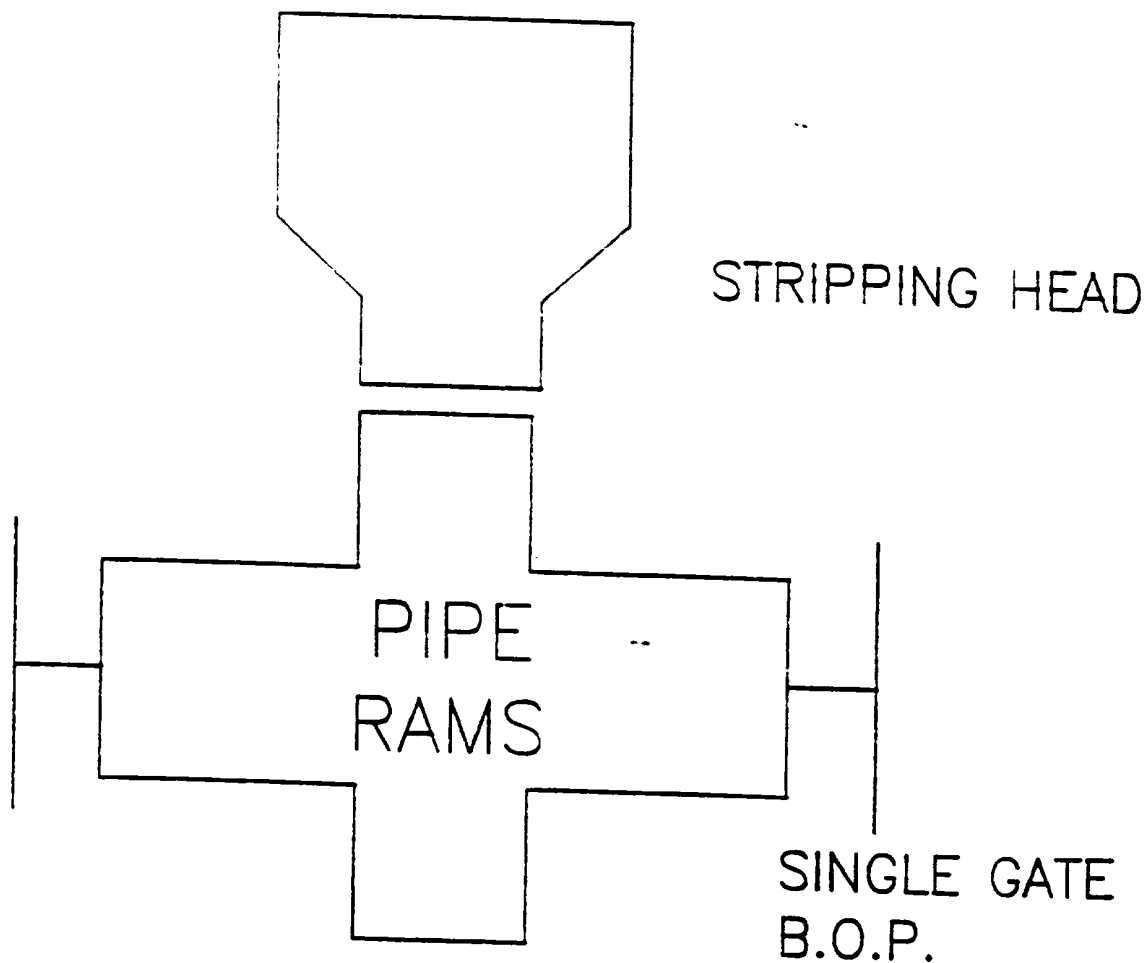

MINIMUM: 2 7/8" 1500 PSI SINGLE GATE B.O.P.

MAXIMUM ANTICIPATED SHUT-IN WELLHEAD  
PRESSURE IS LESS THAN 1500 PSI