

UNITED STATES  
DEPARTMENT OF THE INTERIOR  
BUREAU OF LAND MANAGEMENT

APPLICATION FOR PERMIT TO DRILL, DEEPEN, OR PLUG BACK

1a. TYPE OF WORK PLUG BACK	5. LEASE NUMBER NM-03017
1b. TYPE OF WELL GAS	6. IF INDIAN, ALL. OR TRIBE NAME
2. OPERATOR MERIDIAN OIL INC.	7. UNIT AGREEMENT NAME HUERFANO UNIT
3. ADDRESS & PHONE NO. OF OPERATOR P.O. BOX 4289 FARMINGTON, NM 87499 (505) 326-9700	8. FARM OR LEASE NAME HUERFANO UNIT
4. LOCATION OF WELL  990' FSL, 990' FEL	9. WELL NO. #258
14. DISTANCE IN MILES FROM NEAREST TOWN	10. FIELD, POOL, OR WILDCAT BASIN FRUITLAND COAL
	11. SEC. T. R. M OR BLK. 10 SEC. 36, T27N, R10W
	12. COUNTY SAN JUAN
	13. STATE NM
15. DISTANCE FROM PROPOSED LOCATION TO NEAREST PROPERTY OR LEASE LINE.	16. ACRES IN LEASE
	17. ACRES ASSIGNED TO WELL 300.20
18. DISTANCE FROM PROPOSED LOCATION TO NEAREST WELL DR. COMPL., OR APPLIED FOR ON THIS LEASE.	19. PROPOSED DEPTH
	20. ROTARY OR CABLE TOOLS
21. ELEVATIONS (DF, FT, GR, ETC.) 6496' GL	22. APPROX. DATE WORK WILL START

RECEIVED

NOV 20 1990

OIL CON. DIV.  
DIST. 3

23. PROPOSED CASING AND CEMENTING PROGRAM

\*SEE OPERATIONS PLAN

24. AUTHORIZED BY: Mary B. [Signature] (SHL)  
REGULATORY AFFAIRS

9-21-90  
DATE

PERMIT NO. \_\_\_\_\_ APPROVAL DATE \_\_\_\_\_

APPROVED BY \_\_\_\_\_ TITLE \_\_\_\_\_ DATE \_\_\_\_\_

NOTE: THIS FORMAT IS ISSUED IN LIEU OF US BLM FORM 3160-3.  
(NO ADDITIONAL DIRT WORK WILL BE REQUIRED)

APPROVED

NOV 09 1990

AREA MANAGER

*Hold 2-104 FOR USE  
NGL (E)*

NEW MEXICO OIL CONSERVATION COMMISSION  
WELL LOCATION AND ACREAGE DEDICATION PLAT

Form C-1-2  
Supersedes C-128  
Effective 1-1-55

All distances must be from the outer boundaries of the Section.

Operator <b>El Paso Natural Gas Company</b>		Lease <b>Huerfano Unit (NM-03017)</b>		Well No. <b>258</b>
Unit Letter <b>P</b>	Section <b>36</b>	Township <b>27-N</b>	Range <b>10-W</b>	County <b>SAN JUAN</b>
Actual Footage Location of Well: <b>990</b> feet from the <b>SOUTH</b> line and <b>990</b> feet from the <b>EAST</b> line				
Ground Level Elev. <b>5495</b>	Producing Formation <b>Fruitland Coal</b>	Pool <b>Basin</b>	Dedicated Acreage: <b>320.00</b> Acres	

1. Outline the acreage dedicated to the subject well by colored pencil or hachure marks on the plat below.
2. If more than one lease is dedicated to the well, outline each and identify the ownership thereof (both as to working interest and royalty).
3. If more than one lease of different ownership is dedicated to the well, have the interests of all owners been consolidated by communitization, unitization, force-pooling, etc?

☒ Yes ☐ No If answer is "yes," type of consolidation **Unitization**  
If answer is "no," list the owners and tract descriptions which have actually been consolidated. (Use reverse side of this form if necessary.)

No allowable will be assigned to the well until all interests have been consolidated (by communitization, unitization, forced-pooling, or otherwise) or until a non-standard unit, eliminating such interests, has been approved by the Commission.

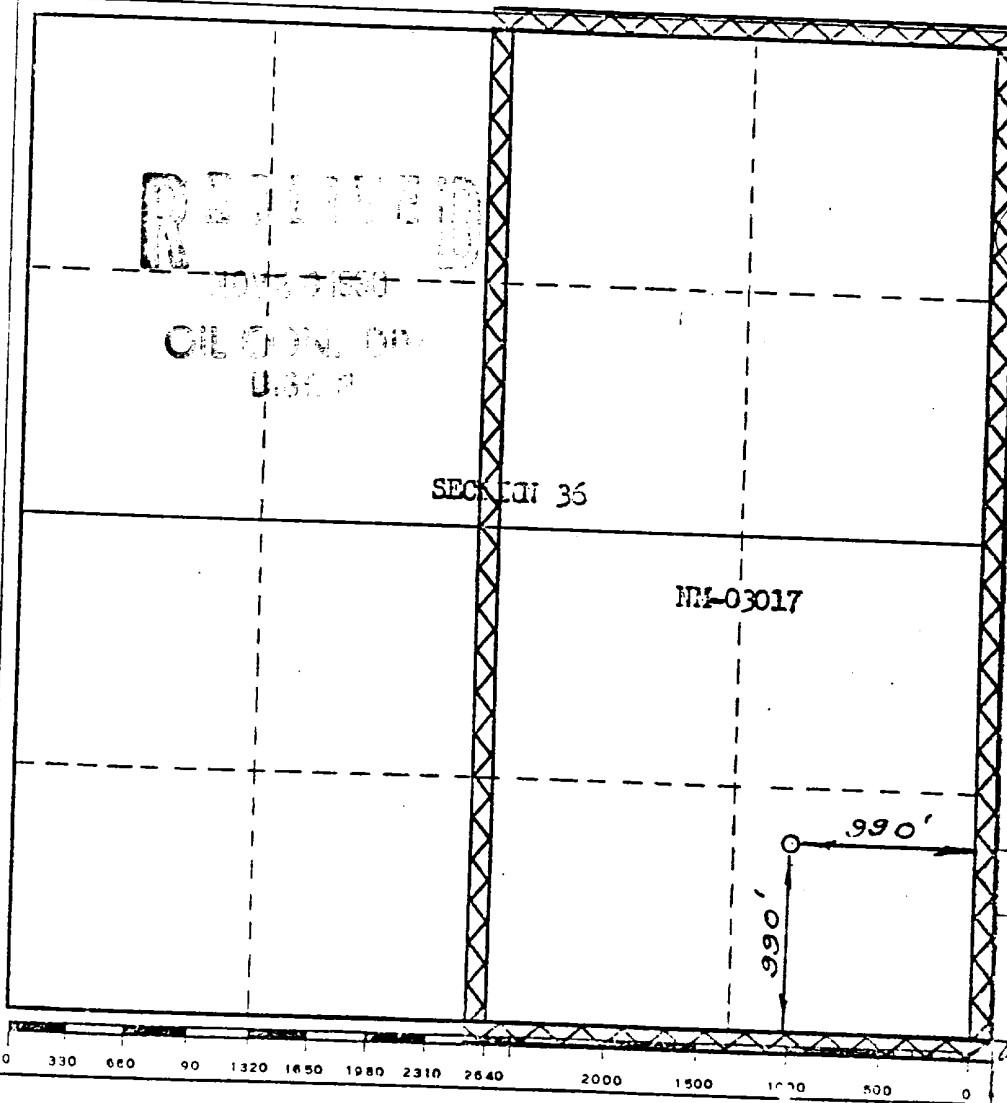

CERTIFICATION

I hereby certify that the information contained herein is true and complete to the best of my knowledge and belief.

*Peggy Bradford*  
Name

**Peggy Bradford**

Position

**Regulatory Affairs**

Company

**El Paso Natural Gas**

Date

**9-21-90**

I hereby certify that the well location shown on this plat was plotted from field notes of actual surveys made by me or under my supervision, and that the same is true and correct to the best of my knowledge and belief.

Date Surveyed

**DECEMBER 11, 1973**

Registered Professional Engineer and/or Land Surveyor

*David O'Brien*

Certificate No.

**1760**

# HUERFANO UNIT #258

## WELLBORE DIAGRAMS

BEFORE R/C

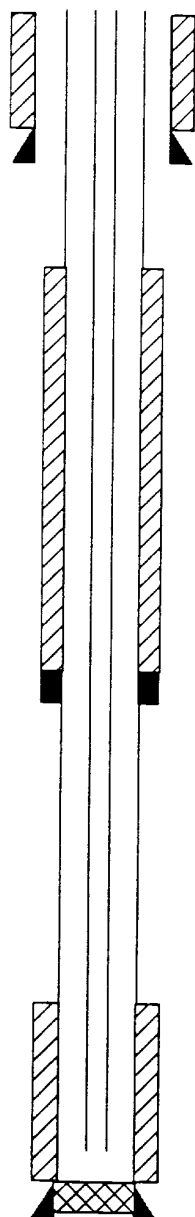

8.625" 24# CSG SET @ 208'

TOC 1300'

OJO ALAMO 1332'

KIRTLAND 1470'

FRUITLAND 2004'

PC 2240'

DV TOOL @ 2285'

CLIFF HOUSE 3806'

TOC 4427'

POINT LOOKOUT 4680'

GALLUP 5722'

2.375" 4.7# TBG SET @ 6096'

PBTD @ 6137'

4.5" 10.5# CSG SET @ 6153'

AFTER R/C

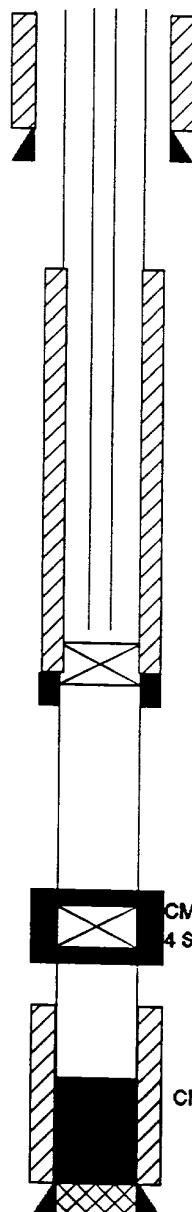

CIBP @ 2300'

CMT RETAINER @ 3756'  
4 SQUEEZE HOLES @ 3856'

CMT PLUG: PBTD-5672'

RECOMPLETION PROCEDURE  
HUERFANO UNIT #258

\*\*NO WORK IS TO BE PERFORMED OR EQUIPMENT TO BE LOCATED OFF APPROVED WELL PAD\*\*

1. Load hole with water.
2. NU low pressure packoff.
3. Logs. Pick perforations from log. TIH with 4-1/2" CIBP and set at 2300'. TOOH.
4. Pressure test casing to 1000 psi for 15 minutes.
5. Perforate coal. Projected zones to be selected from log run.
6. TIH with 2 3/8" tubing and swab wellbore dry. Check well for gas flow. Evaluate well overnight. Check well for buildup pressure and gas flow.
7. TIH with 2 3/8" tubing and clean out to 2300'.
8. Land 2 3/8" 4.7# EUE tubing with an expendable check on bottom, and a common pump seating nipple one joint off bottom. Land tubing 15 feet above bottom perforation. Swab well in. Record final 30, 45, and 60 minute gauges on morning report. ND BOP. NU tree. RD and release rig.
9. Evaluate well's performance for possible fracture stimulation. A fracture stimulation procedure will be provided if necessary.

HUERFANO UNIT #258

RECOMPLETION PROCEDURE  
GALLUP PLUG AND ABANDONMENT

**\*\*NO WORK IS TO BE PERFORMED OR EQUIPMENT TO BE LOCATED OFF APPROVED WELL PAD\*\***

1. MOL and RU. ND wellhead. NU BOP. Load hole with water.
2. TOOH with 196 joints of 2 3/8" 4.7# K-55 tubing set @ 6096'
3. PU 4 1/2" casing scraper on 2 3/8" 4.7# J-55 EUE tubing and TIH to 6137'.  
TOOH.
4. TIH. Spot a cement plug from 6137'-5672' with 53 sx of Class B neat cement (63 cf, 50% excess to cover 50' above the top of the Gallup). Pull up to 5672' and circulate the casing with 9.0 PPG mud with a minimum viscosity of 50 sec/qt. TOOH. Tag cement top with wireline after 4 hours.
5. Perforate 4 squeeze holes at 3856'. Set a 4 1/2" cement retainer at 3756'. TIH with 2 3/8" tubing and sting into test position in cement retainer. Pressure test tubing to 1000 psi. Establish rate into perforations with water. Squeeze cement with 50 sx of Class B neat cement (59 cf, 100% excess to cover 50' above the top of the Cliff House). Sting out of cement retainer and spot 6 sx Class B neat cement on top of cement retainer (7cf, 81' in 4 1/2" casing). TOOH.
6. Proceed with Fruitland recompletion.

Vendors

Wireline and Retainer: Petro

Cement: BJ Services

Approve: \_\_\_\_\_

R. F. Headrick

SHL

# WORKOVER / RECOMPLETION B.O.P. SCHEMATIC

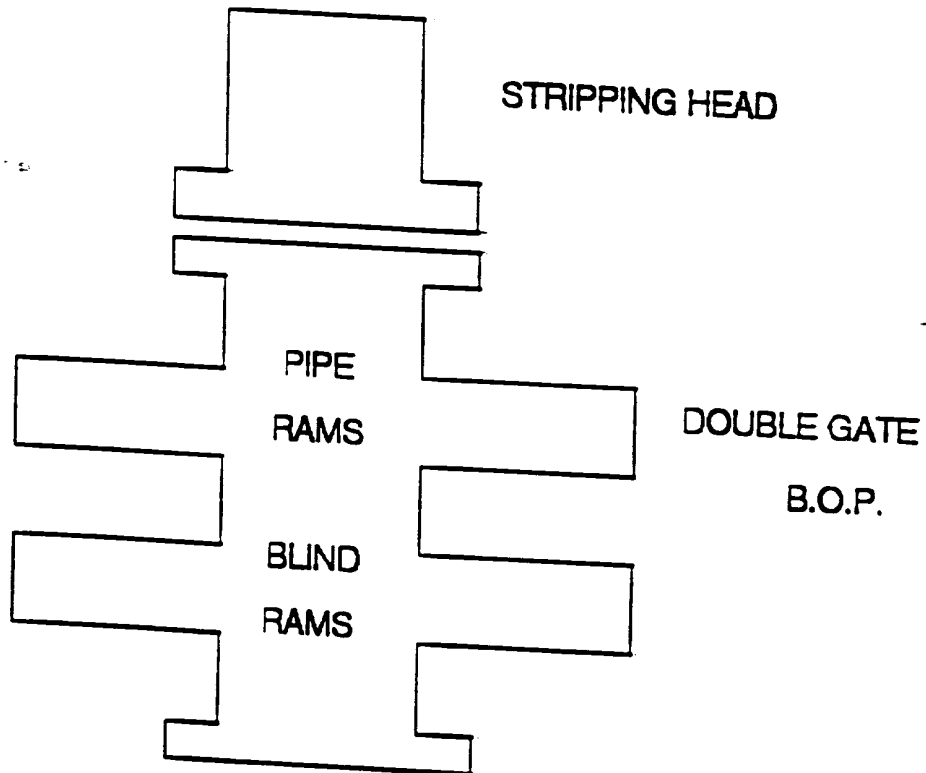

MINIMUM: 6" 2000 PSI DOUBLE GATE B.O.P.  
MAXIMUM ANTICIPATED SHUT-IN WELLHEAD  
PRESSURE IS LESS THAN 2000 PSI