

UNITED STATES
DEPARTMENT OF THE INTERIOR
GEOLOGICAL SURVEY

30-045-21413

APPLICATION FOR PERMIT TO DRILL, DEEPEN, OR PLUG BACK

1a. TYPE OF WORK

DRILL ☒DEEPEN ☐PLUG BACK ☐

b. TYPE OF WELL

OIL
WELL ☐GAS
WELL ☒

OTHER

SINGLE
ZONE ☒MULTIPLE
ZONE ☐

2. NAME OF OPERATOR

El Paso Natural Gas Company

3. ADDRESS OF OPERATOR

PO Box 990, Farmington, NM 87401

4. LOCATION OF WELL (Report location clearly and in accordance with any State requirements.)*

At surface

1180'S, 1550'E

At proposed prod. zone

14. DISTANCE IN MILES AND DIRECTION FROM NEAREST TOWN OR POST OFFICE*

15. DISTANCE FROM PROPOSED*

LOCATION TO NEAREST
PROPERTY OR LEASE LINE, FT.
(Also to nearest drill unit line, if any)18. DISTANCE FROM PROPOSED LOCATION*
TO NEAREST WELL, DRILLING, COMPLETED,
OR APPLIED FOR, ON THIS LEASE, FT.

21. ELEVATIONS (Show whether DF, RT, GR, etc.)

6515'GL

16. NO. OF ACRES IN LEASE

19. PROPOSED DEPTH
6230'17. NO. OF ACRES ASSIGNED
TO THIS WELL

320

20. ROTARY OR CABLE TOOLS
Rotary

22. APPROX. DATE WORK WILL START*

23. PROPOSED CASING AND CEMENTING PROGRAM

SIZE OF HOLE	SIZE OF CASING	WEIGHT PER FOOT	SETTING DEPTH	QUANTITY OF CEMENT
12 1/4"	8 5/8"	24.0#	200'	183 cu.ft. to circulate
7 7/8"	4 1/2"	10.5#	6230'	1227 cu.ft. - 2 stages

Production Casing Cement:

1st stage - 819 cu. ft. to cover Mesa Verde formation.

2nd stage - 408 cu. ft. to cover Ojo Alamo formation.

Selectively perforate and sandwater fracture the Gallup formation.

The E/2 of Section 31 is dedicated to this well.

JAN 16 1974

IN ABOVE SPACE DESCRIBE PROPOSED PROGRAM: If proposal is to deepen or plug back, give data on present productive zone and proposed new productive zone. If proposal is to drill or deepen directionally, give pertinent data on subsurface locations and measured and true vertical depths. Give blowout preventer program, if any.

24.

SIGNED

A. J. Baker

TITLE

Drilling Clerk

DATE

January 15, 1974

(This space for Federal or State office use)

PERMIT NO.

APPROVAL DATE

APPROVED BY

TITLE

DATE

CONDITIONS OF APPROVAL, IF ANY:

*See Instructions On Reverse Side

NEW MEXICO OIL CONSERVATION COMMISSION
WELL LOCATION AND ACREAGE DEDICATION PLAT

Form C-102
Supersedes C-128
Effective 1-1-65

All distances must be from the outer boundaries of the Section.

Operator EL PASO NATURAL GAS COMPANY		Lease MUERANO UNIT (SF-078007)		Well No. 256
Unit Letter 0	Section 31	Township 27-N	Range 9-W	County SAN JUAN
Actual Footage Location of Well: 1180 feet from the SOUTH line and 1550 feet from the EAST line				
Ground Level Elev. 6515	Producing Formation GALLUP	Pool ANGEL PEAK GALLUP EXTENSION	Dedicated Acreage: 320.00 Acres	

- Outline the acreage dedicated to the subject well by colored pencil or hatchure marks on the plat below.
- If more than one lease is dedicated to the well, outline each and identify the ownership thereof (both as to working interest and royalty).
- If more than one lease of different ownership is dedicated to the well, have the interests of all owners consolidated by communitization, unitization, force-pooling, etc?

☒ Yes ☐ No If answer is "yes," type of consolidation Unitization

If answer is "no," list the owners and tract descriptions which have actually been consolidated. (Use reverse side of this form if necessary.)

No allowable will be assigned to the well until all interests have been consolidated (by communitization, unitization, forced-pooling, or otherwise) or until a non-standard unit, eliminating such interests, has been approved by the Commission.

CERTIFICATION

I hereby certify that the information contained herein is true and complete to the best of my knowledge and belief.

Original Signed by

D. G. Brisco

Name

Orville Clark

Position

El Paso Natural Gas Co.

Company

January 15, 1974

Date

I hereby certify that the well location shown on this plat was plotted from field notes of actual surveys made by me or under my supervision, and that the same is true and correct to the best of my knowledge and belief.

Date Surveyed

DECEMBER 11, 1973

Registered Professional Engineer and/or Land Surveyor

[Signature]

License No. **1760**

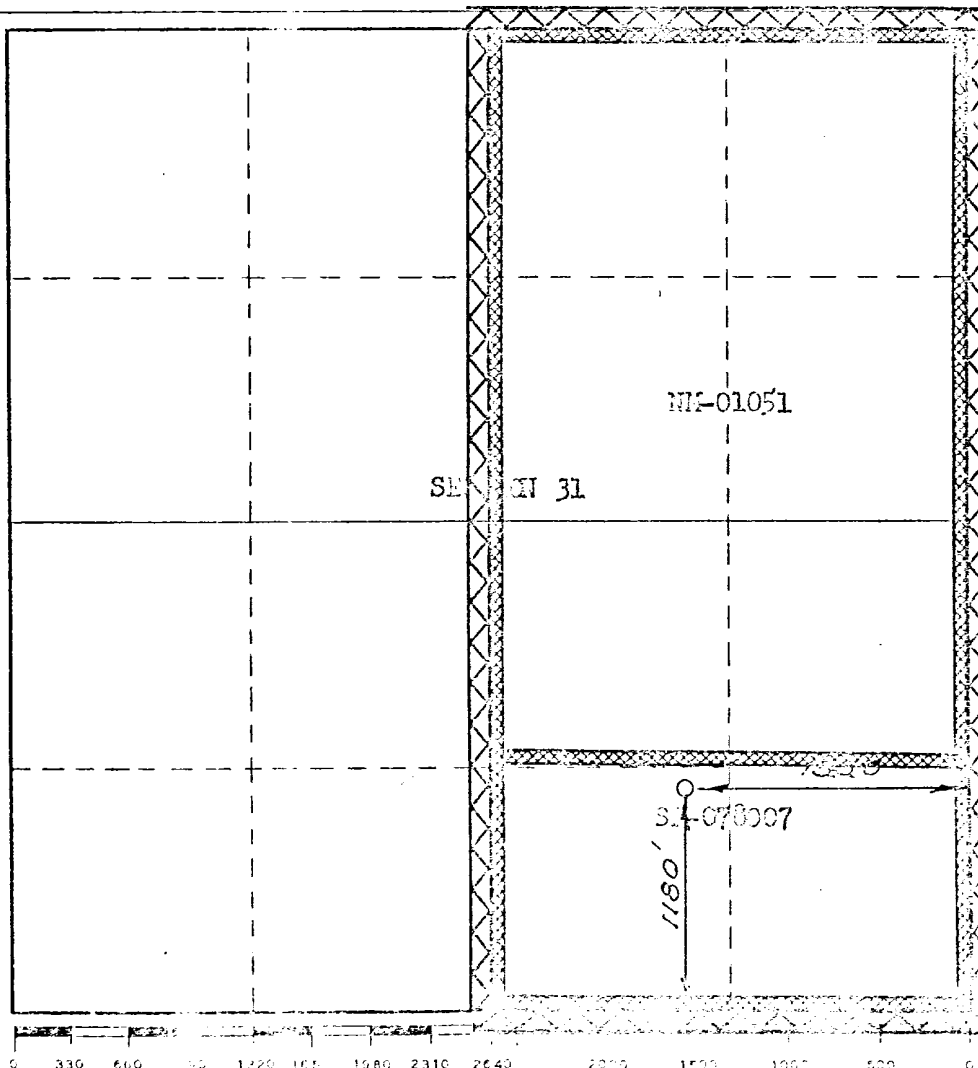

Huerfano Unit # 256
SE/4 Sec. 31, T. 27N, R. 20W
 Gallup

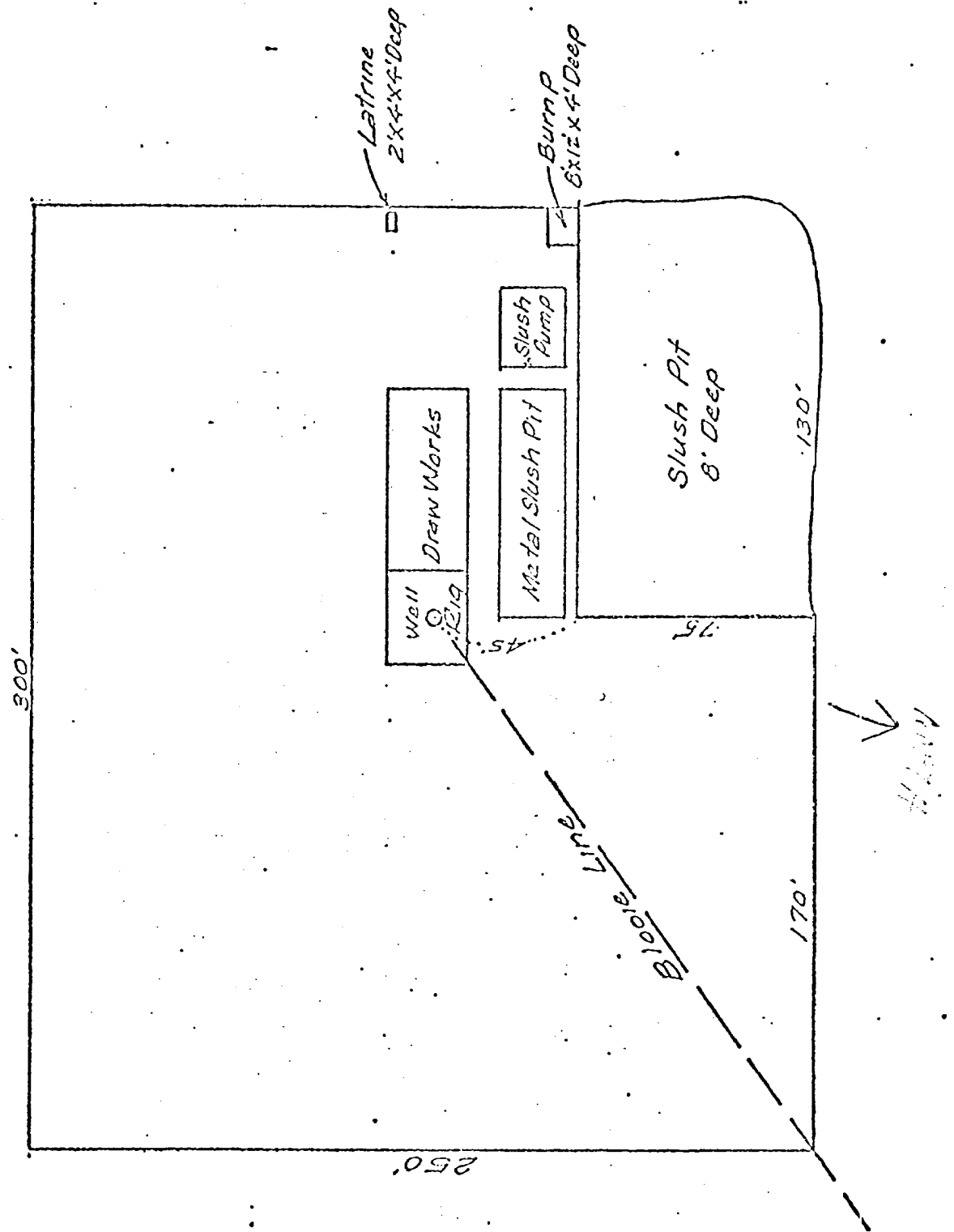

*Survey for West # 256
 S.W. 1/4 Sec 31, T-24 N, R-9 W*

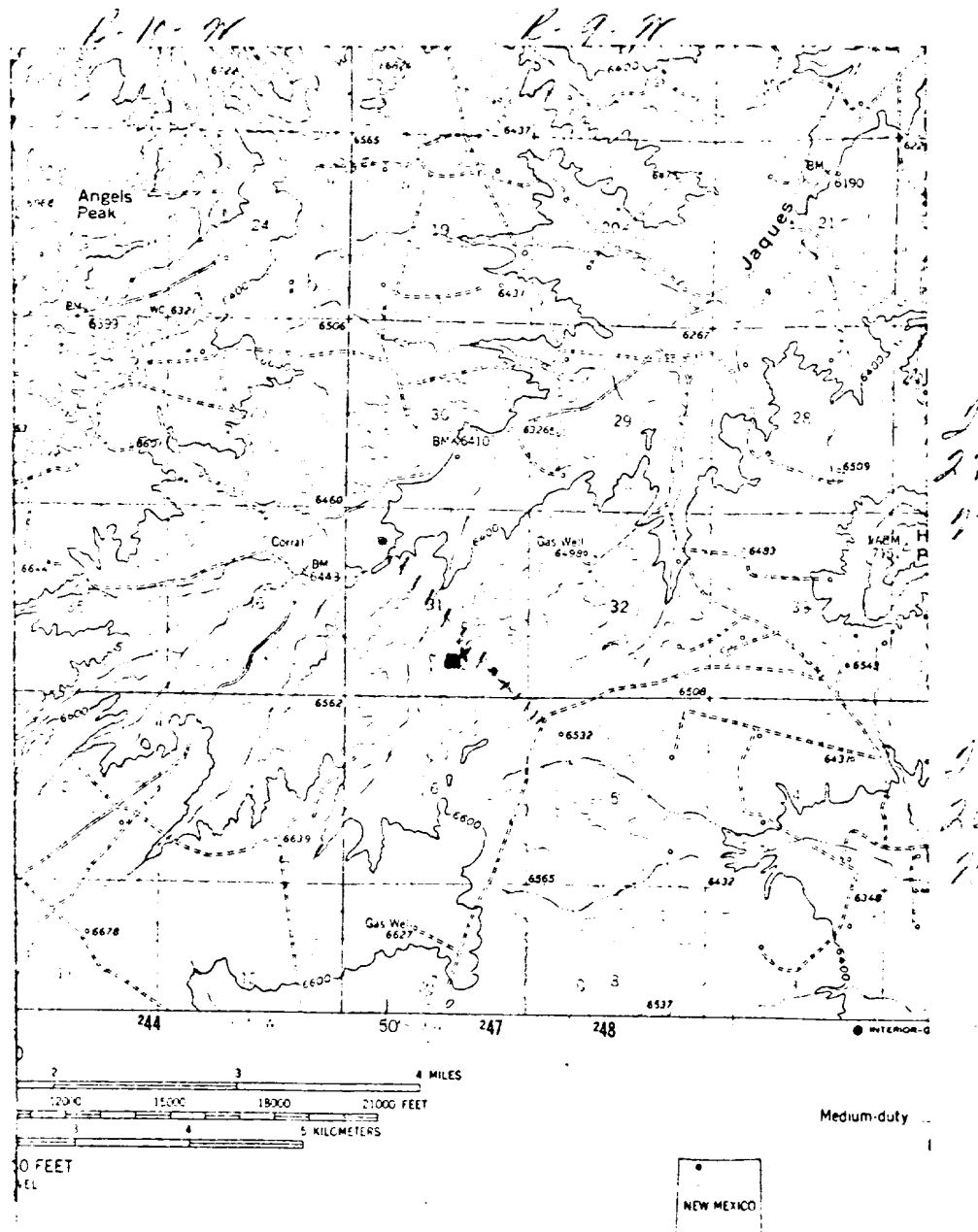

LEGEND OF RIGHT-OF-WAYS

EXISTING ROADS	—————
EXISTING PIPELINES	-+ -+ -+ -+
EXISTING ROAD & PIPELINE	-+ -+ -+ -+
PROPOSED ROADS	—————
PROPOSED PIPELINES	-+ -+ -+ -+
PROPOSED ROAD & PIPELINE	-+ -+ -+ -+