

UNITED STATES  
DEPARTMENT OF THE INTERIOR  
GEOLOGICAL SURVEY

## APPLICATION FOR PERMIT TO DRILL, DEEPEN, OR PLUG BACK

## 1a. TYPE OF WORK

DRILL ☒DEEPEN ☐PLUG BACK ☐

## b. TYPE OF WELL

OIL  
WELL ☒GAS  
WELL ☐

OTHER

SINGLE  
ZONE ☒MULTIPLE  
ZONE ☐

## 2. NAME OF OPERATOR

~~John F. Staver~~ dba Saguaro Oil Company

## 3. ADDRESS OF OPERATOR

P.O. Box 950 Virginia, Minnesota 55792

## 4. LOCATION OF WELL (Report location clearly and in accordance with any State requirements.\*)

At surface 990' FSL 2130' FWL

At proposed prod. zone

same

## 14. DISTANCE IN MILES AND DIRECTION FROM NEAREST TOWN OR POST OFFICE\*

Fifteen (15) miles south of Shiprock, New Mexico

## 15. DISTANCE FROM PROPOSED\*

LOCATION TO NEAREST  
PROPERTY OR LEASE LINE, FT.  
(Also to nearest drlg. unit line, if any)

2130'

## 16. NO. OF ACRES IN LEASE

3200

17. NO. OF ACRES ASSIGNED  
TO THIS WELL

40

18. DISTANCE FROM PROPOSED LOCATION\*  
TO NEAREST WELL, DRILLING, COMPLETED,  
OR APPLIED FOR, ON THIS LEASE, FT.

3250'

## 19. PROPOSED DEPTH

1400'

## 20. ROTARY OR CABLE TOOLS

Rotary

## 21. ELEVATIONS (Show whether DF, RT, GR, etc.)

5306 ground

## 22. APPROX. DATE WORK WILL START\*

February 28, 1974

## 23.

## PROPOSED CASING AND CEMENTING PROGRAM

| SIZE OF HOLE | SIZE OF CASING | WEIGHT PER FOOT | SETTING DEPTH | QUANTITY OF CEMENT |
|--------------|----------------|-----------------|---------------|--------------------|
| 8 3/4"       | 7"             | 20#             | 60'           | cement to surface  |
|              |                |                 |               |                    |
|              |                |                 |               |                    |

Propose to drill and test the dakota sandstone.  
If commercial production is obtained, production  
equipment will be installed and the well completed

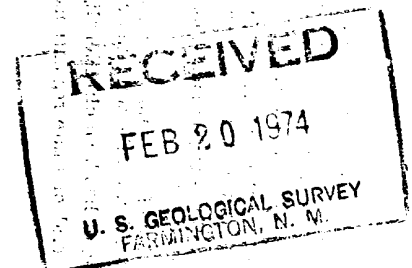

IN ABOVE SPACE DESCRIBE PROPOSED PROGRAM: If proposal is to deepen or plug back, give data on present productive zone and proposed new productive zone. If proposal is to drill or deepen directionally, give pertinent data on subsurface locations and measured and true vertical depths. Give blowout preventer program, if any.

## 24.

SIGNED

*Robert E. Lanth*

TITLE

Geological Consultant

DATE

Feb. 19, 1974

(This space for Federal or State office use)

PERMIT NO.

APPROVAL DATE

APPROVED BY

TITLE

DATE

CONDITIONS OF APPROVAL, IF ANY:



**NEW MEXICO OIL CONSERVATION COMMISSION  
WELL LOCATION AND ACREAGE DEDICATION PLAT**

Form C-102  
Supersedes C-128  
Effective 1-1-65

All distances must be from the outer boundaries of the Section.

|  |                                      |                                  |                                       |                                  |                      |
|--|--------------------------------------|----------------------------------|---------------------------------------|----------------------------------|----------------------|
| Operator<br><b>John F. Staver dba Saguaro Oil Co.</b>  |                                      |                                  | Lease<br><b>Table Mesa</b>            |                                  | Well No.<br><b>2</b> |
| Unit Letter<br><b>N</b>  | Section<br><b>9</b>                  | Township<br><b>27 North</b>      | Range<br><b>17 West</b>               | County<br><b>San Juan County</b> |                      |
| Actual Footage Location of Well:<br><div style="display: flex; justify-content: space-between;"> <span><b>990</b> feet from the <b>South</b> line and <b>2130</b> feet from the <b>West</b> line</span> </div> |                                      |                                  |                                       |                                  |                      |
| Ground Level Elev.<br><b>5306</b>  | Producing Formation<br><b>Dakota</b> | Pool<br><b>Table Mesa Dakota</b> | Dedicated Acreage:<br><b>40</b> Acres |                                  |                      |

1. Outline the acreage dedicated to the subject well by colored pencil or hachure marks on the plat below.
2. If more than one lease is dedicated to the well, outline each and identify the ownership thereof (both as to working interest and royalty).  

one lease 3200 acres
3. If more than one lease of different ownership is dedicated to the well, have the interests of all owners been consolidated by communitization, unitization, force-pooling, etc?

☐ Yes    ☐ No    If answer is "yes," type of consolidation \_\_\_\_\_

If answer is "no," list the owners and tract descriptions which have actually been consolidated. (Use reverse side of this form if necessary.) \_\_\_\_\_

No allowable will be assigned to the well until all interests have been consolidated (by communitization, unitization, forced-pooling, or otherwise) or until a non-standard unit, eliminating such interests, has been approved by the Commission.

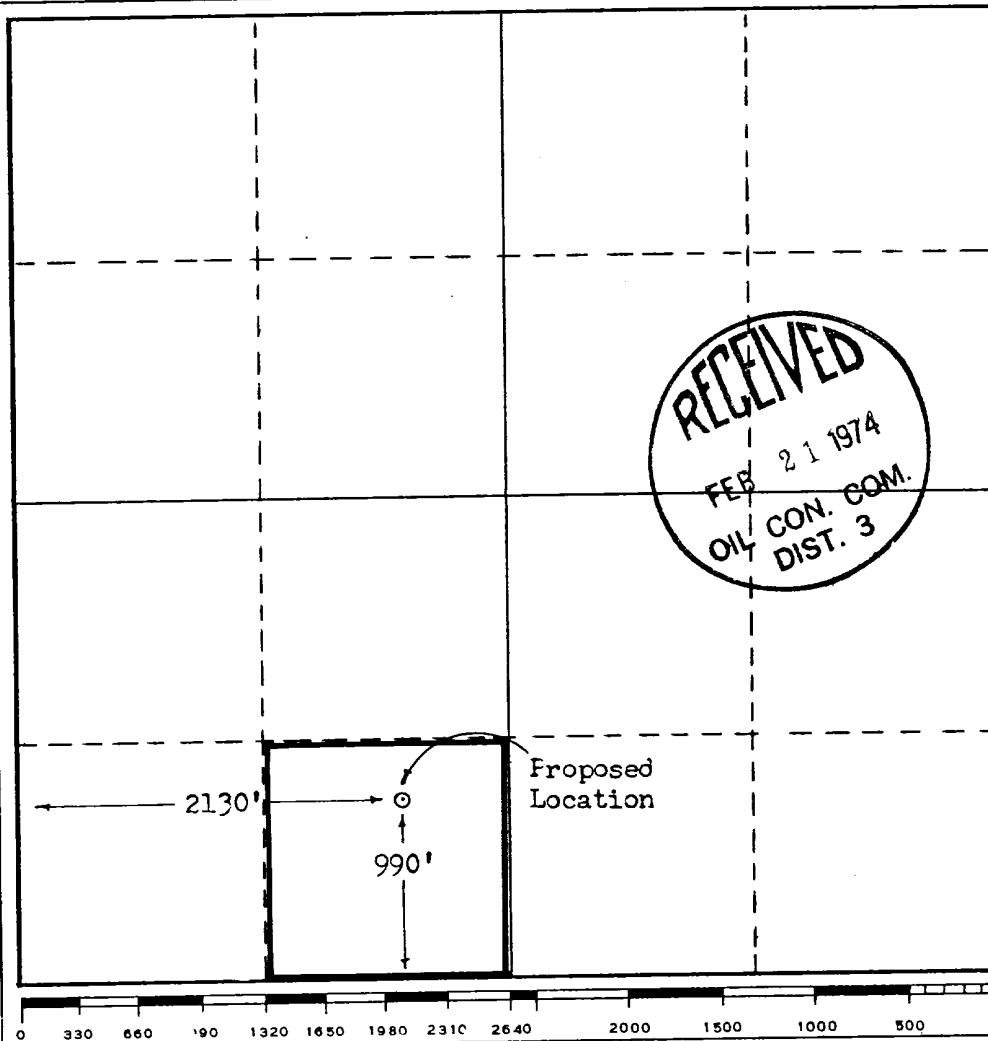

**CERTIFICATION**

I hereby certify that the information contained herein is true and complete to the best of my knowledge and belief.

*Robert E. Lauth*

Name  
**Robert E. Lauth**

Position  
**Geological Consultant**

Company  
**John F. Staver dba Saguaro**

Date  
**February 19, 1974**

I hereby certify that the well location shown on this plat was plotted from field notes of actual surveys made by me or under my supervision, and that the same is true and correct to the best of my knowledge and belief.

**February 12, 1974**

Date Surveyed  
**Frederick H. Reed**

Registered Professional Engineer  
and/or Land Surveyor

*Frederick H. Reed*

**3795**  
Certificate No.