

UNITED STATES  
DEPARTMENT OF THE INTERIOR  
GEOLOGICAL SURVEY30-045-21534  
5. LAND DESIGNATION AND SERIAL NO.  
678566-A

## APPLICATION FOR PERMIT TO DRILL, DEEPEN, OR PLUG BACK

## 1a. TYPE OF WORK

DRILL ☒DEEPEN ☐PLUG BACK ☐

## b. TYPE OF WELL

OIL  
WELL ☐GAS  
WELL ☒

OTHER

SINGLE  
ZONE ☐MULTIPLE  
ZONE ☒

## 2. NAME OF OPERATOR

El Paso Natural Gas Company

## 3. ADDRESS OF OPERATOR

PO Box 990, Farmington, NM 87401

## 4. LOCATION OF WELL (Report location clearly and in accordance with any State requirements.)\*

At surface

800'S, 1800'W

At proposed prod. zone

## 14. DISTANCE IN MILES AND DIRECTION FROM NEAREST TOWN OR POST OFFICE\*

## 15. DISTANCE FROM PROPOSED\*

LOCATION TO NEAREST  
PROPERTY OR LEASE LINE, FT.  
(Also to nearest drilg. unit line, if any)

## 16. NO. OF ACRES IN LEASE

17. NO. OF ACRES ASSIGNED  
TO THIS WELL

149.60

18. DISTANCE FROM PROPOSED LOCATION\*  
TO NEAREST WELL, DRILLING, COMPLETED,  
OR APPLIED FOR, ON THIS LEASE, FT.

## 19. PROPOSED DEPTH

3190'

## 20. ROTARY OR CABLE TOOLS

Rotary

## 21. ELEVATIONS (Show whether DF, RT, GR, etc.)

5824'GL

## 22. APPROX. DATE WORK WILL START\*

## 23. PROPOSED CASING AND CEMENTING PROGRAM

SIZE OF HOLE	SIZE OF CASING	WEIGHT PER FOOT	SETTING DEPTH	QUANTITY OF CEMENT
13 3/4"	9 5/8"	32.3#	120'	135 cu. ft. to circulate
8 3/4"	2 7/8"	6.4#	2330'	555 cu. ft. to cover Ojo Alamo
6 3/4"	2 7/8"	6.4#	3190'	293 cu. ft. to cover Lewis

Selective zones in the Pictured Cliffs and Chacra formations will be perforated and sandwater fractured. The well will be completed as a Pictured Cliffs - Chacra dual well with two parallel strings of 2 7/8" production casing.

The SW/4 of Section 34 is dedicated to this well.

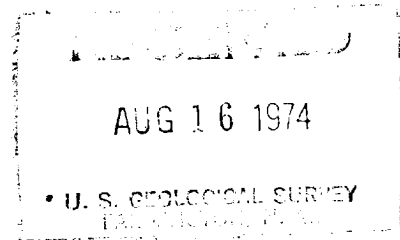

IN ABOVE SPACE DESCRIBE PROPOSED PROGRAM: If proposal is to deepen or plug back, give data on present productive zone and proposed new productive zone. If proposal is to drill or deepen directionally, give pertinent data on subsurface locations and measured and true vertical depths. Give blowout preventer program, if any.

## 24.

SIGNED

*A. J. Bricco*

TITLE

Drilling Clerk

DATE August 15, 1974

(This space for Federal or State office use)

PERMIT NO.

APPROVAL DATE

APPROVED BY

*EA*

TITLE

DATE

CONDITIONS OF APPROVAL, IF ANY:

*any well order*

\*See Instructions On Reverse Side

NEW MEXICO OIL CONSERVATION COMMISSION  
WELL LOCATION AND ACREAGE DEDICATION PLAT

Form C-102  
Supersedes C-128  
Effective 1-1-65

All distances must be from the outer boundaries of the Section.

Operator <b>EL PASO NATURAL GAS COMPANY</b>		Lease <b>HOWELL</b>		(SF-078566-A)		Well No. <b>14</b>	
Unit Letter <b>N</b>	Section <b>34</b>	Township <b>28-N</b>	Range <b>8-W</b>	County <b>SAN JUAN</b>			
Actual Footage Location of Well: <b>800</b> feet from the <b>SOUTH</b> line and <b>1800</b> feet from the <b>WEST</b> line							
Ground Level Elev. <b>5824</b>	Producing Formation <b>PICTURED CLIFFS-CHACRA</b>		Pool <b>UNDESIGNATED CHACRA</b>		Dedicated Acreage: <b>149.60</b> Acres		
<b>SO. BLANCO PICTURED CLIFFS</b>							

1. Outline the acreage dedicated to the subject well by colored pencil or hachure marks on the plat below.
2. If more than one lease is dedicated to the well, outline each and identify the ownership thereof (both as to working interest and royalty).
3. If more than one lease of different ownership is dedicated to the well, have the interests of all owners been consolidated by communization, unitization, force-pooling, etc?

☐ Yes ☐ No If answer is "yes," type of consolidation \_\_\_\_\_

If answer is "no," list the owners and tract descriptions which have actually been consolidated. (Use reverse side of this form if necessary.) \_\_\_\_\_

No allowable will be assigned to the well until all interests have been consolidated (by communization, unitization, forced-pooling, or otherwise) or until a non-standard unit, eliminating such interests, has been approved by the Commission.

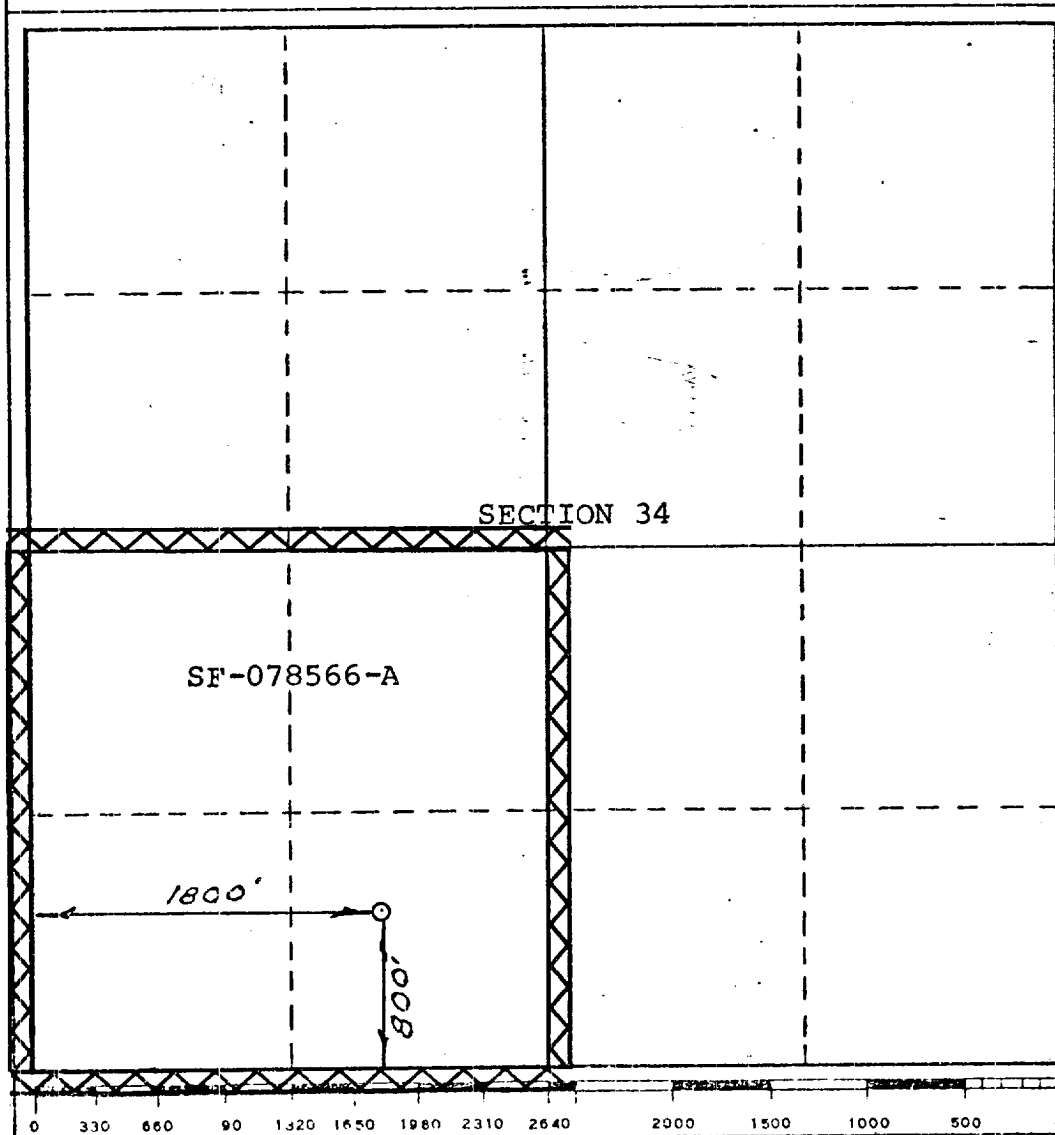

CERTIFICATION

I hereby certify that the information contained herein is true and complete to the best of my knowledge and belief.  
Original Signed by  
**D. G. Brisco**

Name

**Drilling Clerk**

Position

**El Paso Natural Gas Co.**

Company

**August 15, 1974**

Date

I hereby certify that the well location shown on this plat was plotted from field notes of actual surveys made by me or under my supervision, and that the same is true and correct to the best of my knowledge and belief.

Date Surveyed

**JUNE 20, 1974**

Registered Professional Engineer and/or Land Surveyor

Certificate No. **1760**