

UNITED STATES
DEPARTMENT OF THE INTERIOR
GEOLOGICAL SURVEY

SUBMIT IN TRIPLICATE*

Other instructions on
reverse side)Form approved.
Budget Bureau No. 42-R1425.

30-045-21609

APPLICATION FOR PERMIT TO DRILL, DEEPEN, OR PLUG BACK

1a. TYPE OF WORK

DRILL ☒DEEPEN ☐PLUG BACK ☐

b. TYPE OF WELL

OIL
WELL ☒GAS
WELL ☐OTHER ☐SINGLE
ZONE ☒MULTIPLE
ZONE ☐

2. NAME OF OPERATOR

Consolidated Oil & Gas, Inc.

3. ADDRESS OF OPERATOR

1860 Lincoln Street, Denver, Colorado 80203

4. LOCATION OF WELL (Report location clearly and in accordance with any State requirements.)*

At surface

660' FSL; 1980' FEL of Section 34

At proposed prod. zone

Same

14. DISTANCE IN MILES AND DIRECTION FROM NEAREST TOWN OR POST OFFICE*

17-1/2 miles south of Shiprock, New Mexico

15. DISTANCE FROM PROPOSED*

LOCATION TO NEAREST
PROPERTY OR LEASE LINE, FT.
(Also to nearest drlg. unit line, if any)

660'

16. NO. OF ACRES IN LEASE

2560

17. NO. OF ACRES ASSIGNED
TO THIS WELL

160

18. DISTANCE FROM PROPOSED LOCATION*

TO NEAREST WELL, DRILLING, COMPLETED,
OR APPLIED FOR, ON THIS LEASE, FT.

2640

19. PROPOSED DEPTH

6800

20. ROTARY OR CABLE TOOLS

Rotary

21. ELEVATIONS (Show whether DF, RT, GR, etc.)

5603 Gr.

22. APPROX. DATE WORK WILL START*

January 15, 1975

23.

PROPOSED CASING AND CEMENTING PROGRAM

SIZE OF HOLE	SIZE OF CASING	WEIGHT PER FOOT	SETTING DEPTH	QUANTITY OF CEMENT
15-1/2"	13-3/8"	48.00#	100'	100 sx. thru Gallup ss
10-1/2"	8-5/8"	24.0#	1500'	500 sx. thru Lower Morrison (McElmo)
7-7/8"	4-1/2"	9.5# - 11.6#	6800'	650 sx.

Propose to drill and test the main Tocito Dome Pennsylvanian pay zone (Barker Creek). If commercial production is obtained, production equipment will be installed and the well completed in a proper oil field manner.

NOV-29 1974

U. S. GEOLOGICAL SURVEY

IN ABOVE SPACE DESCRIBE PROPOSED PROGRAM: If proposal is to deepen or plug back, give data on present productive zone and proposed new productive zone. If proposal is to drill or deepen directionally, give pertinent data on subsurface locations and measured and true vertical depths. Give blowout preventer program, if any.

24.

SIGNED

Robert E. Lauth
R. E. Lauth

TITLE Geological Consultant

DATE Nov. 25, 1974

(This space for Federal or State office use)

PERMIT NO.

APPROVAL DATE

APPROVED BY

TITLE

DATE

CONDITIONS OF APPROVAL, IF ANY:

*See Instructions On Reverse Side

**NEW MEXICO OIL CONSERVATION COMMISSION
WELL LOCATION AND ACREAGE DEDICATION PLAT**

Form C-102
Supersedes C-128
Effective 1-1-65

All distances must be from the outer boundaries of the Section.

Operator Consolidated Oil & Gas, Inc.		Lease Staver - Navajo		Well No. 1
Unit Letter 0	Section 34	Township 27 North	Range 18 West	County San Juan
Actual Footage Location of Well: 660 feet from the South line and 1980 feet from the East line				
Ground Level Elev: 5603	Producing Formation Penn.-Paradox	Pool Wildcat-North Tocito Dome	Dedicated Acreage: 160 acres Acres	

1. Outline the acreage dedicated to the subject well by colored pencil or hachure marks on the plat below.
2. If more than one lease is dedicated to the well, outline each and identify the ownership thereof (both as to working interest and royalty).

one lease 2560 acres
3. If more than one lease of different ownership is dedicated to the well, have the interests of all owners been consolidated by communitization, unitization, force-pooling, etc?

☐ Yes ☐ No If answer is "yes," type of consolidation _____

If answer is "no," list the owners and tract descriptions which have actually been consolidated. (Use reverse side of this form if necessary.) _____

No allowable will be assigned to the well until all interests have been consolidated (by communitization, unitization, forced-pooling, or otherwise) or until a non-standard unit, eliminating such interests, has been approved by the Commission.

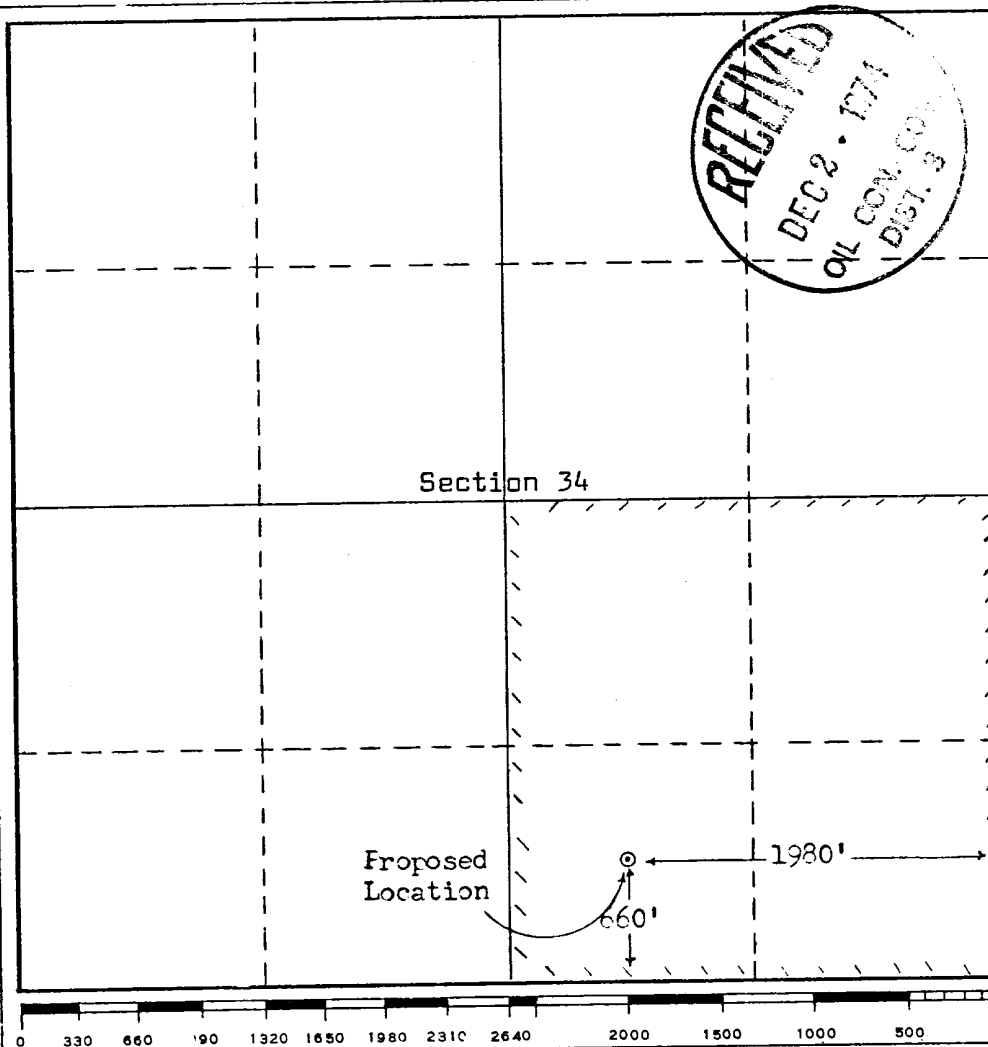

CERTIFICATION

I hereby certify that the information contained herein is true and complete to the best of my knowledge and belief.

Robert E. Lauth

Name
Robert E. Lauth

Position
Geological Consultant

Company
Consolidated Oil & Gas Inc.

Date
October 30, 1974

I hereby certify that the well location shown on this plat was plotted from field notes of actual surveys made by me or under my supervision, and that the same is true and correct to the best of my knowledge and belief.

October 25, 1974

Date Surveyed
Frederick F. Reed

Registered Professional Engineer
and/or Land Surveyor

Frederick H. Reed

Certificate No.

3795

DURANGO, COLORADO

GEOLOGIST

ROBERT E. LAUTH

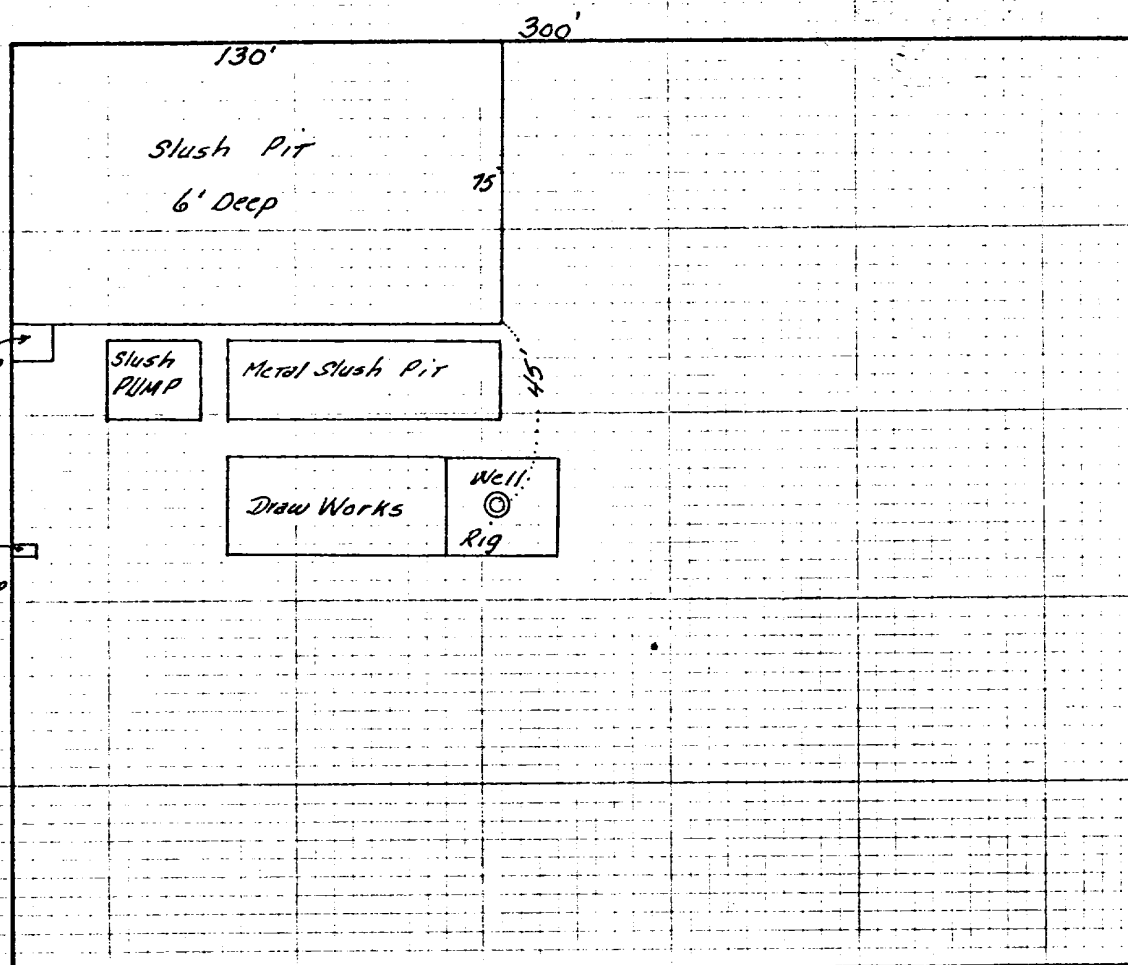

Rig Layout Plat for:

Consolidated O&G, Inc.
No. 1 STAUER - Navajo
SWSE Sec 34 T27N R18W
SAN JUAN County, New Mexico

Calculation Sheet

DATE _____ TITLE _____ AREA _____

MADE BY _____ COUNTY _____

PAGE _____ OF _____ SCALE _____ STATE _____

DESIGNATION OF OPERATOR

The undersigned is, on the records of the Bureau of Land Management, holder of lease

DISTRICT LAND OFFICE: Santa Fe, New Mexico
SERIAL No.: The Navajo Tribe Lease No. N00-C-14-20-5420
Sale No. 107, Tract No. 158

and hereby designates

NAME: Consolidated Oil and Gas Inc.
ADDRESS: Suite 1300 Lincoln Tower Bldg.
1860 Lincoln Street Denver, Colorado 80203

as his operator and local agent, with full authority to act in his behalf in complying with the terms of the lease and regulations applicable thereto and on whom the supervisor or his representative may serve written or oral instructions in securing compliance with the Operating Regulations with respect to (describe acreage to which this designation is applicable):

Southeast Quarter of Section 34 Township 27North Range 18 West NMPM

San Juan County, New Mexico

It is understood that this designation of operator does not relieve the lessee of responsibility for compliance with the terms of the lease and the Operating Regulations. It is also understood that this designation of operator does not constitute an assignment of any interest in the lease.

In case of default on the part of the designated operator, the lessee will make full and prompt compliance with all regulations, lease terms, or orders of the Secretary of the Interior or his representative.

The lessee agrees promptly to notify the supervisor of any change in the designated operator.

November 1, 1974

(Date)

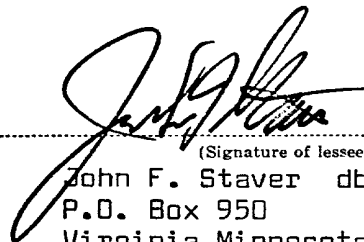

(Signature of lessee)

John F. Staver dba Saguaro Oil Company
P.O. Box 950
Virginia Minnesota 55792

(Address)

R18W

T
27
N

T
27
N

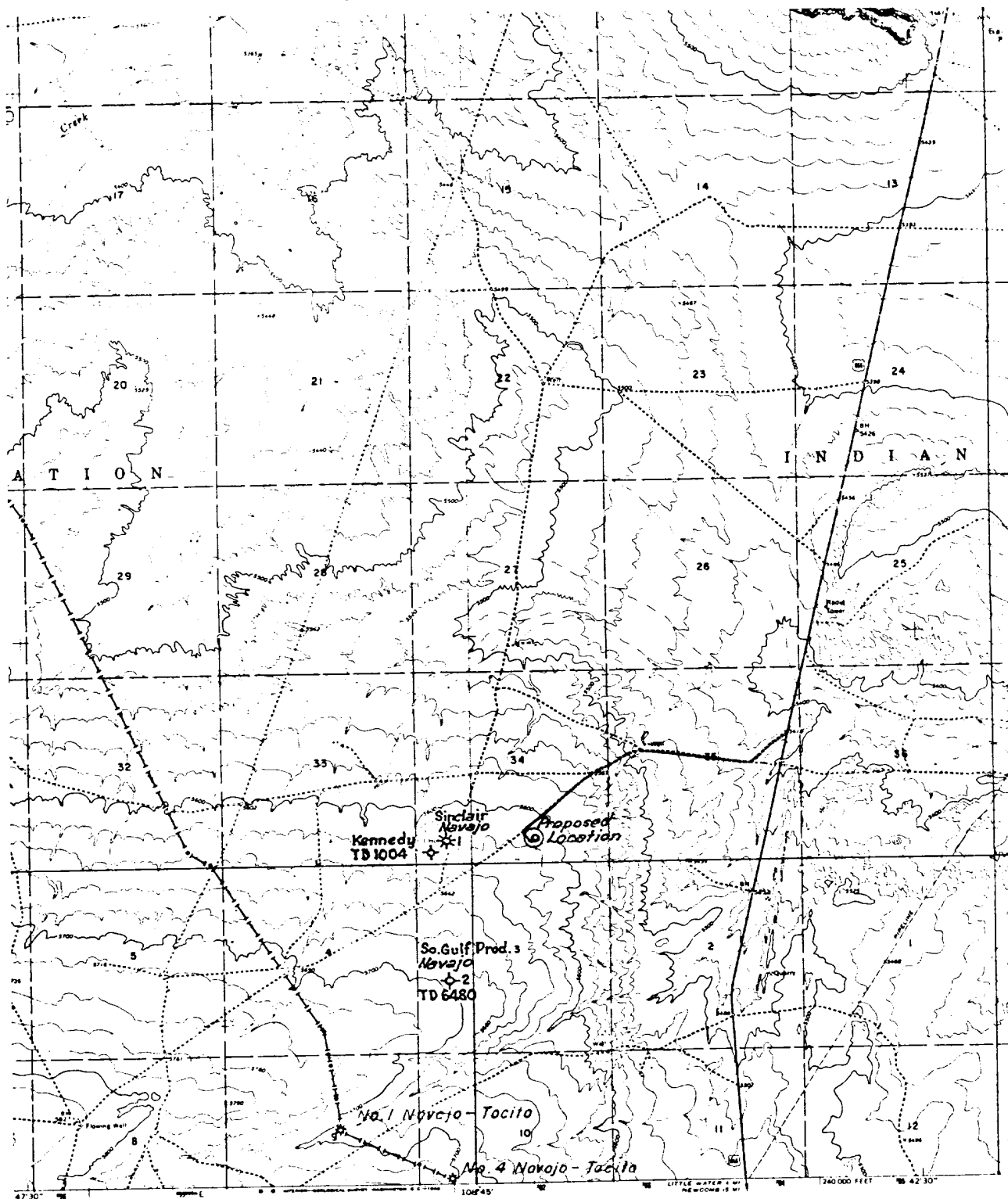

T
26
N

T
26
N

CONSOLIDATED OIL & GAS INC.
STAVEN-NAVAJO LEASE
Plat showing well location, existing
roads, pipelines, etc. Scale: 1"=4000'

