

UNITED STATES
DEPARTMENT OF THE INTERIOR
GEOLOGICAL SURVEY30-045-21734
5. LEASE DESIGNATION AND SERIAL NO.

NM-03605

6. IF INDIAN, ALLOTTEE OR TRIBE NAME

7. UNIT AGREEMENT NAME

8. FARM OR LEASE NAME

Marron

9. WELL NO.

46-A

10. FIELD AND POOL, OR WILDCAT

Blanco Mesa Verde

11. SEC., T., R., M., OR BLK.
AND SURVEY OR AREA

Sec 23, T27N, R8W

12. COUNTY OR PARISH

San Juan

13. STATE

N.M.

APPLICATION FOR PERMIT TO DRILL, DEEPEN, OR PLUG BACK

1a. TYPE OF WORK

DRILL ☒DEEPEN ☐PLUG BACK ☐

b. TYPE OF WELL

OIL
WELL ☐GAS
WELL ☒

OTHER

SINGLE
ZONE ☒MULTIPLE
ZONE ☐

2. NAME OF OPERATOR

WILLIAM C. RUSSELL

3. ADDRESS OF OPERATOR

1775 Broadway New York, New York

4. LOCATION OF WELL (Report location clearly and in accordance with any State requirements.)

At surface

1850 FNL - 1190 FWL

At proposed prod. zone

-same-

14. DISTANCE IN MILES AND DIRECTION FROM NEAREST TOWN OR POST OFFICE*

15

15. DISTANCE FROM PROPOSED*

LOCATION TO NEAREST
PROPERTY OR LEASE LINE, FT.
(Also to nearest drlg. unit line, if any)

1190

16. NO. OF ACRES IN LEASE

320

17. NO. OF ACRES ASSIGNED

TO THIS WELL
320 (infill)18. DISTANCE FROM PROPOSED LOCATION*
TO NEAREST WELL, DRILLING, COMPLETED,
OR APPLIED FOR, ON THIS LEASE, FT.

300

19. PROPOSED DEPTH

4650

20. ROTARY OR CABLE TOOLS

Rotary

21. ELEVATIONS (Show whether DF, RT, GR, etc.)

5937 GR

22. APPROX. DATE WORK WILL START*

April 15, 1975

23. PROPOSED CASING AND CEMENTING PROGRAM

SIZE OF HOLE	SIZE OF CASING	WEIGHT PER FOOT	SETTING DEPTH	QUANTITY OF CEMENT
12 3/4	8 5/8	24#	210	200 sacks (circulate)
7 7/8	4 1/2	10.50#	4650	600 sacks (circulate)
	1 1/2	tubing	inside TD	

Attachments: Well location and acreage dedication plat
Exhibits "A" thru "F"

BOP in use at all times.

RECEIVED

MAR 4 1975

U. S. GEOLOGICAL SURVEY
FARMINGTON, N. M.

IN ABOVE SPACE DESCRIBE PROPOSED PROGRAM: If proposal is to deepen or plug back, give data on present productive zone and proposed new productive zone. If proposal is to drill or deepen directionally, give pertinent data on subsurface locations and measured and true vertical depths. Give blowout preventer program, if any.

24.

SIGNED

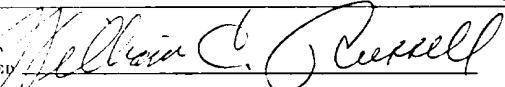

TITLE

Operator

DATE 2-28-75

(This space for Federal or State office use)

PERMIT NO.

APPROVAL DATE

APPROVED BY



TITLE

DATE

CONDITIONS OF APPROVAL, IF ANY:

*See Instructions On Reverse Side

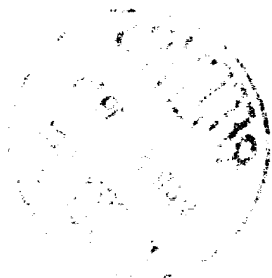
[illegible]

NEW MEXICO OIL CONSERVATION COMMISSION
WELL LOCATION AND ACREAGE DEDICATION PLAT

All distances must be from the corner boundary of the section.

NAME <u>W. C. RUSSELL</u>	SECTION <u>23</u>	TOWNSHIP <u>27 NORTH</u>	RANGE <u>8 WEST</u>	COUNTY <u>SAN JUAN</u>
ACREAGE <u>1190</u>		DIRECTION <u>WEST</u>		
<u>Mesa Verde</u>		<u>Blanco</u>		<u>320</u>

Outline the acreage dedicated to the subject well by colored pencil or hatchure marks on the plat below.

If the land on the lease is dedicated to the well, outline each and identify the ownership thereof (both as to acreage and mineral and royalty).

If more than one lease of different ownership is dedicated to the well, have the interests of all owners been consolidated by communitization, unitization, force-pooling, etc?

Yes ☐ No ☒ If answer is "yes," type of consolidation _____

If answer is "no," list the owners and tract descriptions which have actually been consolidated. (Use reverse side of this form if necessary.) _____

No acreage will be assigned to the well until all interests have been consolidated (by communitization, unitization, force-pooling, or otherwise) or until a non-standard unit, eliminating such interests, has been approved by the Commission.

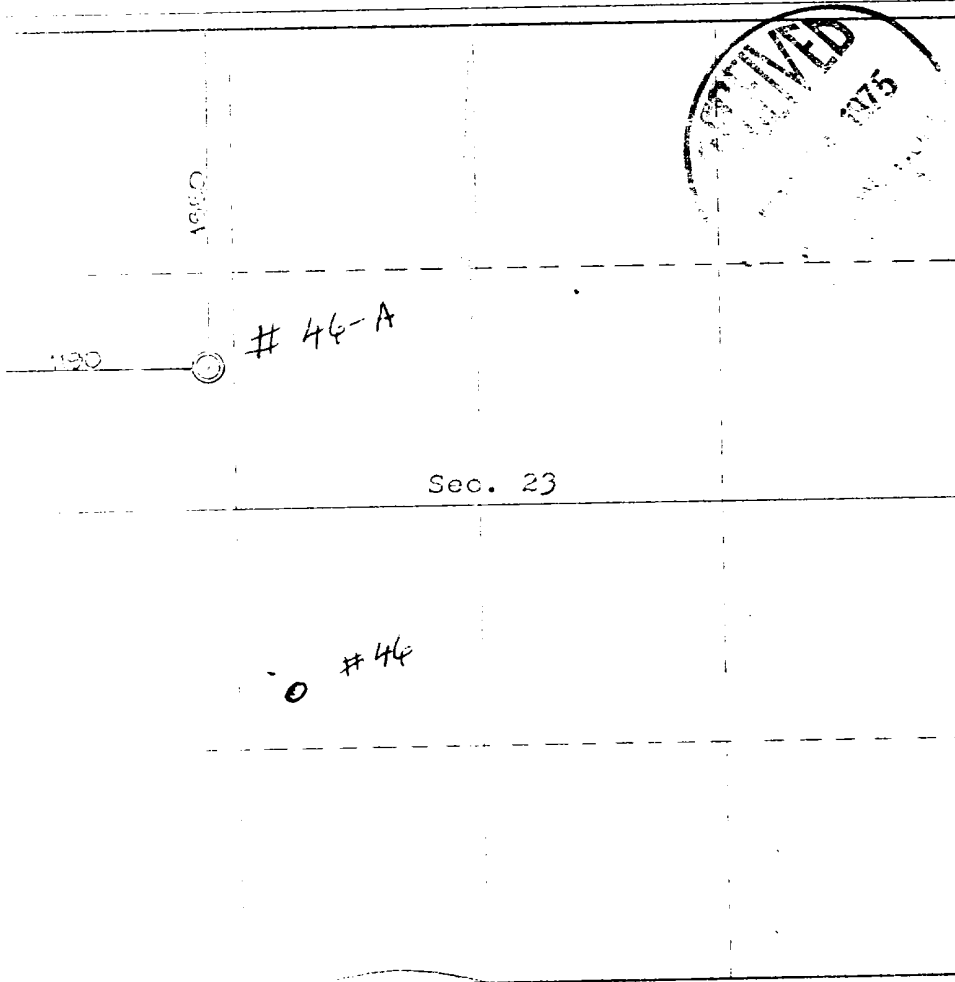

CERTIFICATION

I hereby certify that the information contained herein is true and correct to the best of my knowledge and belief.

William C. Russell

Name

Operator

Position

-self-

April 1, 1975

William C. Russell

I hereby certify that the information shown on this plat was taken from notes of actual survey made under my supervision and that the same is true and correct to the best of my knowledge and belief.

21 January, 1975

JAMES P. L...

James P. L...

1975