

UNITED STATES
DEPARTMENT OF THE INTERIOR
GEOLOGICAL SURVEY30-045-22673
3. LEASE DESIGNATION AND SERIAL NO.

Fed. 1-149 IND-8466

6. IF INDIAN, ALLOTTEE OR TRIBE NAME

NAVAJO

7. UNIT AGREEMENT NAME

NONE

8. FARM OR LEASE NAME

JOHN CHARLES

9. WELL NO.

7A

10. FIELD AND POOL, OR WILDCAT

Blanco Mesaverde

11. SEC. T., R., M., OR BLK.
AND SURVEY OR AREA

Sec. 13, T27N, R9W

12. COUNTY OR PARISH 13. STATE

San Juan

New Mexico

APPLICATION FOR PERMIT TO DRILL, DEEPEN, OR PLUG BACK

1a. TYPE OF WORK

DRILL ☒DEEPEN ☐PLUG BACK ☐

b. TYPE OF WELL

OIL
WELL ☐CAS
WELL ☒

OTHER

SINGLE
ZONE ☒MULTIPLE
ZONE ☐

2. NAME OF OPERATOR

GETTY OIL COMPANY

3. ADDRESS OF OPERATOR

P. O. Box 3360, Casper, WY 82602

4. LOCATION OF WELL (Report location clearly and in accordance with any State requirements.)

At surface

890 FNL 1550 FWL

At proposed prod. zone

Same

14. DISTANCE IN MILES AND DIRECTION FROM NEAREST TOWN OR POST OFFICE*

13 Miles southsoutheast of Blanco, New Mexico

15. DISTANCE FROM PROPOSED*

LOCATION TO NEAREST

PROPERTY OR LEASE LINE, FT.

(Also to nearest drlg. unit line, if any)

890

16. NO. OF ACRES IN LEASE

640

18. DISTANCE FROM PROPOSED LOCATION*

TO NEAREST WELL, DRILLING, COMPLETED,
OR APPLIED FOR, ON THIS LEASE, FT.

1400

19. PROPOSED DEPTH

4500

17. NO. OF ACRES ASSIGNED
TO THIS WELL

320

20. ROTARY OR CABLE TOOLS

Rotary

21. ELEVATIONS (Show whether DF, RT, GR, etc.)

GL 5963 KB 5975

22. APPROX. DATE WORK WILL START*

September 10, 1977

23.

PROPOSED CASING AND CEMENTING PROGRAM

SIZE OF HOLE	SIZE OF CASING	WEIGHT PER FOOT	SETTING DEPTH	QUANTITY OF CEMENT
12 1/4"	9 5/8" O.D.	32.3# H-40	300	256 sx - cement to surface
8 3/4"	7" O.D.	17.0# H-40	2400	341 sx - cement to surface
6 1/4"	4" O.D.	11.3# J-55	4500	274 sx - cement all of liner

Bottom liner All csg. to be new.

We propose to drill to 2400' with mud then cement 7" O.D. casing to surface. Lease gas will be used to drill from 2400' to 4500' T.D. Mesaverde is expected at 3570' and Point Lookout at 4230', K. B. depths.

Blowout preventer program details are a part of the attached Ten Point Well Control Plan.

Gas production is committed to El Paso Natural Gas Company.

IN ABOVE SPACE DESCRIBE PROPOSED PROGRAM: If proposal is to deepen or plug back, give data on present productive zone and proposed new productive zone. If proposal is to drill or deepen directionally, give pertinent data on subsurface locations and measured and true vertical depths. Give blowout preventer program, if any.

24.

SIGNED

Charles Mowry

TITLE

Area Engineer

DATE

July 22, 1977

(This space for Federal or State office use)

PERMIT NO.

APPROVAL DATE

APPROVED BY

TITLE

DATE

CONDITIONS OF APPROVAL, IF ANY

AKA

*See Instructions On Reverse Side

NEW MEXICO OIL CONSERVATION COMMISSION
WELL LOCATION AND ACREAGE DEDICATION PLAT

Form C-102
Supersedes C-128
Effective 1-1-65

All distances must be from the outer boundaries of the Section.

Operator Getty Oil Company			Lease John Charles		Well No. 7A
Unit Letter C	Section 13	Township 27N	Range 9W	County San Juan	
Actual Footage Location of Well: 890 feet from the North line and 1550 feet from the West line					
Ground Level Elev. 5963	Producing Formation Mesa Verde		Pool Blanco	Dedicated Acreage: 3.20 Acres	

1. Outline the acreage dedicated to the subject well by colored pencil or hatchure marks on the plat below.
2. If more than one lease is dedicated to the well, outline each and identify the ownership thereof (both as to working interest and royalty).
3. If more than one lease of different ownership is dedicated to the well, have the interests of all owners been consolidated by communitization, unitization, force-pooling, etc?

☐ Yes ☐ No If answer is "yes," type of consolidation _____

If answer is "no," list the owners and tract descriptions which have actually been consolidated. (Use reverse side of this form if necessary.) _____

No allowable will be assigned to the well until all interests have been consolidated (by communitization, unitization, forced-pooling, or otherwise) or until a non-standard unit, eliminating such interests, has been approved by the Commission.

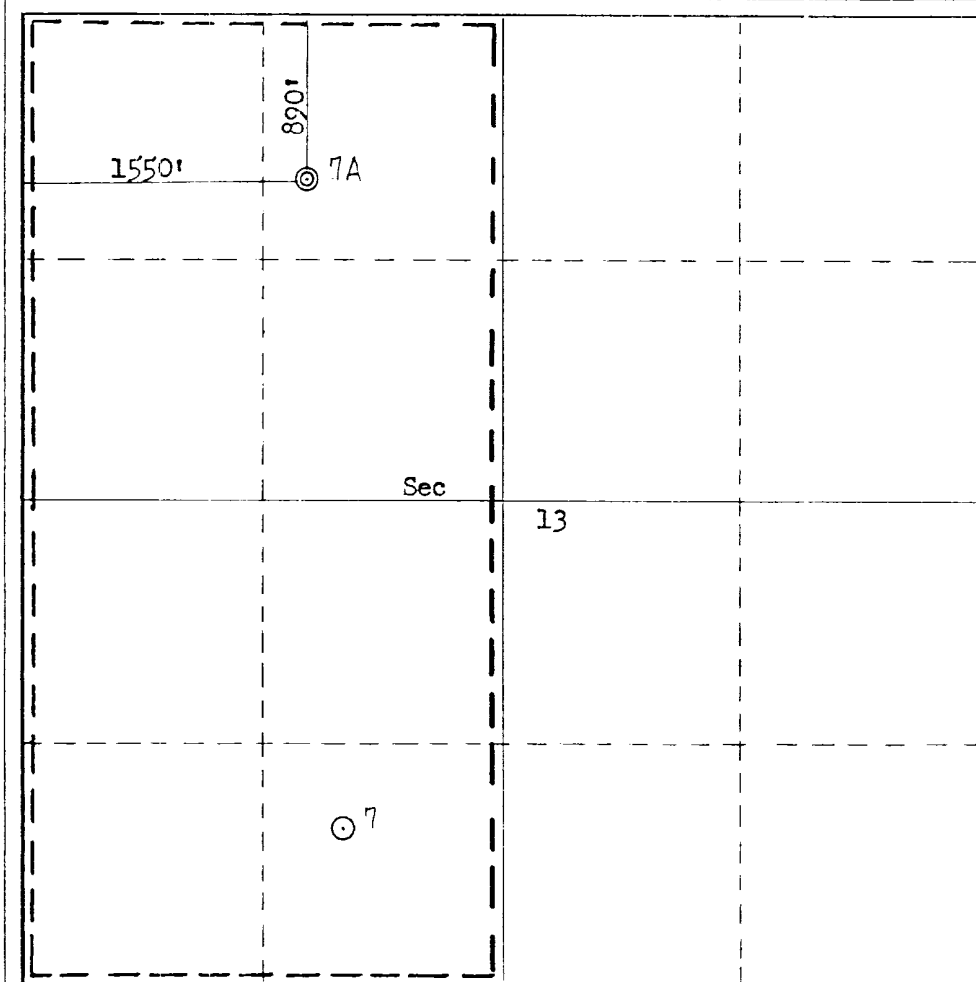

CERTIFICATION

I hereby certify that the information contained herein is true and complete to the best of my knowledge and belief.

Charles Mowry
Name

Area Engineer

Position

Getty Oil Company

Company

July 22, 1977

Date

I hereby certify that the well location shown on this plat was plotted from field notes of actual surveys made by me or under my supervision, and that the same is true and correct to the best of my knowledge and belief.

Date Surveyed

June 23, 1977

Registered Professional Engineer
and a Land Surveyor

Fred B. Kerr Jr.
Fred B. Kerr Jr.

Certificate No.

3950