

UNITED STATES  
DEPARTMENT OF THE INTERIOR  
GEOLOGICAL SURVEY

## APPLICATION FOR PERMIT TO DRILL, DEEPEN, OR PLUG BACK

## 1a. TYPE OF WORK

DRILL ☒DEEPEN ☐PLUG BACK ☐

## b. TYPE OF WELL

OIL  
WELL ☐GAS  
WELL ☒

OTHER

SINGLE  
ZONE ☐MULTIPLE  
ZONE ☐

## 2. NAME OF OPERATOR

Dugan Production Corp.

## 3. ADDRESS OF OPERATOR

Box 234, Farmington, NM 87401

## 4. LOCATION OF WELL (Report location clearly and in accordance with any State requirements.\*)

At surface

990' FSL - 1850' FWL

At proposed prod. zone

## 14. DISTANCE IN MILES AND DIRECTION FROM NEAREST TOWN OR POST OFFICE\*

16 miles south of Farmington, NM

## 15. DISTANCE FROM PROPOSED\*

LOCATION TO NEAREST  
PROPERTY OR LEASE LINE, FT.  
(Also to nearest drlg. unit line, if any)

990'

## 16. NO. OF ACRES IN LEASE

1424.64

17. NO. OF ACRES ASSIGNED  
TO THIS WELL

160 187.64

18. DISTANCE FROM PROPOSED LOCATION\*  
TO NEAREST WELL, DRILLING, COMPLETED,  
OR APPLIED FOR, ON THIS LEASE, FT.Approx  
1/2 mile

## 19. PROPOSED DEPTH

1400'

## 20. ROTARY OR CABLE TOOLS

Rotary

## 21. ELEVATIONS (Show whether DF, RT, GR, etc.)

6137' GR

## 22. APPROX. DATE WORK WILL START\*

10-20-77

## 23.

## PROPOSED CASING AND CEMENTING PROGRAM

SIZE OF HOLE	SIZE OF CASING	WEIGHT PER FOOT	SETTING DEPTH	QUANTITY OF CEMENT
6-1/4"	5-1/2"	14#	30'	5 SX
4-3/4"	2-7/8"	6.4#	1400'	175 cu ft

Plan to drill 4-3/4" hole with air or minimum mud to 1400' to test Pictured Cliffs formation.

Do not plan to have blowout preventer on well while drilling. Master valve and stripper head will be installed while completing.

NMERB Requirement: Gas not dedicated.



IN ABOVE SPACE DESCRIBE PROPOSED PROGRAM: If proposal is to deepen or plug back, give data on present productive zone and proposed new productive zone. If proposal is to drill or deepen directionally, give pertinent data on subsurface locations and measured and true vertical depths. Give blowout preventer program, if any.

## 24.

SIGNED

Richard Tully

TITLE

Landman

DATE

8-10-77

(This space for Federal or State office use)

PERMIT NO.

APPROVAL DATE

APPROVED BY

TITLE

CONDITIONS OF APPROVAL, IF ANY:

AUG 10 1977

U. S. GEOLOGICAL

\*See Instructions On Reverse Side

NEW MEXICO OIL CONSERVATION COMMISSION  
WELL LOCATION AND ACREAGE DEDICATION PLAT

Form C-102  
Supersedes C-128  
Effective 1-1-65

All distances must be from the outer boundaries of the Section.

Operator <b>Dugan Production Corporation</b>			Lease <b>KR</b>		Well No. <b>6</b>
Unit Letter <b>N</b>	Section <b>19</b>	Township <b>27 North</b>	Range <b>13 West</b>	County <b>San Juan</b>	
Actual Footage Location of Well: <b>990</b> feet from the <b>South</b> line and <b>1650</b> feet from the <b>West</b> line					
Ground Level Elev. <b>6137</b>	Producing Formation <b>Pictured Cliffs</b>	Pool <b>WAW</b>	Dedicated Acreage: <b>184.64</b> Acres		

1. Outline the acreage dedicated to the subject well by colored pencil or hachure marks on the plat below.
2. If more than one lease is dedicated to the well, outline each and identify the ownership thereof (both as to working interest and royalty).
3. If more than one lease of different ownership is dedicated to the well, have the interests of all owners been consolidated by communitization, unitization, force-pooling, etc?

☐ Yes ☐ No If answer is "yes," type of consolidation \_\_\_\_\_

If answer is "no," list the owners and tract descriptions which have actually been consolidated. (Use reverse side of this form if necessary.) \_\_\_\_\_

No allowable will be assigned to the well until all interests have been consolidated (by communitization, unitization, forced-pooling, or otherwise) or until a non-standard unit, eliminating such interests, has been approved by the Commission.

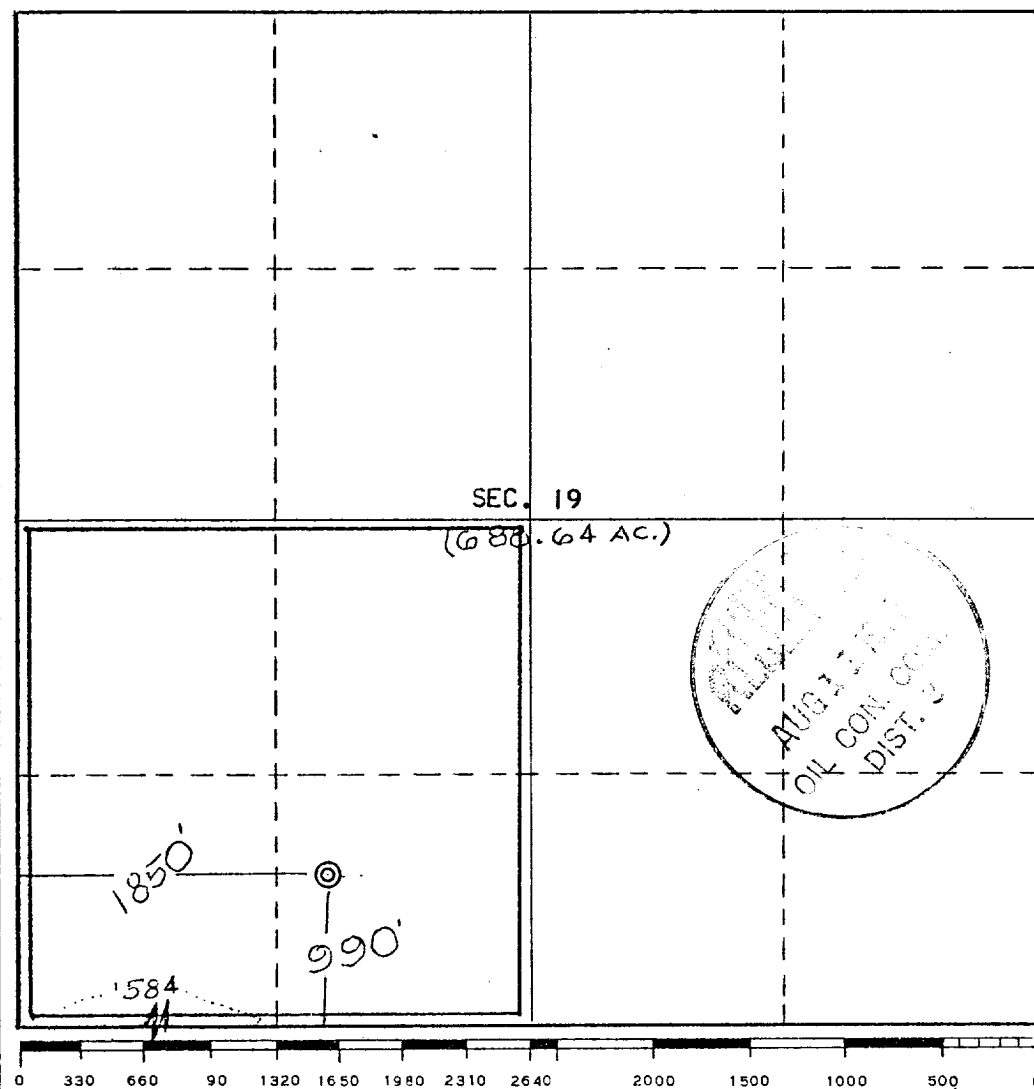

CERTIFICATION

I hereby certify that the information contained herein is true and complete to the best of my knowledge and belief.

*Richard Tully*

Name  
**Richard Tully**  
Position  
**Landman**  
Company  
**Dugan Production Corp.**  
Date  
**8-10-77**

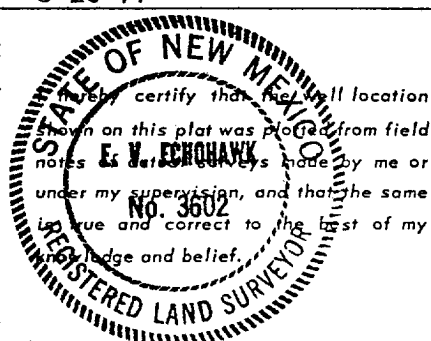

Date Surveyed  
**August 7, 1977**  
Registered Professional Engineer  
and/or Land Surveyor  
*E. V. Echokaw*  
Certificate No. **3602**  
**E.V. Echokaw LS**

STATE OF NEW MEXICO  
OIL CONSERVATION COMMISSION  
1000 Rio Brazos Road  
Aztec, New Mexico 87410

August 22, 1977

Dugan Production Corp.  
Box 234  
Farmington, NM

Attention: \_\_\_\_\_

SUBJECT: NON-STANDARD GAS PRORATION UNIT CONSISTING OF 84.64 ACRES  
IN THE WAW Pictured Cliffs ext. GAS POOL DESCRIBED AS  
FOLLOWS:

TOWNSHIP 27 NORTH, RANGE 13 WEST, NMPM

SECTION: 19 SW/4

By authority granted me by Rule 5(B) of Order No. R-1670, as amended, the  
above-described acreage has been approved as a non-standard gas proration  
unit to be dedicated to the KR  
Well No. 6, located 990/S; 1850/W of said  
Section, 19.

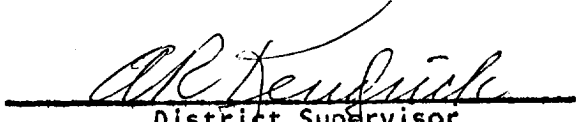
  
District Supervisor  
District #3

cc: Oil Conservation Commission  
Santa Fe, New Mexico