

UNITED STATES
DEPARTMENT OF THE INTERIOR
GEOLOGICAL SURVEY

SUNDRY NOTICES AND REPORTS ON WELLS

(Do not use this form for proposals to drill or to deepen or plug back to a different reservoir. Use Form 9-331-C for such proposals.)

1. oil ☐ gas ☒ other ☐
2. NAME OF OPERATOR
Oklahoma Oil Co.
3. ADDRESS OF OPERATOR
1120 One Energy Square, Dallas, TX 75206
4. LOCATION OF WELL (REPORT LOCATION CLEARLY. See space 17 below.)
AT SURFACE: 1190' FNL and 1550' FEL
AT TOP PROD. INTERVAL: same
AT TOTAL DEPTH: same

16. CHECK APPROPRIATE BOX TO INDICATE NATURE OF NOTICE, REPORT, OR OTHER DATA

REQUEST FOR APPROVAL TO:	SUBSEQUENT REPORT OF:
TEST WATER SHUT-OFF <input type="checkbox"/>	<input type="checkbox"/>
FRACTURE TREAT <input type="checkbox"/>	<input type="checkbox"/>
SHOOT OR ACIDIZE <input type="checkbox"/>	<input checked="" type="checkbox"/>
REPAIR WELL <input type="checkbox"/>	<input type="checkbox"/>
PULL OR ALTER CASING <input type="checkbox"/>	<input type="checkbox"/>
MULTIPLE COMPLETE <input type="checkbox"/>	<input type="checkbox"/>
CHANGE ZONES <input type="checkbox"/>	<input type="checkbox"/>
ABANDON* <input type="checkbox"/>	<input type="checkbox"/>
(other) <input type="checkbox"/>	<input type="checkbox"/>

17. DESCRIBE PROPOSED OR COMPLETED OPERATIONS (Clearly state all pertinent details, and give pertinent dates, including estimated date of starting any proposed work. If well is directionally drilled, give subsurface locations and measured and true vertical depths for all markers and zones pertinent to this work.)*

Ran GR-CCL 109. Swabbed casing dry. Perforated Fruitland formation 1620-24 (4') and 1630 - 38 (8') with 2 jet shots per foot. Acidized with 500 gallons 15% "Gas well acid" and swab to recover. Well flowing to test.

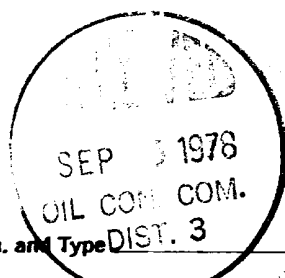

Subsurface Safety Valve: Manu. and Type Set @ 2500'.

18. I hereby certify that the foregoing is true and correct.

SIGNED John Alexander TITLE Agent DATE August 29, 1976

(This space for Federal or State office use)

APPROVED BY _____ TITLE _____ DATE _____
CONDITIONS OF APPROVAL, IF ANY:

*See Instructions on Reverse Side

5. LEASE SF 078872A	
6. IF INDIAN, ALLOTTEE OR TRIBE NAME	
7. UNIT AGREEMENT NAME	
8. FARM OR LEASE NAME Bolack	
9. WELL NO. 1	
10. FIELD OR WILDCAT NAME West Kutz	
11. SEC., T., R., OR BLK. AND SURVEY OR AREA Sec 28, T27N, R12W	
12. COUNTY OR PARISH San Juan	13. STATE New Mexico
14. API NO.	
15. ELEVATIONS (SHOW OF KDB AND WD) 6308	

(NOTE: Report results of multiple completion or zone change on Form 9-330.)

NEW MEXICO OIL CONSERVATION COMMISSION
WELL LOCATION AND ACREAGE DEDICATION PLAT

Supersedes C-128
Effective 1-1-65

All distances must be from the outer boundaries of the Section.

Operator OKLAHOMA OIL COMPANY			Lease BOLACK "B"		Well No. 1
Unit Letter B	Section 28	Township 27N	Range 11W	County San Juan	
Actual Footage Location of Well: 1190 feet from the North line and 1550 feet from the East line					
Ground Level Elev. 6308	Producing Formation Fruitland		Pool Gallagos	Dedicated Acreage: 160 Acres	

1. Outline the acreage dedicated to the subject well by colored pencil or hachure marks on the plat below.
2. If more than one lease is dedicated to the well, outline each and identify the ownership thereof (both as to working interest and royalty).
3. If more than one lease of different ownership is dedicated to the well, have the interests of all owners been consolidated by communitization, unitization, force-pooling, etc?

☐ Yes ☐ No If answer is "yes," type of consolidation _____

If answer is "no," list the owners and tract descriptions which have actually been consolidated. (Use reverse side of this form if necessary.) _____

No allowable will be assigned to the well until all interests have been consolidated (by communitization, unitization, forced-pooling, or otherwise) or until a non-standard unit, eliminating such interests, has been approved by the Commission.

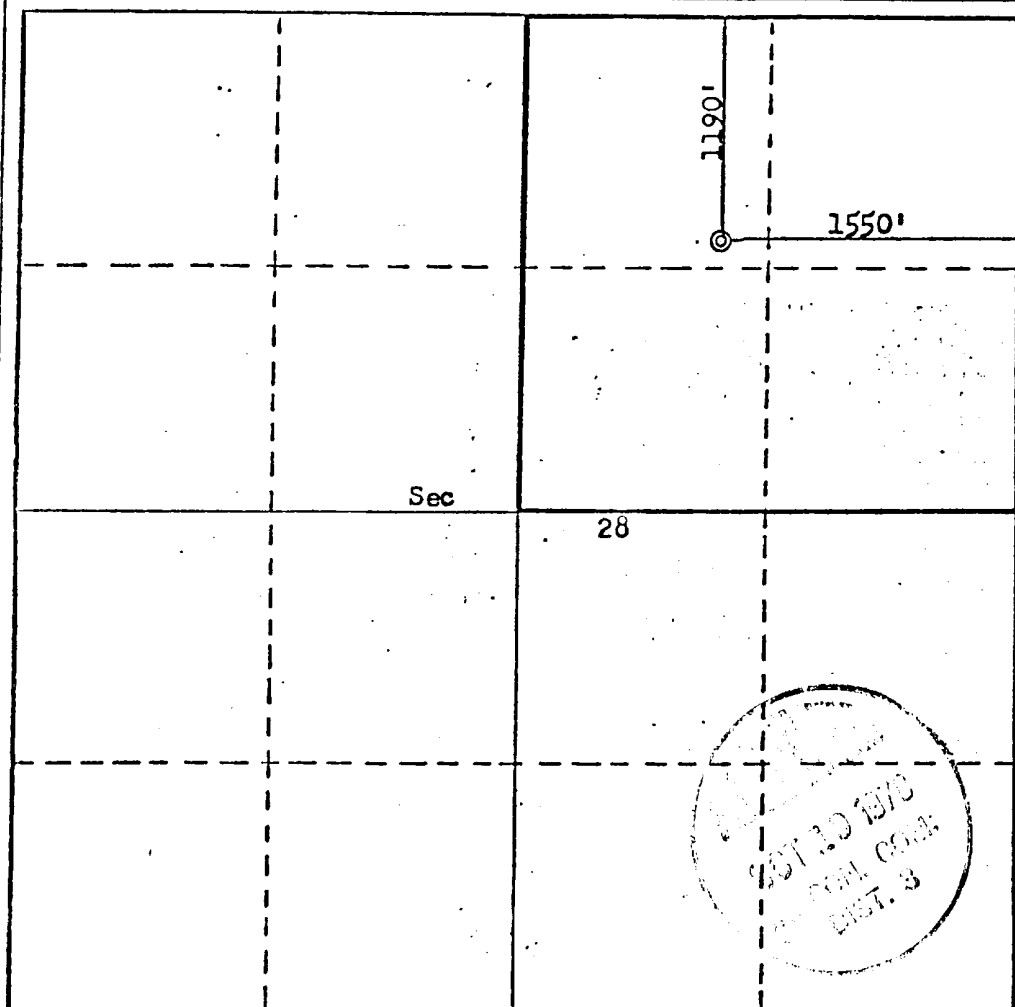

CERTIFICATION

I hereby certify that the information contained herein is true and complete to the best of my knowledge and belief.

John Alexander

Name

John Alexander

Position

AGENT

Company

Oklahoma Oil Company

Date

6-10-6-78

I hereby certify that the well location shown on this plat was plotted from field notes of actual surveys made by me or under my supervision, and that the same is true and correct to the best of my knowledge and belief.

Date Surveyed

May 10, 1978

Registered Professional Engineer
and/or Registered Surveyor

Fred B. Kern Jr.

Certificate No.

392

0 330 660 990 1320 1650 1980 2310 2640 2970 3300 3630 3960 4290 4620 4950 5280 5610 5940 6270 6600