

OIL CONSERVATION COMMISSION

Albuquerque DISTRICT

OIL CONSERVATION COMMISSION
BOX 2088
SANTA FE, NEW MEXICO

DATE 5-18-78

RE: Proposed MC _____
Proposed DHC _____
Proposed NSL ✓ _____
Proposed SWD _____
Proposed WFX _____
Proposed PMX _____

R. L. Stamets

Gentlemen:

I have examined the application dated 5-17-78
for the Mission & Bayless Hi Roll #3 G-35-27N-13W
Operator Lease and Well No. Unit, S-T-R

and my recommendations are as follows:

Approve

Yours very truly,

AR Hendrick

J. GREGORY MERRION
PETROLEUM ENGINEER
P. O. BOX 807
FARMINGTON, NEW MEXICO 87401

May 17, 1978

Dietrich Exploration Co., Inc.
602 Midland Savings Bldg.
444 17th Street
Denver, CO 80202

RE: Hi Roll #3
NE/4 Sec. 35, T27N, R13W
San Juan County, NM

Gentlemen:

You will note from the enclosed copy of application we are requesting an unorthodox location for the above referred to well, and if you have no objection we would appreciate your signing the enclosed waiver and sending it direct to the New Mexico Oil Conservation Commission, P.O. Box 2088, Santa Fe, NM 87501.

Yours very truly,

MERRION & BAYLESS

By

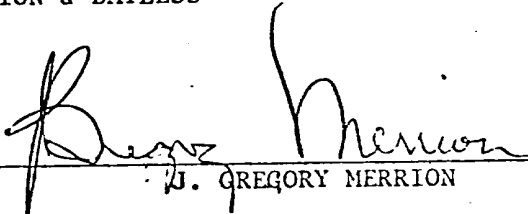

J. GREGORY MERRION

JGM/eh

Enclosure: Waiver Form

cc: ✓ NMOCC
Santa Fe

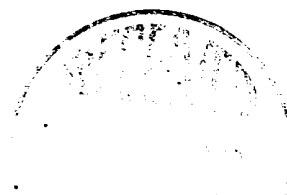
Atty



J. GREGORY MERRION
PETROLEUM ENGINEER
P. O. BOX 807
FARMINGTON, NEW MEXICO 87401

May 17, 1978

Dome Petroleum Corp.
1500 Colorado State Bank Bldg.
Denver, CO 80202

RE: Hi Roll #3
NE/4 Sec. 35, T27N, R13W
San Juan County, NM

Gentlemen:

You will note from the enclosed copy of application we are requesting an unorthodox location for the above referred to well, and if you have no objection we would appreciate your signing the enclosed waiver and sending it direct to the New Mexico Oil Conservation Commission, P.O. Box 2088, Santa Fe, NM 87501.

Yours very truly,

MERRION & BAYLESS

By

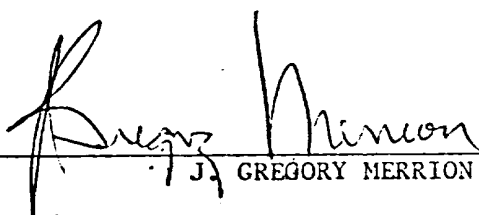
J. GREGORY MERRION

JGM/eh

Enclosure: Waiver Form

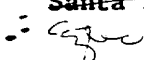
cc: NMOCC
Santa Fe

J. GREGORY MERRION
PETROLEUM ENGINEER
P. O. BOX 807
FARMINGTON, NEW MEXICO 87401

May 17, 1978

Jerome P. McHugh & Assoc.
Suite 1225
600 South Cherry St.
Denver, CO 80222

RE: Hi Roll #3
NE/4 Sec. 35, T27N, R13W
San Juan County, NM

Gentlemen:

You will note from the enclosed copy of application we are requesting an unorthodox location for the above referred to well, and if you have no objection we would appreciate your signing the enclosed waiver and sending it direct to the New Mexico Oil Conservation Commission, P.O. Box 2088, Santa Fe, NM 87501.

Yours very truly,

MERRION & BAYLESS

By

J. GREGORY MERRION

JGM/eh

Enclosure: Waiver Form

cc: NMOCC

- Santa Fe

- JPM

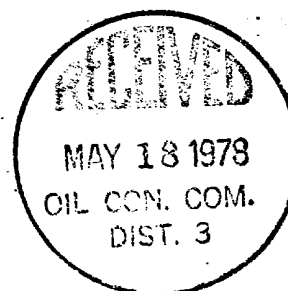

J. GREGORY MERRION
PETROLEUM ENGINEER
P. O. BOX 507
FARMINGTON, NEW MEXICO 87401

May 17, 1978

New Mexico Oil Conservation Commission
P.O. Box 2088
Santa Fe, New Mexico 87501

RE: Hi Roll #3
Pic. Cliff Test
NE/4 Sec. 35, T27N, R13W
San Juan County, NM

Gentlemen:

Please accept this as our application for administrative approval of an unorthodox location for the above well as shown on the attached survey plat. You will note we have moved the location 100 feet north from the orthodox location to comply with the requirements of the Navajo Indian Irrigation Project.

We are sending a copy of this application to the offset acreage holders along with a request for waiver on their part if they have no objection.

Yours very truly,

MERRION & BAYLESS

By 
J. GREGORY MERRION

JGM/eh

Enclosure: Intent to Drill
Survey Plat

cc: ✓ 2 copies - Aztec NMOCC
1 copy - each offset acreage holder



UNITED STATES
DEPARTMENT OF THE INTERIOR
GEOLOGICAL SURVEY

APPLICATION FOR PERMIT TO DRILL, DEEPEN, OR PLUG BACK

1a. TYPE OF WORK DRILL ☒ DEEPEN ☐ PLUG BACK ☐b. TYPE OF WELL
OIL WELL ☐ GAS WELL ☒ OTHER ☐ SINGLE ZONE ☒ MULTIPLE ZONE ☐

2. NAME OF OPERATOR

J. Gregory Merrion and Robert L. Bayless

3. ADDRESS OF OPERATOR

P.O. Box 1541, Farmington, NM 87401

4. LOCATION OF WELL (Report location clearly and in accordance with any State requirements.)
At surface

1350 FNL and 1850 FEL

At proposed prod. zone

Same

14. DISTANCE IN MILES AND DIRECTION FROM NEAREST TOWN OR POST OFFICE*

14 miles south of Farmington

18. DISTANCE FROM PROPOSED*

LOCATION TO NEAREST
PROPERTY OR LEASE LINE, FT.
(Also to nearest drlg. unit line, if any)

1350'

18. DISTANCE FROM PROPOSED LOCATION*
TO NEAREST WELL, DRILLING, COMPLETED,
OR APPLIED FOR, ON THIS LEASE, FT.

2450'

16. NO. OF ACRES IN LEASE

640

19. PROPOSED DEPTH

1300'

17. NO. OF ACRES ASSIGNED
TO THIS WELL

160

20. ROTARY OR CABLE TOOLS

Rotary

21. ELEVATIONS (Show whether DF, RT, GR, etc.)

6007' GL

22. APPROX. DATE WORK WILL START*

As soon as possible

23. PROPOSED CASING AND CEMENTING PROGRAM

SIZE OF HOLE	SIZE OF CASING	WEIGHT PER FOOT	SETTING DEPTH	QUANTITY OF CEMENT
7-7/8"	5-1/2"	15.5#	30 ft.	10 sacks
4-3/4"	2-7/8"	6.4#	1300 ft.	100 sacks

Will drill 7-7/8" hole to 30 ft. and set 30 ft. of 5-1/2", 15.5# casing with 10 sacks cement. Will drill 4-3/4" hole to 1300 ft. and run logs. If appears productive, will run 1300 ft. of 2-7/8", 6.4#, J-55 casing and cement with 100 sacks. Will perforate and stimulate as required. Minimum specifications for pressure control equipment which is to be used - none required. Circulating medium will be clear water and natural mud and water loss control additives. The gas from this formation is not dedicated.

ESTIMATED TOPS:

Formation

Ojo Alamo

Kirtland

Fruitland

Picture Cliff

Depth

Below Surface Alluvium

137 ft.

1030 ft.

1237 ft.

Content

Water

Natural Gas

IN ABOVE SPACE DESCRIBE PROPOSED PROGRAM: If proposal is to deepen or plug back, give data on present productive zone and proposed new productive zone. If proposal is to drill or deepen directionally, give pertinent data on subsurface locations and measured and true vertical depths. Give blowout preventer program, if any.

24.

SIGNED

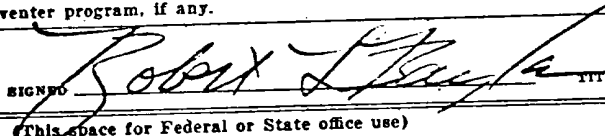

TITLE

Co-Owner

DATE May 3, 1978

PERMIT NO.

APPROVAL DATE

APPROVED BY

TITLE

DATE

CONDITIONS OF APPROVAL, IF ANY:

*See Instructions On Reverse Side

NEW MEXICO OIL CONSERVATION COMMISSION
WELL LOCATION AND ACREAGE DEDICATION PLAT

Form C-102
Supersedes C-128
Effective 1-1-63

All distances must be from the outer boundaries of the Section.

Operator Merrion & Bayless			Lease H1 Roll		Well No. 3
Unit Letter 0	Section 35	Township 27N	Range 13W	County San Juan	
Actual Footage Location of Well: 1350 feet from the North line and 1850 feet from the East line					
Ground Level Elev. 6007	Producing Formation Pictured Cliffs		Pool NIPP Pictured Cliffs		Dedicated Acreage: 160 Acres

1. Outline the acreage dedicated to the subject well by colored pencil or hachure marks on the plat below.
2. If more than one lease is dedicated to the well, outline each and identify the ownership thereof (both as to working interest and royalty).
3. If more than one lease of different ownership is dedicated to the well, have the interests of all owners been consolidated by communitization, unitization, force-pooling, etc?

☐ Yes ☐ No If answer is "yes," type of consolidation _____

If answer is "no," list the owners and tract descriptions which have actually been consolidated. (Use reverse side of this form if necessary.) _____

No allowable will be assigned to the well until all interests have been consolidated (by communitization, unitization, forced-pooling, or otherwise) or until a non-standard unit, eliminating such interests, has been approved by the Commission.

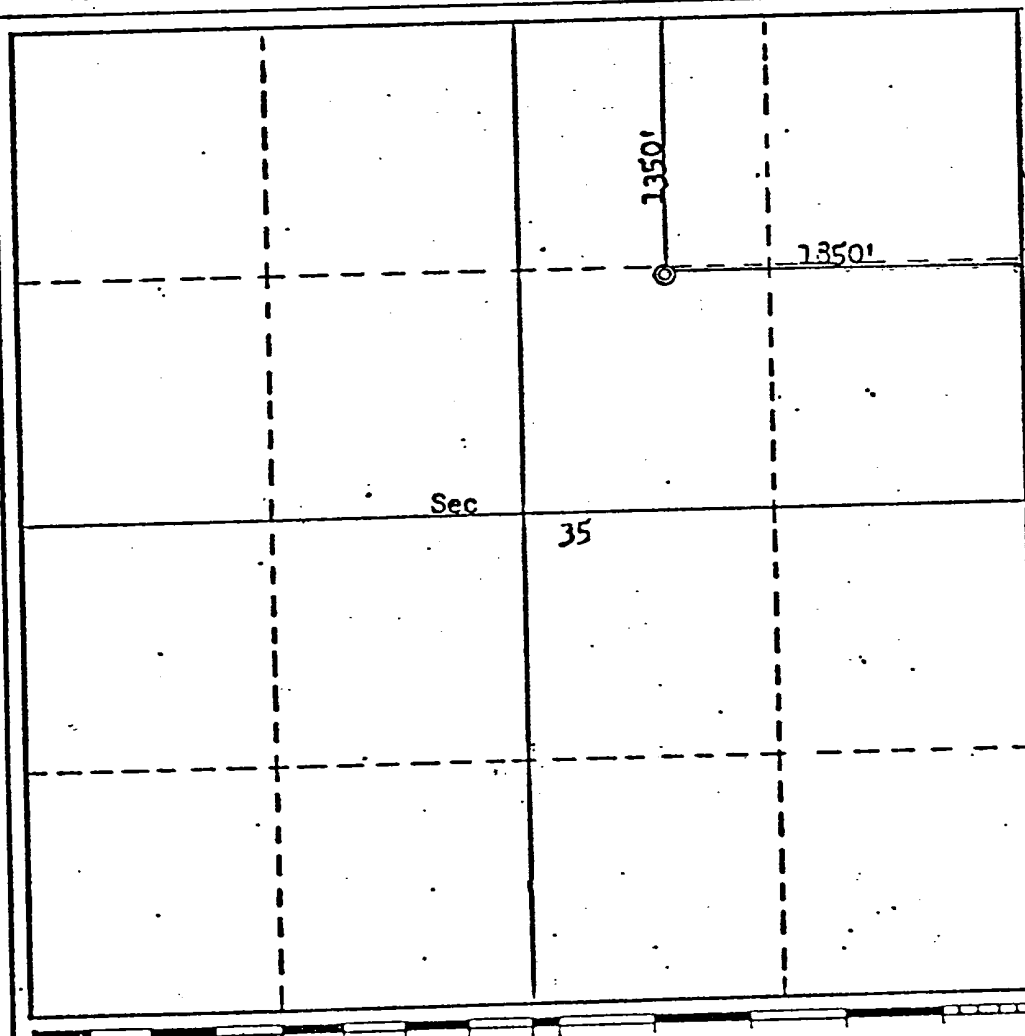

CERTIFICATION

I hereby certify that the information contained herein is true and complete to the best of my knowledge and belief.

Robert L. Bayless

Name
Robert L. Bayless

Position
Co-Owner

Company
Merrion & Bayless

Date
April 5, 1978

I hereby certify that the well location shown on this plat was plotted from field notes of actual surveys made by me or under my supervision, and that the same is true and correct to the best of my knowledge and belief.

Date Surveyed
April 3, 1978

Registered Professional Engineer
and/or (and Surveyor)

Fred S. Kerr Jr.

Certificate No. 2, 1978, 1979

3950