

UNITED STATES  
DEPARTMENT OF THE INTERIOR  
GEOLOGICAL SURVEY

30-045-23128

APPLICATION FOR PERMIT TO DRILL, DEEPEN, OR PLUG BACK

5. LEASE DESIGNATION AND SERIAL NO.  
Santa Fe Contract 1-149  
Indian Contract 8467

6. IF INDIAN, ALLOTTEE OR TRIBE NAME

7. UNIT AGREEMENT NAME

8. FARM OR LEASE NAME  
Jernigan

9. WELL NO.  
#3-A

10. FIELD AND POOL, OR WILDCAT  
Blanco Mesa Verde 72319

11. SEC., T., R., M., OR BLK. AND SURVEY OR AREA  
Section 24, T27N, R9W

12. COUNTY OR PARISH  
San Juan

13. STATE  
New Mexico

14. DISTANCE IN MILES AND DIRECTION FROM NEAREST TOWN OR POST OFFICE\*  
23 Miles Southeast of Bloomfield, New Mexico

15. DISTANCE FROM PROPOSED\* LOCATION TO NEAREST PROPERTY OR LEASE LINE, FT. (Also to nearest drlg. unit line, if any)

16. NO. OF ACRES IN LEASE

17. NO. OF ACRES ASSIGNED TO THIS WELL  
E/320

18. DISTANCE FROM PROPOSED LOCATION\* TO NEAREST WELL, DRILLING, COMPLETED, OR APPLIED FOR, ON THIS LEASE, FT.

19. PROPOSED DEPTH  
4643'

20. ROTARY OR CABLE TOOLS  
Rotary

21. ELEVATIONS (Show whether DF, RT, GR, etc.)  
6028' GL

22. APPROX. DATE WORK WILL START\*  
July 10, 1978

PROPOSED CASING AND CEMENTING PROGRAM

SIZE OF HOLE	SIZE OF CASING	WEIGHT PER FOOT	SETTING DEPTH	QUANTITY OF CEMENT
12-1/4"	9-5/8"	36#	200'	110 SXS
8-3/4"	7"	20#	2256'	165 SXS
6-1/4"	4-1/2"	10.5#	2106'-4643'	300 SXS
	2-3/8"	4.7#		

Surface formation is Nacimiento.  
Top of Ojo Alamo is at 1264'.  
Top of Pictured Cliffs is at 2006'.  
Top of Point Lookout is at 4293'.

Fresh water mud will be used to drill from surface to intermediate total depth.  
An air system will be used to drill from intermediate casing point to total depth.  
It is anticipated that a Gamma Ray Induction Log and Gamma Ray Density Log be run at total depth.

No abnormal pressures or poisonous gases are anticipated in this well.  
It is expected that this well be drilled before August 15, 1978. This depends on rig availability, time required for approvals and the weather.  
Gas is dedicated.

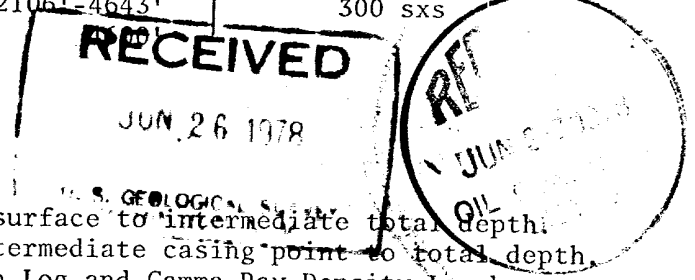

IN ABOVE SPACE DESCRIBE PROPOSED PROGRAM: If proposal is to deepen or plug back, give data on present productive zone and proposed new productive zone. If proposal is to drill or deepen directionally, give pertinent data on subsurface locations and measured and true vertical depths. Give blowout preventer program, if any.

24. SIGNED CC Parsons TITLE District Engineer DATE June 22, 1978

(This space for Federal or State office use)

PERMIT NO. \_\_\_\_\_ APPROVAL DATE \_\_\_\_\_

APPROVED BY \_\_\_\_\_ TITLE \_\_\_\_\_ DATE \_\_\_\_\_

CONDITIONS OF APPROVAL, IF ANY:

ok Frank

\*See Instructions On Reverse Side

NEW MEXICO OIL CONSERVATION COMMISSION  
WELL LOCATION AND ACREAGE DEDICATION PLAT

Form C-102  
Supersedes C-128  
Effective 1-1-65

All distances must be from the outer boundaries of the Section.

Operator <b>SOUTHLAND ROYALTY COMPANY</b>			Lease <b>JERNIGAN</b>		Well No. <b>3A</b>
Unit Letter <b>I</b>	Section <b>24</b>	Township <b>27N</b>	Range <b>9W</b>	County <b>San Juan</b>	

Actual Footage Location of Well:  
**1500** feet from the **South** line and **975** feet from the **East** line  
 Ground Level Elev. **6028** Producing Formation **Mesa Verde** Pool **Blanco** Dedicated Acreage: **320** Acres

1. Outline the acreage dedicated to the subject well by colored pencil or hachure marks on the plat below.
2. If more than one lease is dedicated to the well, outline each and identify the ownership thereof (both as to working interest and royalty).
3. If more than one lease of different ownership is dedicated to the well, have the interests of all owners been consolidated by communitization, unitization, force-pooling, etc?

Yes  No If answer is "yes," type of consolidation \_\_\_\_\_

If answer is "no," list the owners and tract descriptions which have actually been consolidated. (Use reverse side of this form if necessary.) \_\_\_\_\_

No allowable will be assigned to the well until all interests have been consolidated (by communitization, unitization, forced-pooling, or otherwise) or until a non-standard unit, eliminating such interests, has been approved by the Commission.

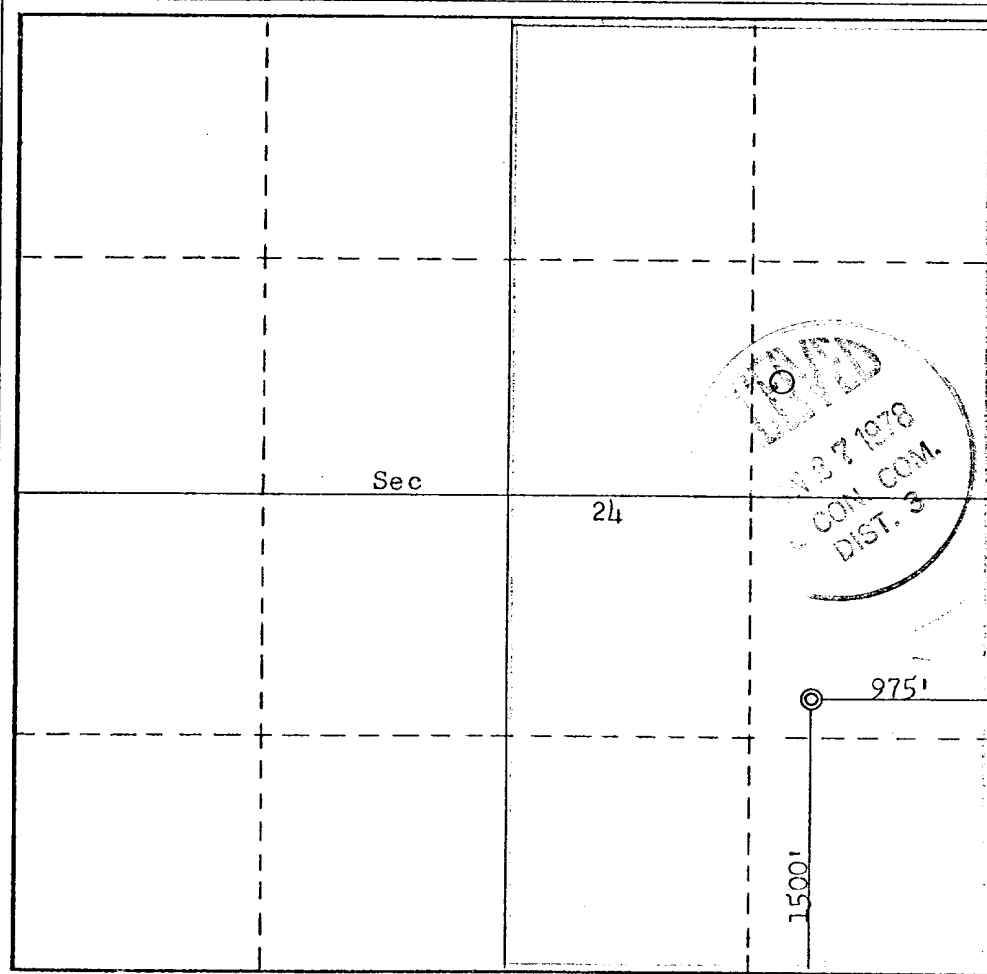

CERTIFICATION

I hereby certify that the information contained herein is true and complete to the best of my knowledge and belief.

Name *C. C. Parsons*  
 Position **District Engineer**  
 Company **Southland Royalty Company**  
 Date **June 22, 1978**

I hereby certify that the well location shown on this plot was plotted from field notes of actual surveys made by me or under my supervision, and that the same is true and correct to the best of my knowledge and belief.

Date Surveyed **May 6, 1978**  
 Registered Professional Engineer and/or Land Surveyor  
*Fred B. Kerr Jr.*  
**Fred B. Kerr Jr.**

Certificate No. **3950**

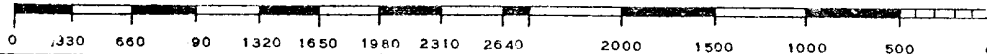



**Southland Royalty Company**

June 22, 1978

United States Geological Survey  
P. O. Box 959  
Farmington, New Mexico

Attention: Mr. P. T. McGrath

Dear Sir:

Enclosed please find map showing existing roads and planned access roads to Southland Royalty Company's Jernigan #3-A well. The locations of tank batteries and flow lines will be on location with well. A burn pit will be provided for disposal of trash. Cuttings, drilling fluid and produced fluids will be put into the reserve pit and properly disposed of depending on amount and type of fluids.

Contractor will furnish restroom facilities on location.

There will be no air strips or camps.

Also, enclosed is a location layout showing approximate location of rig, pits and pipe racks and cut required to build this location.

Water supply will be the Waterhole along Blanco Wash. All water will be transported by truck and stored on location.

The location will be restored according to Bureau of Land Management standards. This work will begin when all related construction is finished.

Mr. Max Larson will be Southland Royalty Company's field representative supervising these operations.

Yours truly,

C. C. Parsons  
District Engineer

CCP/eg



**Southland Royalty Company**

United States Geological Survey  
P. O. Box 959  
Farmington, New Mexico 87401

Attention: Mr. P. T. McGrath

Dear Sir:

I hereby certify that I, or persons under my direct supervision, have inspected the proposed drillsite and access route; that I am familiar with the conditions which presently exist; that the statements made in this plan are, to the best of my knowledge, true and correct; and, that the work associated with the operations proposed herein be performed by Southland Royalty Company and its contractors and subcontractors in conformity with this plan and the terms and conditions under which it is approved.

Date: June 22, 1978

Name: CC Parsons

Title: District Engineer



**Southland Royalty Company**

June 22, 1978

United State Geological Survey  
P. O. Box 959  
Farmington, New Mexico 87401

Attention: Blowout Preventer Plan

Dear Sir:

All drilling and completion rigs will be equipped with 6" or larger double gate hydraulic blowout preventers and a hydraulic operated closing unit with steel lines.

The preventer is 3000# working pressure and 6000# test.

All crews will be thoroughly trained in the operation of this preventer. The preventer will be tested frequently enough to insure proper operation.

Yours truly,

C. C. Parsons  
District Engineer

CCP/eg

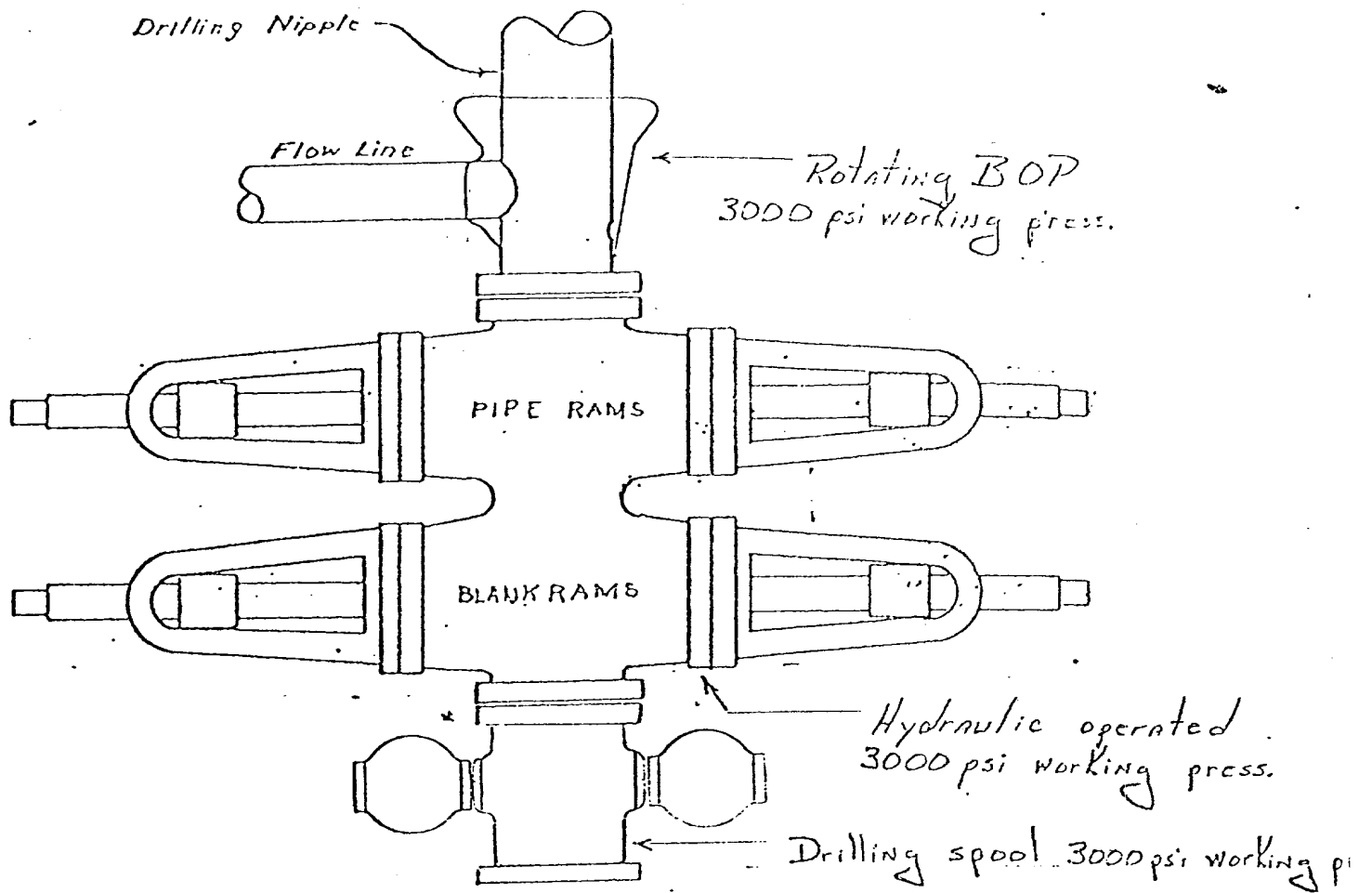

Preventers and spools are to have through bore of 6" - 3000# PSI or larger.

Location Profile for  
 SOUTHLAND ROYALTY CO. # 3A Jernigan  
 1500' FSL 975' FWL Sec 24-T27N-R9W  
 San Juan County, New Mexico

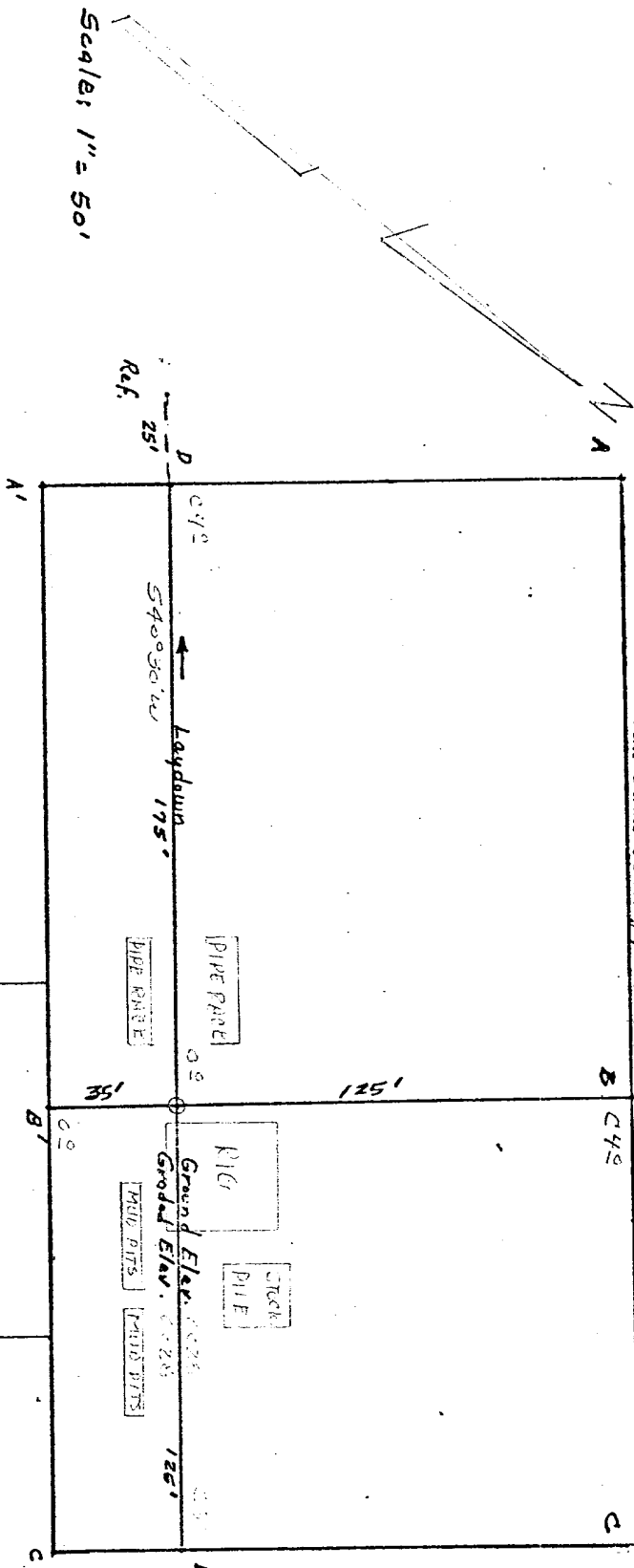

**ILLEGIBLE**

Vert. 1" = 40' Horiz: 1" = 100'

5012				
6012				
6012				
6012				

B-D'

6012				
6012				
6012				
6012				

Vert. 1" = 40' Horiz: 1" = 100'

B

KERR LAND SURVEYING  
 Date: May 6, 1978





DRILLING SCHEDULE - Jernigan #3A

Location: 1500'FSL & 975'FEL, Section 24, T27N, R9W, San Juan County, New Mexico

Field: Blanco Mesa Verde

Elevation: 6028' GL

Geology:

Formation Tops:	Ojo Alamo	1264'	Cliff House	3592'
	Fruitland	1777'	Pt. Lookout	4293'
	Pictured Cliffs	2006'	Total Depth	4643'
	Intermediate TD	2256'		

Logging Program: GR-Induction and GR-Density @ TD.

Coring Program: None

Natural Gauges: Gauge at last connection above Cliff House, Pt. Lookout, and TD.  
Gauge any increase in gas flow.

Drilling:

Contractor: Four Corners Drilling

Tool Pusher: Don Bettale

SRC Representative: Max Larson

SRC Ans. Service: 325-1841

Dispatch Number: 325-7391

Mud Program: Fresh water mud from surface to intermediate TD.  
Air from intermediate to total depth.

Materials:

Casing Program:	Hole Size	Depth	Casing Size	Wt. & Grade
	12-1/4"	200'	9-5/8"	36# K-55
	8-3/4"	2256'	7"	20# K-55
	6-1/4"	2106-4643'	4-1/2"	10.5# K-55

Float Equipment:

9-5/8" Surface Casing: Pathfinder Type "A" Guide Shoe. Product #2003-1-012

7" Intermediate Casing: Pathfinder Type "A" Guide Shoe. Product #2003-1-007.  
Howco self fill insert valve. 5-Pathfinder rigid centralizers.  
Run float valve 2 joints above shoe. Run centralizers every other joint above shoe.

4-1/2" Liner: Pathfinder Type "AP" Guide Shoe. Product #2017-1-050.  
Pathfinder Type "A" Flapper Float Collar. Product #2008-2-000

Tubing:

Wellhead Equipment: 9-5/8" x 10" 2000 casing head, 10" 2000 x 6" 2000 tubing head.