

OIL CONSERVATION COMMISSION

Antelope DISTRICT

OIL CONSERVATION COMMISSION
BOX 2088
SANTA FE, NEW MEXICO

DATE 3-13-79

RE: Proposed MC _____
Proposed DHC _____
Proposed NSL ✓ _____
Proposed SWD _____
Proposed WFX _____
Proposed PMX _____

Gentlemen:

I have examined the application dated 3-5-79
for the Southland Royalty Co. Frontier C #2-R P-5-27N-11W
Operator Lease and Well No. Unit, S-T-R

and my recommendations are as follows:

Approve

Yours very truly,

AR Kendrick



Southland Royalty Company

March 5, 1979

Mr. Joe D. Ramey
New Mexico Department of Energy And Minerals
Oil And Gas Division
P. O. Box 2088
Santa Fe, New Mexico 87501

Re: Frontier "C" #2-R
SE/4, Section 5, T27N, R11W
San Juan County, New Mexico

Dear Sir:

Southland Royalty Company hereby requests administrative approval of an exception to Rule 2 of Order 1670-C, Dakota pool rules, for the above captioned well.

The proposed location is 600' FSL and 900' FEL, Section 5, T27N, R11W, San Juan County, New Mexico. This non-standard location is requested in order to accomodate the Bureau of Indian Affairs Navajo Indian Irrigation Project. A letter from NIIP Project Manager is attached.

Also attached is a nine section plat of the area showing ownership. All offset operators have been provided with a copy of this application by certified mail.

Your cooperation in this matter will be appreciated.

Yours truly,

Curtis C. Parsons
District Engineer



CCP/kde

Attachments

P.O. DRAWER 570 (505) 325-1841 FARMINGTON, NEW MEXICO 87401



UNITED STATES
DEPARTMENT OF THE INTERIOR

BUREAU OF INDIAN AFFAIRS
NAVAJO INDIAN IRRIGATION PROJECT
3539 East 30th Street
Northwest Energy Bldg., Room 103
Farmington, New Mexico 87401

IN REPLY REFER TO:

RESOURCES
Irrigation (NIIP)

February 23, 1979

Mr. Curtis C. Parsons, District Engineer
Southland Royalty Company
P. O. Drawer 570
Farmington, New Mexico 87401

Dear Mr. Parsons:

Enclosed are two copies of a sketch of our proposed sprinkler irrigation systems and your proposed well location in Section 5, T. 27 N., R. 11 W. Your proposed location is 900' FEL, 600' FSL. As indicated on the sketch this location is critical if interference with center pivot sprinkler systems is to be avoided.

Sincerely yours,

Walter E. Rein
Acting Project Manager

Enclosures 2



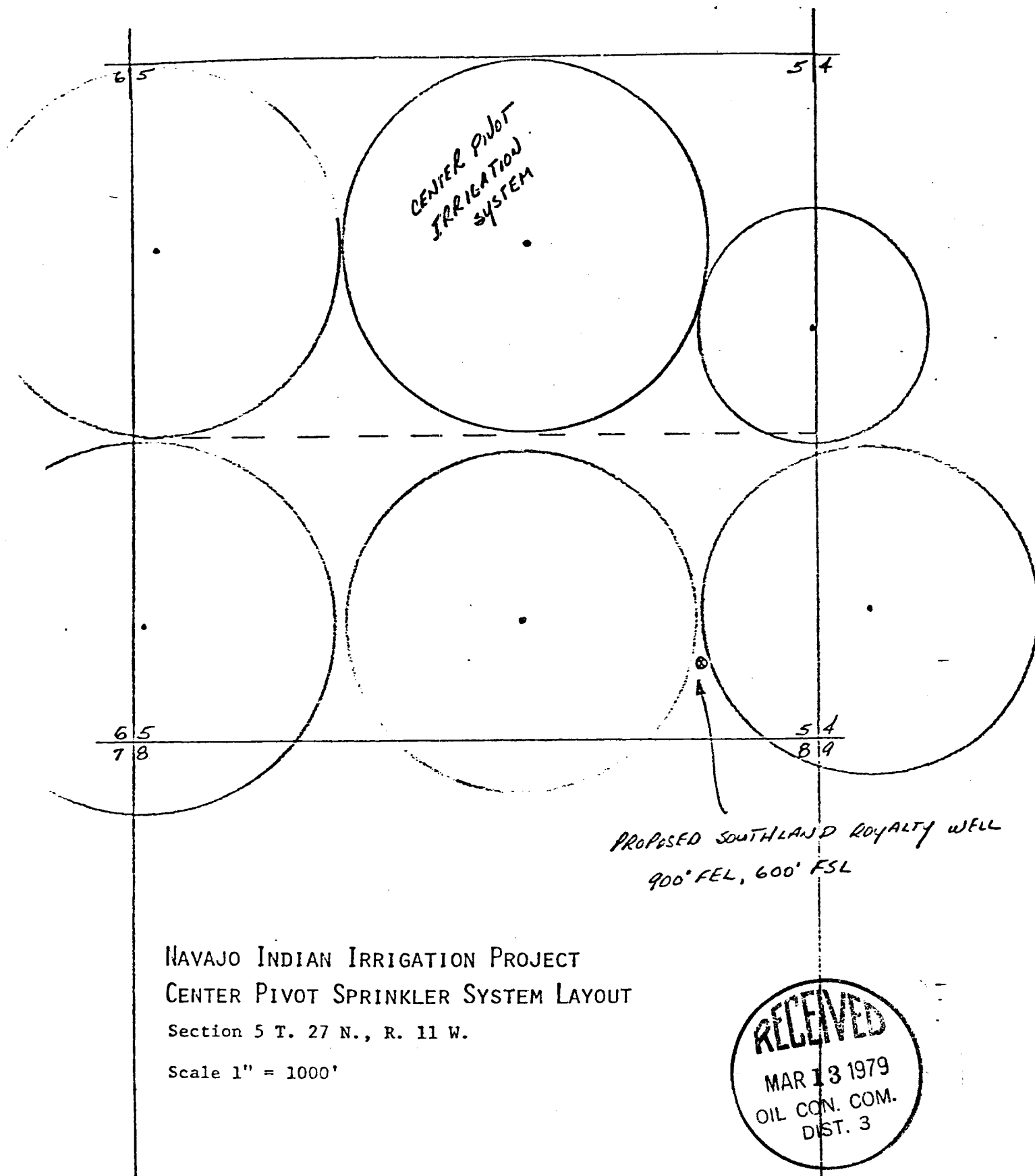

NAVAJO INDIAN IRRIGATION PROJECT
CENTER PIVOT SPRINKLER SYSTEM LAYOUT

Section 5 T. 27 N., R. 11 W.

Scale 1" = 1000'



R-111-W

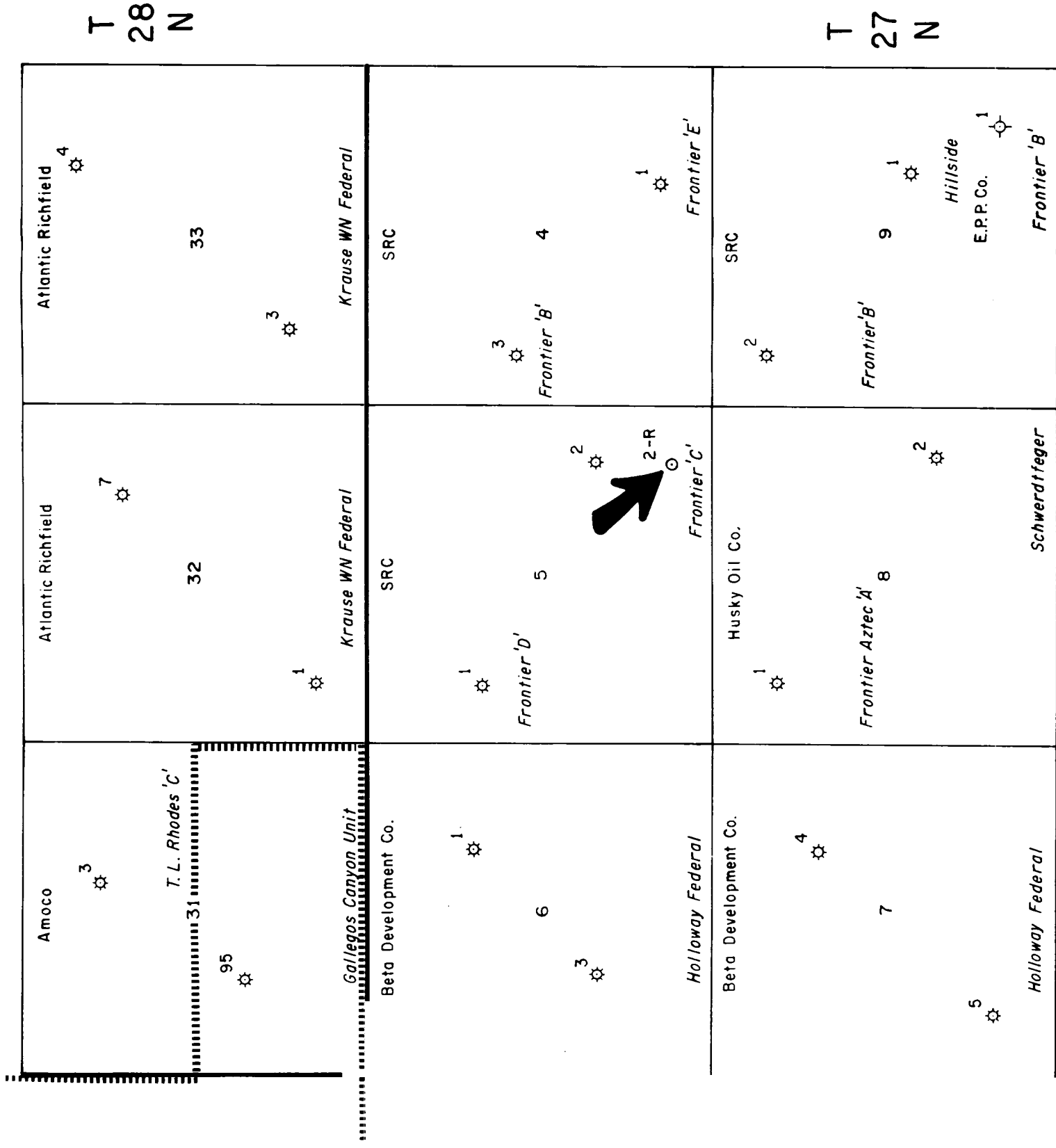



Southland Royalty Company

P.O. Drawer 570
Farmington, New Mexico 87401

3 - 8 - 1979
DATE
C. Parsons
PREPARED BY
San Juan Basin
PROJECT AREA
C.I. HORIZON
1" = 2000'
SCALE
REVISED DATE
FILE NUMBER

SAN JUAN CO., NEW MEXICO

UNORTHODOX LOCATION PLAT

SRC
#2-R Frontier-C'
600' FSL - 900' FEL
Sec. 5 - 27N - 11W