

| | |
|------------------------|---|
| NO. OF COPIES RECEIVED | 4 |
| DISTRIBUTION | |
| SANTA FE | 1 |
| FILE | 1 |
| U.S.G.S. | 2 |
| LAND OFFICE | 1 |
| OPERATOR | |

NEW MEXICO OIL CONSERVATION COMMISSION

30-045-270-47
Form C-101
Revised 1-1-65

| | |
|---|------------------------------|
| 5A. Indicate Type of Lease | |
| STATE <input checked="" type="checkbox"/> | FEE <input type="checkbox"/> |
| 5. State Oil & Gas Lease No. | |
| E-1199-3 | |

APPLICATION FOR PERMIT TO DRILL, DEEPEN, OR PLUG BACK

| | | | |
|--|--|----------------------------------|--|
| 1a. Type of Work | | 7. Unit Agreement Name | |
| b. Type of Well OIL WELL <input type="checkbox"/> GAS WELL <input checked="" type="checkbox"/> OTHER <input type="checkbox"/> | | Huerfanito Unit | |
| DEEPEN <input type="checkbox"/> PLUG BACK <input type="checkbox"/> | | 8. Farm or Lease Name | |
| SINGLE ZONE <input checked="" type="checkbox"/> MULTIPLE ZONE <input type="checkbox"/> | | Huerfanito Unit | |
| 2. Name of Operator | | 9. Well No. | |
| El Paso Natural Gas Company | | 86A | |
| 3. Address of Operator | | 10. Field and Pool, or Wildcat | |
| PO Box 289, Farmington, NM 87401 | | Blanco Mesa Verde | |
| 4. Location of Well UNIT LETTER <u>C</u> LOCATED <u>1000</u> FEET FROM THE <u>North</u> LINE | | 12. County | |
| AND <u>1800</u> FEET FROM THE <u>West</u> LINE OF SEC. <u>36</u> TWP. <u>27N</u> RGE. <u>1W</u> NMPM | | San Juan | |
| 19. Proposed Depth | | 19A. Formation | |
| 4850' | | Mesa Verde | |
| 20. Rotary or C.T. | | Rotary | |
| 21. Elevations (Show whether DF, RT, etc.) | | 22. Approx. Date Work will start | |
| 6244' GL | | | |
| 21A. Kind & Status Plug. Bond | | 21B. Drilling Contractor | |
| statewide | | | |

23.

PROPOSED CASING AND CEMENT PROGRAM

| SIZE OF HOLE | SIZE OF CASING | WEIGHT PER FOOT | SETTING DEPTH | SACKS OF CEMENT | EST. TOP |
|--------------|----------------|-----------------|---------------|-----------------|-----------|
| 12 1/4" | 8 5/8" | 32.3# | 200' | 140 sks. | circulate |
| 7 7/8" | 4 1/2" | 10.5# | 4850' | 539 sks. | 2 stages |

First stage - 285 sks. cement - 50% excess to cover Mesa Verde
Second stage - 254 sks. cement - 60% excess to cover Ojo Alamo

Selectively perforate and sandwater fracture the Mesa Verde formation.

A 3000 psi WP and 6000 psi test double gate preventer equipped with blind and pipe rams will be used for blow out prevention on this well.

This gas is dedicated.

The W/2 of Section 36 is dedicated to this well.

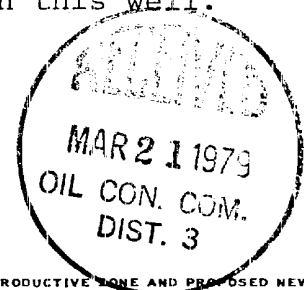

IN ABOVE SPACE DESCRIBE PROPOSED PROGRAM: IF PROPOSAL IS TO DEEPEN OR PLUG BACK, GIVE DATA ON PRESENT PRODUCTIVE ZONE AND PROPOSED NEW PRODUCTIVE ZONE, GIVE BLOWOUT PREVENTER PROGRAM, IF ANY.

I hereby certify that the information above is true and complete to the best of my knowledge and belief.

Signed Nora G. Buice Title Drilling Clerk Date March 20, 1979

(This space for State Use)

APPROVED BY Al Wendrich TITLE SUPERVISOR DATE MAR 21 1979

CONDITIONS OF APPROVAL, IF ANY:

NEW MEXICO OIL CONSERVATION COMMISSION WELL LOCATION AND ACREAGE DEDICATION PLAT

Form C-122
Supersedes C-128
Effective 1-1-65

All distances must be from the outer boundaries of the Section.

| | | | | |
|--|--|---------------------------------------|---|---------------------------|
| Operator EL PASO NATURAL GAS COMPANY | | Lease HUERFANITO (E-1199-3) | | Well No. 86A |
| Unit Letter C | Section 36 | Township 27-N | Range 9-W | County SAN JUAN |
| Actual Footage Location of Well: 1000 feet from the NORTH line and 1800 feet from the WEST line | | | | |
| Ground Level Elev. 6244 | Producing Formation MESA VERDE | Pool BLANCO MESA VERDE | Dedicated Acreage: 320.00 Acres | |

1. Outline the acreage dedicated to the subject well by colored pencil or hachure marks on the plat below.
2. If more than one lease is dedicated to the well, outline each and identify the ownership thereof (both as to working interest and royalty).
3. If more than one lease of different ownership is dedicated to the well, have the interests of all owners been consolidated by communitization, unitization, force-pooling, etc?

☒ Yes ☐ No If answer is "yes," type of consolidation Unitization

If answer is "no," list the owners and tract descriptions which have actually been consolidated. (Use reverse side of this form if necessary.)

No allowable will be assigned to the well until all interests have been consolidated (by communitization, unitization, forced-pooling, or otherwise) or until a non-standard unit, eliminating such interests, has been approved by the Commission.

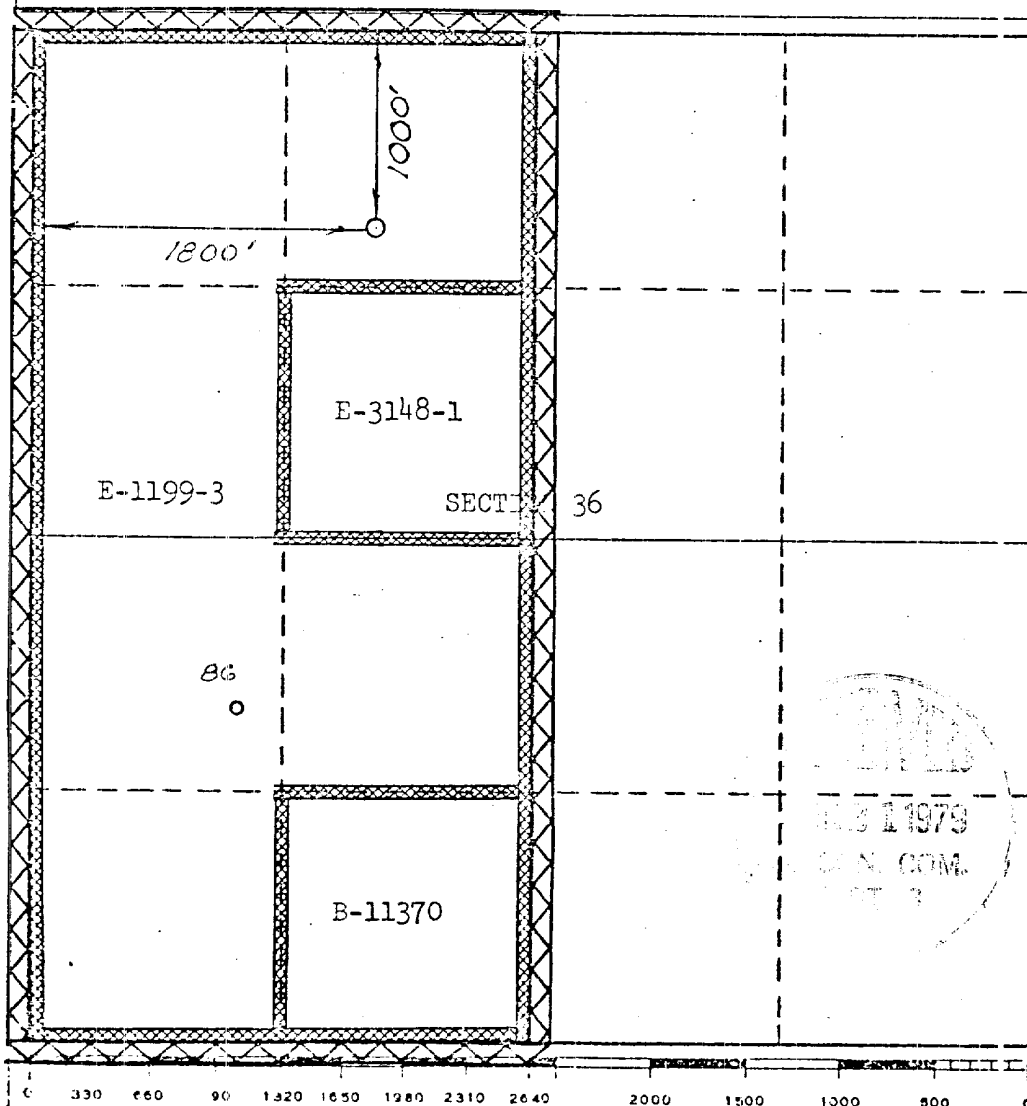

CERTIFICATION

I hereby certify that the information contained herein is true and complete to the best of my knowledge and belief.

N. P. Lucas

Name
Drilling Clerk

Position
El Paso Natural Gas Co.

Company
March 20, 1979

Date

I hereby certify that the well location shown on this plat was plotted from field notes of actual surveys made by me or under my supervision, and that the same is true and correct to the best of my knowledge and belief.

Date Surveyed
NOVEMBER 16, 1978

Registered Professional Engineer and/or Land Surveyor

Certificate No. 1760