

UNITED STATES
DEPARTMENT OF THE INTERIOR
GEOLOGICAL SURVEY

APPLICATION FOR PERMIT TO DRILL, DEEPEN, OR PLUG BACK

1a. TYPE OF WORK

DRILL ☒DEEPEN ☐PLUG BACK ☐

b. TYPE OF WELL

OIL
WELL ☐GAS
WELL ☒

OTHER

SINGLE
ZONE ☒MULTIPLE
ZONE ☐

2. NAME OF OPERATOR

Supron Energy Corporation

3. ADDRESS OF OPERATOR

P.O. Box 808, Farmington, New Mexico 87401

4. LOCATION OF WELL (Report location clearly and in accordance with any State requirements.)*

At surface

1190'/North and 790'/West

At proposed prod. zone

Same as above

14. DISTANCE IN MILES AND DIRECTION FROM NEAREST TOWN OR POST OFFICE*

20 Miles S.E. of Bloomfield, New Mexico

15. DISTANCE FROM PROPOSED*

LOCATION TO NEAREST
PROPERTY OR LEASE LINE, FT.
(Also to nearest drlg. unit line, if any)

790'

16. NO. OF ACRES IN LEASE

642.24

17. NO. OF ACRES ASSIGNED
TO THIS WELL

w/ 320.44

18. DISTANCE FROM PROPOSED LOCATION*
TO NEAREST WELL, DRILLING COMPLETED,
OR APPLIED FOR, ON THIS LEASE, FT.

209'

19. PROPOSED DEPTH

4600'

20. ROTARY OR CABLE TOOLS

Rotary

21. ELEVATIONS (Show whether DF, RT, GR, etc.)

6016 GR

22. APPROX. DATE WORK WILL START*

11/1/79

23.

PROPOSED CASING AND CEMENTING PROGRAM

SIZE OF HOLE	SIZE OF CASING	WEIGHT PER FOOT	SETTING DEPTH	QUANTITY OF CEMENT
9-7/8"	7-5/8"	20#	250	150 SX
6-3/4"	4-1/2"	9.50#	4600	800 SX

We propose to drill this well with mud through the Mesaverde and run 4-1/2" casing to T.D. of 4600'. It will then be perforated and sand water fractured. Tubing will be set at approx. 4300'.

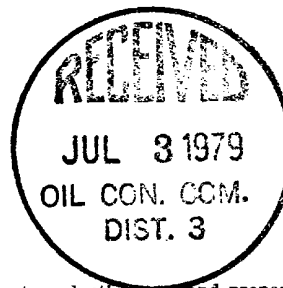
gas is dedicated

IN ABOVE SPACE DESCRIBE PROPOSED PROGRAM: If proposal is to deepen or plug back, give data on present productive zone and proposed new productive zone. If proposal is to drill or deepen directionally, give pertinent data on subsurface locations and measured and true vertical depths. Give blowout preventer program, if any.

24. SIGNED BY

Kenneth E. Roddy

TITLE Production Superintendent

DATE 6/29/79

SIGNED

Kenneth E. Roddy

(This space for Federal or State office use)

PERMIT NO.

APPROVAL DATE

APPROVED BY

TITLE

DATE

CONDITIONS OF APPROVAL, IF ANY:

*ok 3 inch**WYMACC*

NEW MEXICO OIL CONSERVATION COMMISSION
WELL LOCATION AND ACREAGE DEDICATION PLAT

Form C-102
Supersedes C-128
Effective 1-1-65

All distances must be from the outer boundaries of the Section.

Operator: SUPRON ENERGY CORPORATION			Lease NAVAJO INDIAN "B"		Well No. 3-A
Unit Letter D	Section 19	Township 27 NORTH	Range 8 WEST	County SAN JUAN	
Actual Footage Location of Well: 1190 feet from the NORTH line and 790 feet from the WEST line					
Ground Level Elev. 6016	Producing Formation MESAVERDE		Pool BLANCO	Dedicated Acreage: W 1/2 320.44/100 Acres	

1. Outline the acreage dedicated to the subject well by colored pencil or hachure marks on the plat below.
2. If more than one lease is dedicated to the well, outline each and identify the ownership thereof (both as to working interest and royalty).
3. If more than one lease of different ownership is dedicated to the well, have the interests of all owners been consolidated by communitization, unitization, force-pooling, etc?

☐ Yes ☐ No If answer is "yes," type of consolidation _____

If answer is "no," list the owners and tract descriptions which have actually been consolidated. (Use reverse side of this form if necessary.) _____

No allowable will be assigned to the well until all interests have been consolidated (by communitization, unitization, forced-pooling, or otherwise) or until a non-standard unit, eliminating such interests, has been approved by the Commission.

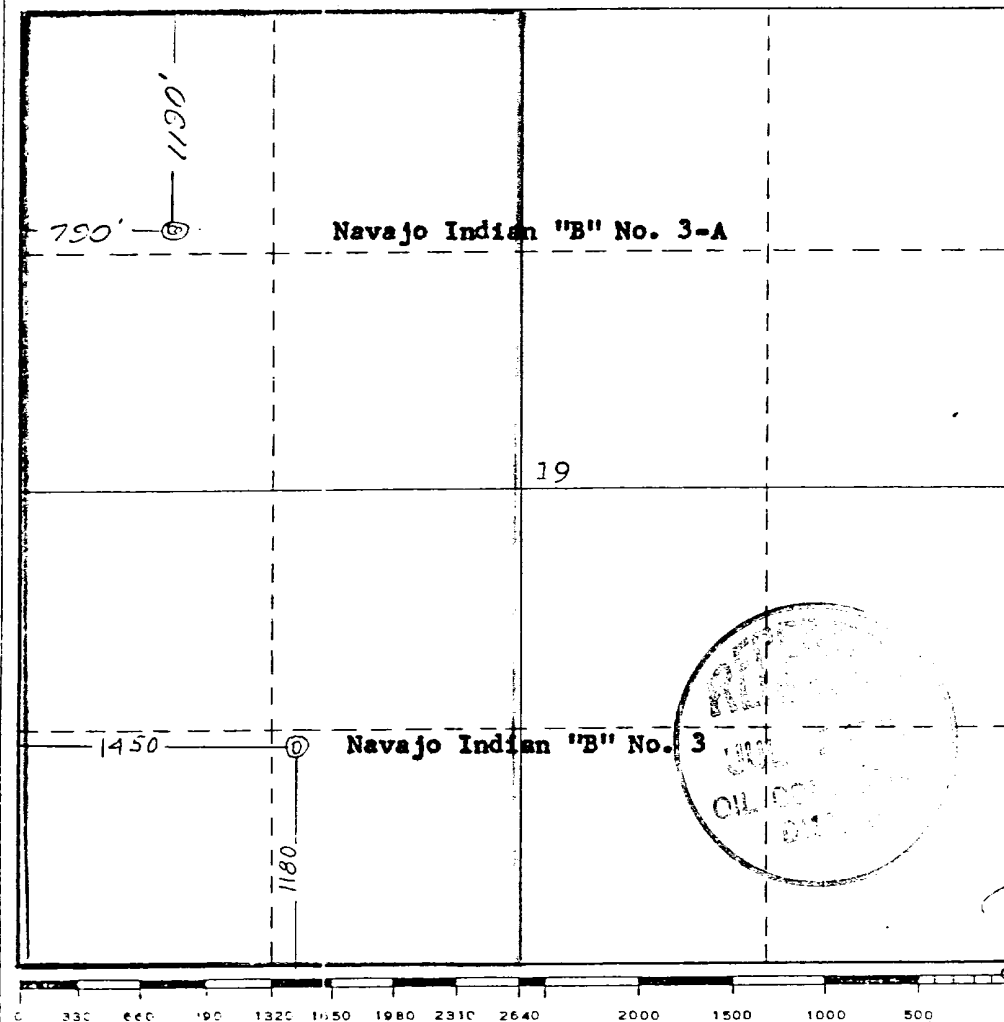

CERTIFICATION

I hereby certify that the information contained herein is true and complete to the best of my knowledge and belief.

Rudy D. Motto

Name

Rudy D. Motto

Position

Area Superintendent

Company

Supron Energy Corporation

Date

June 25, 1979

I hereby certify that the well location shown on this plat was plotted from field notes of a survey made by me or under my supervision, and that the same is true and correct to the best of my knowledge and belief.

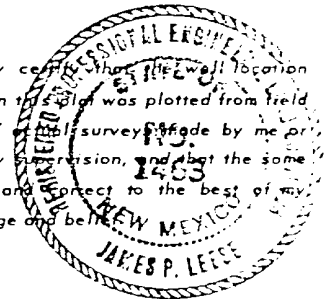

Date Surveyed

31 May 1979

Registered Professional Engineer
and/or Land Surveyor

James P. Leese
James P. Leese

Certificate No.

1463

NAVAJO INDIAN "B" NO. 3-A

1190'/N & 790'/W
Sec. 19, Twp. 27N, Rge. 8W

SUPPLEMENT TO FORM 9-331C

1. The Geologic name of the surface formation is "Wasatch".
 2. The estimated tops of important geologic markers are:
 - A. Base of Ojo Alamo - - - - - 1560
 - B. Top of Pictured Cliffs - - - - - 2030
 - C. Top of Cliff House - - - - - 3710
 - D. Top of Point Lookout - - - - - 4300
 3. The estimated depth at which anticipated water, oil, or other mineral bearing formations are expected to be encountered are:
 - A. Base of Ojo Alamo - - - - - 1560 - - Water
 - B. Top of Pictured Cliffs - - - - - 2030 - - Gas
 - C. Top of Cliff House - - - - - 3710 - - Gas and Water
 - D. Top of Point Lookout - - - - - 4300 - - Gas
 4. The casing program is shown on form 9-331C and all casing is new.
 5. The lessee's pressure - control equipment schematics are attached, along with minimum specifications, testing procedures, and frequencies.
 6. The type, estimated volumes, and characteristics of the circulating media are as follows:
 - A. 0 - 250 Ft. - Natural mud
 - B. 250 - 4600 Ft. - Permaloid non-dispersed mud containing 167 sx gel, 67 sx permaloid, and 10 sx C.M.C.
 7. The auxiliary equipment to be used will be floats at the bit and a sub on the floor with a full-opening valve to be stabbed into the drill pipe when the kelly is not in the string.
 8. This well is in an area which is partially developed; therefore we will not have a testing and coring program. The logging program will be as follows:
 - A. E.S. Induction
 - B. Gamma Ray Density
 - C. Gamma Ray Correlation
 - D. Cement Bond Log
 9. We do not expect to find any abnormal pressures, temperatures or hydrogen sulphide problems in this partially developed area.
 10. The anticipated starting date for this well is 11/1/79.
-

SUPRON ENERGY CORPORATION
Post Office Box 808
FARMINGTON, NEW MEXICO 87401

I hereby certify that I, or persons under my direct supervision, have inspected the proposed drillsite and access route; that I am familiar with the conditions which presently exist; that the statements made in this plan are, to the best of my knowledge, true and correct; and, that the work associated with the operations proposed herein will be performed by SUPRON ENERGY CORPORATION and its contractors subcontractors in conformity with this plan and the terms and conditions under which it is approved.

SUPRON ENERGY CORPORATION

A handwritten signature in black ink, reading "Rudy D. Motto". The signature is written in a cursive style with a large, stylized "R" and "M".

Rudy D. Motto
Area Superintendent
Phone: 325-3587

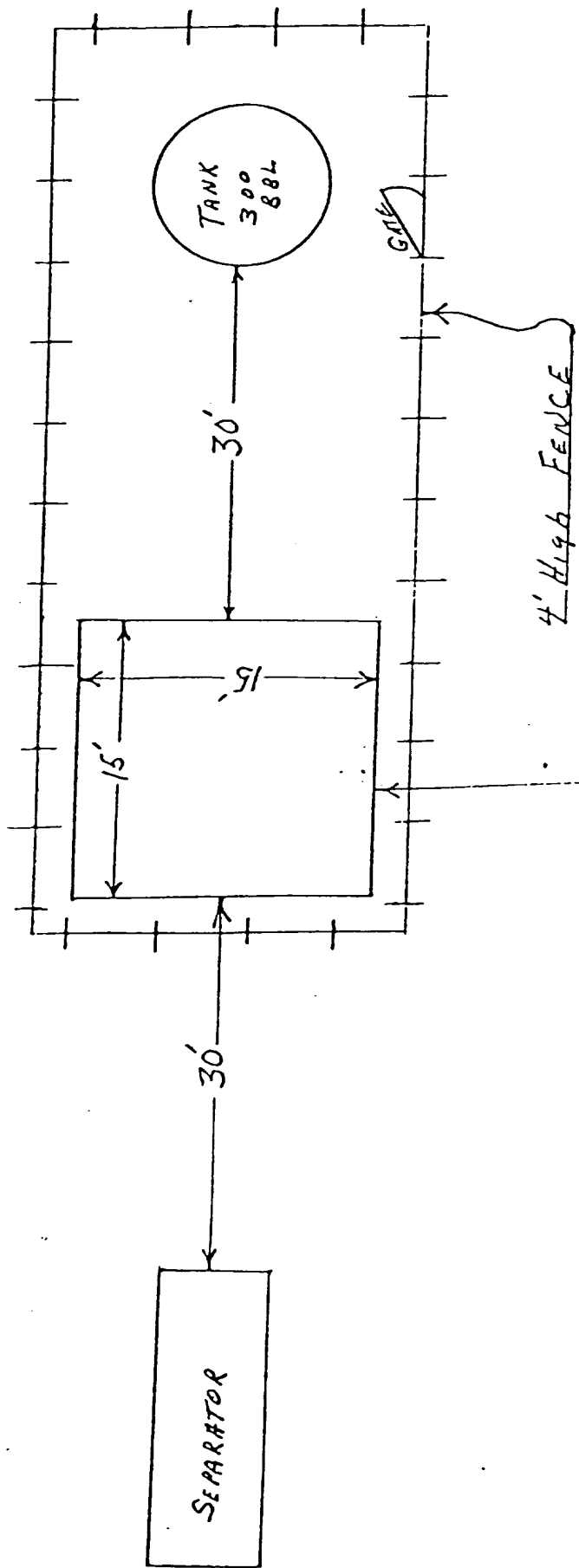

THIS PORTION, OR ANY PART THEREOF, MAY BE PLACED OUTSIDE OF SUB-STRUCTURE IF DESIRED. USE LONG RADIUS BENDS. PIPE USED FOR EXTENSION SHOULD BE SHOP MADE WITH NO SCREWED CONNECTIONS AND PRESSURE TESTED INITIALLY TO SAME TEST PRESSURE AS THE CHOKE MANIFOLD.

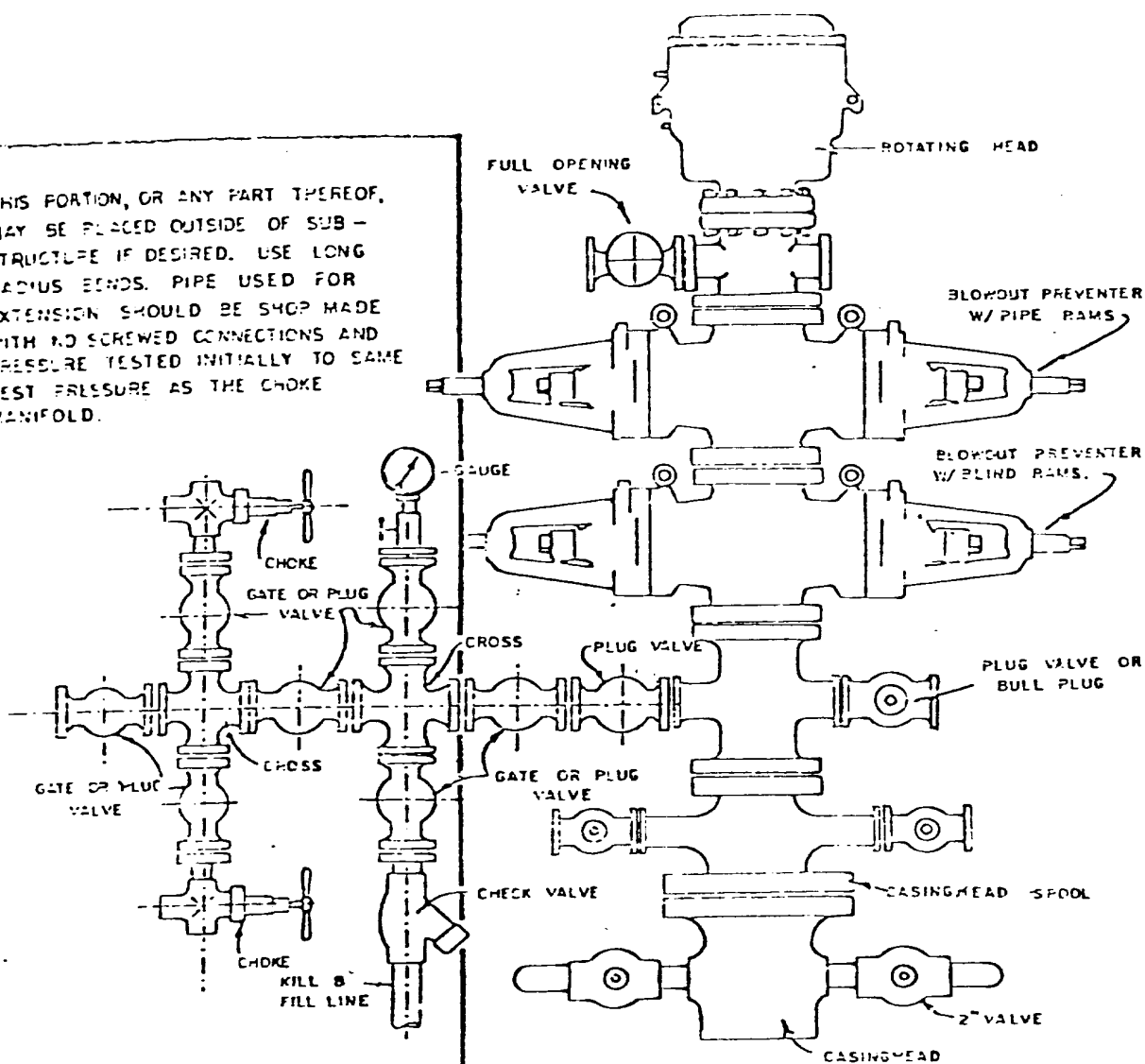

BLOWOUT PREVENTER HOOKUP

SUPRON ENERGY CORPORATION

LOCATION AND EQUIPMENT LAYOUT

NAVAJO INDIAN "B" NO. 3-A

1190 Feet from the North line and 790 feet from the West line of Section 19, Township 27 North, Range 8 West, N.M.P.M., San Juan County, New Mexico.

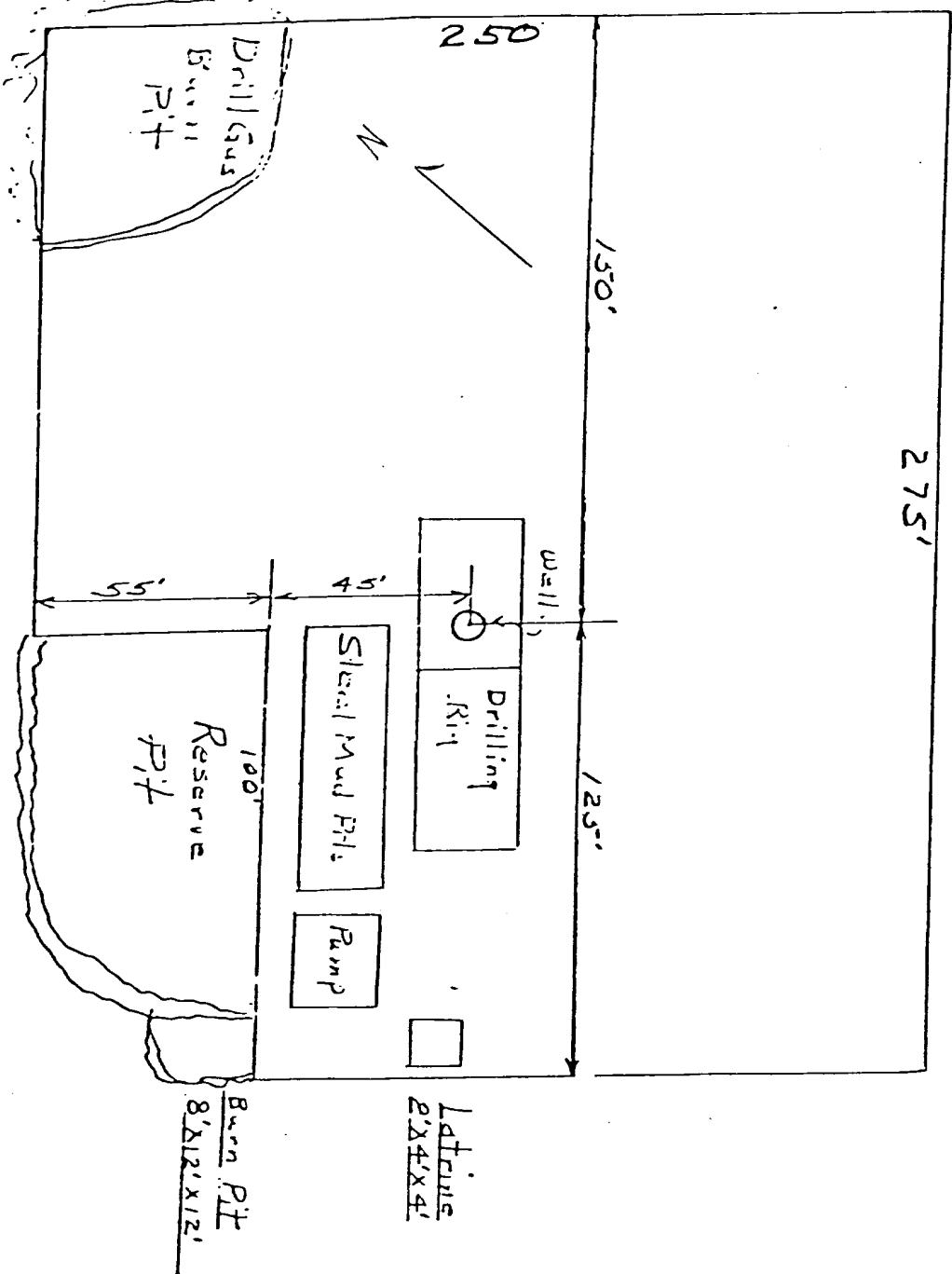

SUPRON ENERGY CORPORATION

POST OFFICE BOX 808

FARMINGTON, NEW MEXICO 87401

June 29, 1979

United States Geological Survey
P.O. Box 959
Farmington, New Mexico 87401

Attention: Mr. Phil McGrath

Dear Sir:

Supron Energy Corporation proposes to drill the Navajo Indian "B" No. 3-A well located 1190 feet from the North line and 790 feet from the West line of Section 19, Township 27 North, Range 8 West, N.M.P.M., San Juan County, New Mexico.

The following attachments are included with this application:

1. Map of existing roads.
 2. No access road needed.
 3. Location of existing wells.
 4. Lateral roads to well locations.
 5. Location of surface equipment if required.
 6. Drilling and completion water will be obtained from the San Juan River.
 7. Waste will be disposed of by being placed in the reserve pit and buried upon completion of the well.
 8. There will be no camp at or near the well site.
 9. There will be no air strip.
 10. A plat is attached showing the location of the rig, mud tanks, reserve pit, burn pit and etc.
 11. A letter of certification is attached. The operator representative, for compliance purposes, is Rudy D. Motto, Area Superintendent, P.O. Box 808, Farmington, New Mexico 87401. Phone (505) 325-3587.
 12. After the well is completed the location will be cleaned up and bladed. The reserve pit will be allowed to dry then it will be filled and restored to its natural state.
 13. The soil is sandy loam with the principal vegetation being sage brush.
-