

5-USGS (Farmington) 1-Lively 1-File

Form 9-331  
Dec. 1973

Form Approved.  
Budget Bureau No. 42-R1424

UNITED STATES  
DEPARTMENT OF THE INTERIOR  
GEOLOGICAL SURVEY

**SUNDRY NOTICES AND REPORTS ON WELLS**

(Do not use this form for proposals to drill or to deepen or plug back to a different reservoir. Use Form 9-331-C for such proposals.)

1. oil ☐ gas ☒ other

2. NAME OF OPERATOR

Lively Exploration Co.

3. ADDRESS OF OPERATOR

Box 208, Farmington, NM 87401

4. LOCATION OF WELL (REPORT LOCATION CLEARLY. See space 17 below.)

AT SURFACE: 1440' FNL - 240' FEL

AT TOP PROD. INTERVAL:

AT TOTAL DEPTH:

16. CHECK APPROPRIATE BOX TO INDICATE NATURE OF NOTICE, REPORT, OR OTHER DATA

REQUEST FOR APPROVAL TO:

TEST WATER SHUT-OFF ☐

FRACTURE TREAT ☐

SHOOT OR ACIDIZE ☐

REPAIR WELL ☐

PULL OR ALTER CASING ☐

MULTIPLE COMPLETE ☐

CHANGE ZONES ☐

ABANDON\* ☐

(other) amended location

SUBSEQUENT REPORT OF:

☐

☐

☐

☐

☐

☐

☐

☐

☐

☐

5. LEASE

NM 013861

6. IF INDIAN, ALLOTTEE OR TRIBE NAME

7. UNIT AGREEMENT NAME

8. FARM OR LEASE NAME

Lively

9. WELL NO.

#2E

10. FIELD OR WILDCAT NAME

Basin Dakota

11. SEC., T., R., M., OR BLK. AND SURVEY OR AREA

Sec 21 T28N R8W

12. COUNTY OR PARISH

San Juan

13. STATE

NM

14. API NO.

15. ELEVATIONS (SHOW DF, KDB, AND WD)

(NOTE: Report results of multiple completion or zone change on Form 9-330.)

17. DESCRIBE PROPOSED OR COMPLETED OPERATIONS (Clearly state all pertinent details, and give pertinent dates, including estimated date of starting any proposed work. If well is directionally drilled, give subsurface locations and measured and true vertical depths for all markers and zones pertinent to this work.)\*

Plan to change location site to 1440' FNL - 240' FEL per BLM instructions.

We are making an application for an unorthodox location.



Subsurface Safety Valve: Manu. and Type \_\_\_\_\_

Set @ \_\_\_\_\_ Ft.

18. I hereby certify that the foregoing is true and correct

SIGNED

Thomas A. Dugan

TITLE Agent

DATE 12-20-79

(This space for Federal or State office use)

APPROVED BY \_\_\_\_\_

TITLE \_\_\_\_\_

DATE \_\_\_\_\_

CONDITIONS OF APPROVAL, IF ANY:

NMOCC

\*See Instructions on Reverse Side

**NEW MEXICO OIL CONSERVATION COMMISSION  
WELL LOCATION AND ACREAGE DEDICATION PLAT**

Form C-102  
Supersedes C-128  
Effective 1-1-65

All distances must be from the outer boundaries of the Section.

Operator <b>Lively Exploration Company</b>			Lease <b>Lively</b>		Well No. <b>Lively 2E</b>
Unit Letter <b>H</b>	Section <b>21</b>	Township <b>28 North</b>	Range <b>8 West</b>	County <b>San Juan</b>	
Actual Footage Location of Well: <b>1440</b> feet from the <b>North</b> line and <b>240</b> feet from the <b>East</b> line					
Ground Level Elev. <b>5848</b>	Producing Formation <b>Dakota</b>		Pool <b>Basin</b>		Dedicated Acreage: <b>320</b> Acres

1. Outline the acreage dedicated to the subject well by colored pencil or hachure marks on the plat below.
2. If more than one lease is dedicated to the well, outline each and identify the ownership thereof (both as to working interest and royalty).
3. If more than one lease of different ownership is dedicated to the well, have the interests of all owners been consolidated by communitization, unitization, force-pooling, etc?

☐ Yes    ☐ No    If answer is "yes," type of consolidation \_\_\_\_\_

If answer is "no," list the owners and tract descriptions which have actually been consolidated. (Use reverse side of this form if necessary.) \_\_\_\_\_

No allowable will be assigned to the well until all interests have been consolidated (by communitization, unitization, forced-pooling, or otherwise) or until a non-standard unit, eliminating such interests, has been approved by the Commission.

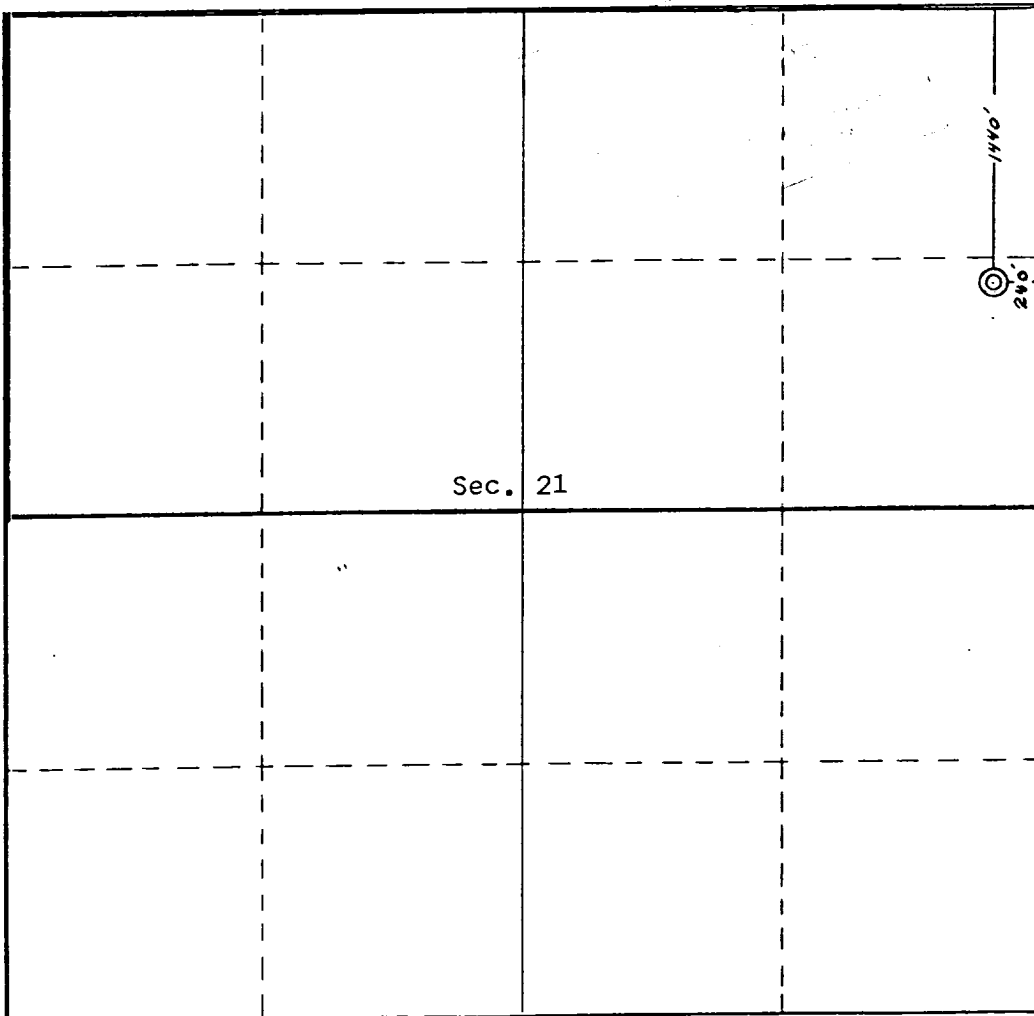

**CERTIFICATION**

*I hereby certify that the information contained herein is true and complete to the best of my knowledge and belief.*

*Thomas A. Dugan*

Name  
**Thomas A. Dugan**

Position  
**Agent**

Company  
**Lively Exploration Co.**

Date  
**12-20-79**

**EDGAR L. RISENHOVER**  
NEW MEXICO  
5979  
I hereby certify that the well location shown on this plat was plotted from field notes of actual surveys made by me or under my supervision, and that the same are true and correct to the best of my knowledge and belief.

Date Surveyed  
**November 14, 1979**

Registered Professional Engineer  
and/or Land Surveyor

*Edgar L. Risenhoover*

Certificate No. **5979**

**Edgar L. Risenhoover, L.S.**

