

UNITED STATES
DEPARTMENT OF THE INTERIOR
GEOLOGICAL SURVEY

30-045-24097

5. LEASE DESIGNATION AND SERIAL NO.
SF 079232

6. IF INDIAN, ALLOTTEE OR TRIBE NAME

7. UNIT AGREEMENT NAME

8. FARM OR LEASE NAME
Bolack "B"

9. WELL NO.
7

10. FIELD AND POOL, OR WILDCAT
Basin Dakota

11. SEC., T., R., M., OR BLK.
AND SURVEY OR AREA
Sec 29 T27N R8W

12. COUNTY OR PARISH
San Juan

13. STATE
N.M.

APPLICATION FOR PERMIT TO DRILL, DEEPEN, OR PLUG BACK

1a. TYPE OF WORK
DRILL ☒ DEEPEN ☐ PLUG BACK ☐

b. TYPE OF WELL
OIL WELL ☐ GAS WELL ☒ OTHER ☐ SINGLE ZONE ☐ MULTIPLE ZONE ☐

2. NAME OF OPERATOR
Tenneco Oil Company

3. ADDRESS OF OPERATOR
720 S. Colorado Blvd., Denver, CO 80222

4. LOCATION OF WELL (Report location clearly and in accordance with any State requirements.)
At surface 800 FSL 490FWL
At proposed prod. zone

14. DISTANCE IN MILES AND DIRECTION FROM NEAREST TOWN OR POST OFFICE*
14 miles South South East of Blanco, N.M.

15. DISTANCE FROM PROPOSED* LOCATION TO NEAREST PROPERTY OR LEASE LINE, FT. (Also to nearest drlg. unit line, if any)
16. NO. OF ACRES IN LEASE
2552.22

18. DISTANCE FROM PROPOSED LOCATION* TO NEAREST WELL, DRILLING, COMPLETED, OR APPLIED FOR, ON THIS LEASE, FT.
19. PROPOSED DEPTH
6950

17. NO. OF ACRES ASSIGNED TO THIS WELL
320.00
20. ROTARY OR CABLE TOOLS
Rotary

21. ELEVATIONS (Show whether DF, RT, GR, etc.)
6362 GR
22. APPROX. DATE WORK WILL START*
ASAP

23. PROPOSED CASING AND CEMENTING PROGRAM

SIZE OF HOLE	SIZE OF CASING	WEIGHT PER FOOT	SETTING DEPTH	QUANTITY OF CEMENT
10 3/4"	9 5/8" new	36#, K-55	250' ±	Circulate to surface
8 3/4"	7" new	23#, K-55	3,000' ±	Circulate to surface
6 1/2"	4 1/2" new	10.5#, 11.6#	6,950' ±	Circulate through liner hanger

See Attached

1. If non-productive plug & abandon per USGS/BLM requirements
2. No abnormal temperatures, pressures or other geologic hazards are expected

THE GAS IS DEDICATED

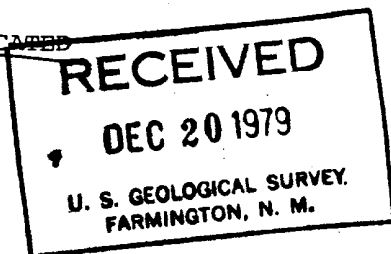

IN ABOVE SPACE DESCRIBE PROPOSED PROGRAM: If proposal is to deepen or plug back, give data on present productive zone and proposed new productive zone. If proposal is to drill or deepen directionally, give pertinent data on subsurface locations and measured and true vertical depths. Give blowout preventer program, if any.

24. SIGNED M. Lee Freeman TITLE Staff Production Analyst DATE December 18, 1979
(This space for Federal or State office use)

PERMIT NO. _____ APPROVAL DATE _____

APPROVED BY _____ TITLE _____ DATE _____
CONDITIONS OF APPROVAL, IF ANY:

ok End

*See Instructions On Reverse Side

INMOCC

All distances must be from the outer boundaries of the Section.

Operator TENNECO OIL COMPANY			Lease BOLACK "B"		Well No. 7
Unit Letter M	Section 29	Township 27N	Range 8W	County San Juan	
Actual Footage Location of Well: 800 feet from the South line and 490 feet from the West line					
Ground Level Elev. 6362	Producing Formation Dakota	Pool Basin Dakota	Dedicated Acreage: 320 Acres		

1. Outline the acreage dedicated to the subject well by colored pencil or hatchure marks on the plat below.
2. If more than one lease is dedicated to the well, outline each and identify the ownership thereof (both as to working interest and royalty).
3. If more than one lease of different ownership is dedicated to the well, have the interests of all owners been consolidated by communitization, unitization, force-pooling, etc?

☐ Yes ☐ No If answer is "yes," type of consolidation _____

If answer is "no," list the owners and tract descriptions which have actually been consolidated. (Use reverse side of this form if necessary.) _____

No allowable will be assigned to the well until all interests have been consolidated (by communitization, unitization, forced-pooling, or otherwise) or until a non-standard unit, eliminating such interests, has been approved by the Commission.

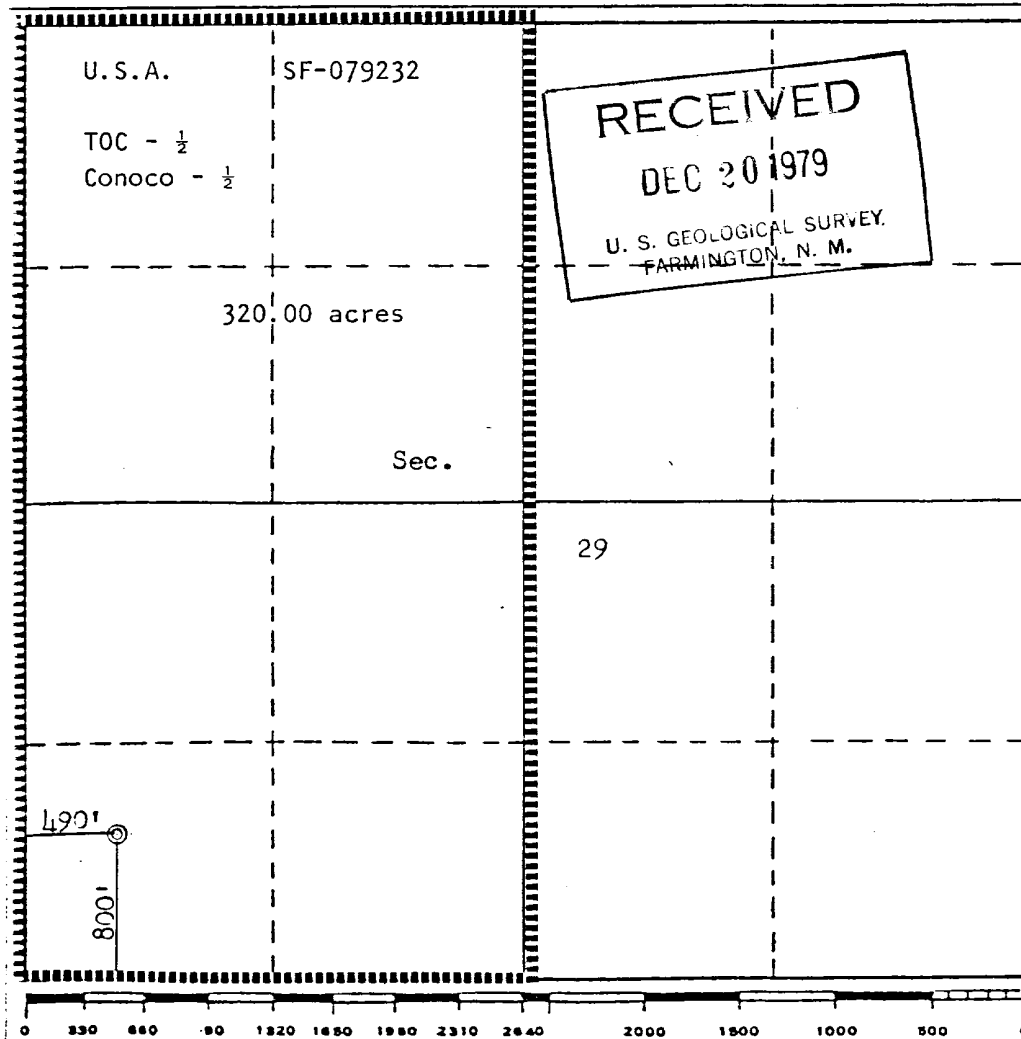

CERTIFICATION

I hereby certify that the information contained herein is true and complete to the best of my knowledge and belief.

M. L. Freeman
Name **M. L. Freeman**
Position **Staff Production Analyst**
Company **Tenneco Oil Company**
Date **December 18, 1979**

I hereby certify that the well location shown on this plat was plotted from field notes of actual surveys made by me or under my supervision, and that the same is true and correct to the best of my knowledge and belief.

Date Surveyed **October 3, 1979**
Registered Professional Engineer and/or Land Surveyor
Fred B. Kern Jr.
Certificate No. **3950**
FRED B. KERN JR.

TENNECO OIL COMPANY

PROGNOSIS TO DRILL AND COMPLETE

DIVISION: Rocky Mountain

DATE: August 6, 1979

LEASE: Bolack

WELL NO.: B-7

LOCATION: 800 FSL - 490 FWL
Section 29, T 27N, R 8W
San Juan County, New Mexico

FIELD: Basin Dakota

ESTIMATED ELEVATION: 6450'

ESTIMATED TOTAL DEPTH: 6950'

PROJECTED HORIZON: Dakota

DRILLING, CASING AND CEMENT PROGRAM:

- (1) MIRU Rotary tools.
- (2) Drill 10 3/4 surface hole to \pm 250'.
- (3) Run 9 5/8 36# K-55 ST&C casing. Set at 250'. Cement w/sufficient volume to circulate to surface.
- (4) Nipple up well head & blow out equipment. Test prior to drilling out to 600 psi 1/2 hour.
- (5) Reduce hole to 8 3/4". Drill to 3,000' with water and Benex.
- (6) Run 7" casing. Set at 3,000'. Cement with sufficient volume to circulate to surface.
- (7) Nipple up well head & rig to drill with air or air mist to total depth.
- (8) Run 4 1/2 liner w/ \pm 150' overlap inside of 7" casing to TD.
- (9) Cement with sufficient volume to circulate cement.
- (10) MORT.

ESTIMATED FORMATION TOPS:

SURFACE -- San Jose Formation

OJO Alamo	1667' (water)	Mancos	4997'
Pictured Cliffs	2427' (gas)	Gallup	5867' (oil/gas)
Cliff House	4037' (gas)	Greenhorn	6682'
Menefee	4065' (gas)	Dakota	6782'
Point Look Out	4690' (gas)		

DRILLING MUD PROGRAM:

0 - 250' Native solids. Use sufficient viscosity to clean hole and run surface casing.

250' - 3,000' Low solids. Use sufficient viscosity to clean hole and run intermediate casing.

3,000 - TD Gas or air/air mist.

CORING AND TESTING PROGRAM:

No cores or DST's are anticipated.

DEVIATION SURVEYS: 0 - 250' - 2° Max.
250' - 3,500' - 3° Max.

1. Survey surface hole at 100' intervals. Maximum allowable deviation at 3,500' - TD - 5° Max.
2. FROM SURFACE TO TOTAL DEPTH DEVIATION SURVEYS MUST BE TAKEN EVERY 500' OR EACH TRIP WHICHEVER IS FIRST. This may entail running the TOTCO on wireline. Record each survey on the AAODC Drilling Report Sheet. Maximum allowable change in deviation is 1° per 100'.

SAMPLES:

30' = 2,500' - 3,000'. Insure 300 into Lewis shale.

WELL SURVEYS:

Induction - Gamma Ray

Density - Gamma Ray - Caliper

BOP: 10" x 000 series Double Ram Preventor w/closing unit.

PREVENTORS MUST BE CHECKED FOR OPERATION EVERY 24 HOURS, AND THE CHECK MUST BE RECORDED ON THE AAODC DRILLING REPORT SHEET.

REPORTS

Drilling reports for the past 24 hours will include depth, footage, time distribution, activity breakdown, mud properties, bit record, bottom hole assembly, daily and cumulative mud costs, plus any other pertinent information; will be called into Tenneco Oil Company, Denver, Colorado between 7:30 A.M. and 8:00 A.M.

1. 303-758-7130 (office) - Don Barnes
303-758-7287 - Don Barnes private line - Monday-Friday (before 7:45 A.M.)
2. 303-936-0704 (home) - Don Barnes - weekends and holidays
3. 303-424-1269 (home) - John Owen - if Don Barnes not available

The yellow sheet of the IADC Report to be filled out completely, the original copy of the drilling time recorder, and copies of any invoices from this well signed and received for Tenneco Oil Company will be mailed daily to:

TENNECO OIL COMPANY
PENTHOUSE
720 SOUTH COLORADO BOULEVARD
DENVER, COLORADO 80222

ATTENTION: DRILLING DEPARTMENT

In case of an emergency, notify the following:

1. Mr. Don Barnes, Division Drilling Engineer - 303-936-0704.
2. Mr. John Owen, Project Drilling Engineer - 303-424-1269.
3. Mr. Mike Lacey, Division Production Manager - 303-979-0509.

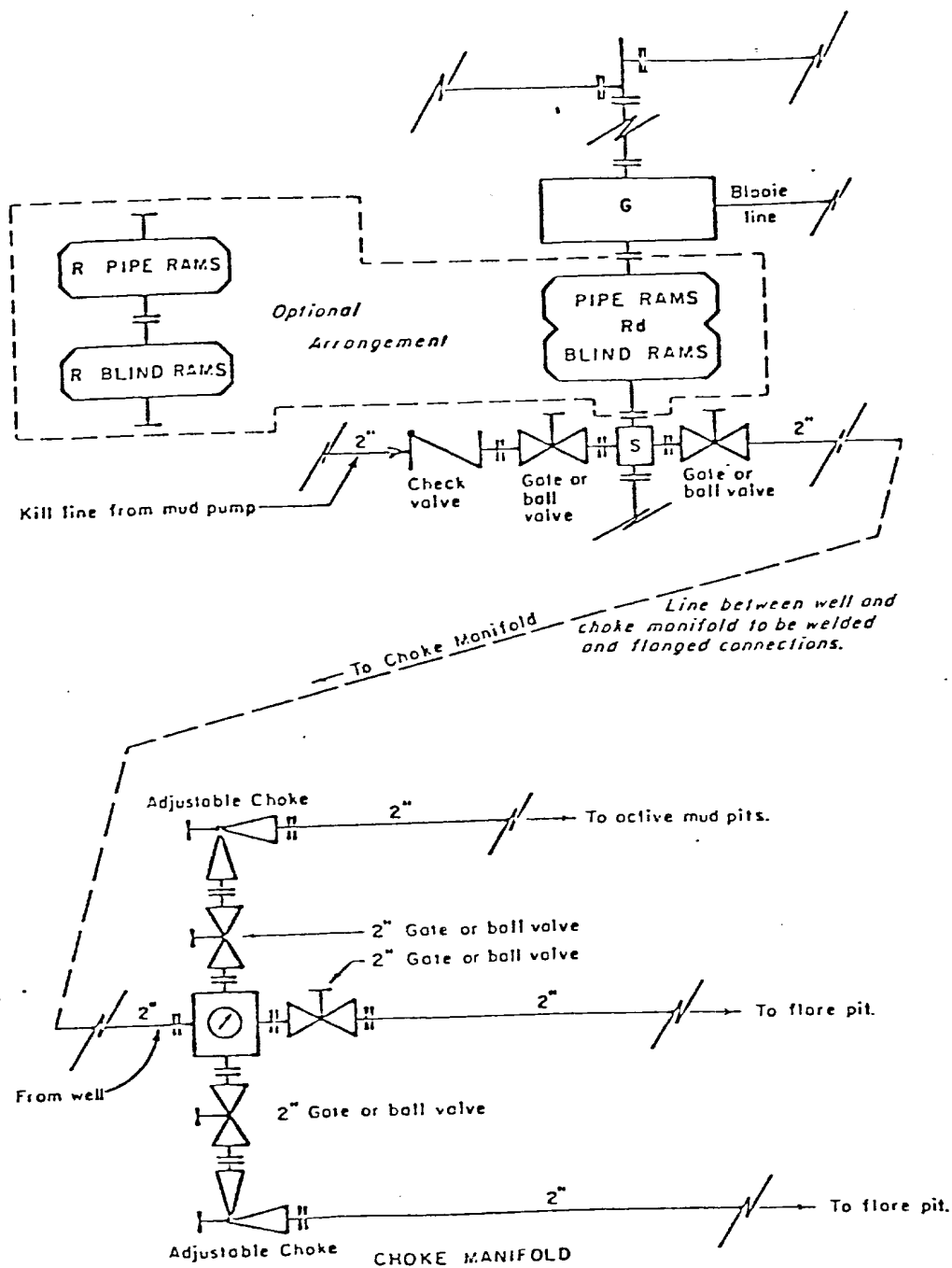

All equipment to be 3,000 psi working pressure except as noted.

- Rd Double ram type preventer with two sets of rams.
- R Single ram type preventer with one set of rams.
- S Drilling spool with side outlet connections for choke and kill lines.
- G Rotating head 150 psi working pressure minimum

ARRANGEMENT C

TENNECO OIL COMPANY
 ROCKY MOUNTAIN DIVISION
 REQUIRED MINIMUM
 BLOWOUT PREVENTER AND
 CHOKE MANIFOLD

J. MAGILL 10-26-78 EVI

1. Existing Road - Please refer to Map No. 1 which shows the existing roads. New roads which will be required have been marked on this map. All existing and new roads will be properly maintained during the duration of this project.
2. Planned Access Roads - Please refer to Map No. 1. The grade of the access roads will be consistent with that of the local terrain. The road surface will not exceed twenty feet (20') in width. Upon completion of the project, the access road will be adequately drained to control soil erosion. Drainage facilities may include ditches, water bars, culverts or any other measure deemed necessary by trained Company personnel to insure proper drainage. Gates and/or cattleguards will be installed if necessary.
3. Location of Existing Wells - Please refer to Map No. 2.
4. Location of Tank Batteries, Production Facilities, and Production Gathering and Service Lines - Please refer to Maps No. 1 and No. 2. Map No. 2 shows the existing roads and new proposed access roads. All known production facilities are shown on these two maps.
5. Location and Type of Water Supply - Water for the proposed project will be obtained from a private source.
6. Source of Construction Materials - No additional materials will be required to build either the access road or the proposed location.
7. Methods of Handling Waste Materials - All garbage and trash materials will be put into a burn pit shown on the attached Location Plat No. 1. When clean-up operations are begun on the proposed project, the burn pit with its refuse will be buried to a depth of at least three feet (3'). A latrine, the location of which is also shown on Plat No. 1. will be provided for human waste. If large amounts of liquids are left in the reserve pit after completion of the project, the pit will be fenced until the liquids have had adequate time to dry. The location clean-up will not take place until such time as the reserve pit can be properly covered over to prevent run-off from carrying any of these materials into the watershed. No earthen pit will be located on natural drainage; all earthen pits will be so constructed as to prevent leakage from occurring.

8. Ancillary Facilities - No camps or airstrips will be associated with this project.
9. Wellsite Layout - Please refer to the attached Plat No. 1.
10. Plans for Restoration of the Surface - After completion of the proposed project the location will be cleaned and leveled. The location will be left in such a condition that will enable reseedling operations to be carried out. Seed mixture as designated by the responsible government agency will be used. The reseedling operation will be performed during the time period set forth by the regulatory body. The location production equipment will be painted as designated by the responsible government agency.
11. Other Information - The proposed site is located on a mesa bench above Blanco Canyon. The planned access route will follow an existing ridge for approximately 350' to the site. The surface and minerals are both federally owned. The principal vegetation is sparse pinon and juniper.
12. Operator's Representative - See drilling prognosis.
13. Certification - I hereby certify that I, or persons under my direct supervision, have inspected the proposed drillsite and access route; that I am familiar with the conditions which presently exist; that the statements made in this plan are, to the best of my knowledge, true and correct; and that the work associated with the operations proposed herein will be performed by Tenneco Oil Company and its contractors and sub-contractors in conformity with this plan and the terms and conditions under which it is approved.

L. Freeman
Staff Production Analyst

LF/gh

TENNECO OIL COMPANY

CALCULATION SHEET

PANY

EXHIBIT

ECT DRILLING WELL SITE LAYOUT *Boilack "B" 7*

ATION *800FSL 490FWL SEC 29 T27N R8W*

DATE *12/17/79*

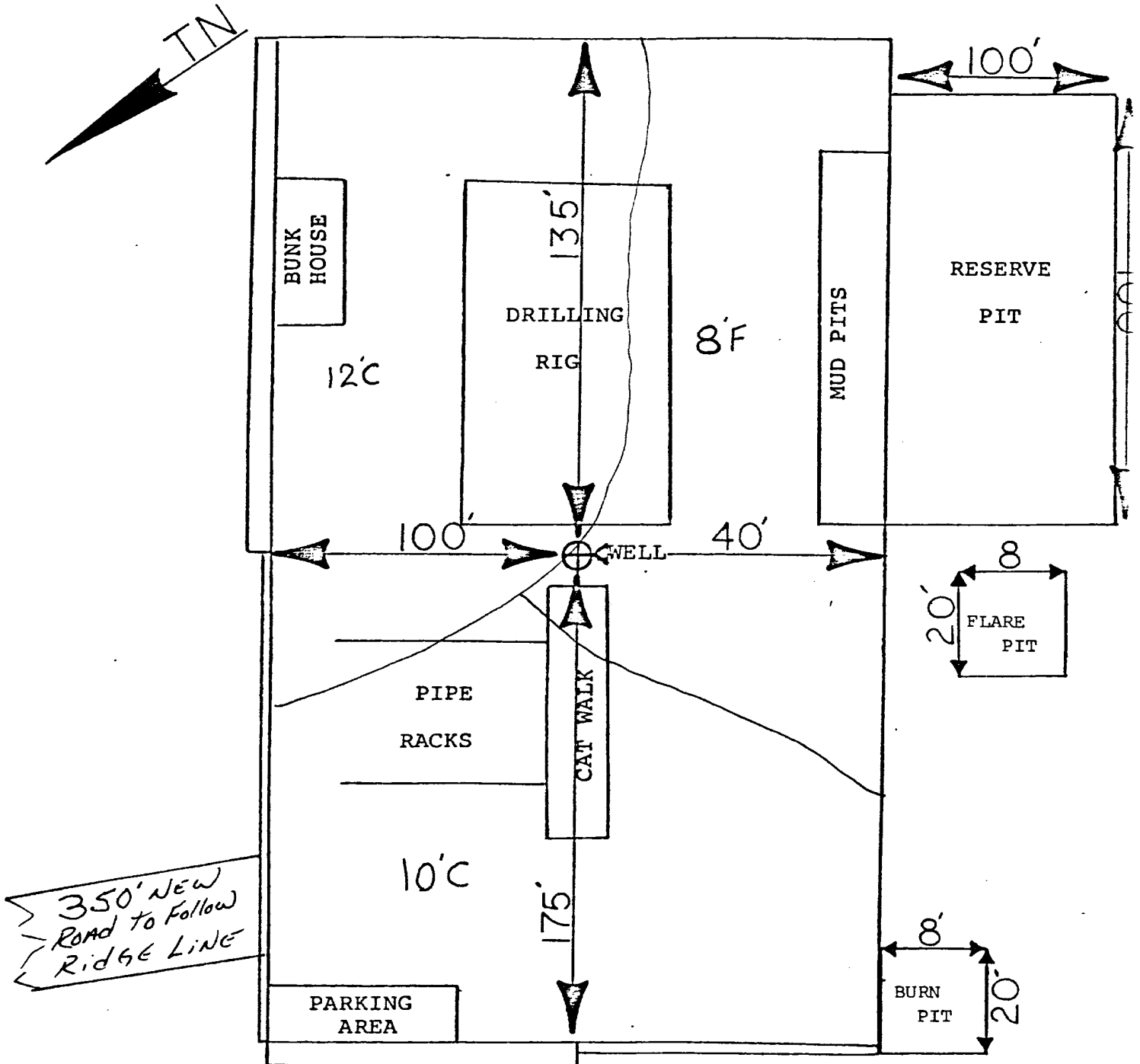

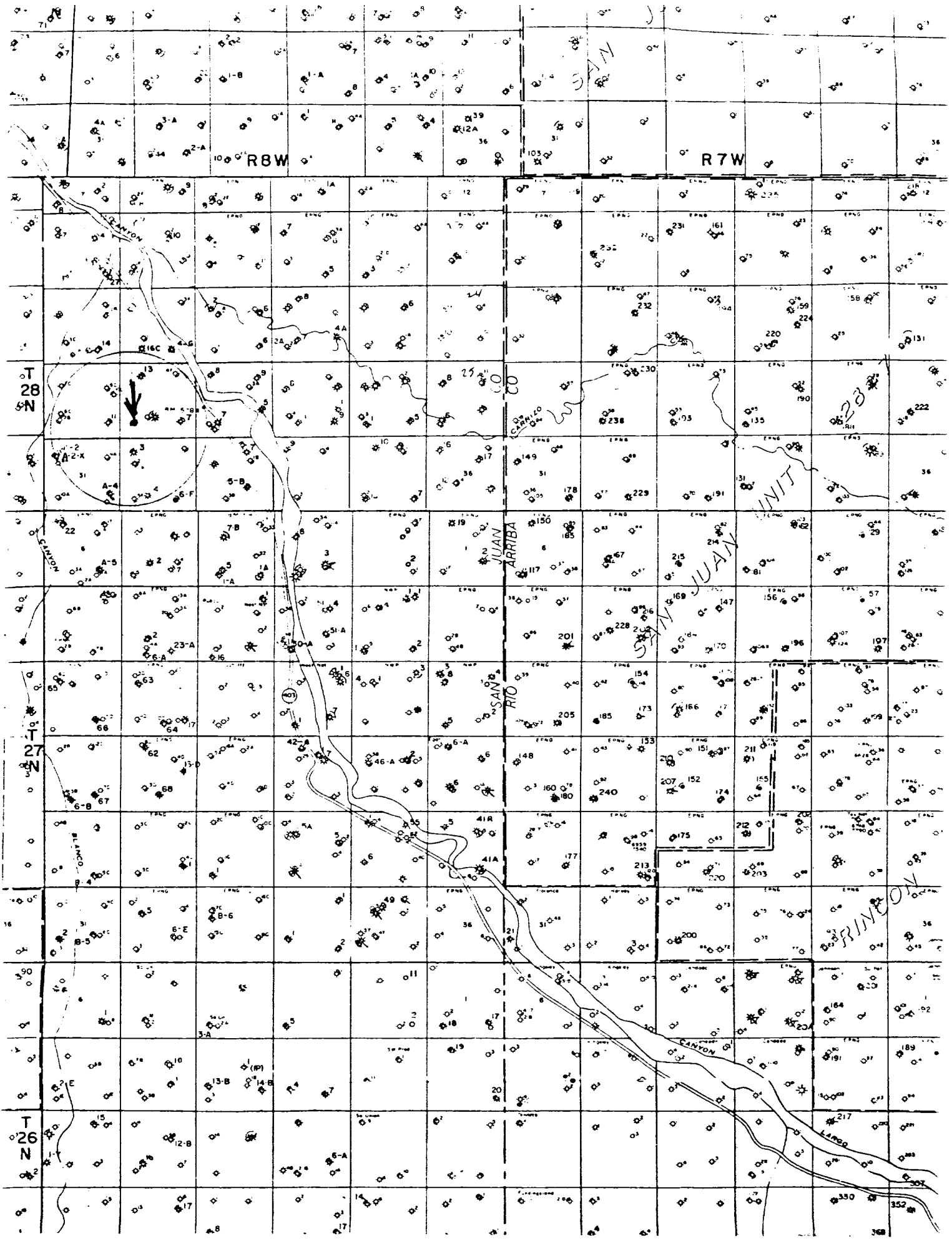

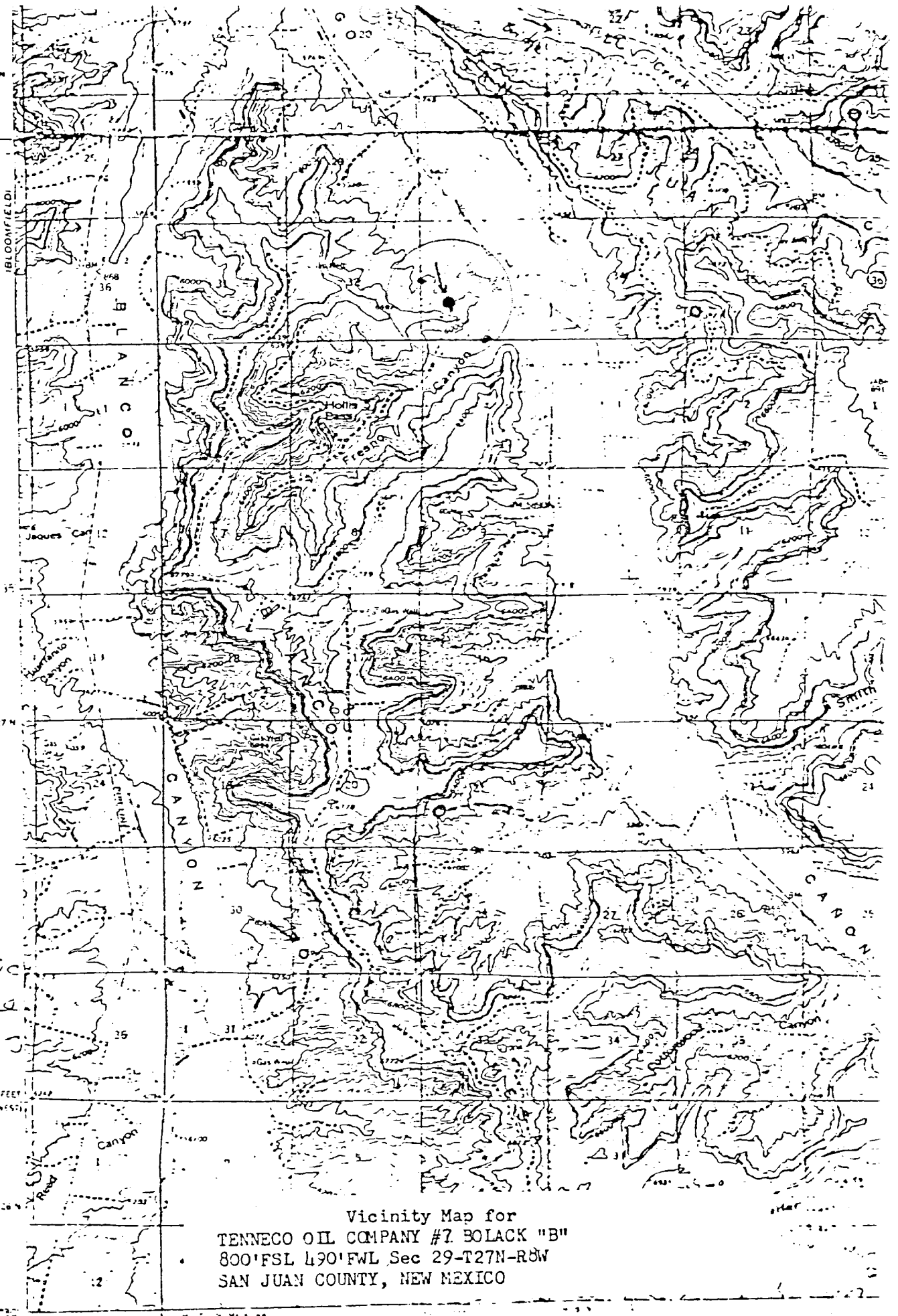

Vicinity Map for
TENNECO OIL COMPANY #7 BOLACK "B"
800' FSL 190' FWL Sec 29-T27N-R8W
SAN JUAN COUNTY, NEW MEXICO

Tenneco Oil
A Tenneco Company

Penthouse
720 South Colorado Blvd
Denver, Colorado 80222
(303) 758-7130



CERTIFIED MAIL
Return Receipt Requested

December 7, 1979

New Mexico Oil Conservation Division
P.O. Box 2088
Santa Fe, New Mexico 87501

Attention: Mr. Joe D. Ramey

New Mexico Oil Conservation Division
1000 Rio Brazos Road
Aztec, New Mexico 87401

Attention: Mr. A. R. Kendrick

Re: Application for Unorthodox Location
Tenneco Bolack "B" #7
Proposed Dakota Gas Well
San Juan County, New Mexico

Gentlemen:

Attached in duplicate (to each office) are a well location plat C-102 with a sketch of the surrounding topography and an ownership plat for the above captioned Dakota gas well.

The Bolack "B" #7 proposed site is 800' FSL, 490' FWL, Sec. 29 T27N-R8W, San Juan County, New Mexico. This places the well 490' from the boundary line of the proration unit. This was the only feasible site due to topographical conditions as sketched on the C-102.

A copy of this application is being submitted to all offset operators by certified mail with a request that they furnish your Santa Fe office with a waiver of objection.

Pursuant to authority of Rule 104-F, we respectfully request your approval of an exception to the standard well location requirements.

Very truly yours,

TENNECO OIL COMPANY

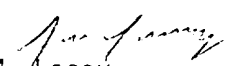

J. M. Lacey
Division Production

JML/el

Enclosures

W A I V E R

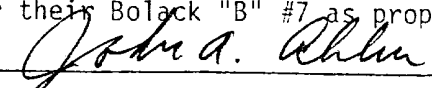
El Paso Exploration Co. hereby waives objection to Tenneco Oil Company's application for unorthodox location for their Bolack "B" #7 as proposed above.

By: 
Date: January 2, 1980



OIL CONSERVATION COMMISSION

Aztec DISTRICT

OIL CONSERVATION COMMISSION
BOX 2088
SANTA FE, NEW MEXICO

DATE December 21, 1979

RE: Proposed MC _____
Proposed DHC _____
Proposed NSL x _____
Proposed SWD _____
Proposed WFX _____
Proposed PMX _____

Gentlemen:

I have examined the application dated December 7, 1979
for the Sanner Oil Company, Belach B #7, M-29-27N-8W
Operator Lease and Well No. Unit, S-T-R

and my recommendations are as follows:

Approve

Yours very truly,

Frank S. Carey

Tenneco Oil

A Tenneco Company

Penthouse
720 South Colorado Blvd.
Denver, Colorado 80222
(303) 758-7130



CERTIFIED MAIL

Return Receipt Requested

December 7, 1979

New Mexico Oil Conservation Division
P.O. Box 2088
Santa Fe, New Mexico 87501

Attention: Mr. Joe D. Ramey

New Mexico Oil Conservation Division
1000 Rio Brazos Road
Aztec, New Mexico 87401

Attention: Mr. A. R. Kendrick

Re: Application for Unorthodox Location
Tenneco Bolack "B" #7
Proposed Dakota Gas Well
San Juan County, New Mexico

Gentlemen:

Attached in duplicate (to each office) are a well location plat C-102 with a sketch of the surrounding topography and an ownership plat for the above captioned Dakota gas well.

The Bolack "B" #7 proposed site is 800' FSL, 490' FWL, Sec. 29 T27N-R8W, San Juan County, New Mexico. This places the well 490' from the boundary line of the proration unit. This was the only feasible site due to topographical conditions as sketched on the C-102.

A copy of this application is being submitted to all offset operators by certified mail with a request that they furnish your Santa Fe office with a waiver of objection.

Pursuant to authority of Rule 104-F, we respectfully request your approval of an exception to the standard well location requirements.

Very truly yours,

TENNECO OIL COMPANY

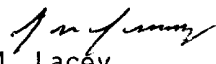
J. M. Lacey
Division Production Manager

JML/el

Enclosures

W A I V E R

_____ hereby waives objection to Tenneco Oil Company's application for unorthodox location for their Bolack "B" #7 as proposed above.

By: _____

Date: _____

All distances must be from the corner boundaries of the Section

Lessor TENNECO OIL COMPANY			Lease BOLACK "B"		Well No. 7
Section Letter M	Section 29	Township 27N	Range 8W	County San Juan	
Well Location of Well: 800 feet from the South line and 490 feet from the West line					
Well Level Elev. 6362	Producing Formation		Pool		Dedicated Acreage: Acres

1. Outline the acreage dedicated to the subject well by colored pencil or hachure marks on the plat below.
2. If more than one lease is dedicated to the well, outline each and identify the ownership thereof (both as to working interest and royalty).
3. If more than one lease of different ownership is dedicated to the well, have the interests of all owners been consolidated by communitization, unitization, force-pooling, etc?

☐ Yes ☐ No If answer is "yes," type of consolidation _____

If answer is "no," list the owners and tract descriptions which have actually been consolidated. (Use reverse side of this form if necessary.) _____

No allowable will be assigned to the well until all interests have been consolidated (by communitization, unitization, forced-pooling, or otherwise) or until a non-standard unit, eliminating such interests, has been approved by the Commission.

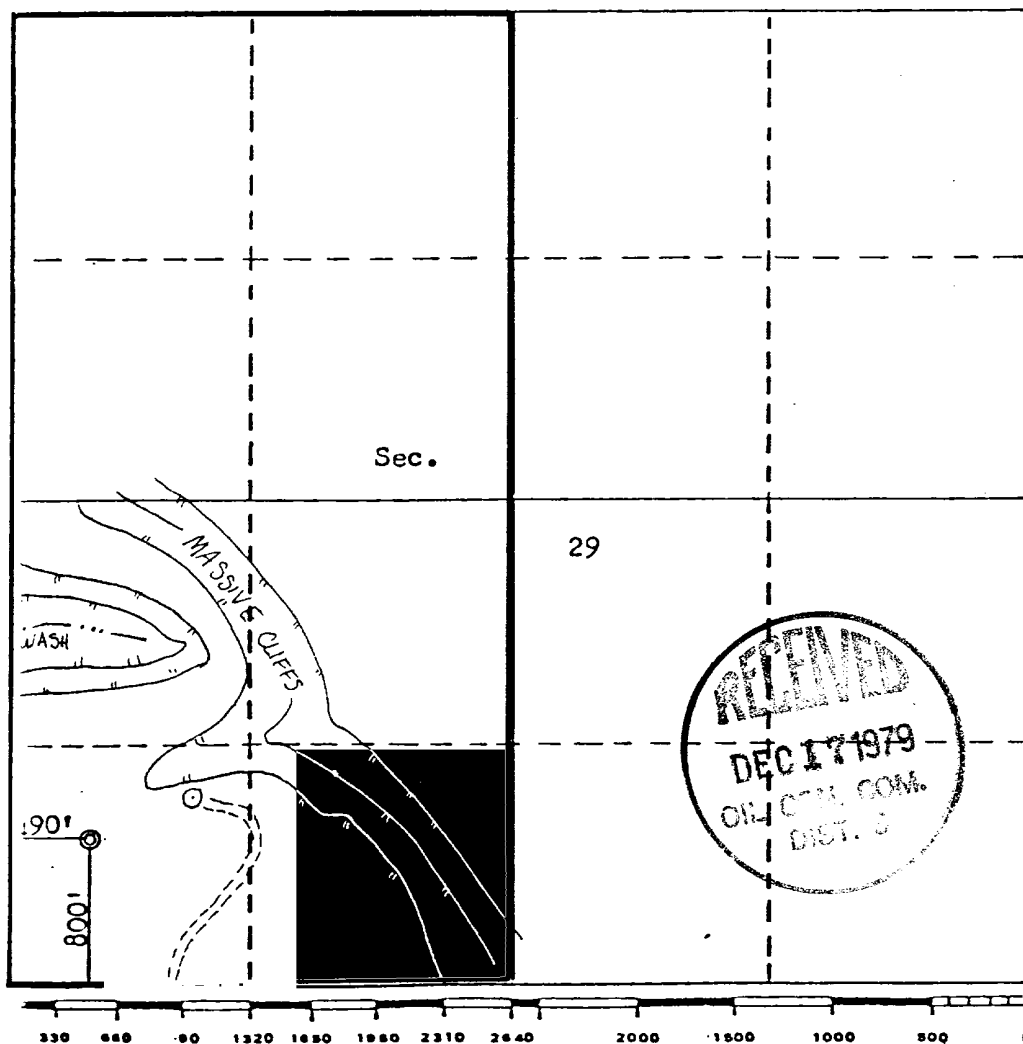

CERTIFICATION

I hereby certify that the information contained herein is true and complete to the best of my knowledge and belief.

Name

Position

Company

Date

I hereby certify that the well location shown on this plat was plotted from field notes of actual surveys made by me or under my supervision, and that the same is true and correct to the best of my knowledge and belief.

Date Surveyed

October 3, 1979

Registered Professional Engineer and/or Land Surveyor

Fred B. Kerr Jr.
Fred B. Kerr Jr.

Certificate No. 3950
NEW MEXICO
FRED B. KERR, JR.

R 8 W

T 27 N

CANYON

BLANCO

LPNG

403

0.63 a. ms.
rator Tenneco
ing area

BLANCO
AREA

Ownership Plat
Non-Standard Location Request
Tenneco Bolack "B" #7
800 FSL 490 FWL Sec. 29-27N-8W
San Juan Co., New Mexico
Completed Dakota Well



45'

R 8 W 40'

MAILING LIST
APPLICATION FOR UNORTHODOX LOCATIONS
TENNECO - BOLACK "B" #7
SAN JUAN COUNTY, NEW MEXICO

El Paso Natural Gas Company
P.O. Box 1492
El Paso, Texas 79978

Attention: R. H. Nordhausen

New Mexico Oil Conservation Division
P.O. Box 2088
Santa Fe, New Mexico 87501

Attention: Joe D. Ramey

New Mexico Oil Conservation Division
1000 Rio Brazos Road
Aztec, New Mexico 87401

Attention: A. R. Kendrick
