

UNITED STATES  
DEPARTMENT OF THE INTERIOR  
GEOLOGICAL SURVEY

APPLICATION FOR PERMIT TO DRILL, DEEPEN, OR PLUG BACK

1a. TYPE OF WORK DRILL <input checked="" type="checkbox"/> DEEPEN <input type="checkbox"/> PLUG BACK <input type="checkbox"/>			5. LEASE DESIGNATION AND SERIAL NO. NW 33044	
b. TYPE OF WELL OIL WELL <input type="checkbox"/> GAS WELL <input checked="" type="checkbox"/> OTHER <input type="checkbox"/> SINGLE ZONE <input type="checkbox"/> MULTIPLE ZONE <input type="checkbox"/>			6. IF INDIAN, ALLOTTEE OR TRIBE NAME	
2. NAME OF OPERATOR Dugan Production Corp.			7. UNIT AGREEMENT NAME	
3. ADDRESS OF OPERATOR Box 208, Farmington, NM 87401			8. FARM OR LEASE NAME Baby Doe	
4. LOCATION OF WELL (Report location clearly and in accordance with any State requirements.)* At surface 990' FSL - 1550' FEL At proposed prod. zone			9. WELL NO. 2	
14. DISTANCE IN MILES AND DIRECTION FROM NEAREST TOWN OR POST OFFICE* 13 miles south of Farmington, NM			10. FIELD AND POOL, OR WILDCAT WAW Fruitland PC	
15. DISTANCE FROM PROPOSED* LOCATION TO NEAREST PROPERTY OR LEASE LINE, FT. (Also to nearest drlg. unit line, if any) 990'		16. NO. OF ACRES IN LEASE 320	17. NO. OF ACRES ASSIGNED TO THIS WELL 160	
18. DISTANCE FROM PROPOSED LOCATION* TO NEAREST WELL, DRILLING, COMPLETED, OR APPLIED FOR, ON THIS LEASE, FT. 2080'		19. PROPOSED DEPTH 1400'	20. ROTARY OR CABLE TOOLS Rotary	
21. ELEVATIONS (Show whether DF, RT, GR, etc.) 6113' GL			22. APPROX. DATE WORK WILL START* April 9, 1980	

23. PROPOSED CASING AND CEMENTING PROGRAM

SIZE OF HOLE	SIZE OF CASING	WEIGHT PER FOOT	SETTING DEPTH	QUANTITY OF CEMENT
8-3/4"	7"	20#	90'	35 sx
4-3/4"	2-7/8"	6.4#	1400'	75 sx

Plan to drill 4-3/4" hole to test Pictured Cliffs Fm. Plan to run IES log to TD. If productive, plan to set 2-7/8" tbq for csg, cement, selectively perforate, frac, clean out after frac, run 1-1/4" tbq and complete well.

Plan to use 3000 psi BOP per attached schematic diagram. Will use master valve and stripper head while completing well.

NMERB: Gas not dedicated.

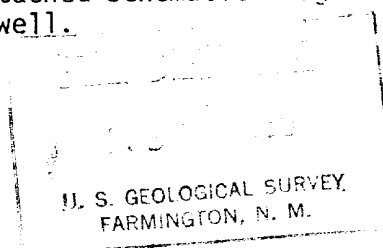

IN ABOVE SPACE DESCRIBE PROPOSED PROGRAM: If proposal is to deepen or plug back, give data on present productive zone and proposed new productive zone. If proposal is to drill or deepen directionally, give pertinent data on subsurface locations and measured and true vertical depths. Give blowout preventer program, if any

24. Thomas A. Dugan SIGNED Thomas A. Dugan TITLE Petroleum Engineer DATE 2-14-80  
(This space for Federal or State office use)

PERMIT NO. \_\_\_\_\_ APPROVAL DATE \_\_\_\_\_  
APPROVED BY \_\_\_\_\_ TITLE \_\_\_\_\_  
CONDITIONS OF APPROVAL, IF ANY:

*ok Smith*

\*See Instructions On Reverse Side

NMOCC

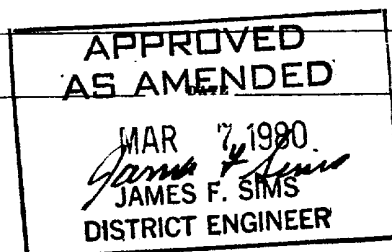

NEW MEXICO OIL CONSERVATION COMMISSION  
WELL LOCATION AND ACREAGE DEDICATION PLAT

Supersedes C-128  
Effective 1-1-65

All distances must be from the outer boundaries of the Section.

Operator Dugan Production Corporation			Lease Baby Doe		Well No. #2
Unit Letter 0	Section 29	Township 27 North.	Range 13 West	County San Juan	
Actual Footage Location of Well: 990 feet from the South line and 1550 feet from the East line					
Ground Level Elev. 6113	Producing Formation Fruitland PC	Pool WAW	Dedicated Acreage: 160 Acres		

1. Outline the acreage dedicated to the subject well by colored pencil or hachure marks on the plat below.
2. If more than one lease is dedicated to the well, outline each and identify the ownership thereof (both as to working interest and royalty).
3. If more than one lease of different ownership is dedicated to the well, have the interests of all owners been consolidated by communitization, unitization, force-pooling, etc?

☐ Yes ☐ No If answer is "yes," type of consolidation \_\_\_\_\_

If answer is "no," list the owners and tract descriptions which have actually been consolidated. (Use reverse side of this form if necessary.) \_\_\_\_\_

No allowable will be assigned to the well until all interests have been consolidated (by communitization, unitization, forced-pooling, or otherwise) or until a non-standard unit, eliminating such interests, has been approved by the Commission.

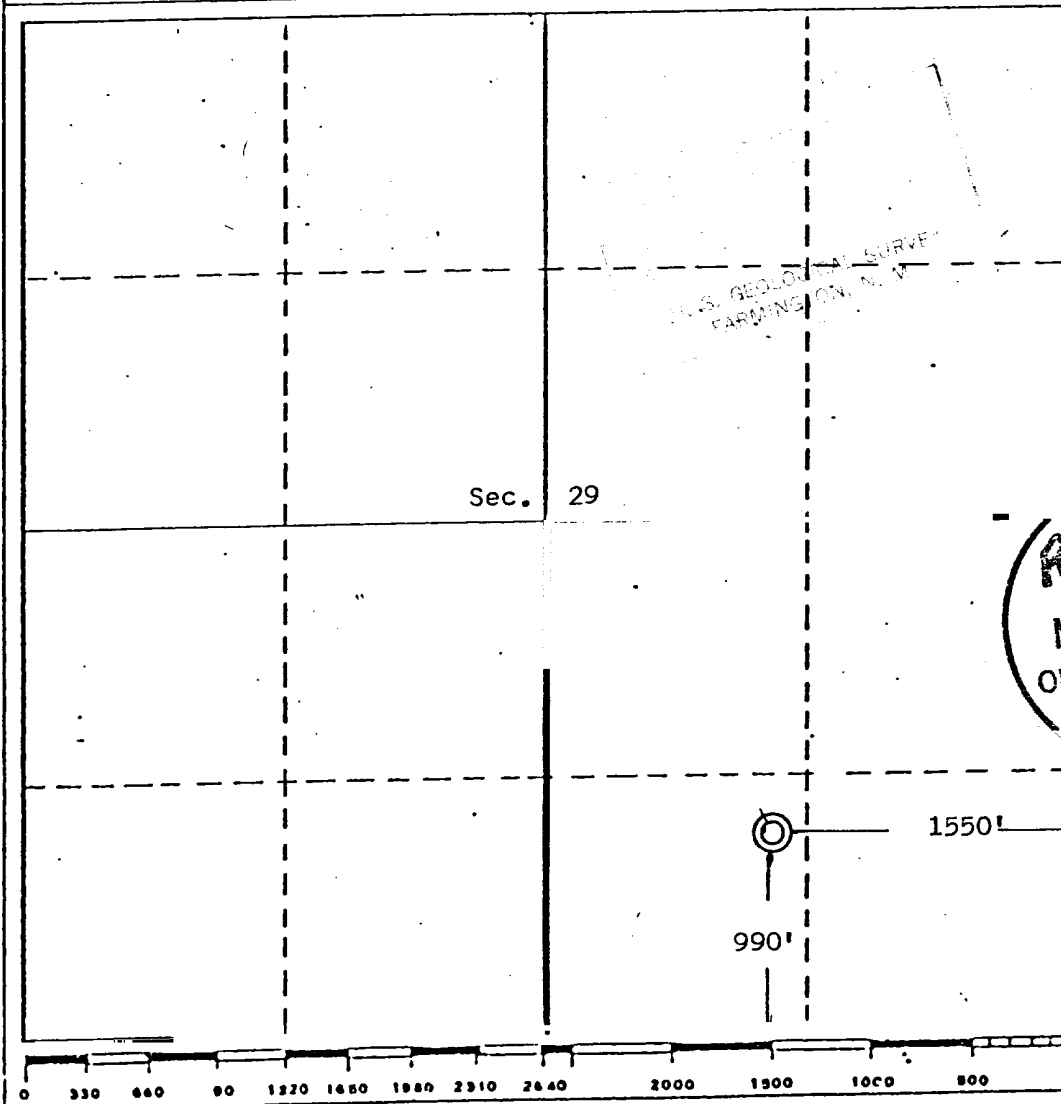

CERTIFICATION

I hereby certify that the information contained herein is true and complete to the best of my knowledge and belief.

*Thomas A. Dugan*  
Name Thomas A. Dugan

Position Petroleum Engineer

Company Dugan Production Corp.

Date 2-14-80

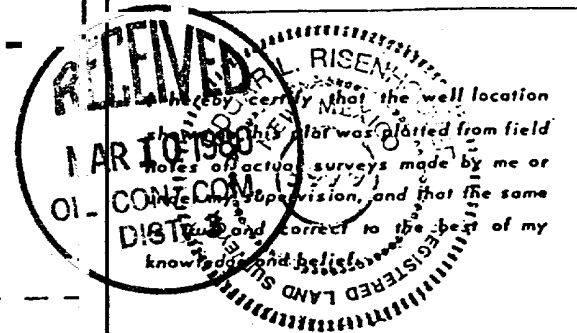

Date Surveyed February 12, 1980

Registered Professional Engineer and/or Land Surveyor

*Edgar L. Risenhoover*  
Certificate No. 5979

Edgar L. Risenhoover, L.S.