

District I
P O. Box 1980, Hobbs, NM

District II
P O. Drawer DD, Artesia, NM 88221

District III
1000 Rio Brazos Rd, Aztec, NM 87410

State of New Mexico
Energy, Minerals and Natural Resources Department

OIL CONSERVATION DIVISION

2040 South Pacheco Street
Santa Fe, New Mexico 87505

SUBMIT COPY TO
APPROPRIATE
DISTRICT OFFICE
AND 1 COPY TO
SANTA FE OFFICE

RECEIVED
NOV 12 1998

FEB 08 1999

Senny S. Foust
DEPUTY OIL & GAS INSPECTOR

Approved PIT REMEDIATION AND CLOSURE REPORT

OIL CON. DIV.
DIST. 3

Operator: PNM Gas Services (Dreyfus) Telephone: 324-3764

Address: 603 W. Elm Street Farmington, NM 87401

Facility or Well Name: Federal 32-41

Location: Unit A Sec 32 T 27 N R 11 W County San Juan

Pit Type: Separator ☒ Dehydrator ☐ Other ☐

Land Type: BLM ☐ State ☐ Fee ☐ Other Navajo

Pit Location: Pit dimensions: length 18 width 18 depth 3

(Attach diagram) Reference: wellhead ☒ other ☐

Footage from reference: 59'

Direction from reference: 85 Degrees ☒ East North ☒
of ☐ West South ☐

Depth to Ground Water:	Less than 50 feet	(20 points)	
	50 feet to 99 feet	(10 points)	
	Greater than 100 feet	(0 points)	<u>0</u>

(Vertical distance from contaminants to seasonal high water elevation of ground water)

Wellhead Protection Area:	Yes	(20 points)	
	No	(0 points)	<u>0</u>

(Less than 200 feet from a private domestic water source, or, less than 1,000 feet from all other water sources)

Distance to Surface Water:	Less than 200 feet	(20 points)	
	200 feet to 1,000 feet	(10 points)	
	Greater than 1,000 feet	(0 points)	<u>0</u>

(Horizontal distance to perennial lakes, ponds, rivers, streams, creeks, irrigation canals and ditches)

RANKING SCORE (TOTAL POINTS): 0

Date Remediation Started: 6/9/98 Date Completed: 6/9/98Remediation Method: Excavation X Approx. Cubic Yard 274

(Check all appropriate sections)

Landfarmed X Amount Landfarmed (cubic yds) 194Other 80 yds. of clean overburden.Remediation Location: Onsite X Offsite _____
(i.e., landfarmed onsite, name and location of offsite facility)RECEIVED
NOV 12 1998

Backfill Material Location: _____

General Description of Remedial Action:

OIL CON. DIV.
DIST. 3Excavated contaminated soil to pit size of 37' X 25' X 8' and landfarmed soil onsite within a bermed area at a depth of 6" to 12". Soil was aerated by plowing until soil met regulatory levels.Ground Water Encountered: No ☒ Yes ☐ Depth _____Final Pit Closure
Sampling:Sample Location Bottom of excavation.

(if multiple samples, attach sample result and diagram of sample locations and depths.)

Sample depth 8'Sample date 6/9/98 Sample time 2:35:00 PM

Sample Results

Benzene (ppm) < 0.2500Total BTEX (ppm) 14.5000

Field headspace (ppm) _____

TPH (ppm) 52.00 Method 8015AVertical Extent (ft) _____ Risk Analysis form attached Yes ☐ No ☒Ground Water Sample: Yes ☐ No ☒ (If yes, see attached Groundwater Site Summary Report)

I HEREBY CERTIFY THAT THE INFORMATION ABOVE IS TRUE AND COMPLETE TO THE BEST OF MY KNOWLEDGE AND MY BELIEF

DATE October 29, 1998PRINTED NAME Maureen Gannon
AND TITLE Project ManagerSIGNATURE Maureen Gannon

Federal #32-41
Dreyfus
Lease # SF-078896
(G)-32-27N-11W
San Juan County

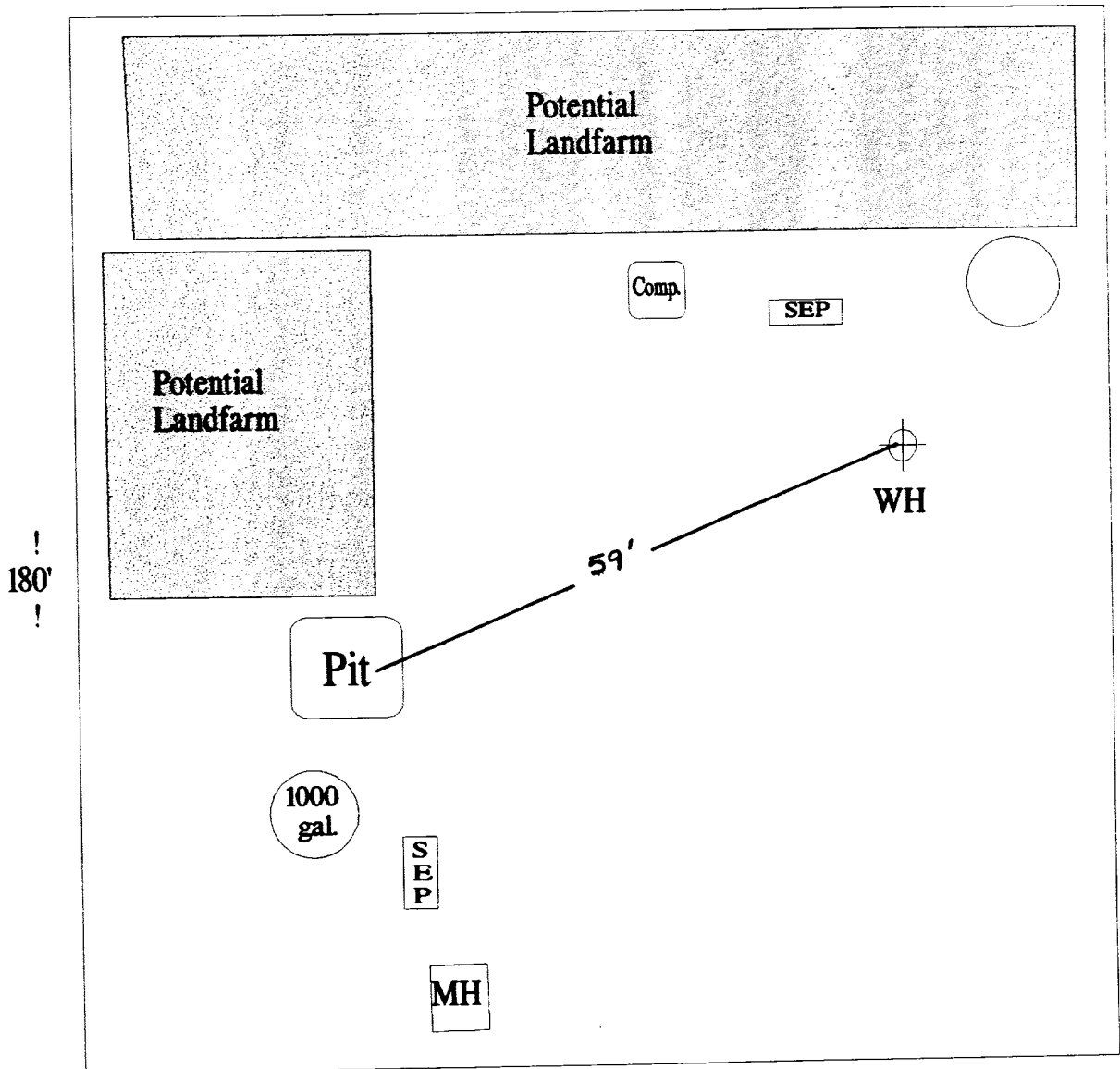

Federal #32-41
Louis Oreyfus
Sec. 32, 27N, 11W, G

7-1-98

Landfarm:

194 yds.

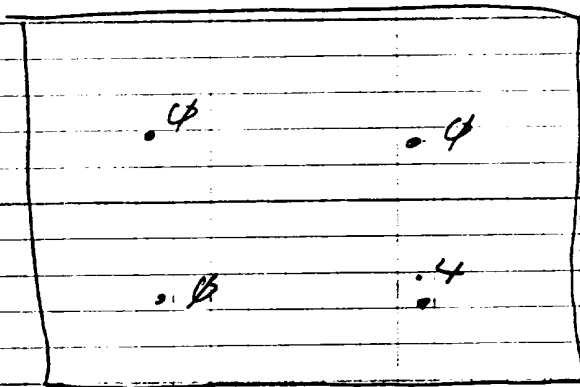
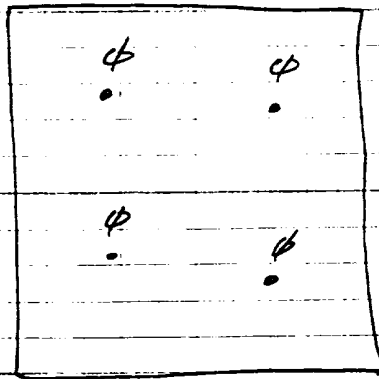

9807010930
2"-12"

Soil vapor head space = 1.6 ppm

OFF: (505) 325-5667



LAB: (505) 325-1556

On Site Technologies, LTD.

Date: 16-Jun-98

CLIENT: PNM - Public Service Company of NM

Project: Federal 32-41

Lab Order: 9806027

CASE NARRATIVE

Samples were analyzed using the methods outlined in the following references:

Test Methods for Evaluating Solid Waste, Physical/Chemical Methods, SW846, 3rd Edition

All method blanks, laboratory spikes, and/or matrix spikes met quality assurance objectives.

OFF: (505) 325-5667



LAB: (505) 325-1556

ANALYTICAL REPORT

Date: 16-Jun-98

Client:	PNM - Public Service Company of NM	Client Sample Info:	Federal 32-41
Work Order:	9806027	Client Sample ID:	9806091435; Bottom
Lab ID:	9806027-01A	Matrix:	SOIL
Project:	Federal 32-41	Collection Date:	6/9/98 2:35:00 PM
		COC Record:	5229

Parameter	Result	PQL	Qual	Units	DF	Date Analyzed
DIESEL RANGE ORGANICS		SW8015				Analyst: HR
T/R Hydrocarbons: C10-C28	52	25		mg/Kg	1	6/15/98
BTEX		SW8020A				Analyst: DC
Benzene	ND	250		µg/Kg	250	6/13/98
Toluene	1500	500		µg/Kg	250	6/13/98
Ethylbenzene	1800	250		µg/Kg	250	6/13/98
m,p-Xylene	9100	500		µg/Kg	250	6/13/98
o-Xylene	2100	250		µg/Kg	250	6/13/98

14500
14.500 ppm

Qualifiers:

PQL - Practical Quantitation Limit

S - Spike Recovery outside accepted recovery limits

ND - Not Detected at Practical Quantitation Limit

R - RPD outside accepted recovery limits

J - Analyte detected below Practical Quantitation Limit

E - Value above quantitation range

B - Analyte detected in the associated Method Blank

Surr: - Surrogate

1 of 1

P.O. BOX 2606 • FARMINGTON, NM 87499

OFF: (505) 325-5667



LAB: (505) 325-1556

ANALYTICAL REPORT

Date: 16-Jun-98

Client:	PNM - Public Service Company of NM	Client Sample Info:	Federal 32-41
Work Order:	9806027	Client Sample ID:	9806091445; Wall Composite
Lab ID:	9806027-02A	Matrix:	SOIL
Project:	Federal 32-41	Collection Date:	6/9/98 2:45:00 PM
		COC Record:	5229

Parameter	Result	PQL	Qual	Units	DF	Date Analyzed
DIESEL RANGE ORGANICS		SW8015				Analyst: HR
T/R Hydrocarbons: C10-C28	27	25		mg/Kg	1	6/15/98
BTEX		SW8020A				Analyst: DC
Benzene	ND	2		µg/Kg	2	6/13/98
Toluene	ND	4		µg/Kg	2	6/13/98
Ethylbenzene	110	2		µg/Kg	2	6/13/98
m,p-Xylene	600	4		µg/Kg	2	6/13/98
o-Xylene	260	2		µg/Kg	2	6/13/98

Qualifiers:
PQL - Practical Quantitation Limit
ND - Not Detected at Practical Quantitation Limit
J - Analyte detected below Practical Quantitation Limit
B - Analyte detected in the associated Method Blank

S - Spike Recovery outside accepted recovery limits
R - RPD outside accepted recovery limits
E - Value above quantitation range
Surr: - Surrogate

1 of 1

P.O. BOX 2606 • FARMINGTON, NM 87499

TECHNICAL SERVICES DIVISION • 6/16/98

OFF: (505) 325-5667



LAB: (505) 325-1556

On Site Technologies, LTD.

Date: 07-Jul-98

CLIENT: PNM - Public Service Company of NM
Project: Landfarms
Lab Order: 9807001

CASE NARRATIVE

Samples were analyzed using the methods outlined in the following references:

Test Methods for Evaluating Solid Waste, Physical/Chemical Methods, SW846, 3rd Edition

All method blanks, laboratory spikes, and/or matrix spikes met quality assurance objectives.

OFF: (505) 325-5667



LAB: (505) 325-1556

ANALYTICAL REPORT

Date: 07-Jul-98

Client:	PNM - Public Service Company of NM	Client Sample Info:	Federal 33-41
Work Order:	9807001	Client Sample ID:	9807010930: 6pt. Comp. 2-12in.
Lab ID:	9807001-06A	Matrix:	SOIL
Project:	Landfarms	Collection Date:	7/1/98 9:30:00 AM
		COC Record:	7308

Parameter	Result	PQL	Qual	Units	DF	Date Analyzed
DIESEL RANGE ORGANICS		SW8015				Analyst: DC
T/R Hydrocarbons: C10-C28	ND	25		mg/Kg	1	7/7/98

Qualifiers:

PQL - Practical Quantitation Limit

ND - Not Detected at Practical Quantitation Limit

J - Analyte detected below Practical Quantitation Limit

B - Analyte detected in the associated Method Blank

S - Spike Recovery outside accepted recovery limits

R - RPD outside accepted recovery limits

E - Value above quantitation range

Surr: - Surrogate

1 of 1

P.O. BOX 2606 • FARMINGTON, NM 87499