

(Do not use this form for proposals to drill or to deepen or plug back to a different reservoir. Use Form 9-331-C for such proposals.)

- NMOCC**

All distances must be from the outer boundaries of the Section.

Operator <b>AMOCO PRODUCTION COMPANY</b>			Lease <b>MARTIN GAS COM "C"</b>		Well No. <b>1-E</b>
Unit Letter <b>0</b>	Section <b>11</b>	Township <b>27N</b>	Range <b>10W</b>	County <b>San Juan</b>	
Actual Footage Location of Well: <b>860</b> feet from the <b>South</b> line and <b>1845</b> feet from the <b>East</b> line					
Ground Level Elev. <b>6043</b>	Producing Formation <b>Dakota/Chacra</b>		Pool <b>Basin Dakota/ Chacra</b>	Dedicated Acreage: <b>320 /160 Acres</b>	

1. Outline the acreage dedicated to the subject well by colored pencil or hachure marks on the plat below.
2. If more than one lease is dedicated to the well, outline each and identify the ownership thereof (both as to working interest and royalty).
3. If more than one lease of different ownership is dedicated to the well, have the interests of all owners been consolidated by communitization, unitization, force-pooling, etc?

☒ Yes ☐ No If answer is "yes," type of consolidation Communitization & Operating Agreements

If answer is "no," list the owners and tract descriptions which have actually been consolidated. (Use reverse side of this form if necessary.)

No allowable will be assigned to the well until all interests have been consolidated (by communitization, unitization, forced-pooling, or otherwise) or until a non-standard unit, eliminating such interests, has been approved by the Commission.

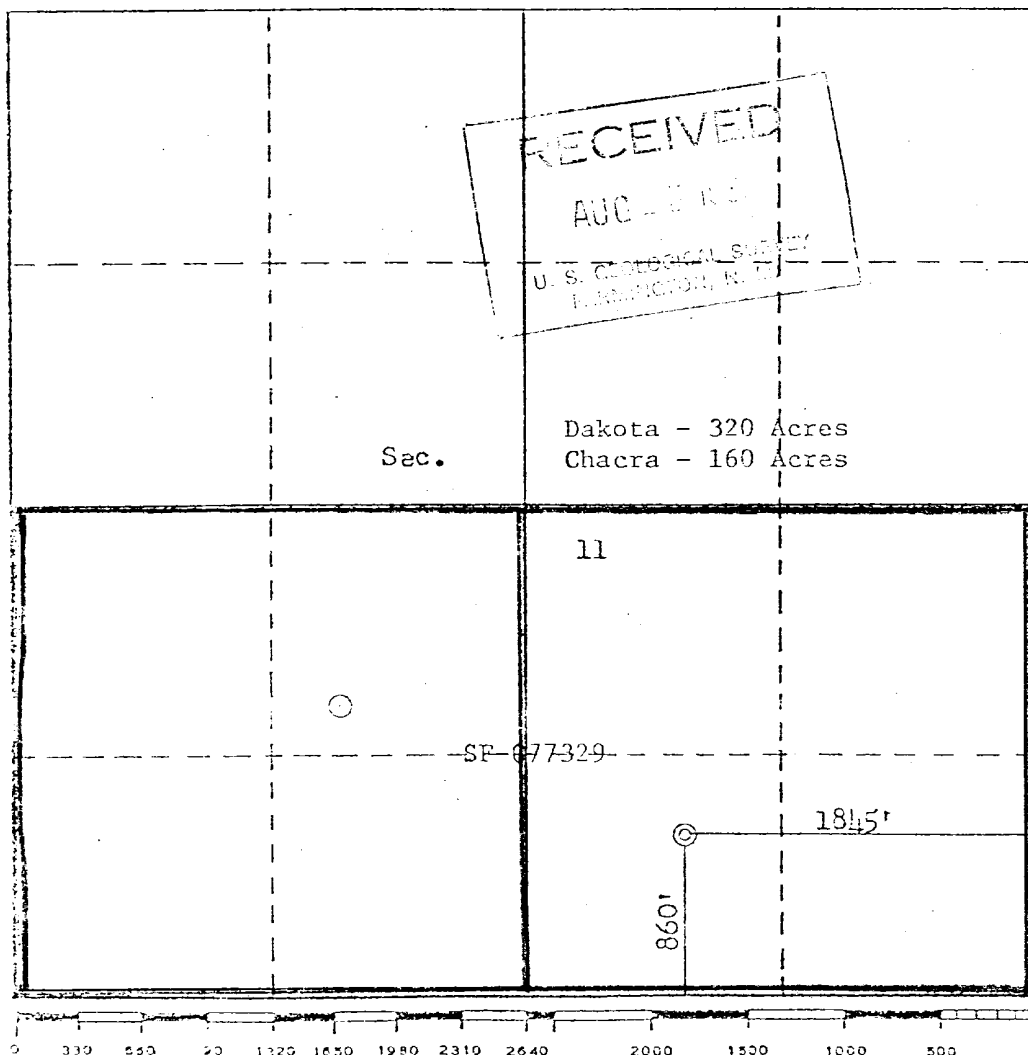

**RECEIVED**  
CERTIFICATION  
**AUG 20 1980**  
OIL CON. COM.

I hereby certify that the information contained herein is true and complete to the best of my knowledge and belief.

*B. E. Fackrell*

Name  
**B. E. FACKRELL**

Position  
**DISTRICT ENGINEER**

Company  
**AMOCO PRODUCTION COMPANY**

Date  
**APRIL 18, 1980**

I hereby certify that the well location shown on this plat was plotted from field notes of actual surveys made by me or under my supervision, and that the same is true and correct to the best of my knowledge and belief.

Date Surveyed  
**April 14, 1980**

Registered Professional Engineer and/or Land Surveyor  
*Fred B. Kerr Jr.*  
**Fred B. Kerr Jr.**

Certificate No.  
**3950**