

UNITED STATES
 DEPARTMENT OF THE INTERIOR
 GEOLOGICAL SURVEY

30-045-24495

APPLICATION FOR PERMIT TO DRILL, DEEPEN, OR PLUG BACK

1a. TYPE OF WORK
 DRILL ☒ DEEPEN ☐ PLUG BACK ☐

b. TYPE OF WELL
 OIL WELL ☐ GAS WELL ☒ OTHER ☐
 SINGLE ZONE ☐ MULTIPLE ZONE ☐

2. NAME OF OPERATOR
 Dugan Production Corp.

3. ADDRESS OF OPERATOR
 Box 208, Farmington, NM 87401

4. LOCATION OF WELL (Report location clearly and in accordance with any State requirements.)
 At surface 790' FSL - 1750' FWL
 N At proposed prod. zone

14. DISTANCE IN MILES AND DIRECTION FROM NEAREST TOWN OR POST OFFICE*
 6-1/2 miles south of Farmington, NM

15. DISTANCE FROM PROPOSED* LOCATION TO NEAREST PROPERTY OR LEASE LINE, FT.
 (Also to nearest drlg. unit line, if any)
 790'

16. NO. OF ACRES IN LEASE
 320

17. NO. OF ACRES ASSIGNED TO THIS WELL
 160

18. DISTANCE FROM PROPOSED LOCATION* TO NEAREST WELL, DRILLING, COMPLETED, OR APPLIED FOR, ON THIS LEASE, FT.
 0'

19. PROPOSED DEPTH
 1420'

20. ROTARY OR CABLE TOOLS
 Rotary

21. ELEVATIONS (Show whether I.F., RT., GR., etc.)
 5942' GL

22. APPROX. DATE WORK WILL START*
 ASAP

23. PROPOSED CASING AND CEMENTING PROGRAM

SIZE OF HOLE	SIZE OF CASING	WEIGHT PER FOOT	SETTING DEPTH	QUANTITY OF CEMENT
7-7/8"	7"	20#	90'	35 sx circulate
4-3/4"	2-7/8"	6.4#	1420'	150 sx *
* SEE SPECIM STIPULATIONS				

Plan to drill 4-3/4" hole to test the Pictured Cliffs Formation. Plan to run IES log to TD. If productive, plan to set 2-7/8" tbg for csg, cement, selectively perforate, frac, clean out after frac, run 1-1/4" tbg and complete well.

Plan to use 3000 psi BOP per attached schematic diagram. Will use master valve and stripper head while completing well.

NMERB: Gas rot dedicated.

This action is subject to administrative appeal pursuant to 30 CFR 2901

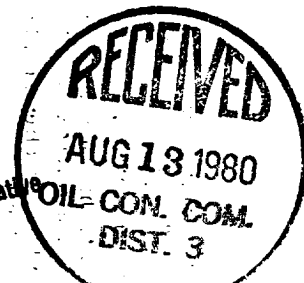

IN ABOVE SPACE DESCRIBE PROPOSED PROGRAM: If proposal is to deepen or plug back, appeal on present productive zone and proposed new productive zone. If proposal is to drill or deepen directionally, give pertinent data on subsurface locations and measured and true vertical depths. Give blowout preventer program, if any.

24. SIGNED [Signature] TITLE Geologist DATE 6-11-80

(This space for Federal or State office use)

PERMIT NO. JUN 6 1980
JAMES F. SMITH
 APPROVED BY DISTRICT ENGINEER

APPROVAL DATE
 TITLE
 DATE

oh 3m

mmoco

*See Instructions On Reverse Side
 OPERATOR

**NEW MEXICO OIL CONSERVATION COMMISSION
WELL LOCATION AND ACREAGE DEDICATION PLAT**

Form C-102
Supersedes C-128
Effective 1-1-65

All distances must be from the outer boundaries of the Section.

Operator Dugan Production Corporation			Lease Piney		Well No. #1
Unit Letter N	Section 4	Township 27 North	Range 13 West	County San Juan	
Actual Footage Location of Well: <div style="display: flex; justify-content: space-between;"> 790' feet from the South line and 1750 feet from the West line </div>					
Ground Level Elev. 5942	Producing Formation Pictured Cliffs	Pool WAW Fruitland <i>East</i>		Dedicated Acreage: 160 Acres	

1. Outline the acreage dedicated to the subject well by colored pencil or hachure marks on the plat below.
2. If more than one lease is dedicated to the well, outline each and identify the ownership thereof (both as to working interest and royalty).
3. If more than one lease of different ownership is dedicated to the well, have the interests of all owners been consolidated by communitization, unitization, force-pooling, etc?

☐ Yes ☐ No If answer is "yes," type of consolidation _____

If answer is "no," list the owners and tract descriptions which have actually been consolidated. (Use reverse side of this form if necessary.) _____

No allowable will be assigned to the well until all interests have been consolidated (by communitization, unitization, forced-pooling, or otherwise) or until a non-standard unit, eliminating such interests, has been approved by the Commission.

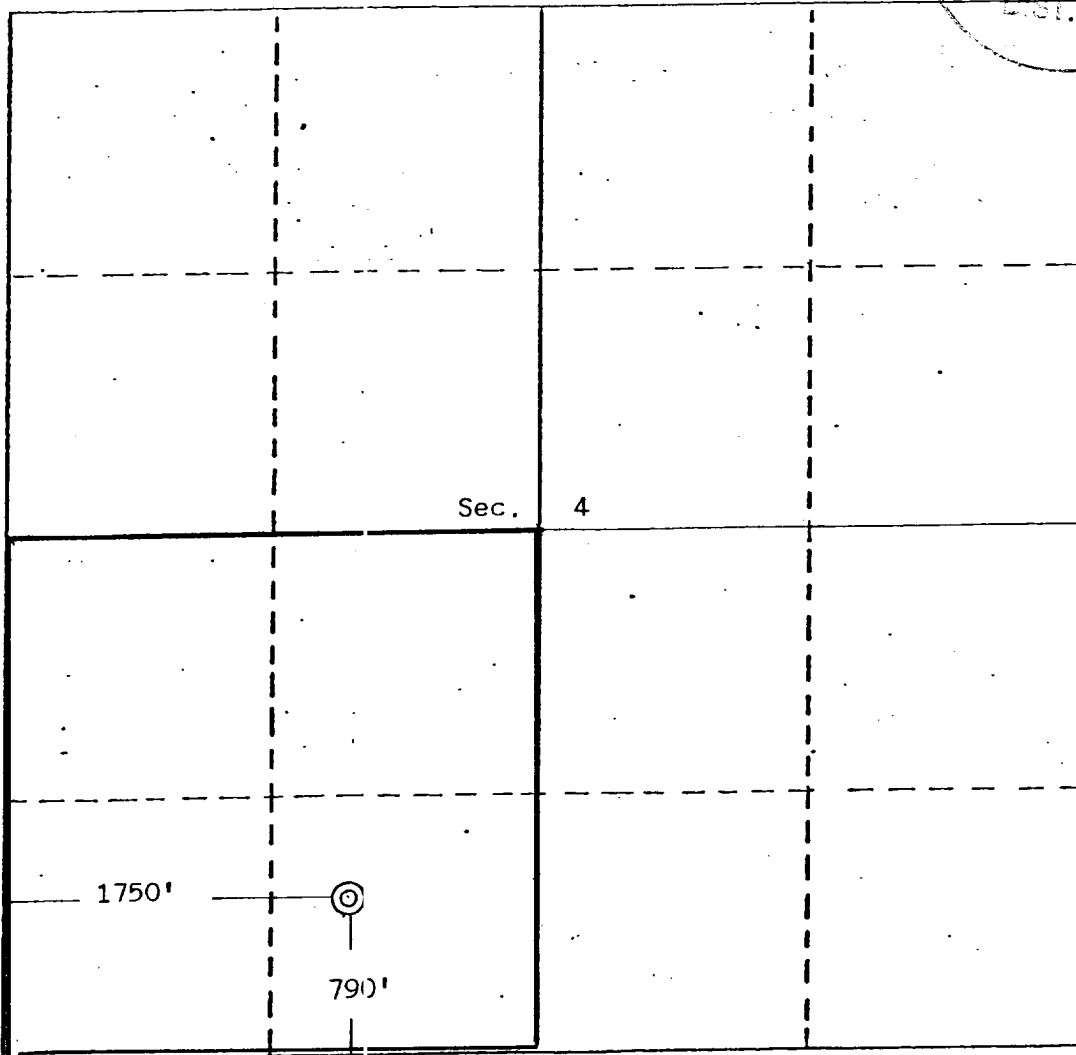
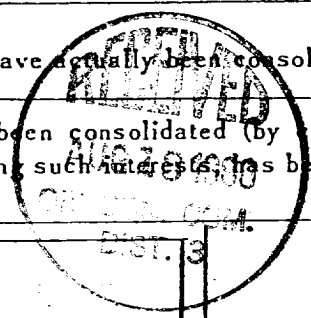

CERTIFICATION

I hereby certify that the information contained herein is true and complete to the best of my knowledge and belief.

Sherman E. Dugan
Name

Sherman E. Dugan

Position
Geologist

Company
Dugan Production Corp.

Date
6-11-80

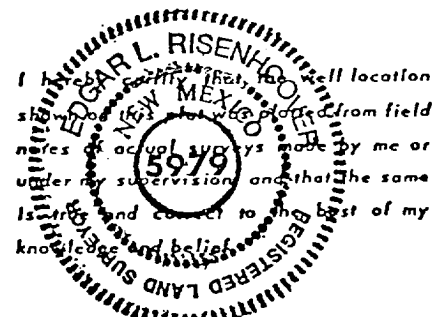

Date Surveyed
June 6, 1980

Registered Professional Engineer
and/or Land Surveyor

Edgar L. Risenhoover
Certificate No. 5979

Edgar L. Risenhoover, L.S.

