

District I
P.O. Box 1980, Hobbs, NM

District II
P.O. Box 1980, Hobbs, NM

District III
P.O. Box 1980, Hobbs, NM

District IV
P.O. Box 1980, Hobbs, NM

District V
P.O. Box 1980, Hobbs, NM

District VI
P.O. Box 1980, Hobbs, NM

District VII
P.O. Box 1980, Hobbs, NM

District VIII
P.O. Box 1980, Hobbs, NM

District IX
P.O. Box 1980, Hobbs, NM

District X
P.O. Box 1980, Hobbs, NM

District XI
P.O. Box 1980, Hobbs, NM

District XII
P.O. Box 1980, Hobbs, NM

District XIII
P.O. Box 1980, Hobbs, NM

District XIV
P.O. Box 1980, Hobbs, NM

District XV
P.O. Box 1980, Hobbs, NM

District XVI
P.O. Box 1980, Hobbs, NM

District XVII
P.O. Box 1980, Hobbs, NM

District XVIII
P.O. Box 1980, Hobbs, NM

District XIX
P.O. Box 1980, Hobbs, NM

District XX
P.O. Box 1980, Hobbs, NM

District XXI
P.O. Box 1980, Hobbs, NM

District XXII
P.O. Box 1980, Hobbs, NM

District XXIII
P.O. Box 1980, Hobbs, NM

District XXIV
P.O. Box 1980, Hobbs, NM

District XXV
P.O. Box 1980, Hobbs, NM

District XXVI
P.O. Box 1980, Hobbs, NM

District XXVII
P.O. Box 1980, Hobbs, NM

District XXVIII
P.O. Box 1980, Hobbs, NM

District XXIX
P.O. Box 1980, Hobbs, NM

District XXX
P.O. Box 1980, Hobbs, NM

District XXXI
P.O. Box 1980, Hobbs, NM

District XXXII
P.O. Box 1980, Hobbs, NM

District XXXIII
P.O. Box 1980, Hobbs, NM

District XXXIV
P.O. Box 1980, Hobbs, NM

District XXXV
P.O. Box 1980, Hobbs, NM

District XXXVI
P.O. Box 1980, Hobbs, NM

District XXXVII
P.O. Box 1980, Hobbs, NM

District XXXVIII
P.O. Box 1980, Hobbs, NM

District XXXIX
P.O. Box 1980, Hobbs, NM

District XXXX
P.O. Box 1980, Hobbs, NM

District XXXXI
P.O. Box 1980, Hobbs, NM

District XXXXII
P.O. Box 1980, Hobbs, NM

District XXXXIII
P.O. Box 1980, Hobbs, NM

District XXXXIV
P.O. Box 1980, Hobbs, NM

District XXXXV
P.O. Box 1980, Hobbs, NM

District XXXXVI
P.O. Box 1980, Hobbs, NM

District XXXXVII
P.O. Box 1980, Hobbs, NM

District XXXXVIII
P.O. Box 1980, Hobbs, NM

State of New Mexico
Energy, Minerals and Natural Resources Department

OIL CONSERVATION DIVISION
P.O. Box 2088

Santa Fe, New Mexico 87504-2088

SUBMIT 1 COPY TO
APPROPRIATE
DISTRICT OFFICE
AND 1 COPY TO
SANTA FE OFFICE

(Revised 3/9/94)

PIT REMEDIATION AND CLOSURE REPORT

Operator: BONNEVILLE FUELS CORPORATION Telephone: 303-863-1555

Address: 1660 Lincoln Street, Suite 1800, Denver, CO 80264

Facility Or: SCOTT "E" FEDERAL #18

Well Name

Location: Unit or Qtr/Qtr Sec SW N Sec 36 T 27 R 11 County SAN JUAN

Pit Type: Separator XX Dehydrator Other

Land Type: BLM XX, State , Fee , Other

Pit Location: Pit dimensions: length 15, width 15, depth 4
(Attach diagram)

Reference: wellhead , other See Attached

Footage from reference:

Direction from reference: Degrees East North
of
 West South

Depth To Ground Water: Less than 50 feet (20 points)
(Vertical distance from 50 feet to 99 feet (10 points)
contaminants to seasonal Greater than 100 feet (0 points) 0
high water elevation of
ground water)

Wellhead Protection Area: Yes (20 points)
(Less than 200 feet from a private No (0 points) 0
domestic water source, or; less than
1000 feet from all other water sources)

Distance To Surface Water: Less than 200 feet (20 points)
(Horizontal distance to perennial 200 feet to 1000 feet (10 points)
lakes, ponds, rivers, streams, creeks, Greater than 1000 feet (0 points) 0
irrigation canals and ditches)

RANKING SCORE (TOTAL POINTS): 0

RECEIVED
FEB 18 1997
OIL CON. DIV.
DIST. 3

Date Remediation Started: 9/15/94 Date Completed: 9/15/94

Remediation Method: Excavation XX Approx. cubic yards 33
(check all appropriate sections) Landfarmed _____ Insitu Bioremediation _____
Other _____

Remediation Location: Onsite XX Offsite _____
(ie. landfarmed onsite, name and location of offsite facility)

General Description Of Remedial Action: Contamination was remediated by dilution and aeration. Remediated soil was backfilled into remediated pit. A below grade fiberglass tank was emplaced in the same location as old earthen pit as per NMOC guidelines. Pit was sampled approximately 1-1/2 years after initial remediation to supply BTEX values for bottom of pit and backfill composite. Sampling was done with a truck mounted Geoprobe which auger drilled to just below the old TD of the remediated pit. Several samples were taken off the auger while drilling to TD and were taken as representative of the backfill. The TD sample was either taken off the raised auger or with a split spoon.

Ground Water Encountered: No XX Yes _____ Depth _____

Final Pit: Sample location See Attached
Closure Sampling: _____
(if multiple samples, attach sample results and diagram of sample locations and depths)

Sample depth 4'; 4'

Sample date 9/15/94; 5-23-96 Sample time 9:00:00; 9:35

Sample Results

Benzene (ppm) _____

Total BTEX (ppm) _____

Field headspace (ppm) Composite 4' (PID, 5.1 units)

TPH @ 4' = 34; Backfill = 253, 164, 435, 274, 311

Ground Water Sample: Yes _____ No XX (If yes, attach sample results)

I HEREBY CERTIFY THAT THE INFORMATION ABOVE IS TRUE AND COMPLETE TO THE BEST OF MY KNOWLEDGE AND BELIEF

DATE 10/19/96

SIGNATURE

PRINTED NAME
AND TITLE

James O. Cable
Vice President Operations

FINAL PTF CLOSURE SAMPLING REPORT

Operator: BONNEVILLE FUELS CORPORATION Telephone: (505) 632-9876
 Address: 310 NORTH FIRST STREET, BLOOMFIELD, NM 87413
 Facility Or: SCOTT "E" FEDERAL #18
 Well Name _____
 Location: Unit or Qtr/Qtr Sec _____ Sec _____ T _____ R _____ County SAN JUAN

Depth	TPH
Surface	125 ppm
2 ft.	ppm
4 ft.	34 ppm
6 ft.	ppm
8 ft.	ppm
10 ft.	ppm
12 ft.	ppm
14 ft.	ppm
16 ft.	ppm
18 ft.	ppm
20 ft.	ppm
ft.	ppm
ft.	ppm
ft.	ppm

SIDE VIEW

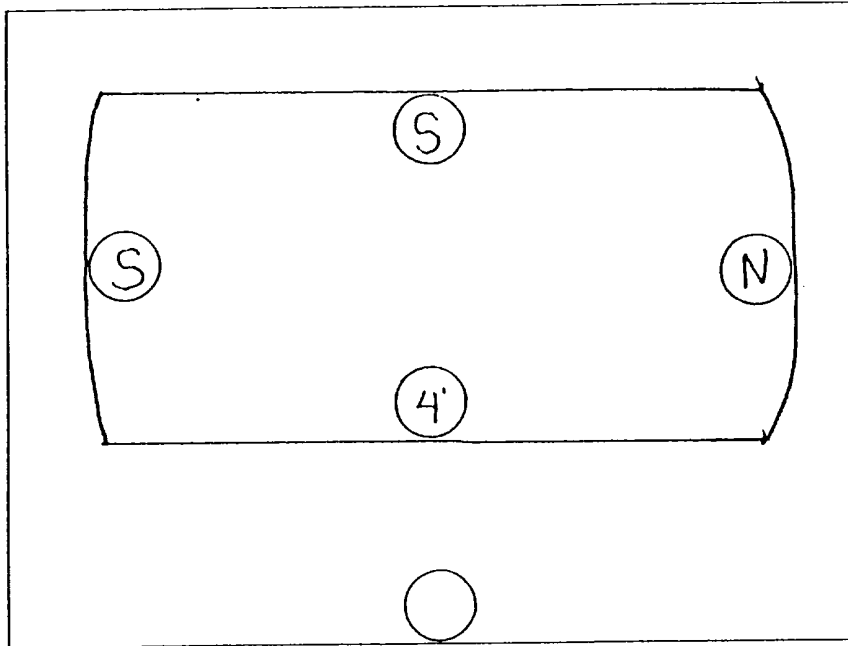

TOP VIEW

North Side	16 ppm
East Side	44 ppm
South Side	37 ppm
West Side	81 ppm

North

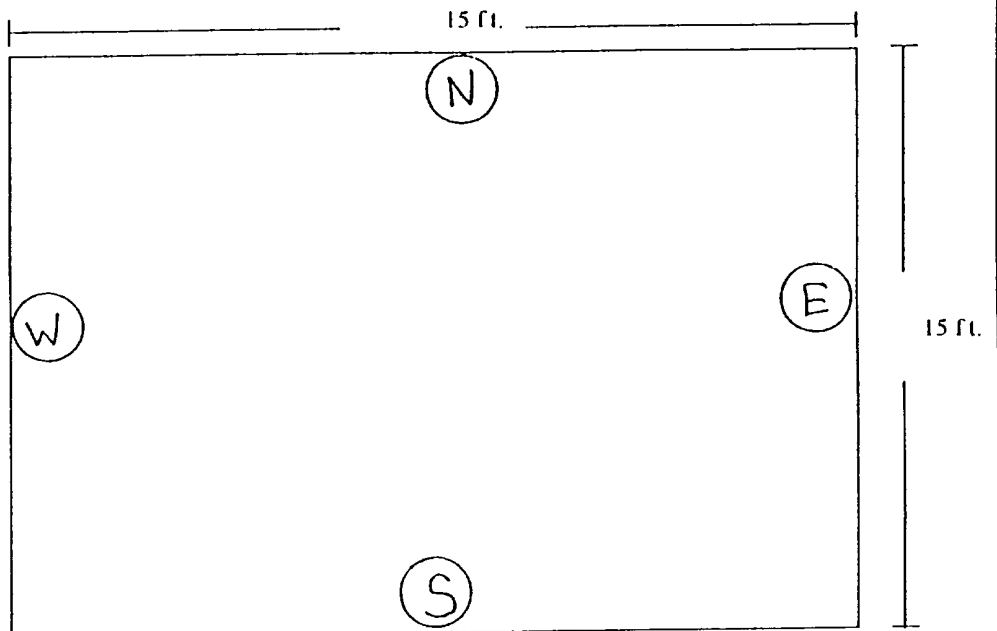

BONNEVILLE FUELS CORPORATION

SCOTT "E" FEDERAL #18



STORAGE TANK

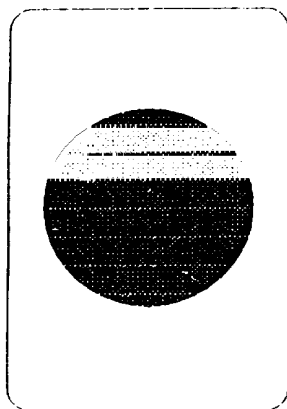

WELLHEAD



168' 166° SE

SEPERATOR



SEPERATOR PIT

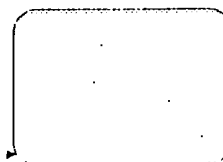

ON SITE TECHNOLOGIES, LTD.
P.O. BOX 2606, FARMINGTON, NM 87499
(505) 325-5667

DATE : 05-23-96

CLIENT : BONNEVILLE FUELS

SITE LOCATION: SCOTT "E" FEDERAL # 18
Unit N Sec .36, T27N, R1W, NMPM
San Juan County

CONTRACTOR : ON SITE

ASSESSMENT SUMMARY

CO. #: BON 1001

LOGGER : CG

JOB #: 4-1296

PAGE #: 1

START : 9:00

FINISH : 09:35

NOTES:

One pit assessed: Separator

Separator Composite: 3'-5' (PID: 5.1 Units)

TD: 4'

LAB: TEST N/A

