

UNITED STATES
DEPARTMENT OF THE INTERIOR
GEOLOGICAL SURVEY

APPLICATION FOR PERMIT TO DRILL, DEEPEN, OR PLUG BACK

1a. TYPE OF WORK
DRILL ☒ DEEPEN ☐ PLUG BACK ☐

b. TYPE OF WELL

OIL
WELL ☐GAS
WELL ☒

OTHER

SINGLE
ZONE ☒MULTIPLE
ZONE ☐

2. NAME OF OPERATOR

Bixco, Inc.

3. ADDRESS OF OPERATOR

Box 255, Farmington, NM 87401

4. LOCATION OF WELL (Report location clearly and in accordance with any State requirements.)*

At surface

790 ft. from South line, 1850 ft. from East
line

At proposed prod. zone

Same

14. DISTANCE IN MILES AND DIRECTION FROM NEAREST TOWN OR POST OFFICE*

11 miles South of Farmington, NM

15. DISTANCE FROM PROPOSED*

LOCATION TO NEAREST

PROPERTY OR LEASE LINE, FT.

(Also to nearest drlg. unit line, if any)

790 ft.

16. NO. OF ACRES IN LEASE

320 ac.

17. NO. OF ACRES ASSIGNED
TO THIS WELL

160 ac.

18. DISTANCE FROM PROPOSED LOCATION*

TO NEAREST WELL, DRILLING, COMPLETED,
OR APPLIED FOR, ON THIS LEASE, FT.

3850 ft.

19. PROPOSED DEPTH

1490 ft.

20. ROTARY OR CABLE TOOLS

Rotary

21. ELEVATIONS (Show whether DF, RT, GR, etc.)

5956 Gr.

22. APPROX. DATE WORK WILL START*

October 1, 1980

23.

PROPOSED CASING AND CEMENTING PROGRAM

SIZE OF HOLE	SIZE OF CASING	WEIGHT PER FOOT	SETTING DEPTH	QUANTITY OF CEMENT
8 3/4"	7"	17.0# H-40	90 Ft.	35 sacks - to surface
4 3/4"	2 7/8"	6.5# N-80	1490 ft.	150 sacks - to surface

It is proposed to set 3 jts of 7", 17# surface casing in an 8 3/4" hole to 90 ft. depth and cement it to the surface with approx. 35 sacks of reg. cement, 4%CaCl. After cement sets 12 hrs a 4 3/4" hole will be drilled to a TD of 1490 ft. to test gas possibilities in the Farmington, Fruitland and Pictured Cliffs ss's. No water-bearing formations or abnormal pressures are anticipated. An electrical-induction, a formation density and a compensated neutron-density log with caliper will be run to total depth. If an evaluation of these logs indicates gas possibilities, 2 7/8", 6.5# tubing will be run to total depth and cemented to the surface. After at least 24 hrs, the possible gas zones will be perforated and tested and stimulated, if required. The 4 3/4" will be drilled with an 8.6 to 9.0 lb/gal., low water-loss mud. A Hydril 7", 3000# test blow-out preventor will be used during drilling and a master valve and stripping head will be utilized during any completion attempt. Estimated formation tops are: Ojo Alamo Ss - Surface, Kirtland Sh - 50 ft, Fruitland Fm - 865 ft, Pictured Cliffs Ss. - 1320 ft., Lewis Sh. - 1482 ft.

IN ABOVE SPACE DESCRIBE PROPOSED PROGRAM: If proposal is to deepen or plug back, give data on present productive zone and proposed new productive zone. If proposal is to drill or deepen directionally, give pertinent data on subsurface locations and measured and true vertical depths. Give blowout preventer program, if any.

24.

SIGNED

William R. Geer

TITLE

Agent

Sept. 2, 1980

(This space for Federal or State office use)

PERMIT NO.

APPROVAL DATE

APPROVED BY

CONDITIONS OF APPROVAL, IF ANY

TITLE

DATE

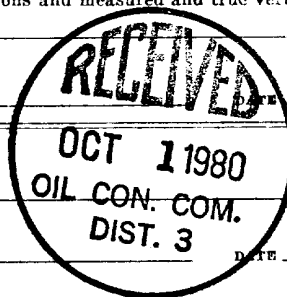
*ok 3rd*

NACCC

**NEW MEXICO OIL CONSERVATION COMMISSION
WELL LOCATION AND ACREAGE DEDICATION PLAT**

Form C-102
Supersedes C-120
Effective 1-1-65

All distances must be from the outer boundaries of the Section.

Operator Bixco Incorporated			Lease GasB		Well No. 2
Unit Letter 0	Section 8	Township 27 North	Range 13 West	County San Juan	
Actual Footage Location of Well: 790 feet from the South line and 1850 feet from the East line					
Ground Level Elev. 5956	Producing Formation Pictured Cliffs Ss.		Pool Wildcat WAW East	Dedicated Acreage: 160 Acres	

1. Outline the acreage dedicated to the subject well by colored pencil or hachure marks on the plat below.
2. If more than one lease is dedicated to the well, outline each and identify the ownership thereof (both as to working interest and royalty).
3. If more than one lease of different ownership is dedicated to the well, have the interests of all owners been consolidated by communitization, unitization, force-pooling, etc?

☐ Yes ☐ No If answer is "yes," type of consolidation not applicable

If answer is "no," list the owners and tract descriptions which have actually been consolidated. (Use reverse side of this form if necessary.) _____

No allowable will be assigned to the well until all interests have been consolidated (by communitization, unitization, forced-pooling, or otherwise) or until a non-standard unit, eliminating such interests, has been approved by the Commission.

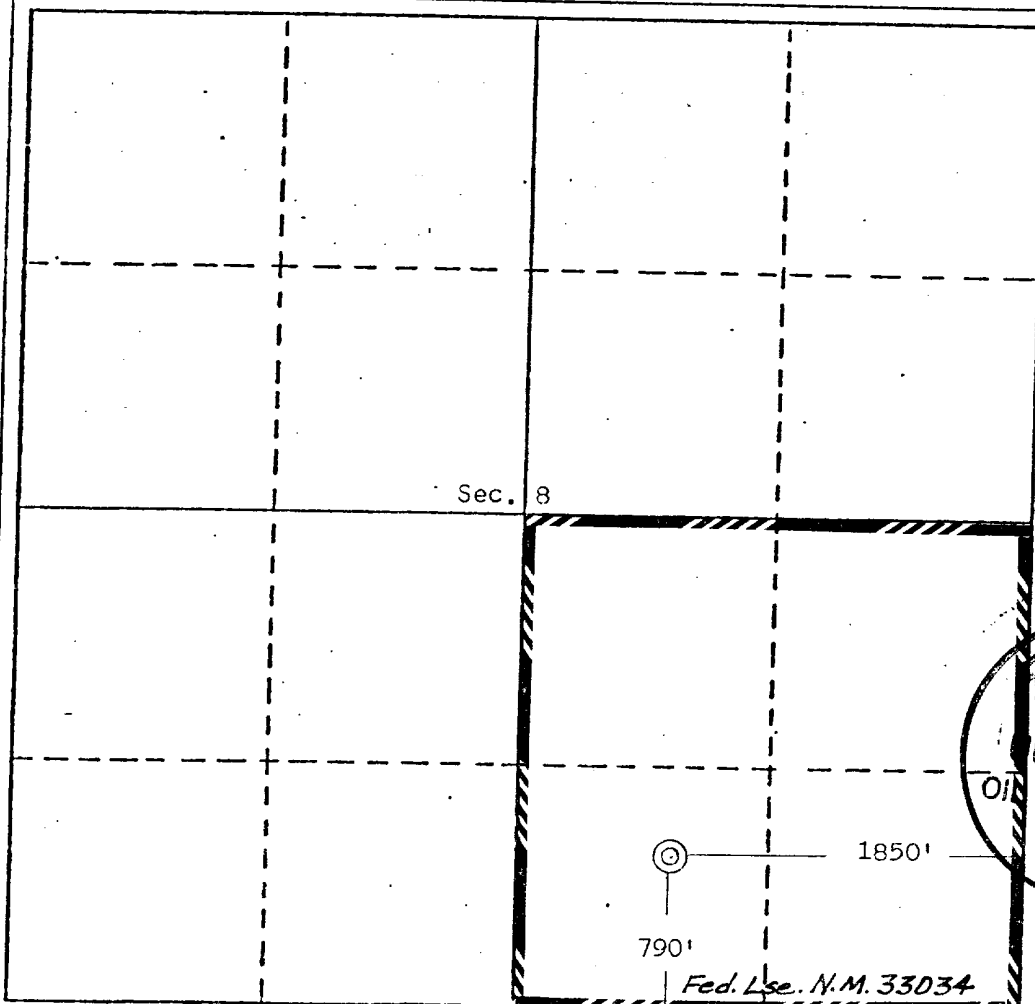

CERTIFICATION

I hereby certify that the information contained herein is true and complete to the best of my knowledge and belief.

William R. Speer
Name
William R. Speer

Position
Agent

Company
Bixco, Inc.

Date
August 28, 1980

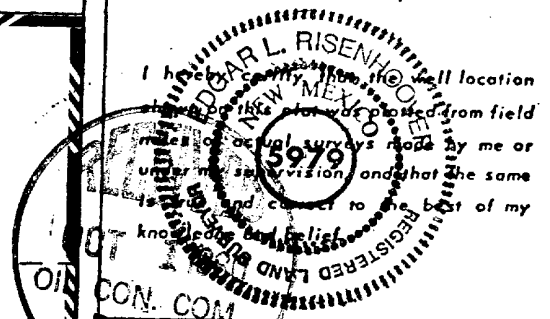

Date Surveyed
August 26, 1980

Registered Professional Engineer
and/or Land Surveyor

Edgar L. Risenhoover
Certificate No. **5979**

Edgar L. Risenhoover, L.S.

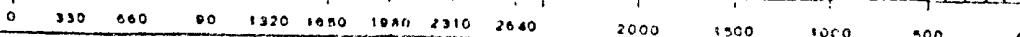

DEVELOPMENT PLAN FOR SURFACE USE

For proposed Bixco, Inc. #2 Gass Well,
located 790 ft. from south line & 1850 ft. from east,
section 8, Township 27 North, Range 13 West, N.M.P.M.
San Juan County, New Mexico

1. The attached topographic map (scale: 1 inch = 2,000 ft.) indicates the proposed location of the well, as well as the location of existing roads and wells in the immediate vicinity.
2. The proposed location is accessible by existing state highway 371, south of Farmington 4.8 miles from the bridge over the San Juan River, then right on to a new Navajo Irrigation Project paved highway southward 5.8 miles, through a cattle guard on the west side of the highway. The location is approximately 1900 ft. west-southwest of the cattle guard across flat terrain and no road or location construction is contemplated for the small, drive-in rig which will be used for drilling. The terrain is very flat over the entire area which will be utilized for drilling, as is indicated by the map.
3. The attached well drill-site layout plat indicates that the only construction anticipated is the digging of three mud and reserve pits, approximately 15 ft. X 8 ft. X 6 ft. deep, some ten feet from the hole as shown. Two of these pits will be utilized for drilling mud and well-cuttings retention, while the third will be used for a reserve pit for water for cementing and/or fracture stimulation. All pits will be unlined. Upon Completion of the well these pits will be fenced until the remaining mud is sufficiently dehydrated (estimated 4-8 wks.) to be back-filled, tamped and leveled to the surrounding terrain level.
4. One additional well is presently planned for drilling on this lease -- the #1 Gass in the NE/4 NE/4. Should the proposed well prove productive, it is anticipated that any production facilities will be installed within a 200 ft. radius of the proposed hole, as dictated by the needs of a future pipeline tie to a gathering system which does not presently extend into the immediate vicinity of the well. It is anticipated that such a tie will be made to either of two existing systems belonging to El Paso Natural Gas Co. which lie approximately 2.5 miles to the south (a 40 psi, low-pressure system) and 2.0 miles to the north (a 200psi, High-pressure system). It is also anticipated that the well-head hook-up, any production equipment and all pipeline connections will be discussed with, be approved by and will conform with the requirements of the Bureau of Indian Affairs and the Navajo Tribe with respect to the Navajo Indian Irrigation Project.
5. Water for the drilling and completion of the proposed well will be obtained from the San Juan River and will be hauled by truck to the location on contract.

6. No permanent camp or airstrip facilities are proposed.
7. Upon completion of the drilling operation, the location will be thoroughly cleaned up of all debris, the pits filled and tamped, the location leveled to conform with the pre-existing terrain and any disturbed area not utilized for production facilities will be seeded as required.
8. The lessee and operator's representative and agent for the proposed well is William R. Speer, P.O. Box 255, Farmington, NM 87401. His office telephone number is 505-325-7789 and his residential telephone number is 505-325-2520.
9. Certification:

Date Sept. 2, 1980

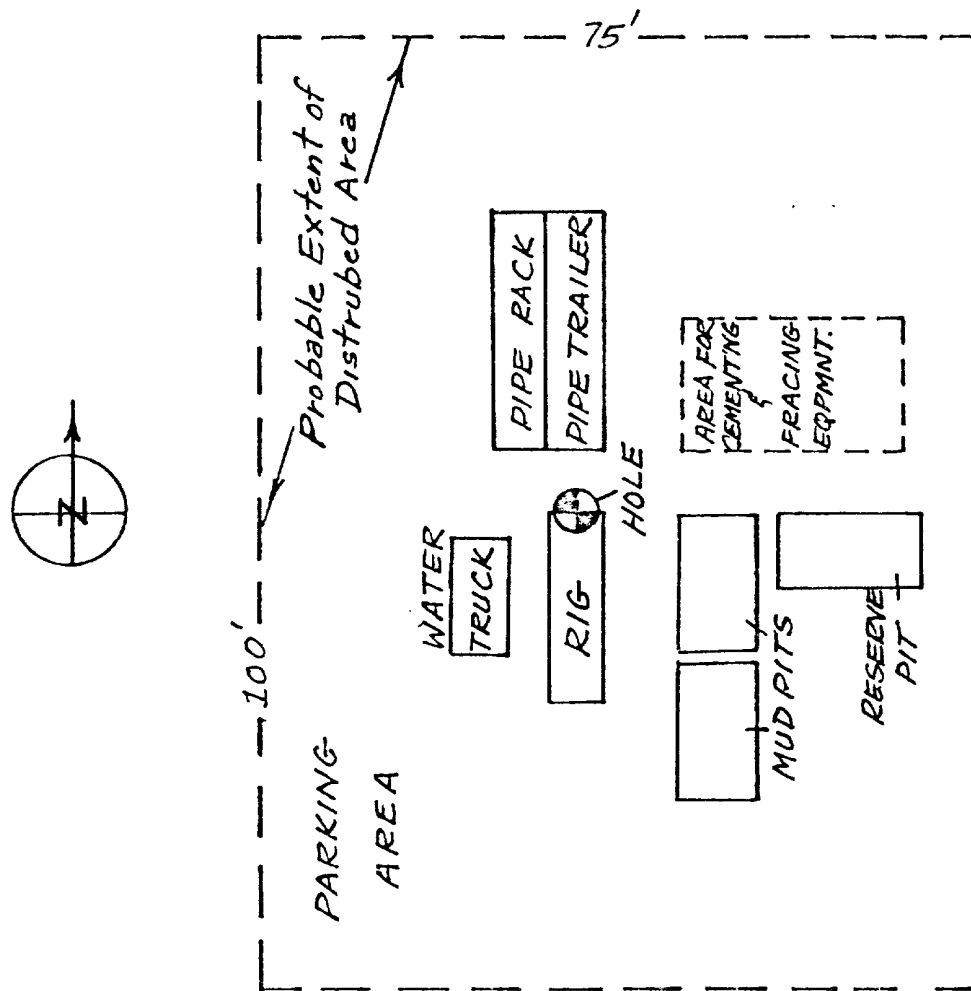

WAW-PICTURED CLIFFS WELL DRILL-SITE LAYOUT PLAT
showing location, size and placement of various units

SCALE: 1 INCH = 20 FEET

For the proposed Bixco, Inc. #2 Gass-Pictured Cliffs Test
790 ft. fsl and 1850 ft. fel, Sec. 8, T27N, R13W, San Juan
County, New Mexico

THIS PORTION, OR ANY PART THEREOF,
MAY BE PLACED OUTSIDE OF SUB-
STRUCTURE, IF DESIRED. USE LONG
RADIUS BENDS. PIPE USED FOR
EXTENSION SHOULD BE SHOP MADE

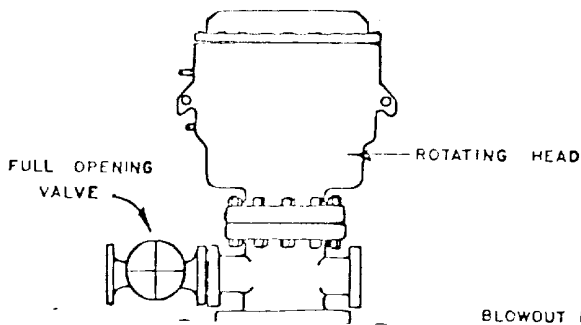

BLOWOUT PREVENTER

HUGH LAKE, N.M. QUAD
UNITED STATES
DEPARTMENT OF THE INTERIOR
GEOLOGICAL SURVEY

R13W

