

Approved

Meter Number: 93937
Location Name: MARTIN GAS COM F #1E
Location: TN-27 RG-10
SC-14 UL-N
2 - Federal
NMOCD Zone: OUTSIDE
Hazard Ranking Score: 00

RECEIVED
APR 14 1997
OIL CON. DIV.
DIST. 3

**RATIONALE FOR RISK-BASED CLOSURE OF PRODUCTION PITS
LOCATED OUTSIDE OF THE VULNERABLE ZONE
IN THE SAN JUAN BASIN**

This production pit location was ranked according to the criteria in the New Mexico Oil Conservation Division's Unlined Surface Impoundment Closure Guidelines and received a ranking score of zero. The estimated depth to groundwater is greater than 100-feet beneath ground surface (bgs), the pit is not in a well head protection area, and there are no surface water bodies within 1,000 horizontal feet of the pit location.

The primary source, discharge to the pit has been removed. There has been no discharge to the pits for at least 4 years and the pits have been closed for at least one year.

Each pit was backfilled with clean soil and graded in a manner to divert precipitation away from the excavated area. Minimal infiltration of rainfall is expected. Any rainfall that does infiltrate the ground surface must migrate through clean backfill before reaching the residual hydrocarbons.

There is no source material at the ground surface, so direct contact of hydrocarbons with livestock and the populous is not likely.

In general, outside of the vulnerable area and alluvial valleys, bedrock material is generally encountered within 20 feet of the ground surface. Bedrock material in the San Juan Basin consists of interbedded sandstones, shales and clays. According to Freeze and Cherry, 1979, the hydraulic conductivity of the bedrock material are as follows:

Sandstone	10^{-9} to 10^{-13} cm/sec
Shale	10^{-12} to 10^{-16} cm/sec
Clay	10^{-12} to 10^{-15} cm/sec

Based on this information, the residual hydrocarbons should not migrate to groundwater.

Natural process (bioremediation) are degrading the residual hydrocarbon to carbon dioxide and water and will continue until the source is gone, therefore minimizing any impact to the environment.

Based on the above information, it is highly unlikely that any source material will impact groundwater or ever find an exposure pathway to affect human health and therefore El Paso Field Services Company (EPFS) requests closure of this pit location.

GENERAL	<p>Meter: <u>93-937</u> Location: <u>Martin Gas Com F No. 1E</u> Operator #: <u>0203</u> Operator Name: <u>Amoco</u> P/L District: <u>Angel Peak</u> Coordinates: Letter: <u>A</u> Section <u>14</u> Township: <u>27</u> Range: <u>10</u> Or Latitude _____ Longitude _____ Pit Type: Dehydrator _____ Location Drip: <u>X</u> Line Drip: _____ Other: _____ Site Assessment Date: <u>9/28/94</u> Area: <u>01</u> Run: <u>52</u></p>
SITE ASSESSMENT	<p>NMOCD Zone: (From NMOCD Maps) Inside <input type="checkbox"/> (1) Outside <input checked="" type="checkbox"/> (2)</p> <p>Land Type: BLM <input checked="" type="checkbox"/> (1) State <input type="checkbox"/> (2) Fee <input type="checkbox"/> (3) Indian _____</p> <p>Depth to Groundwater Less Than 50 Feet (20 points) <input type="checkbox"/> (1) 50 Ft to 99 Ft (10 points) <input type="checkbox"/> (2) Greater Than 100 Ft (0 points) <input checked="" type="checkbox"/> (3)</p> <p>Wellhead Protection Area : Is it less than 1000 ft from wells, springs, or other sources of fresh water extraction? , or ; Is it less than 200 ft from a private domestic water source? <input type="checkbox"/> (1) YES (20 points) <input checked="" type="checkbox"/> (2) NO (0 points)</p> <p>Horizontal Distance to Surface Water Body Less Than 200 Ft (20 points) <input type="checkbox"/> (1) 200 Ft to 1000 Ft (10 points) <input type="checkbox"/> (2) Greater Than 1000 Ft (0 points) <input checked="" type="checkbox"/> (3)</p> <p>Name of Surface Water Body <u>Armenta Canyon</u> (Surface Water Body : Perennial Rivers, Major Wash, Streams, Creeks, Irrigation Canals, Ditches, Lakes, Ponds) Distance to Nearest Ephemeral Stream <input type="checkbox"/> (1) < 100' (Navajo Pits Only) <input type="checkbox"/> (2) > 100'</p> <p>TOTAL HAZARD RANKING SCORE: <u>0</u> POINTS</p>
REMARKS	<p>Remarks : <u>Redline book: Outside, Vulnerable Zone Topo: Outside</u> <u>Three pits, location drip pit has a small amount of liquid in it. Will close one pit.</u> <u>PUSH IN</u></p>

ORIGINAL PIT LOCATION

Original Pit : a) Degrees from North 134° Footage from Wellhead 126'
b) Length : 27' Width : 25' Depth : 5'

ORIGINAL PIT LOCATION

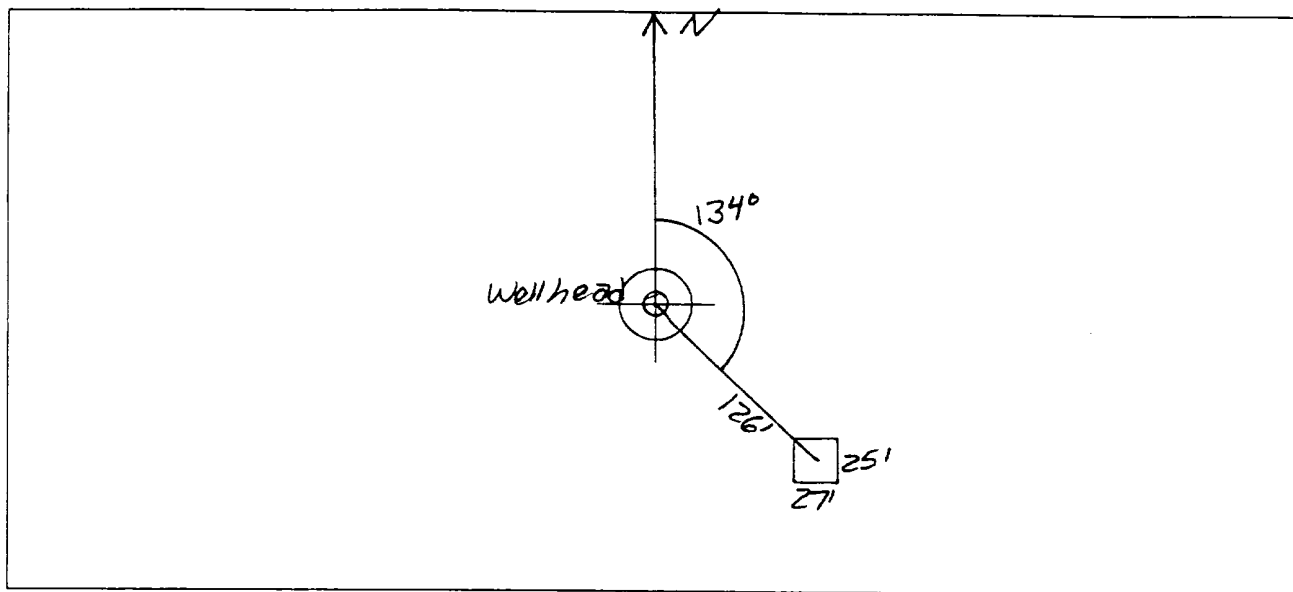

Remarks :

Pictures at 1630
Dump Truck

REMARKS

Completed By:

Sarah Kelly
Signature

9/28/94
Date

FIELD PIT REMEDIATION/CLOSURE FORM

GENERAL	<p>Meter: <u>93937</u> Location: <u>Martin Gas Com F No 1E</u></p> <p>Coordinates: Letter: <u>N</u> Section <u>14</u> Township: <u>27</u> Range: <u>10</u></p> <p>Or Latitude _____ Longitude _____</p> <p>Date Started : <u>10-14-94</u> Run: <u>01</u> <u>52</u></p>
FIELD OBSERVATIONS	<p>Sample Number(s): <u>VW 414</u></p> <p>Sample Depth: <u>6</u> Feet</p> <p>Final PID Reading <u>19</u> PID Reading Depth <u>6</u> Feet</p> <p style="text-align: center;">Yes No</p> <p>Groundwater Encountered <input type="checkbox"/> <input type="checkbox"/> Approximate Depth _____ Feet</p>
CLOSURE	<p>Remediation Method :</p> <p>Excavation <input type="checkbox"/> Approx. Cubic Yards _____</p> <p>Onsite Bioremediation <input type="checkbox"/></p> <p>Backfill Pit Without Excavation <input checked="" type="checkbox"/></p> <p>Soil Disposition:</p> <p>Envirotech <input type="checkbox"/> Tierra <input type="checkbox"/></p> <p>Other Facility <input type="checkbox"/> Name: _____</p> <p>Pit Closure Date: <u>10-14-94</u> Pit Closed By: <u>BEI</u></p>
REMARKS	<p>Remarks : <u>Sandstone 6'</u></p> <p>_____</p> <p>_____</p>
	<p>Signature of Specialist: <u>V. L. Wilkes</u></p>



FIELD SERVICES LABORATORY
ANALYTICAL REPORT

PIT CLOSURE PROJECT - Soil Samples Outside the GWV Zone

SAMPLE IDENTIFICATION

	Field ID	Lab ID
SAMPLE NUMBER:	VW 414	946427
MTR CODE SITE NAME:	93937	N/A
SAMPLE DATE TIME (Hrs):	10-14-94	1125
SAMPLED BY:	N/A	
DATE OF TPH EXT. ANAL:	10-17-94	10-17-94
DATE OF BTEX EXT. ANAL:	N/A	N/A
TYPE DESCRIPTION:	VG	light grey sand & clay

REMARKS:

RESULTS

PARAMETER	RESULT	UNITS	QUALIFIERS			
			DF	Q	M(g)	V(ml)
TPH (418.1)	365	MG/KG			2.0	28
HEADSPACE PID	19	PPM				
PERCENT SOLIDS	91.5	%				

-- TPH is by EPA Method 418.1 --

Narrative:

DF = Dilution Factor Used

Approved By: 

Date: 10/23/94

 Test Method for
 Oil and Grease and Petroleum Hydrocarbons
 in Water and Soil
 Perkin-Elmer Model 1600 FT-IR
 Analysis Report

04/10/17 13:30

Sample Identification
 746427

Initial mass of sample, g
 0.010

Volume of sample after extraction, ml
 10.00

Detected hydrocarbons, ppm
 100.000

Integration of hydrocarbons 0000 cm-1
 100.000

