

UNITED STATES
DEPARTMENT OF THE INTERIOR
GEOLOGICAL SURVEY

APPLICATION FOR PERMIT TO DRILL, DEEPEN, OR PLUG BACK

1a. TYPE OF WORK

DRILL ☒DEEPEN ☐PLUG BACK ☐

b. TYPE OF WELL

OIL
WELL ☐GAS
WELL ☒

OTHER

SINGLE
ZONE ☒MULTIPLE
ZONE ☐

2. NAME OF OPERATOR

Tenneco Oil Company

3. ADDRESS OF OPERATOR

P. O. Box 3249, Englewood, CO 80155

4. LOCATION OF WELL (Report location clearly and in accordance with any State requirements.)*

At surface 790' FSL 790' FWL

At proposed prod. zone Same

14. DISTANCE IN MILES AND DIRECTION FROM NEAREST TOWN OR POST OFFICE*

14 miles southeast of Blanco, New Mexico

15. DISTANCE FROM PROPOSED*

LOCATION TO NEAREST
PROPERTY OR LEASE LINE, FT.
(Also to nearest drlg. unit line, if any) 790'

16. NO. OF ACRES IN LEASE

1200.00

17. NO. OF ACRES ASSIGNED
TO THIS WELL

W 320

18. DISTANCE FROM PROPOSED LOCATION*
TO NEAREST WELL, DRILLING, COMPLETED,
OR APPLIED FOR, ON THIS LEASE, FT.

19. PROPOSED DEPTH

7100'

20. ROTARY OR CABLE TOOLS

Rotary

21. ELEVATIONS (Show whether DF, RT, GR, etc.)

5873' ground

22. APPROX. DATE WORK WILL START*

March 1982

23. PROPOSED CASING AND CEMENTING PROGRAM

SIZE OF HOLE	SIZE OF CASING	WEIGHT PER FOOT	SETTING DEPTH	QUANTITY OF CEMENT
12-1/4"	9-5/8"	36#	+ 250'	Circ cmt to surface
8-3/4"	7"	23#	+ 3200'	Circ cmt to surface
6-1/4"	4-1/2"	10.5#, 11.6#	+ 7100'	Circ cmt to liner top

See attached drilling program

Gas is dedicated

Build earthen berm between backside of pit and drop-off



IN ABOVE SPACE DESCRIBE PROPOSED PROGRAM: If proposal is to deepen or plug back, give data on present productive zone and proposed new productive zone. If proposal is to drill or deepen directionally, give pertinent data on subsurface locations and measured and true vertical depths. Give blowout preventer program, if any.

24.

SIGNED

Don H. Harrison

TITLE

Production Analyst

DATE

10/14/81

(This space for Federal or State office use)

PERMIT NO.

APPROVAL DATE

RAYMOND W. VINYARD

APPROVED BY

(Orig. Sgd.) RAYMOND W. VINYARD

TITLE

ACTING DISTRICT SUPERVISOR

DATE

DEC 04 1981

CONDITIONS OF APPROVAL, IF ANY:

ok

*See Instructions On Reverse Side

OIL CONSERVATION DIVISION

P. O. BOX 2088

SANTA FE, NEW MEXICO 87501

Form C-107
Revised 10-1-78

STATE OF NEW MEXICO
ENERGY AND MINERALS DEPARTMENT

All distances must be from the outer boundaries of the Section.

Operator Tenneco Oil Company			Lease Russell		Well No. 4E
Unit Letter M	Section 25	Township 28N	Range 8W	County San Juan	
Actual Footage Location of Well:					
790 feet from the South		line and 790 feet from the West		line	
Ground Level Elev: 5873	Producing Formation Dakota	Pool Basin Dakota		Dedicated Acreage: W 320 Acres	

1. Outline the acreage dedicated to the subject well by colored pencil or hachure marks on the plat below.
2. If more than one lease is dedicated to the well, outline each and identify the ownership thereof (both as to working interest and royalty).
3. If more than one lease of different ownership is dedicated to the well, have the interests of all owners been consolidated by communitization, unitization, force-pooling, etc?

☐ Yes ☐ No If answer is "yes," type of consolidation _____

If answer is "no," list the owners and tract descriptions which have actually been consolidated. (Use reverse side of this form if necessary.) _____

No allowable will be assigned to the well until all interests have been consolidated (by communitization, unitization, forced-pooling, or otherwise) or until a non-standard unit, eliminating such interests, has been approved by the Commission.

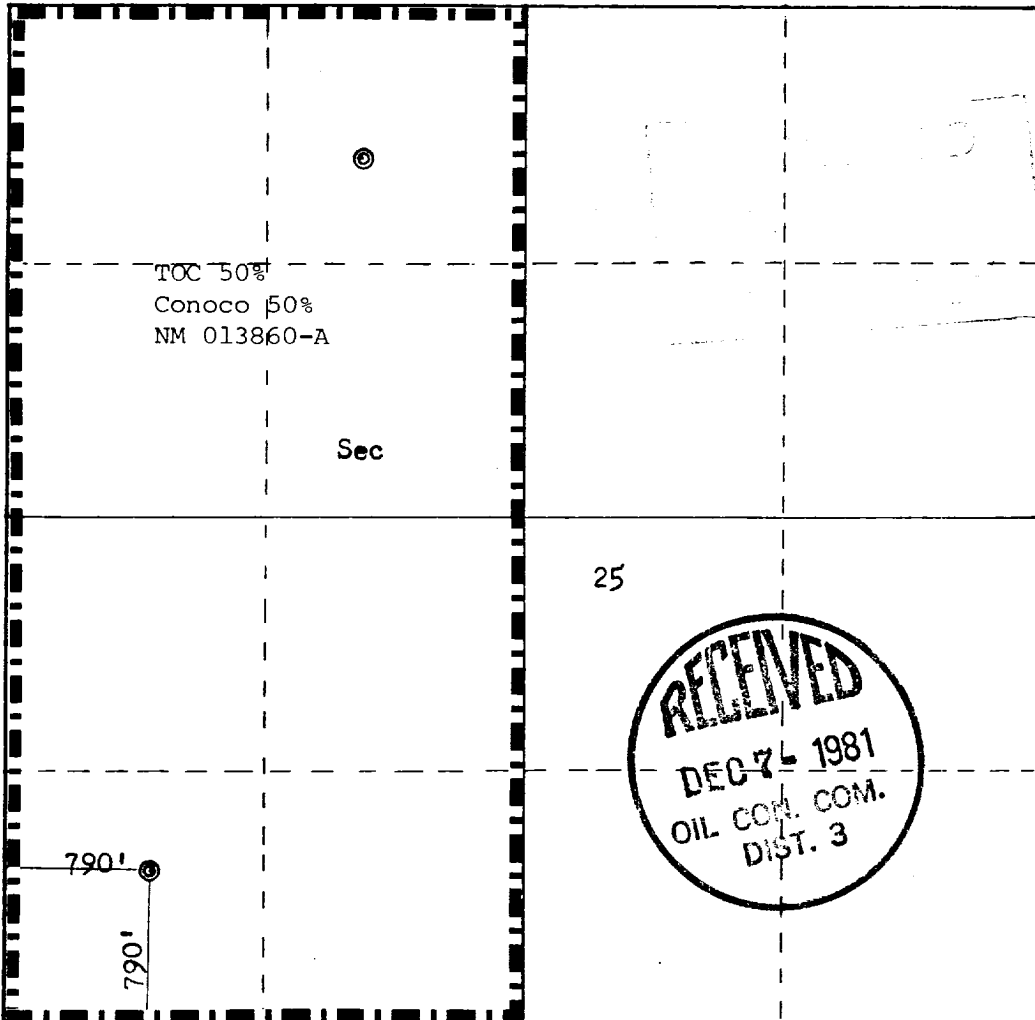

Scale: 1"=1000'

CERTIFICATION

I hereby certify that the information contained herein is true and complete to the best of my knowledge and belief.

Don H. Morrison
Name
Don H. Morrison
Position
Production Analyst
Company
Tenneco Oil Company
Date
August 26, 1981

I hereby certify that the well location shown on this plat was plotted from field notes of actual surveys made by me or under my supervision, and that the same is true and correct to the best of my knowledge and belief.

Date Surveyed
July 9, 1981
Registered Professional Engineer and Land Surveyor
Fred B. Kerr, Jr.
Fred B. Kerr, Jr.
Certificate No.
3950

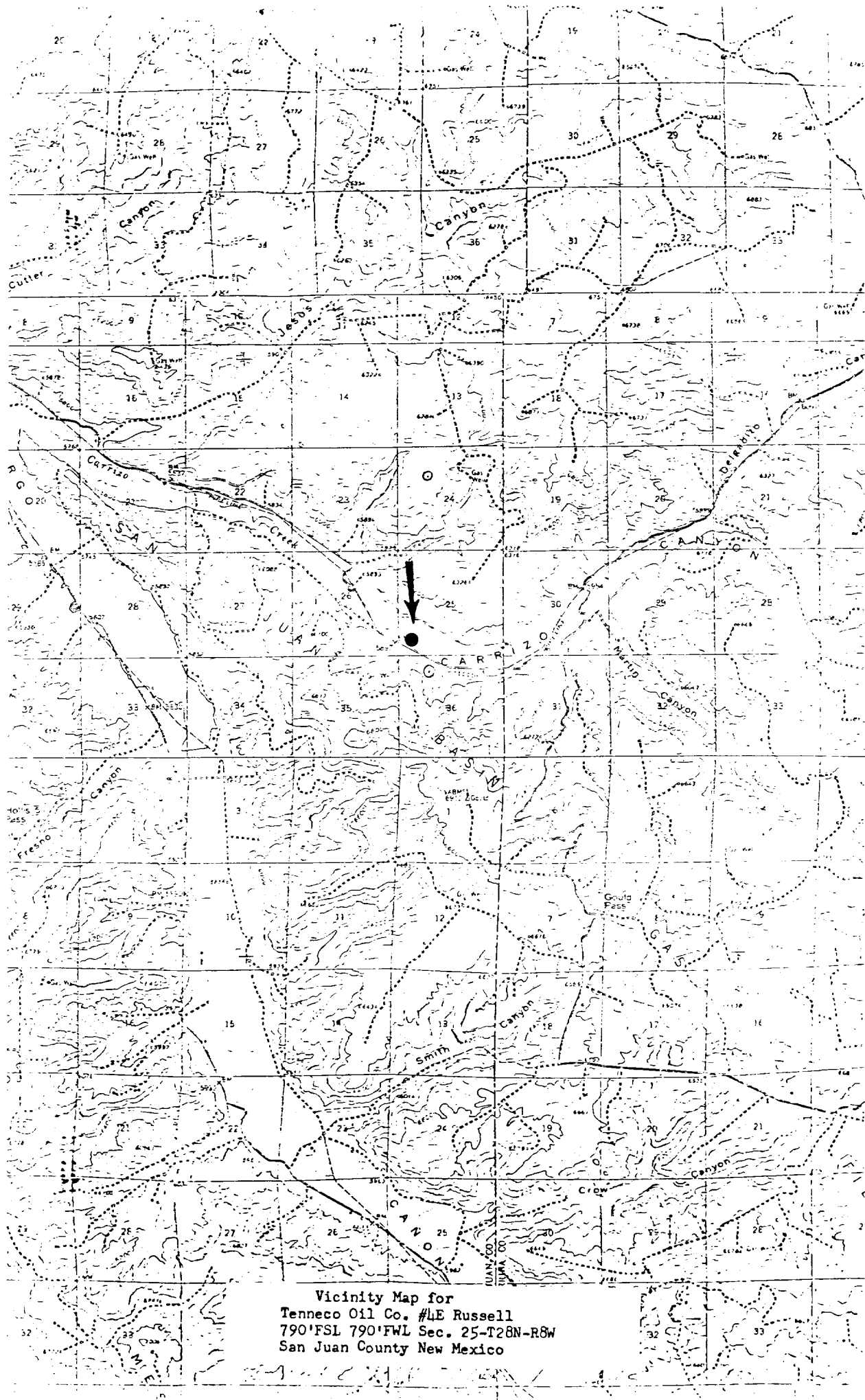

Vicinity Map for
Tenneco Oil Co. #LE Russell
790' FSL 790' FWL Sec. 25-T28N-R8W
San Juan County New Mexico