



STATE OF NEW MEXICO  
ENERGY AND MINERALS DEPARTMENT  
OIL CONSERVATION DIVISION

BRUCE KING  
GOVERNOR  
LARRY KEHOE  
SECRETARY

January 12, 1982

POST OFFICE BOX 2088  
STATE LAND OFFICE BUILDING  
SANTA FE, NEW MEXICO 87501  
(505) 827-2434

Southland Royalty Company  
P. O. Drawer 570  
Farmington, New Mexico 87401

Attention: R. E. Fielder

Administrative Order NSL-1461

Gentlemen:

Reference is made to your application for a non-standard location for your Hugh Lake Well No. 1 to be located 800 feet from the North line and 565 feet from the West line of Section 33, Township 27 North, Range 12 West, NMPM, Basin-Dakota Pool, San Juan County, New Mexico.

By authority granted me under the provisions of Rule 3 of Order No. R-1670, the above-described unorthodox location is hereby approved.

Sincerely,

  
JOE D. RAMEY,  
Director

JDR/RLS/dr

cc: Oil Conservation Division - Aztec  
Oil & Gas Engineering Committee - Hobbs  
U. S. Geological Survey - Farmington





STATE OF NEW MEXICO  
ENERGY AND MINERALS DEPARTMENT

OIL CONSERVATION DIVISION  
AZTEC DISTRICT OFFICE

NSL-1461

1000 RIO BRAZOS ROAD  
AZTEC NEW MEXICO 87410  
(505) 334-6178

OIL CONSERVATION DIVISION  
BOX 2088  
SANTA FE, NEW MEXICO 87501

DATE Jan 5, 1992

RE: Proposed MC \_\_\_\_\_  
Proposed DHC \_\_\_\_\_  
Proposed NSL ✓ \_\_\_\_\_  
Proposed SWD \_\_\_\_\_  
Proposed WFX \_\_\_\_\_  
Proposed PMX \_\_\_\_\_

Gentlemen:

I have examined the application dated Dec 22, 1991  
for the Southland Royalty Co. Hugh Lake #1 N-33-27N-12W  
Operator Lease and Well No. Unit, S-T-R

and my recommendations are as follows:

Approve  
\_\_\_\_\_  
\_\_\_\_\_  
\_\_\_\_\_  
\_\_\_\_\_  
\_\_\_\_\_

Yours truly,

Jeff A. Edmister  
JE



**Southland Royalty Company**

December 18, 1981

Mr. Joe D. Ramey  
New Mexico Department of Energy and Minerals  
Oil & Gas Division  
P. O. Box 2088  
Santa Fe, New Mexico 87501

Dear Mr. Ramey:

Southland Royalty Company hereby requests approval for an unorthodox location for the Hugh Lake #1 well. The proposed location is 800' FNL & 565' FWL of Section 33, T27N, R12W, San Juan County, New Mexico.

The unorthodox site is due to topography.

A copy of this application is being submitted to all offset operators by certified mail with a request that they furnish your Santa Fe Office with a waiver of objection.

Pursuant to authority of Rule 104-F, we respectfully request your approval of an exemption to the standard well location requirement.

Sincerely,

SOUTHLAND ROYALTY COMPANY

R. E. Fielder  
District Engineer

REF/eg

Enclosures

✓CC: Mr. Frank Chavez-OCC-Aztec, NM



## OIL CONSERVATION DIVISION

STATE OF NEW MEXICO  
ENERGY AND MINERALS DEPARTMENTP. O. BOX 2088  
SANTA FE, NEW MEXICO 87501Form C-107  
Revised 10-1-78

All distances must be from the outer boundaries of the Section.

Operator <b>SOUTHLAND ROYALTY COMPANY</b>			Lease <b>HUGH LAKE</b>		Well No. <b>1</b>
Unit Letter <b>D</b>	Section <b>33</b>	Township <b>27N</b>	Range <b>12W</b>	County <b>San Juan</b>	
Actual Footage Location of Well: <b>800</b> feet from the <b>North</b> line and <b>565</b> feet from the <b>West</b> line					
Ground Level Elev. <b>5904</b>	Producing Formation <b>Dakota</b>		Pool <b>Basin Dakota</b>		Dedicated Acreage: <b>320</b> Acres

1. Outline the acreage dedicated to the subject well by colored pencil or hachure marks on the plat below.
2. If more than one lease is dedicated to the well, outline each and identify the ownership thereof (both as to working interest and royalty).
3. If more than one lease of different ownership is dedicated to the well, have the interests of all owners been consolidated by communitization, unitization, force-pooling, etc?

☐ Yes ☐ No If answer is "yes," type of consolidation \_\_\_\_\_

If answer is "no," list the owners and tract descriptions which have actually been consolidated. (Use reverse side of this form if necessary.) \_\_\_\_\_

No allowable will be assigned to the well until all interests have been consolidated (by communitization, unitization, forced-pooling, or otherwise) or until a non-standard unit, eliminating such interests, has been approved by the Commission.

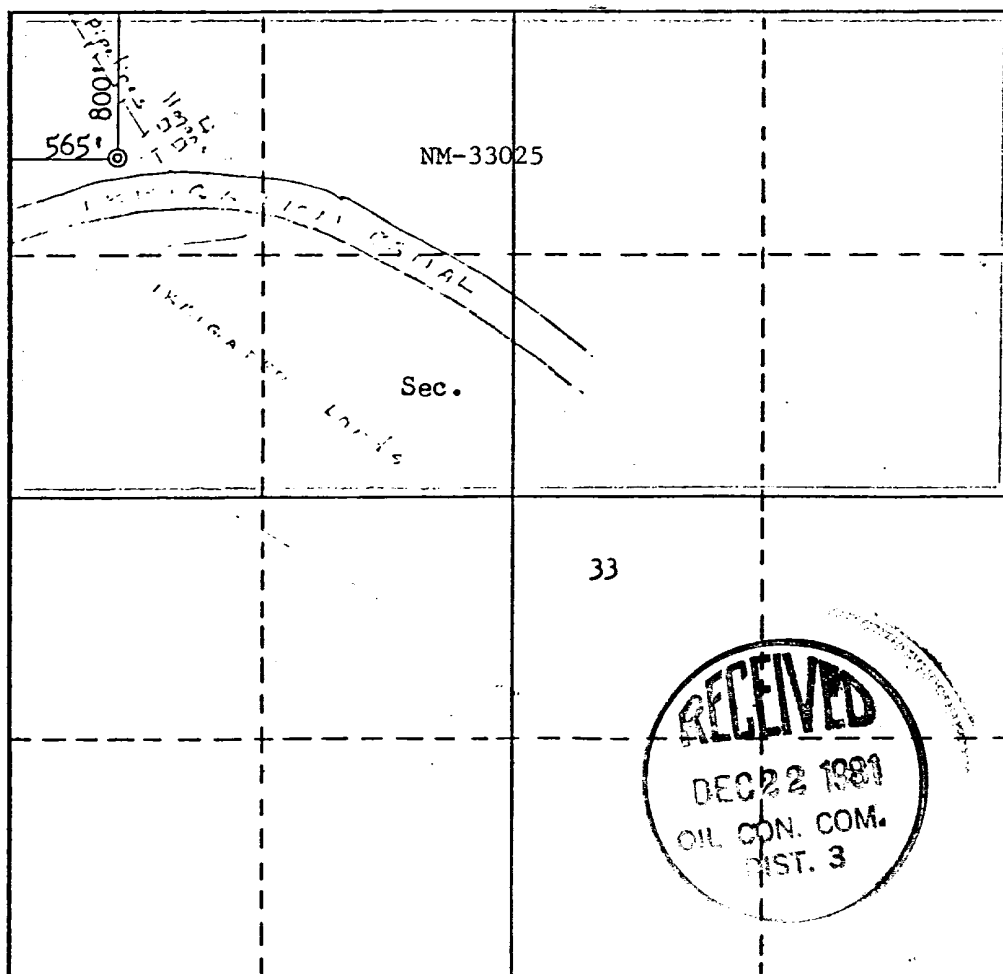

## CERTIFICATION

I hereby certify that the information contained herein is true and complete to the best of my knowledge and belief.

*R. E. Fielder*

Name

R. E. Fielder

Position

District Engineer

Company

Southland Royalty Company

Date

December 21, 1981

I hereby certify that the well location shown on this plat was plotted from field notes of actual surveys made by me or under my supervision, and that the same is true and correct to the best of my knowledge and belief.

Date Surveyed

November 14, 1981

Registered Professional Engineer and/or Land Surveyor

*Fred B. Kerr Jr.*  
Fred B. Kerr Jr.

Certificate No.

3950

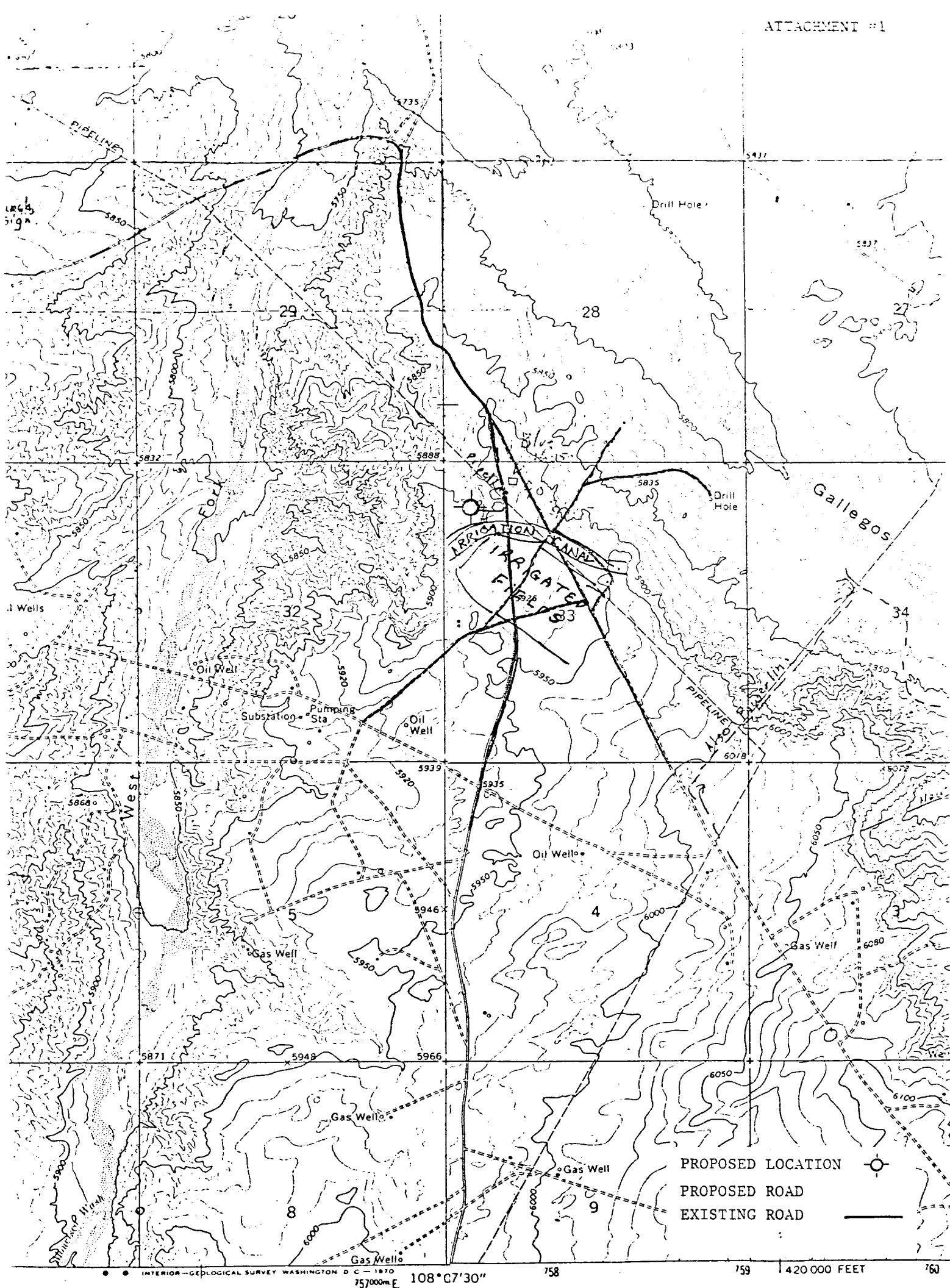

ROAD CLASSIFICATION.  
 Medium-duty ——— Light-duty ———

Mapped, edited, and published by the Geological Survey  
 Control by USGS, USC&GS, and U.S. Bureau of Reclamation

Topography by photogrammetric methods from aerial  
 photographs taken 1964 and by altimetric surveys of the  
 area by USGS 1965

Vicinity Map for  
 SOUTHLAND ROYALTY CO. #1 HUGH LAKE  
 800' FNL 565' FWL Sec. 33-T27N-R12W  
 SAN JUAN COUNTY, NEW MEXICO

HUGH LAKE, N. MEX.  
 N3630—W10807.5/7.5

zone 12, shown in blue

Fine red dashed lines indicate selected fence lines

datum  
 lineate system.

rid ticks,

UTM GRID  
 DECLINAT

1965

AMC 4767 II CW CEDIC V001

CERTIFIED MAIL



**Southland Royalty Company**

December 21, 1981

Mr. Joe D. Ramey  
New Mexico Department of Energy and Minerals  
Oil & Gas Division  
P. O. Box 2088  
Santa Fe, New Mexico 87501

Dear Mr. Ramey:

Southland Royalty Company hereby requests approval for an unorthodox location for the Hugh Lake #1 well. The proposed location is 800' FNL & 565' FWL of Section 33, T27N, R12W, San Juan County, New Mexico.

The unorthodox site is due to topography.

A copy of this application is being submitted to all offset operators by certified mail with a request that they furnish your Santa Fe Office with a waiver of objection.

Pursuant to authority of Rule 104-F, we respectfully request your approval of an exemption to the standard well location requirement.

Sincerely,

SOUTHLAND ROYALTY COMPANY

*R. E. Fielder*

R. E. Fielder  
District Engineer

REF/eg

Enclosures

✓ CC: Mr. Frank Chavez-OCC-Aztec, NM

W A I V E R

MERRION AND BAYLESS hereby waives objection to Southland Royalty Company's application for an unorthodox location for their Hugh Lake #1 as proposed above.

\_\_\_\_\_  
Date

\_\_\_\_\_  
Signed

CERTIFIED MAIL



**Southland Royalty Company**

December 21, 1981

Mr. Joe D. Ramey  
New Mexico Department of Energy and Minerals  
Oil & Gas Division  
P. O. Box 2088  
Santa Fe, New Mexico 87501

Dear Mr. Ramey:

Southland Royalty Company hereby requests approval for an unorthodox location for the Hugh Lake #1 well. The proposed location is 800' FNL & 565' FWL of Section 33, T27N, R12W, San Juan County, New Mexico.

The unorthodox site is due to topography.

A copy of this application is being submitted to all offset operators by certified mail with a request that they furnish your Santa Fe Office with a waiver of objection.

Pursuant to authority of Rule 104-F, we respectfully request your approval of an exemption to the standard well location requirement.

Sincerely,

SOUTHLAND ROYALTY COMPANY

R. E. Fielder  
District Engineer

REF/eg

Enclosures

✓CC: Mr. Frank Chavez-OCC-Aztec, NM

-----  
W A I V E R

BETA DEVELOPMENT COMPANY hereby waives objection to Southland Royalty Company's application for an unorthodox location for their Hugh Lake #1 as proposed above.

\_\_\_\_\_  
Date

\_\_\_\_\_  
Signed